

INSTALLATION INSTRUCTIONS
WINDSHIELD, FULL/SPLIT, ELECTRIC 4X4-KIT
682912/682913-A

READ ALL INSTRUCTIONS BEFORE INSTALLING THIS KIT.



Compare the kit contents list to the parts packaged in the kit. Ensure all parts are included before beginning installation.

Park vehicle on a flat surface.

Turn the key to the OFF position and remove the key from the switch.

Chock wheels to keep vehicle from rolling.



Always wear a safety shield or approved safety goggles when working on the vehicle.

VEHICLE PREPARATION

1. Compare the kit contents list to the parts packaged in the kit. Ensure all parts are included before beginning installation.
2. Park vehicle on a flat surface.
3. Turn the key to the OFF position and remove the key from the switch.

TOOLS

- 12mm Socket
- Ratchet
- Torx T25
- 10mm Wrench

682913 KIT CONTENTS FOR FULL WINDSHEILD

ITEM	QTY	PART NUMBER	DESCRIPTION
1	1	668947	WINDSHIELD SEAL KIT
1A	1	682965	HEADER WINDSHIELD SEAL
1B	1	668953	LOWER WINDSHIELD SEAL
2	6	3441-340	CLAMP CLIPS
3	6	3441-338	ROPS CLAMP
4	6	3441-339	CLAMP SEAL
5	1	682945	FULL WINDSHIELD
6	1	682911	METAL HEADER
7	3	670248	LATCH KIT (INCLUDES 7A-7D)
7A	3	--	LATCH SCREW
7B	3	--	LATCH WASHER
7C	3	--	LATCH NUT
7D	3	--	RUBBER LATCH

682912 KIT CONTENTS FOR SPLIT WINDSHIELD

ITEM	QTY	PART NUMBER	DESCRIPTION
1	1	668947	WINDSHIELD SEAL KIT
1A	1	682965	HEADER WINDSHIELD SEAL
1B	1	668953	LOWER WINDSHIELD SEAL
2	6	3441-340	CLAMP CLIPS
3	6	3441-338	ROPS CLAMP
4	6	3441-339	CLAMP SEAL
5	1	682916	SPLIT WINDSHIELD ASSEMBLY
6	1	682911	METAL HEADER
7	1	670316	LATCH & PIN KIT (INCLUDES 7A-7G)
7A	1	--	LATCH SCREW
7B	1	--	LATCH WASHER
7C	1	--	LATCH NUT
7D	1	--	RUBBER LATCH
7E	1	670249	GROMMET
7F	1	670250	HEADER PIN ASSEMBLY (INCLUDES PIN AND NUT)
7G	1	670251	LOWER PIN ASSEMBLY (INCLUDES PIN BUSHING AND NUT)

A. Install Windshield Header

1. Place the top of the windshield header (6) flush to the bottom side of the canopy.
2. Use the header pins (7F) and latch fasteners (7A, 7B, and 7C) to install windshield header (6), as shown in Fig. 1. Finger tighten header pins (7F) until end of installation.

NOTICE: Figure 1 demonstrates formation for Split Windshield (682912). For Full Windshield (682913) use three latch fasteners (7A, 7B, and 7C) across header.

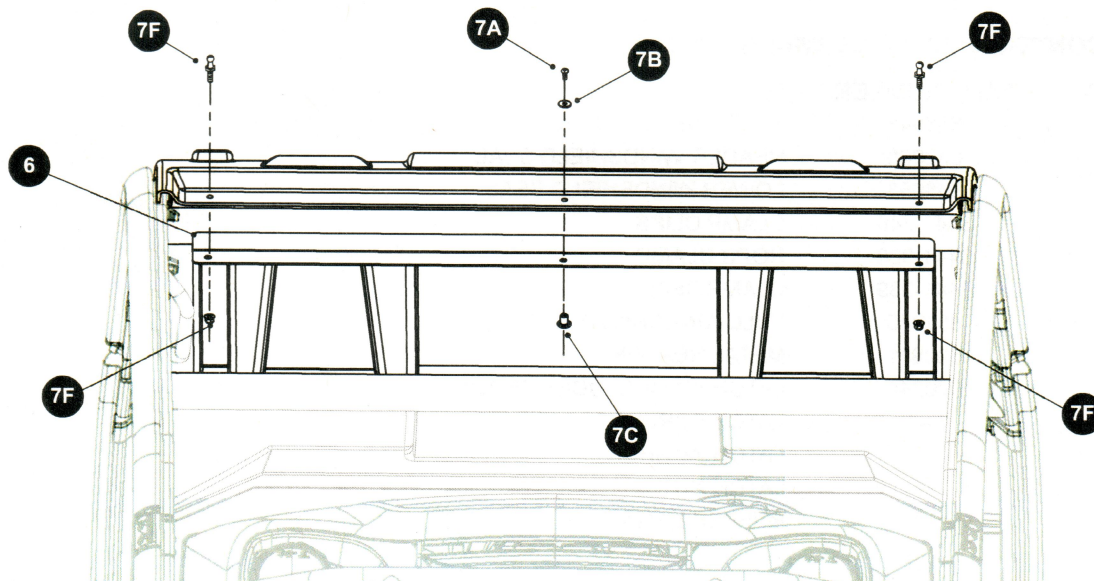

Fig. 1

B. Windshield seal installation

1. Install header seal (1A) to the front bottom edge metal header as shown in Fig. 2. Bulb of seal should face the front of vehicle, to support windshield. Seal will follow profile of the metal header. Side seals included with canopy kit.

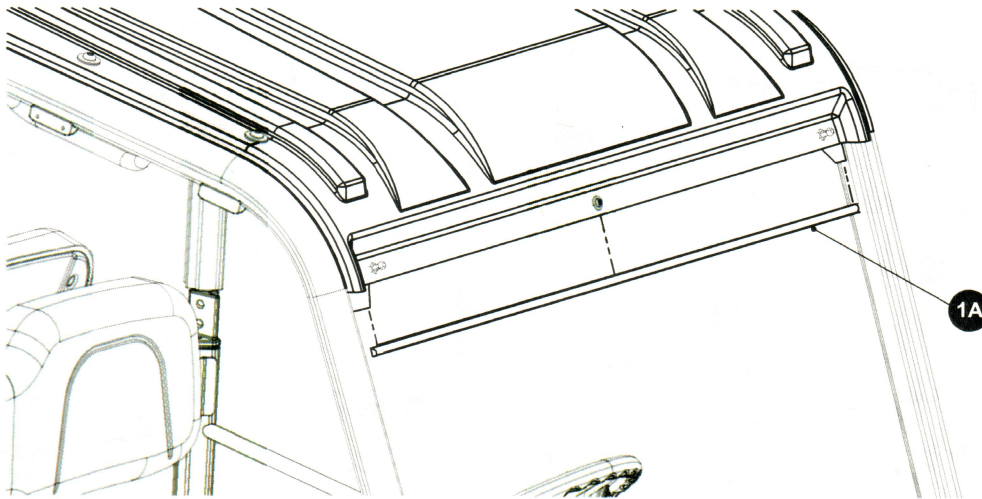

Fig. 2

2. Install lower seal (1B) to windshield bottom, as shown in Fig. 3.

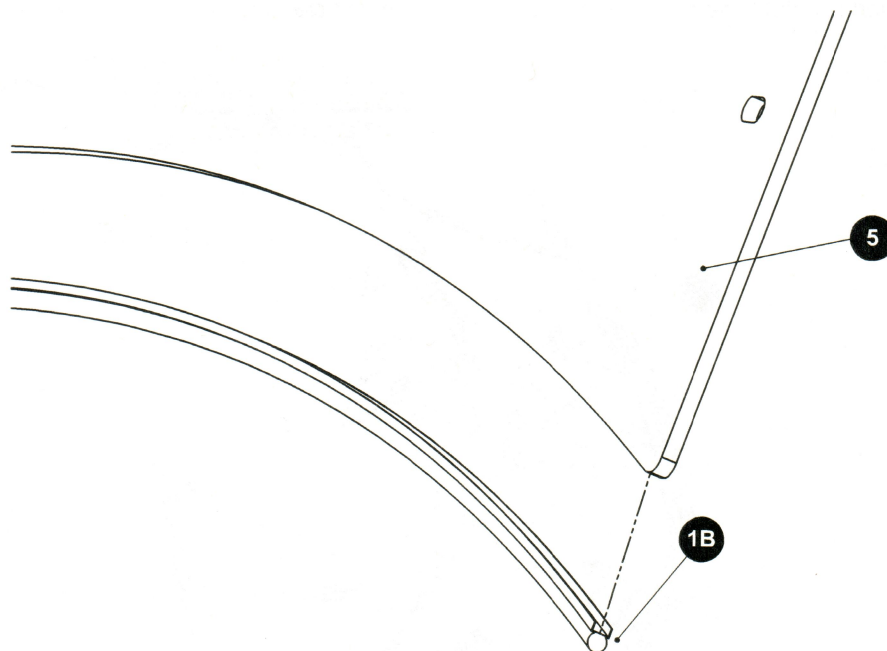

Fig. 3

C. Prepare for Windshield Installation

1. Insert clips (3) each with two gaskets (4) into slots of windshield, as shown in Fig. 4.

NOTICE: For Split Windshield (682912) clips will only be installed below hinge line.

2. Insert latches (7D) or grommets (7E) into the top of the windshield, as shown in Fig. 4 and Fig. 5.

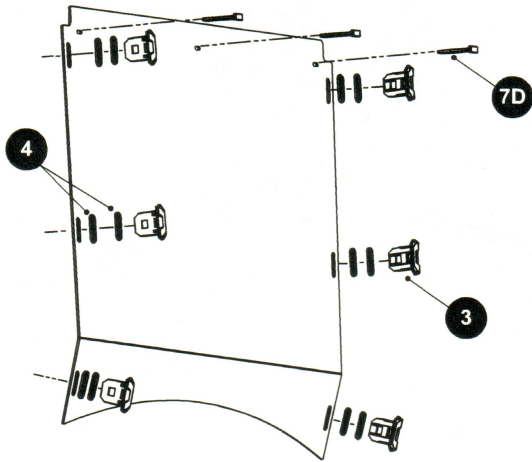

Fig. 4

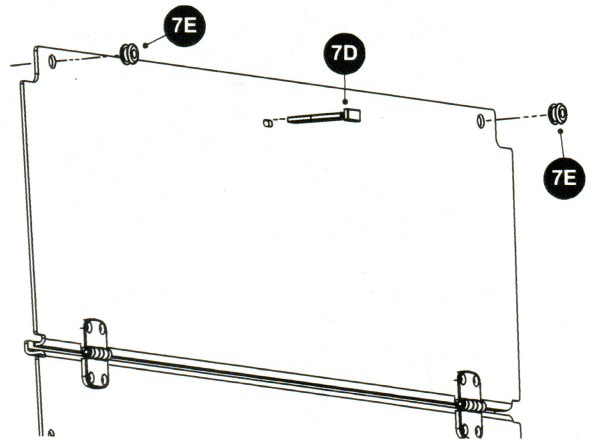

Fig. 5

NOTICE: Full Windshield (682913) to use three rubber latches (7D) across top, as shown in Fig.4. Orientation shown in Fig. 5 for Split Windshield (682912).

D. Windshield Installation

1. Place windshield in position on vehicle OPS. Use header pieces to find location, or rest windshield bottom on the vehicle. Once position is established, attach OPS clips (2) to the vehicle, and insert male clips (3) with windshield.

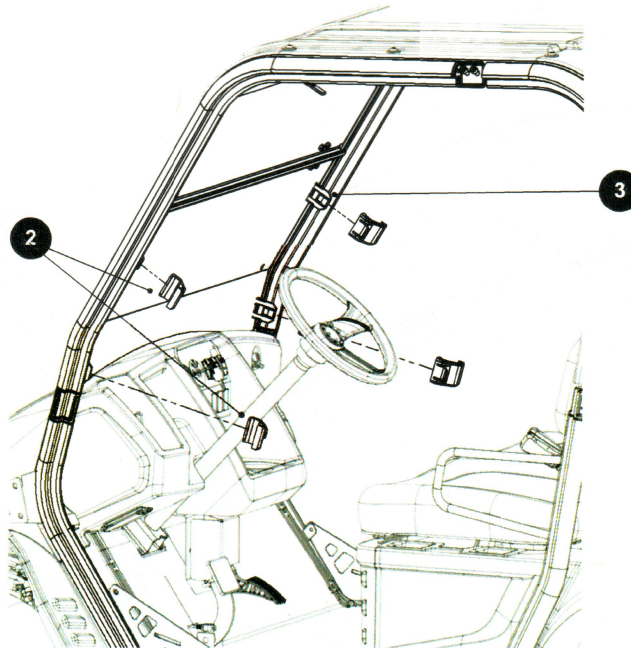

Fig. 6

E. Install Locating Pins (Split Windshield only)

1. Install bottom pin assemblies (7G) to bottom portion of windshield, as shown in Fig. 7. Hand tighten.

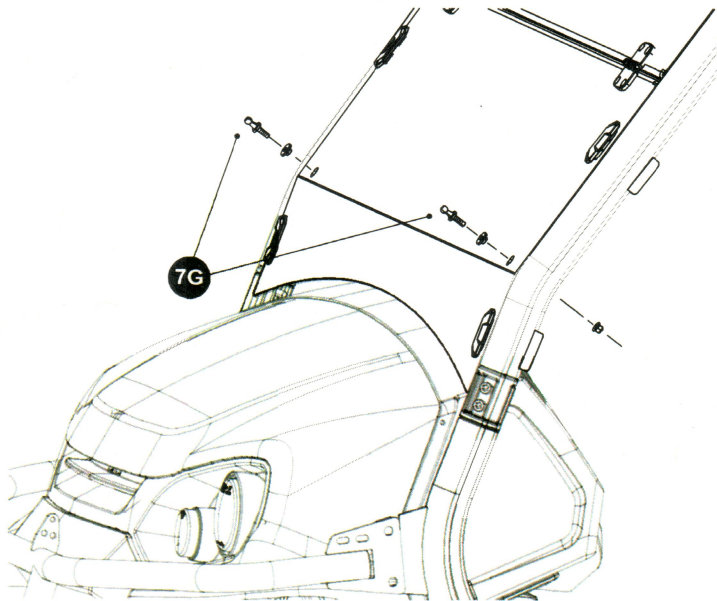

Fig. 7

F. Tighten Locating Pins (Split Windshield only)

1. Tighten the header pins (7F) after mating with grommets installed in the windshield.
2. Remove windshield connection from header pins (7F) and rotate to locate lower pins (7G), as shown in Fig. 8. Once connection is established, tighten the lower pins (7G).

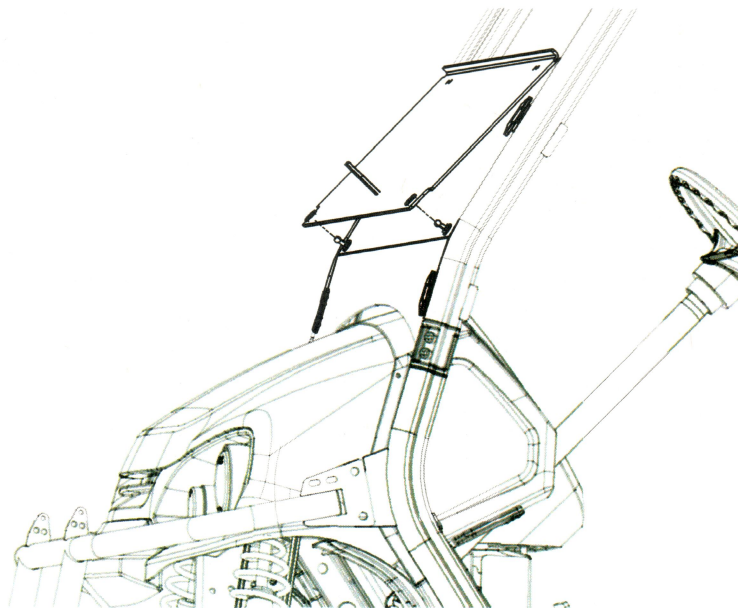

Fig. 8