

Arctic Cat® Snowmobile

Installation Instructions

SPEEDRack Base Kit (p/n 7639-342)



■ **NOTE:** Read these Installation Instructions thoroughly before beginning the installation process. Retain these Installation Instructions for future reference.

Kit includes:

Ref. No.	p/n	QTY	DESCRIPTION
1	*	10	Button-Head Torx Screw (M5 x 10 mm)
2	*	10	Flat Washer
3	*	10	Spring Lock Washer
4	6706-353	1	Front Base
5	6706-352	1	Rear Base
N/A	N/A	1	Template
N/A	2436-501	1	SPEEDLock
N/A	2653-096	1	Instruction

* Included in Hardware Kit (p/n 1641-262)

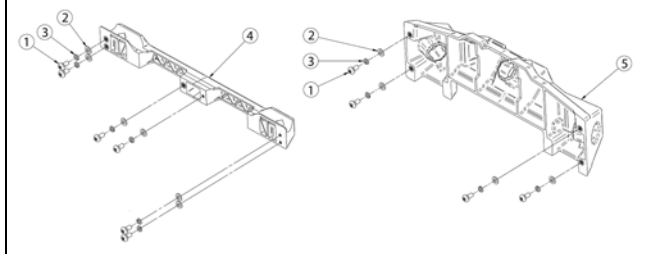

■ **NOTE:** On certain models, the seat and gas tank assemblies will have to be removed.

■ **NOTE:** Below is a recommended mounting location. The template can be moved on longer tunnel models.

1. Align Template with the two rivets in line with the rear tunnel gussets; then mark all mounting locations. See Fig. 1 and 2.

Fig. 1

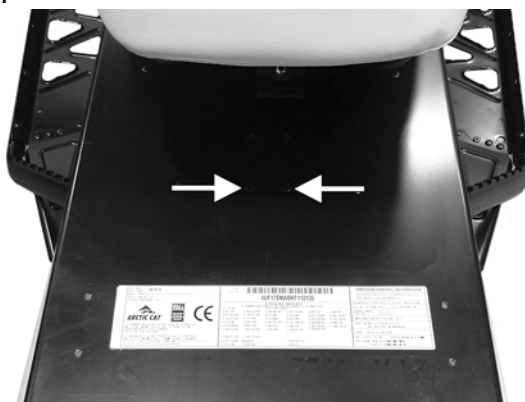

XM539A

Fig. 2



XM538

CAUTION

Before drilling into the tunnel, make sure not to drill into the heat exchanger.

2. Using a 15/64-in. drill bit, drill all ten mounting locations; then secure Front and Rear Base to the tunnel using ten Button-Head Torx Screws (M5 x 10 mm), ten Spring Lock Washers, and ten Flat Washers. Do not over-tighten. See Fig. 3.

Fig. 3

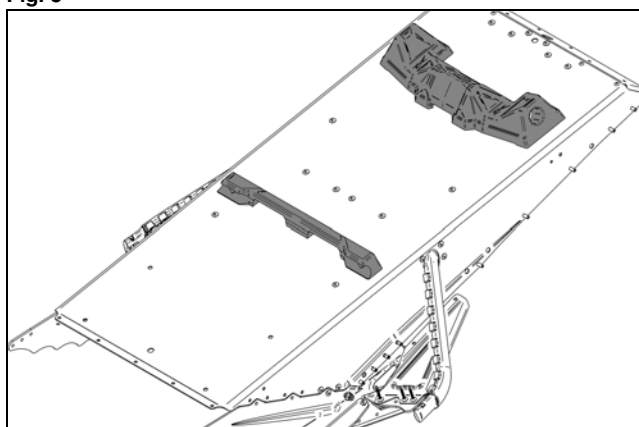

SNO-850

CAUTION

Do not install the rack completely toward the rear of the tunnel on models with the short heat exchanger or damage to the tunnel may occur.

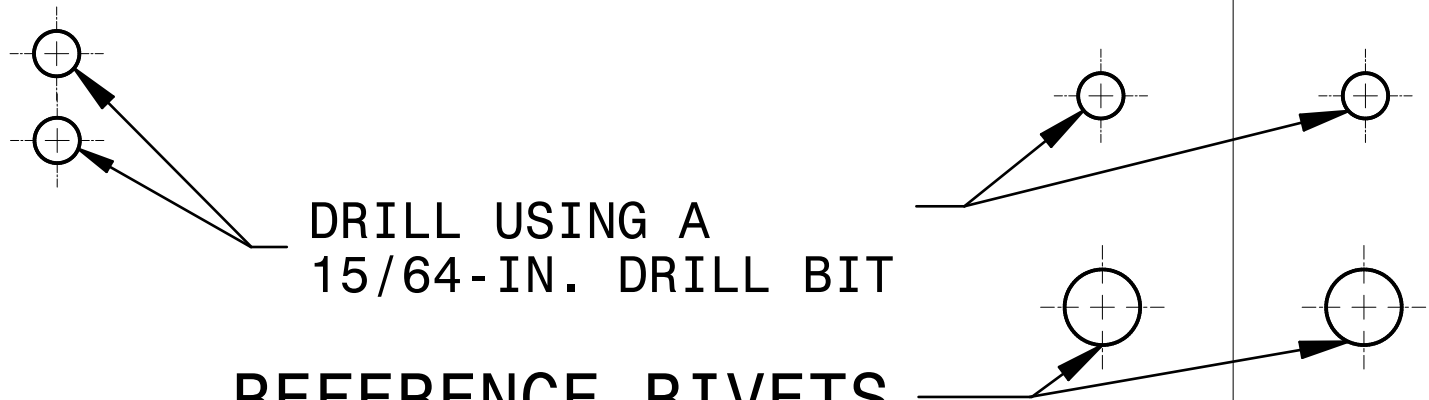

REFERENCE RIVETS
ON TUNNEL FOR
ALIGNMENT OF THE
TEMPLATE



FRONT

**TAPE ALL SHEETS TOGETHER
BEFORE INSTALLING THE
TEMPLATE ON THE TUNNEL**

ALIGN
WITH OTHER
PAPER

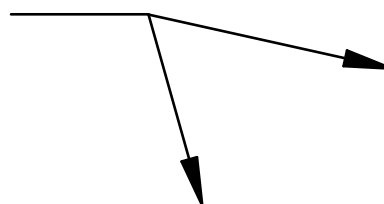

1

1

THE LINE BELOW SHOULD BE
5 INCHES IF THIS PRINT IS
PRINTED TO SCALE (8.5X11 PAPER).

PRINT OPTION:

CHOOSE "CUSTOM SCALE" : 100%

THE LINE BELOW SHOULD BE
5 INCHES IF THIS PRINT IS
PRINTED TO SCALE (8.5X11 PAPER).

PRINT OPTION:
CHOOSE "CUSTOM SCALE" : 100%

ALIGN
WITH OTHER
PAPER

TAPE ALL SHEETS TOGETHER
BEFORE INSTALLING THE
TEMPLATE ON THE TUNNEL



FRONT

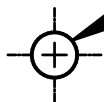
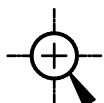

DRILL USING A
15/64-IN. DRILL BIT

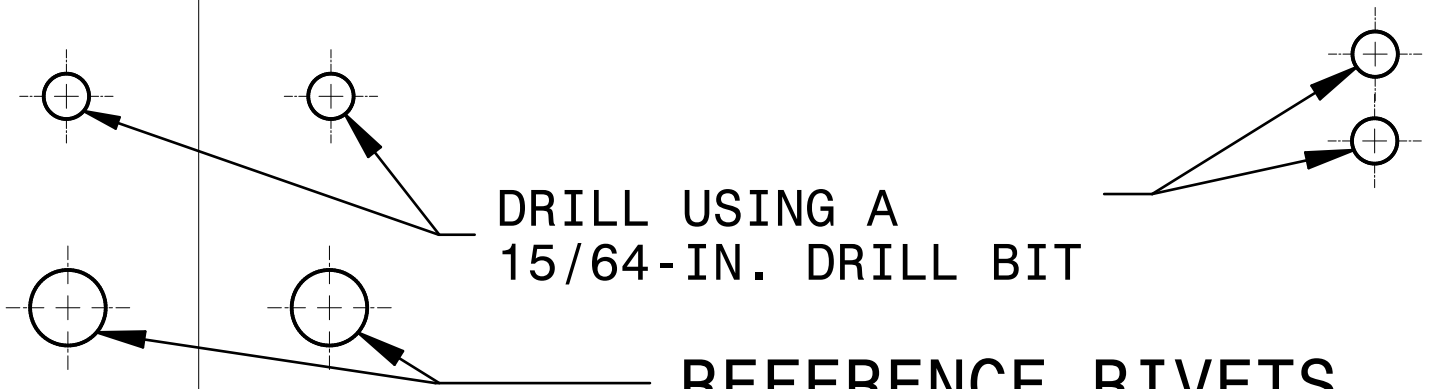

DRILL USING A
15/64-IN. DRILL BIT

REFERENCE RIVETS
ON TUNNEL FOR
ALIGNMENT OF THE
TEMPLATE

FRONT

TAPE ALL SHEETS TOGETHER
BEFORE INSTALLING THE
TEMPLATE ON THE TUNNEL

ALIGN
WITH OTHER
PAPER

THE LINE BELOW SHOULD BE
5 INCHES IF THIS PRINT IS
PRINTED TO SCALE (8.5X11 PAPER).

PRINT OPTION:
CHOOSE "CUSTOM SCALE" : 100%



THE LINE BELOW SHOULD BE
5 INCHES IF THIS PRINT IS
PRINTED TO SCALE (8.5X11 PAPER).

PRINT OPTION:
CHOOSE "CUSTOM SCALE" : 100%

ALIGN
WITH OTHER
PAPER

TAPE ALL SHEETS TOGETHER
BEFORE INSTALLING THE
TEMPLATE ON THE TUNNEL



FRONT

DRILL USING A
15/64-IN. DRILL BIT

