

BOM ID	Description	QTY
1	Saddle Clamp - Bolt	1
2	Saddle Clamp - Washer	1
3	Saddle Clamp - Outer	2
4	Saddle Clamp - Inner	2
5	Top Link	1
6	Saddle Clamp - Spring	1
7	Saddle Clamp - Nut	1
8	Pivot Screw	4
9	Taper Pin - Nonthreaded	4
10	Pivot Arm	2
11	Seat Post	1
12	Taper Pin - Threaded	4
13	LT Elastomer	1

Installation Instructions -

1. Note your current saddle height and fore/aft position to duplicate it with the Thudbuster.
2. Remove your current saddle and seatpost. Confirm your current saddle is compatible with Thudbuster.
Thudbuster is only compatible with saddles using round alloy rails.
3. Confirm your new Thudbuster seatpost (or shim) diameter is the same as your old seatpost. (Thudbusters are available in three direct fit sizes, 27.2, 30.9, and 31.6mm.)
4. Grease the shim (if applicable) and seat pillar before installing. DO NOT lubricate seat tubes of Carbon frames (unless specified by the manufacturer).
5. Insert the shim (if applicable) into the bicycle frame with the split aligned with the split in the seat-tube.
6. Install the Thudbuster into the bicycle frame to approximately the correct height with the extension marks on seat pillar facing the front of the bicycle.
7. Loosen the saddle clamp bolt until the saddle rails can be installed into the seatpost clamps.
8. Begin to tighten the saddle clamp bolt. Ensure your saddle tilt angle is correct before tightening completely. Tighten the saddle clamp to 16Nm MAX. Be sure all the components of the clamp are installed as shown above.
9. Adjust the saddle height if necessary.

**NOTICE! The Thudbuster must be set-up with appropriate elastomer before riding (See below).
Maximum allowable rider weight is 250 lb (115kg).**

Selecting Elastomers -





The Thudbuster LT can be tuned for different weight riders and riding styles by selecting the correct elastomer. Start with the softest elastomer recommended for a given rider weight. The Thudbuster LT is shipped with medium elastomer installed. You may desire to decrease or increase the stiffness by using a softer or harder elastomer. Optional Thudbuster elastomers can be purchased at your local bicycle dealer. Never use a softer elastomer than recommended for your weight.

Changing Elastomer -

Cane Creek's Long Travel Thudbuster Elastomers can be removed by hand without any disassembly of the seat post. The Elastomers should be changed to the firmness rating needed for the rider weight (Reference the Elastomer weight range guide to the right).

To Change Elastomer:

1. Push down on seat to move the seat post arms backwards and press the gold release button.
2. Move seat forward while holding the gold release button until elastomer moves freely within the arms.
3. Rotate elastomer by pushing the smaller wings of the elastomer in opposite directions until the wings are outside of the seat post pivot arms.
4. Remove elastomer from the seat post.
5. Insert replacement elastomer in opposite order as removal.
6. Ensure elastomer is oriented with "top" and "bottom" markings in correct position and is fully seated inside of the arms.
7. Push down on seat to move the seat post arms backwards until the gold release button re-engages.

RIDER WEIGHT		ELASTOMER RECOMMENDATION
(lbs)	(kg)	
<140lbs	<65kg	Extra Soft (Sold Separately) 
120lbs - 170lbs	55kg - 75kg	Soft (Sold Separately) 
150lbs - 200lbs	65kg - 90kg	Medium (Installed) 
180lbs - 230lbs	80kg - 100kg	Firm (Sold Separately) 
210lbs - 250lbs	95kg - 115kg	Extra Firm (Sold Separately) 

Additional elastomers are available separately from www.canecreek.com

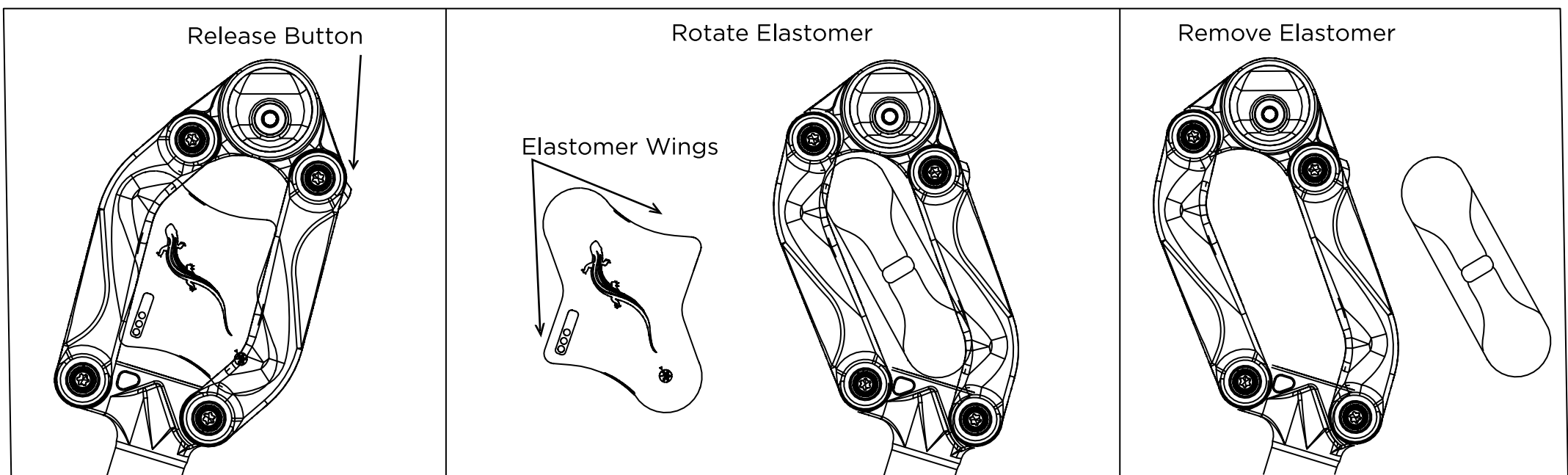

To identify the firmness of the elastomer, find the rectangular area on the elastomer wing:

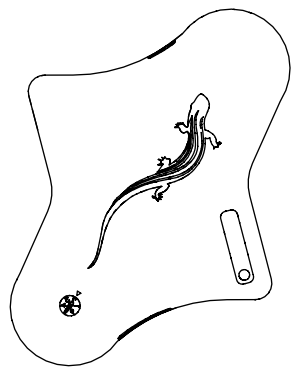

Extra Soft (Sold Separately)

Under 140lbs (65kg)

Part Number: AAE0299-54

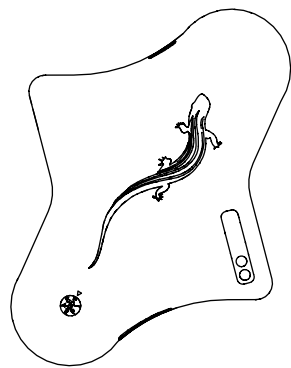

Soft (Sold Separately)

120-170lbs (55-75kg)

Part Number: AAE0299-61

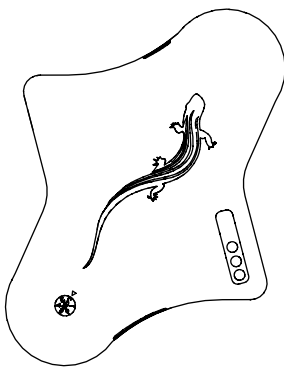

Medium (Installed)

150-200lbs (65-90kg)

Part Number: AAE0299-68

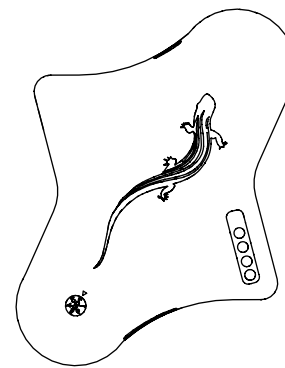

Firm (Sold Separately)

180-230lbs (80-100kg)

Part Number: AAE0299-75

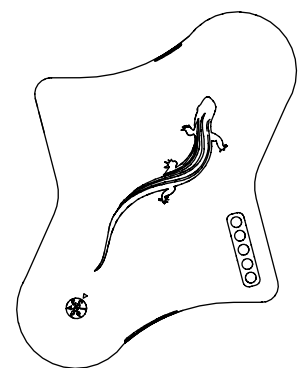

Extra Firm (Sold Separately)

210-250lbs (95-115kg)

Part Number: AAE0299-81

NOTICE! If you ride in muddy conditions, using either a fender or the Cane Creek Thudglove neoprene boot will protect the pivots and extend the life of your seat post.

NOTICE! Thudbuster seat posts are designed to absorb bumps on variable riding surfaces. However, you should still stand up when encountering large obstacles on the road or trail.

Warranty Information

Thudbuster seat posts are warranted against defects in materials or workmanship for one year from the date of purchase. This warranty applies to the original owner only. At their discretion, Cane Creek Cycling Components will repair or replace any defective seat post with the same or comparable model. This warranty is void if the seat post is damaged as a result of abuse, alterations, modifications, improper adjustment, lack of maintenance, crashes, or other conditions judged by Cane Creek Components to be abnormal, excessive, or improper. It is mandatory that a Return Authorization Number (RA#) is received (by calling Cane Creek) before any return is made. Additionally, a dated Proof of Purchase must accompany the seat post when returned.

Release Button replace - BAE0311

Instructions -

1. Remove elastomer following steps above
2. While holding drive side taper pin (threaded) with T45, unscrew non drive side pivot screw from taper pin (nonthreaded) with T25.
3. Open pivot arms being careful to note the orientation of the release button.
4. Insert springs into new release button and carefully insert into top link.
5. Install o-rings back over arms. Close pivot.
6. Install drive side taper pin (threaded)
7. Install non drive side taper pin (nonthreaded) and pivot screw and apply blue lock-tite and hand tighten.
8. Torque pivot bolt to 9Nm.

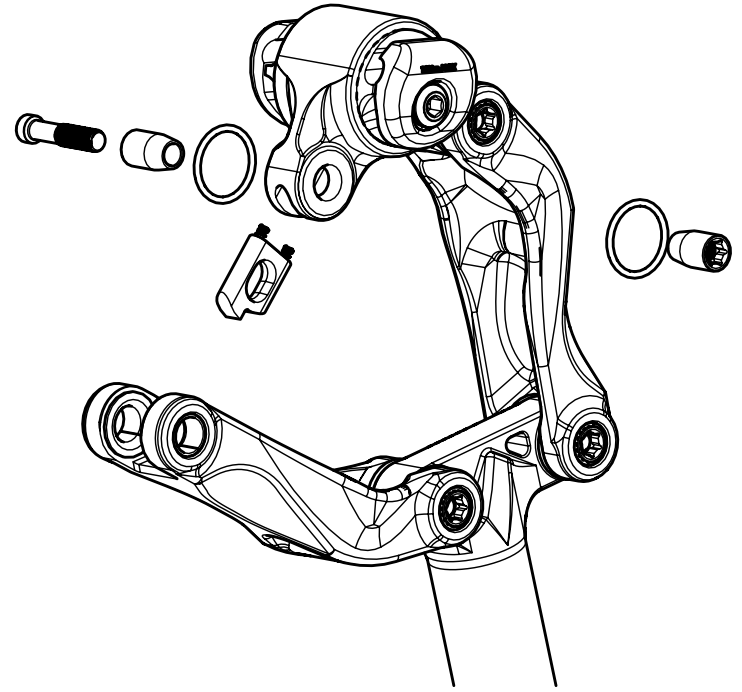

O-ring replace - BAE0320

Instructions -

1. Remove elastomer following steps above
2. Remove T25 bolt and threaded pin (T45 on opposite side)
*Only remove one pivot at a time. The rear, upper pivot houses the release button. Note orientation and reinstall if removed.
3. Insert 6mm hex through pivot bore from drive side and punch out non-threaded pin (T25)
4. Open pivot arm and remove existing O-Rings
5. Slide new O-Rings over arms
6. Close pivot
7. Install o-rings (slide back over arms to position)
8. Install non-threaded pin to non-drive side
9. Install threaded pin to drive-side and apply blue loc-tite and hand tighten the T25 bolt
10. Repeat for the other three pivots
11. Torque each pivot bolt to 9Nm

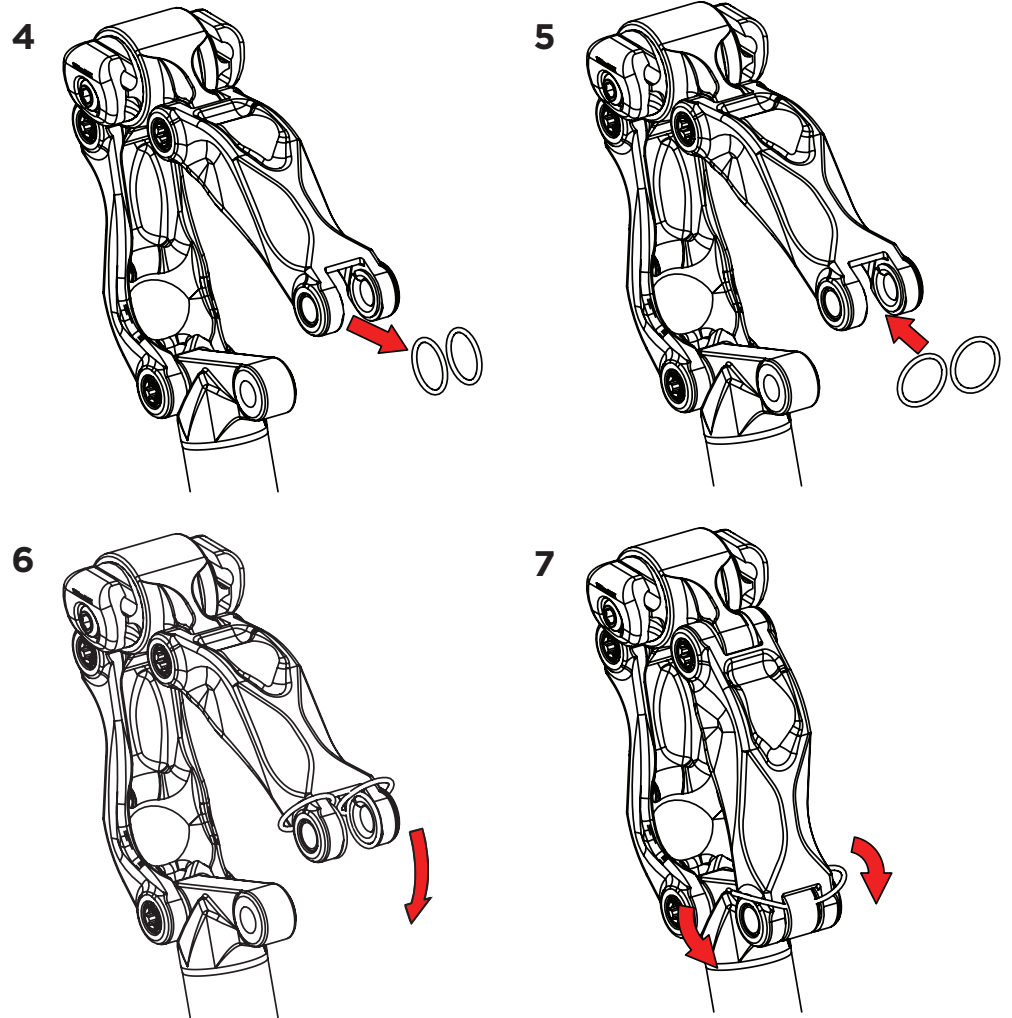

Bushing replace - BAE0199

Instructions -

Removal:

1. Remove elastomer following steps above
2. Remove tapered pins, pivot screw and O-rings
3. Disassemble tool and reassemble in the orientation pictured in figure A
4. Hold tool body with a 8mm open wrench and use 5mm hex wrench to remove bushing

Install:

1. Disassemble tool and reassemble with new bushing in the orientation pictured in figure B
2. Hold tool body with a 8mm open wrench and use 5mm hex wrench to install bushing

A: Removal

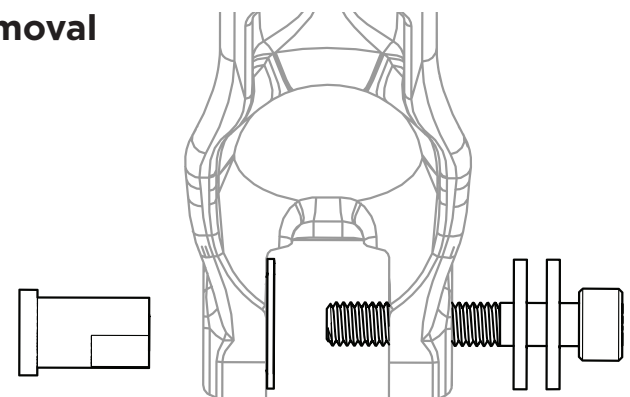

B: Install

