

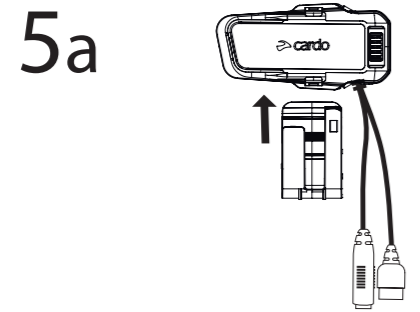

Option 1

Installation on narrow rim helmet
 Installation sur casque à bord étroit
 Instalación en el casco de borde estrecho

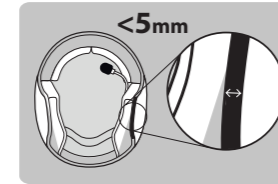

5b

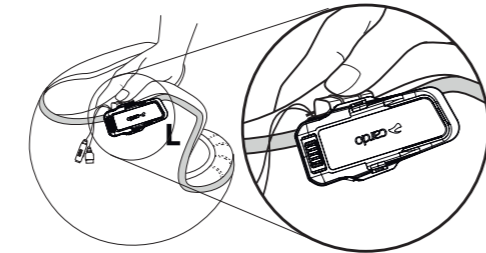

Push clamp into place
 Mettez l'attache en place
 Empuja la abrazadera hasta que calce

Option 2

Installation on wide rim helmet
 Installation sur casque à bord large
 Instalación en el casco de borde ancho

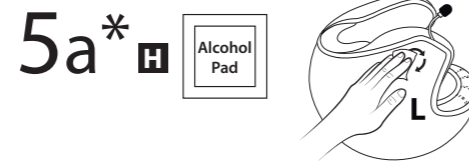
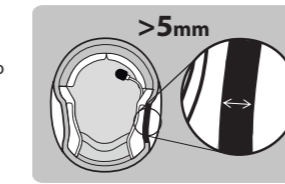

5b*

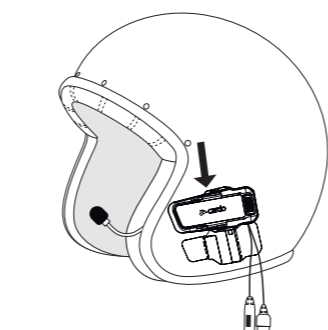
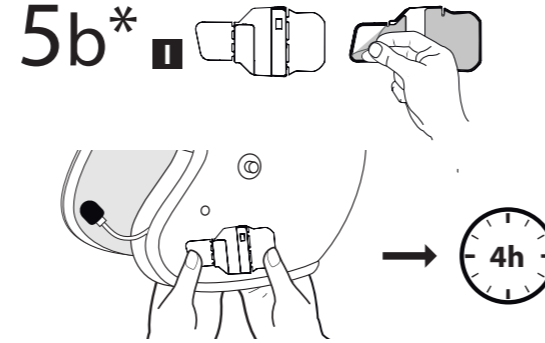

6

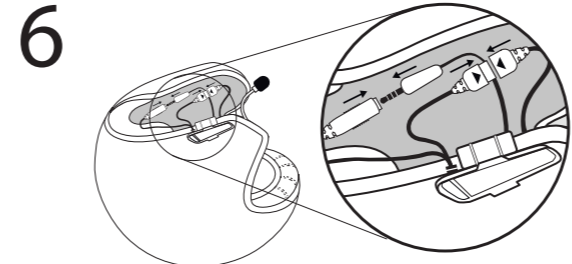

7

7a

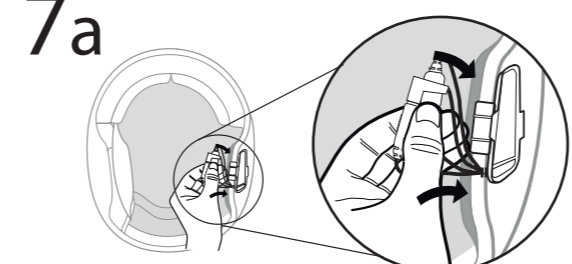

Tuck wires behind padding
 Placer les fils derrière le rembourrage
 Coloque los cables detrás de los acolchados

7b

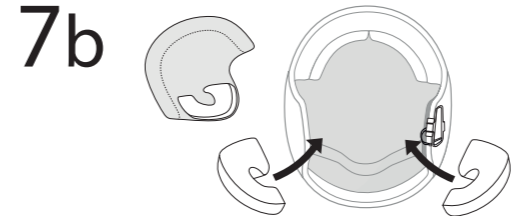

8 Optional

If needed, use booster pads to place speakers closer to ear
 Si nécessaire, utilisez des coussinets de rattrapage pour rapprocher les haut-parleurs de l'oreille
 Si es necesario, use almohadillas de amplificadores para poner los altavoces cerca de la oreja

8a

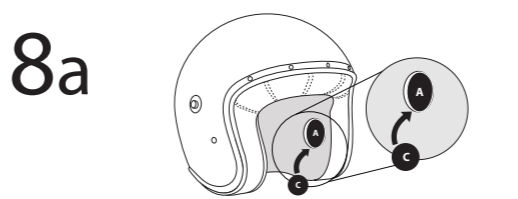

8b

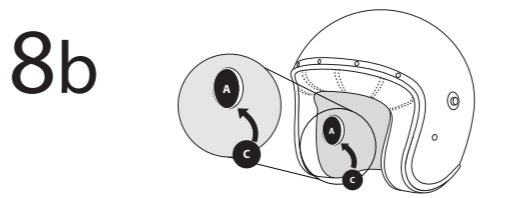

9

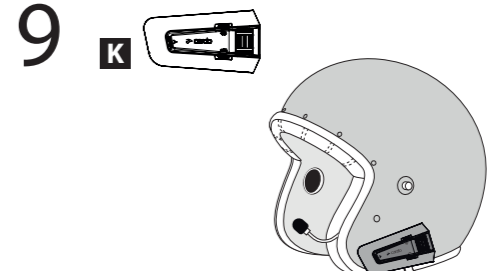

10

Remove the unit
 Retirer l'unité
 Retire la unidad

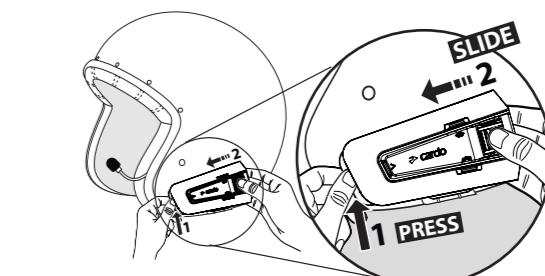

Press & slide
 Appuyer et faire glisser
 Presione y deslice

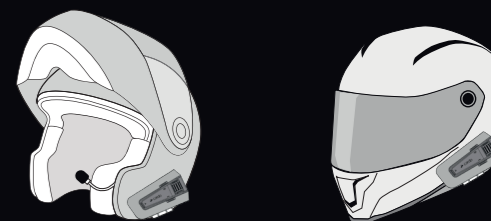

PACKTALK EDGE
 Installation Guide

INSTALLATION VIDEO

Vidéo d'installation
Video de instalación



CONTENTS

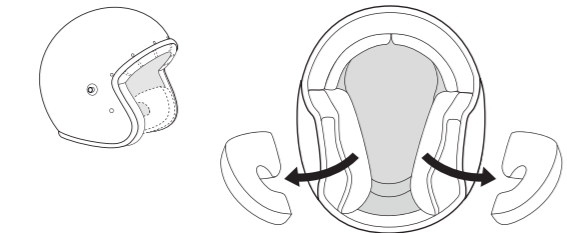
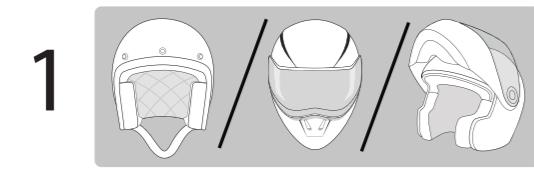
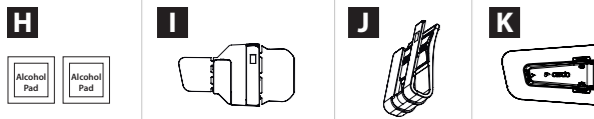
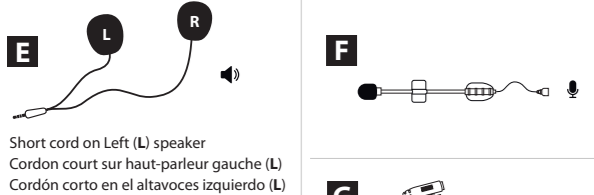

2 **A** x2

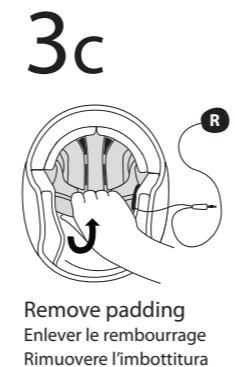
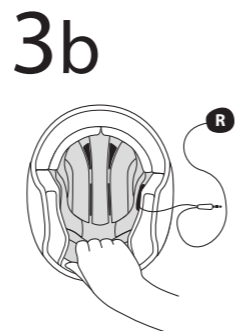
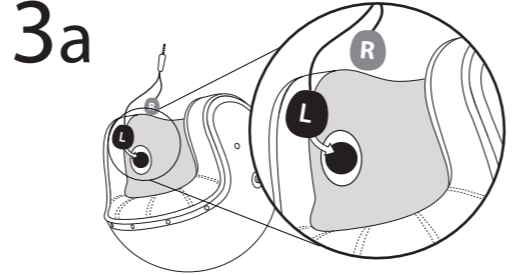
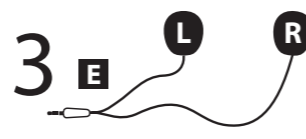
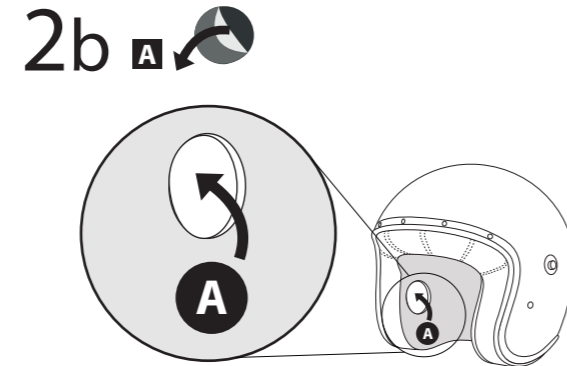
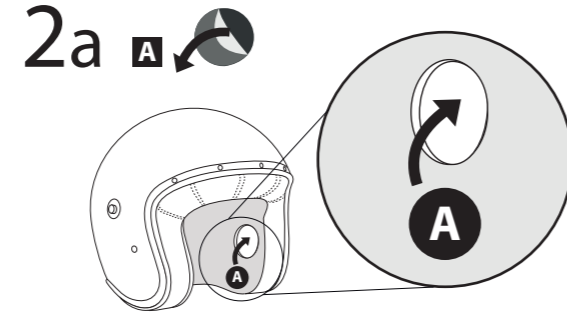

3d

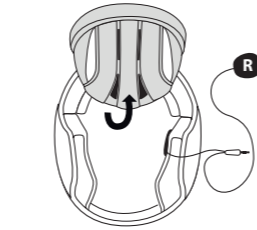

3e

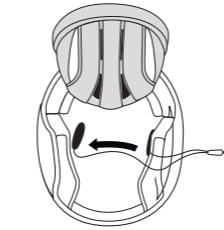

3f

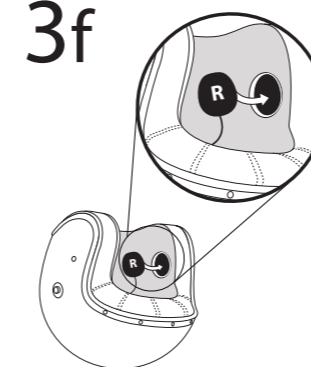

3g

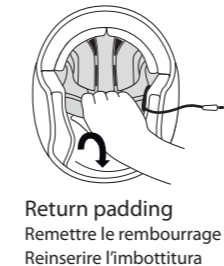

Option 1

Open face helmet installation
Installation sur casque jet (open face)
Instalación del casco abierto



4a **B** x2

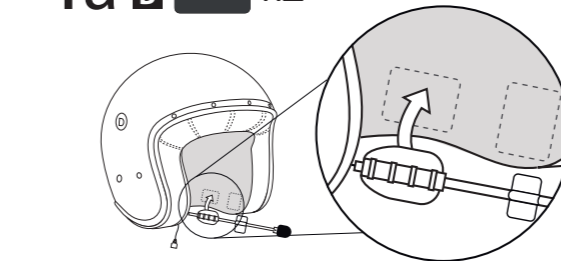

Place the mic to position the velcros
Placez le micro pour positionner les velcros
Colocar el micrófono para poner los velcros

4b **F**

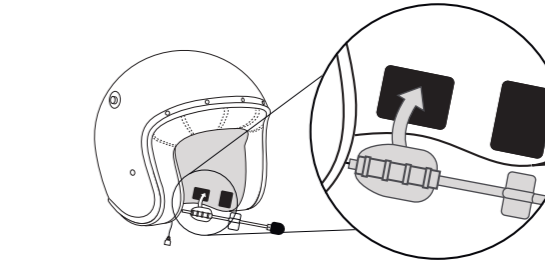

4c

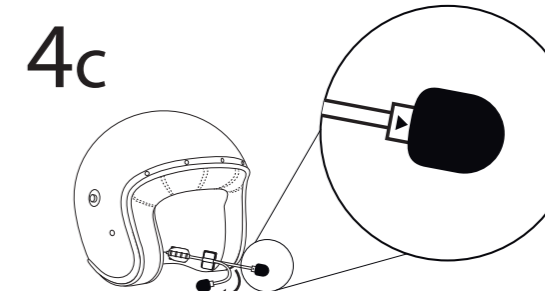

Option 2

Full face helmet installation
Installation sur casque intégral
Instalación en el casco de cara completa

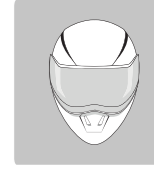

4* **D** **B**

4a* **B**

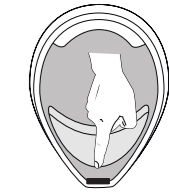

4b* **D**

4c*

