

Tech sheet

CeramicSpeed Bottom Bracket

Spacer overview for SRAM DUB

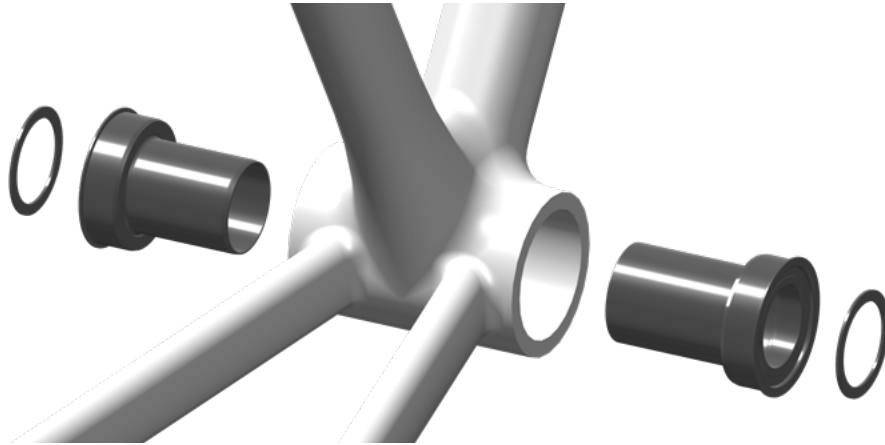

ROAD	Frame width	Non-drive side		Drive side	
		Standard	Wide	Standard	Wide
BB86	86,5	0	2 × 1 mm	3 mm	2 × 3 mm
BB30	68	0	3 mm	3 mm	2 × 1 + 3 mm
PF30	68	0	2 × 1 mm	3 mm	2 × 3 mm
PF30a	73	2 × 3 mm	NA	3 mm	NA
BBright	79	1 mm	3 mm	3 mm	2 × 3 mm
EVO386	86,5	2 × 1 mm	2 × 1 + 3 mm	2 × 3 mm	2 × 1 + 2 × 3 mm
BSA	68	0 mm	2 × 1 mm	1 + 3 mm	1 + 2 × 3 mm
ITA	70	1 mm	3 mm	3 mm	2 × 3 mm
T45 (Colnago)	82,5	3 mm	2 × 1 + 3 mm	2 × 1 + 3 mm	2 × 1 + 2 × 3 mm
T47	68	1 mm	2 × 1 + 3 mm	2 × 3 mm	2 × 1 + 2 × 3 mm
T47a	76,75	1 mm	2 × 1 + 3 mm	2 × 1 + 3 mm	2 × 1 + 2 × 3 mm
T47 (Trek)	85,5	1 mm	1 + 3 mm	2 × 1 + 3 mm	2 × 1 + 2 × 3 mm
T47	86,5	1 mm	1 + 3 mm	1 + 3 mm	1 + 2 × 3 mm

OFF-ROAD	Frame width	Non-drive side		Drive side	
		Standard	Wide	Standard	Wide
BB92	91,5	0	3 mm	1 + 3 mm	1 + 2 × 3 mm
BB30	73	0	3 mm	1 + 3 mm	1 + 2 × 3 mm
PF30	73	0	3 mm	1 + 3 mm	1 + 2 × 3 mm
BSA	73	1 mm	1 + 3 mm	1 + 3 mm	1 + 2 × 3 mm
T47	73	3 mm	2 × 3 mm	1 + 2 × 3 mm	1 + 3 × 3 mm
T47 Factor	88,5	3 mm	2 × 3 mm	2 × 1 + 3 mm	2 × 1 + 2 × 3 mm

Due to manufacturing variances and arrangements between frames and cranks, it is advised to always confirm setup alignment and clearances after appropriately torquing the cranks and before riding. This spacer guide is only a reference for standard arrangements and may require individual adjustments based on the chosen combination of components.