



Custom Dynamics® 575 Headlight Adapter Kit Installation Instructions

We thank you for purchasing the Custom Dynamics® Adapter kit for 5.75" Headlight. Our products utilize the latest technology and high quality components to ensure you the most reliable service. We offer one of the best warranty programs in the industry and we back our products with excellent customer support, if you have questions before or during installation of this product please call Custom Dynamics® at 1(800) 382-1388.

Part Number: CDTB575ADK

Package Contents:

- 1/4-20x5/8 Button Head Cap Screw (3)
- 24205 Loctite .5ml (1)
- Rubber Gasket (3)

Fitment: Harley-Davidson Softails models with 5.75" factory headlamp buckets, when converting to Custom Dynamics® TruBEAM® LED headlamp.



Installation

1. Park the bike on a level surface and make sure headlamp is cool to the touch before beginning installation.
2. Remove the stock headlamp from the bucket by removing the chrome trim ring. See service manual if unsure of this process.
3. Remove the inner headlamp locating ring.
4. Remove the headlamp bucket from the bike, according to the instructions in the manufacturers service manual. This step is required to gain access to the acorn nuts on the bottom of the headlamp bucket assembly.

Note: It is not necessary to unplug the wiring harness to complete this installation, however, if you choose to do so, partial or full removal of the gas tank may be required on some models. If you are not unplugging the harness connector, take steps to protect the bucket/bike finishes with a cloth or other means to avoid damage.

5. Locate the mounting bracket for the bucket, begin by removing the 3 7/16" nuts that secure the bracket. Save the 3 star washers removed for reinstallation later. See Photo A. If nuts are difficult to loosen, apply heat with heat gun to soften the factory thread lock.
6. Remove the bracket, what is left are the 3 mounting studs attached on the outside of the bucket with Chrome acorn nuts. Use a wrench to hold the inside studs with the rubber gaskets, Loosen/remove the 7/16" acorn nuts and remove the studs. This may be a bit difficult as the manufacturer applied loc-tite before installation. Save the acorn nuts for reinstallation later. Discard the 3 star washers used in between the bucket and the gasket, they will not be re-used. See photo B.



Please read all Information below before Installation

Important: This kit is intended to increase the area inside the headlamp bucket in order to properly mount a Custom Dynamics® TruBEAM® LED headlamp. This product is Not intended for any other application with any other type of headlamp or fitment for any other models except where noted.

Safety First: Make sure bike is parked on a level surface and the headlamp is cool to the touch before beginning installation.

Note: A manufacturer detailed service manual is needed for reference on how to remove the factory headlight assembly and bucket.

Note: If removing the headlamp bucket and wiring harness from the bike to perform this installation, partial or full removal of the gas tank may be required in order to access the headlamp harness connector on some models. Please refer to the manufacturers service manual for instructions on locating and removing the headlamp harness connector.

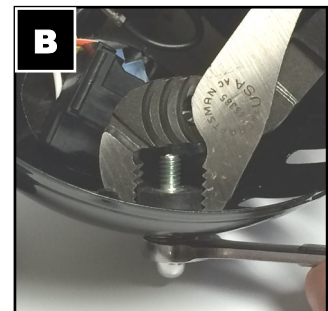
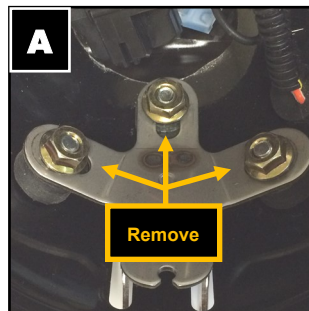

Questions? Call us at: 1 (800) 382-1388 M-TH 8:30AM-5:30PM / FR 9:30AM-5:30PM EST

Installation Instructions - Page 2

6. Prepare the bracket with the provided kit items. For each 1/4-20 cap screw, re-use 1 star washer, installing first, then install each screw into the bracket hole openings. Lastly, install the kit provided rubber gasket onto the bottom of the screws as shown. See Photo C.
7. Insert the bracket assembly back into the headlamp bucket, ensuring that the screws install back into their respective holes.
8. Turn the lamp over and apply the kit provided Loc-Tite onto each cap screw, generously coating the threads. Do not skip this step.
9. Install the saved acorn nuts onto each cap screw, then tighten with the a 5/32" allen hex key and 7/16" wrench. See Photo D.

WARNING: Do not over tighten the acorn nuts! They should be snug but without compressing the rubber gaskets inside. If compression occurs the headlamp bucket diameter can bend out of shape easily. Check the bucket to make sure the proper roundness is present, if not, loosen each nut until the proper shape returns. The Applied loc-tite will be sufficient to keep secure.

10. Re-mount the headlamp bucket to the bike, according to the instructions in the manufacturers service manual.
11. Before reinstalling the inner headlamp locating ring, the inside diameter of the ring will need to be ground down slightly to allow the locating ring to sit flush against the LED headlamp locating ring tabs. See Photo E for the location of the tabs. Use a Dremel or similar grinding tool in small increments to grind around the entire diameter of the ring until it fits as shown in Photo F. Fit test the ring with the headlamp after grinding to ensure proper fitment. Once modification is complete, reinstall the inner headlamp locating ring into the headlamp bucket.
12. Following the instructions included with the CDTB-575 TruBEAM® LED headlamp.
13. Re-install the outer headlamp trim ring.
14. Check for proper headlamp fitment.
15. Check operation of headlamp before riding.

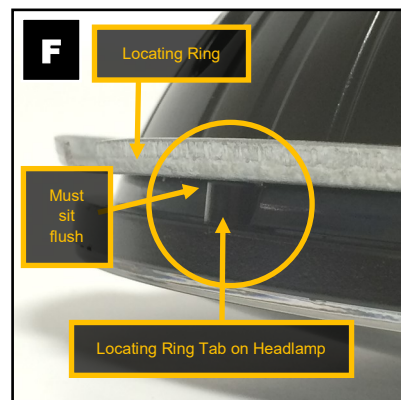
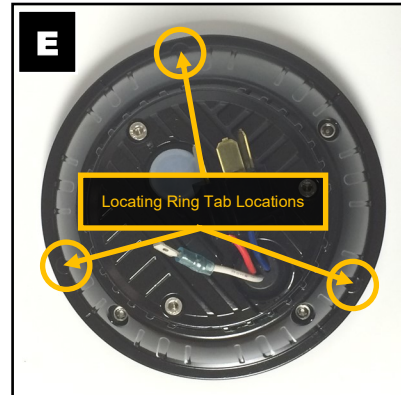
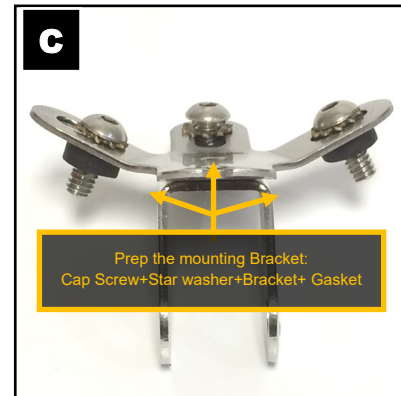

Everything to Light Up Your Ride™