

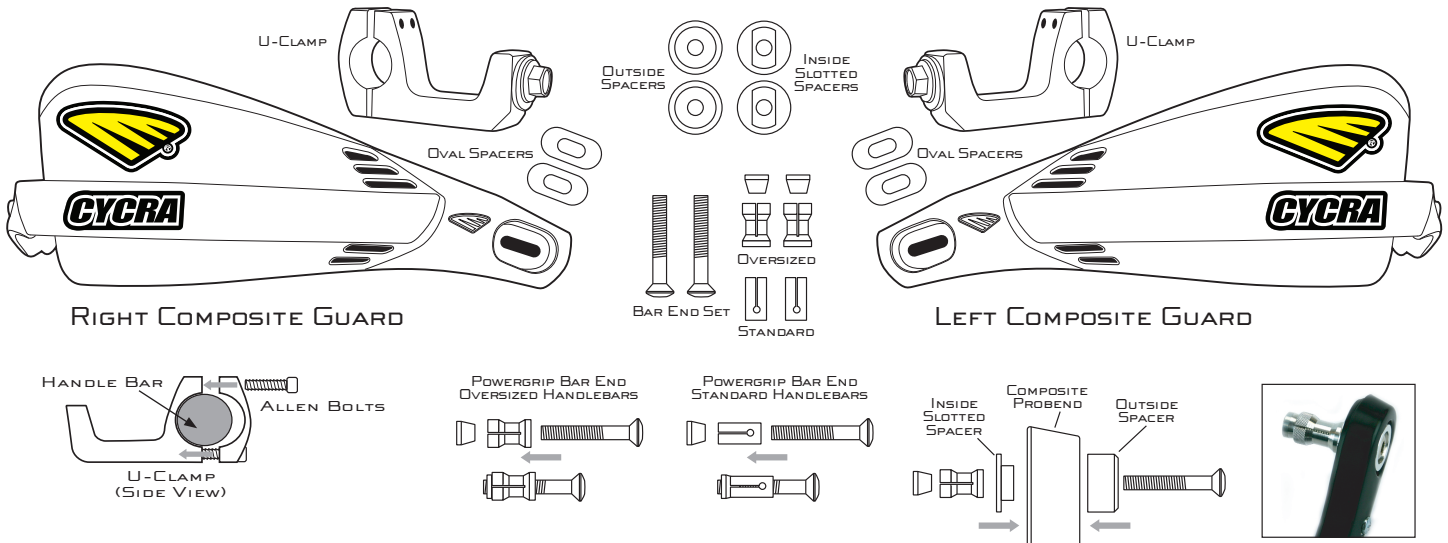

COMPOSITE PROBEND RACER PACK

THIS RACER PACK COMES COMPLETE WITH ALL MOUNTING HARDWARE, AND HANDSHIELDS.

THESE HANDGUARDS PROVIDE YOU WITH THE MAXIMUM AMOUNT OF FREEDOM COMBINED WITH SUPERIOR PROTECTION FROM THE ELEMENTS.



INSTALLATION INSTRUCTIONS:

- (FIGURE 1) INSTALL U-CLAMPS ONTO THE HANDLEBARS. PLACE THE TWO HALVES OVER HANDLEBARS AND TIGHTEN ALLEN BOLTS SLIGHTLY ALLOWING FOR ADJUSTMENT.
NOTE: STANDARD 7/8 U-CLAMPS ARE UNIVERSAL FIT. ALL OTHERS ARE RIGHT AND LEFT SPECIFIC.
- (FIGURE 2) INSERT OUTSIDE SPACERS INTO HOLE ON THE SIDE OF THE OUTSIDE OF THE COMPOSITE PROBEND BAR.
- (FIGURE 3) INSERT INSIDE SLOTTED SPACERS INTO SLOTTED HOLE ON THE INSIDE OF THE COMPOSITE PROBEND BAR.
- (FIGURE 4) INSTALL POWERGRIP BAR ENDS THROUGH THE BOTH SPACERS ON THE COMPOSITE PROBEND BAR.
NOTE: BOTH STANDARD AND OVERSIZED BAR END SLEEVES ARE PROVIDED. USE APPROPRIATE SLEEVE FOR YOUR APPLICATION.
- (FIGURE 5) CUT OUT THE ENDS OF THE HANDLEBAR GRIPS AND INSERT POWERGRIP BAR ENDS INTO HANDLEBAR ENDS. TIGHTEN BAR ENDS SLIGHTLY ALLOWING FOR ADJUSTMENT.
- (FIGURE 6) PLACE (2) OVAL SPACERS WITH THE FLANGES FACING INWARDS ON BOTH SIDES OF THE COMPOSITE PROBEND BAR.
- (FIGURE 7) INSTALL COMPOSITE PROBEND BARS ONTO U-CLAMPS USING THE 8MM BOLTS SUPPLIED.
- (FIGURE 8) ADJUST PROBEND BARS TO DESIRED POSITIONS, THEN TIGHTEN U-CLAMPS, 8MM BOLTS, AND BAR ENDS.
IMPORTANT: DO NOT SIEZE THROTTLE TUBE WHEN TIGHTENING BAR END!!!
- CHECK FOR TIGHTNESS AND ENSURE THAT ALL CONTROLS/CABLES WORK FREELY AND ARE CLEAR OF ANY OBSTRUCTIONS!!!

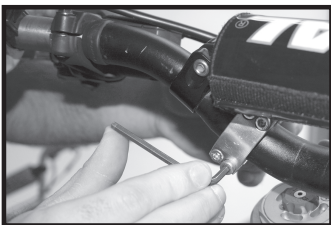

Figure 1



Figure 2



Figure 3



Figure 4

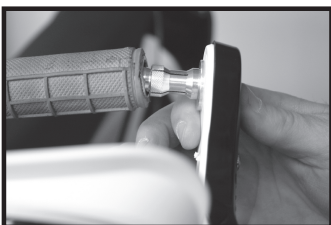

Figure 5

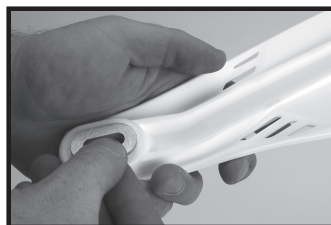

Figure 6



Figure 7



Figure 8

WARNING: PROBEND HANDGUARDS ARE DESIGNED FOR USE ON OFF-ROAD MOTORCYCLES ONLY. THEY ARE NOT DESIGNED FOR ANY OTHER PURPOSE OR ANY OTHER CLASS OF MOTORCYCLE. PROBEND HANDGUARDS ARE DESIGNED TO PROTECT FROM ROOST AND DEBRIS. HOWEVER, THEY MAY NOT PREVENT INJURY.

PROBEND IS A TRADEMARK DESIGN AND SHAPE - CYCRA DBA SV PLASTICS LLC