

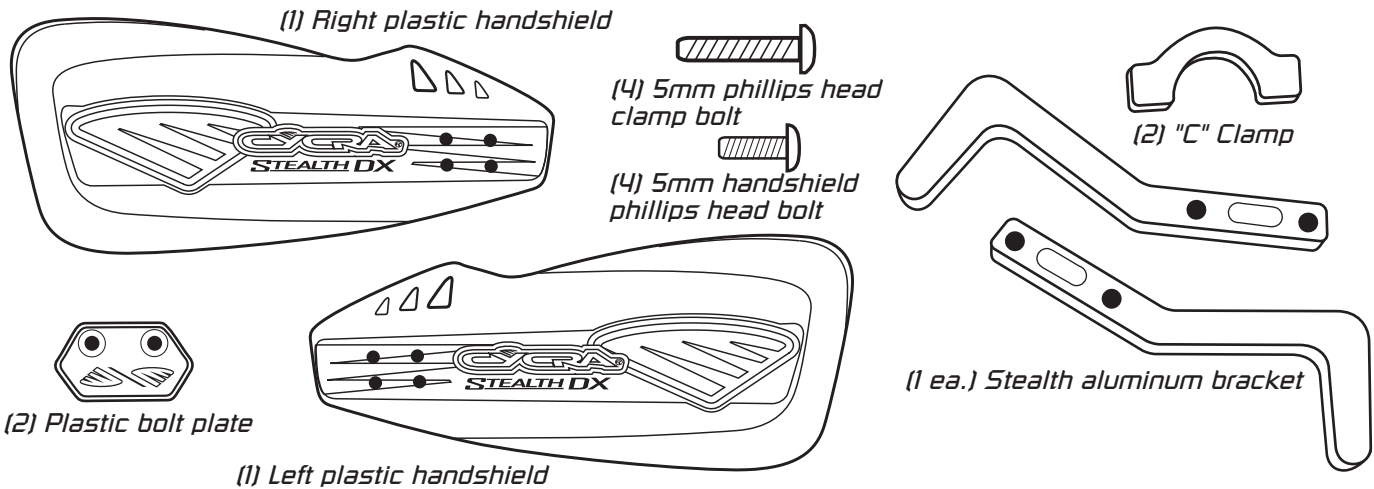

STEALTH DX HANDSHIELDS

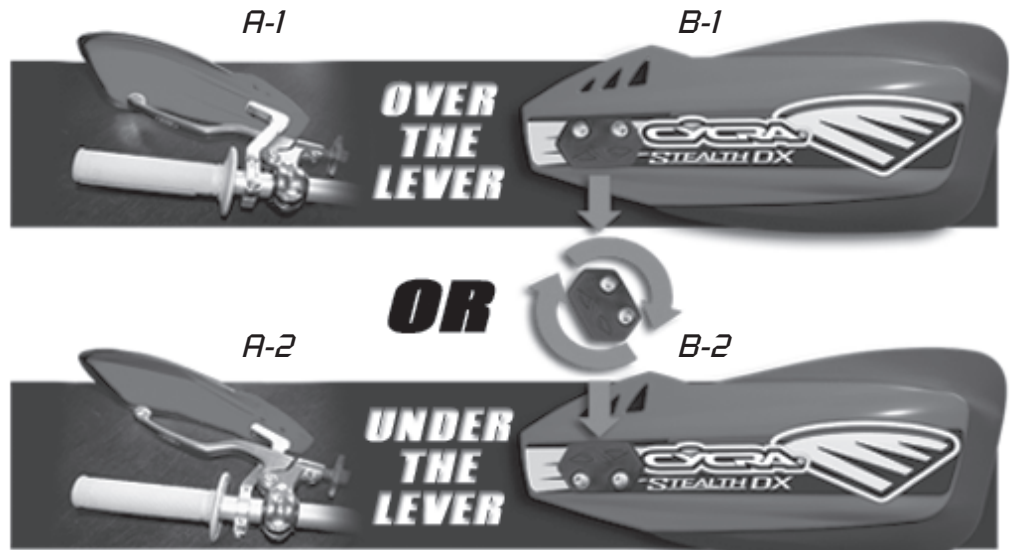

1 - At this time look over your bikes controls and decide which mounting method will work best for your specific needs. If you like your perch so your levers are low you may want to consider running the bracket over your levers (diagram A-1). If you like your perches so your lever are high you may choose to run the brackets under your levers (diagram A-2).



2 - No matter how you choose to mount your brackets the "L" should be open to the end of the handlebar.

3 - To begin the installation use the appropriate Stealth bracket, "C" clamp, and (2) 5mm phillips head clamp bolts. Position the Stealth Bracket between the lever perch and the grip. Secure around the handlebar by inserting 5mm bolts thru bracket and threading into "C" clamp. **Be cautious not to overtighten** - during a direct impact the bracket should rotate on handlebar keeping it from breaking or bending the aluminum.

4 - Follow this same procedure on the other side of the handlebar.

5 - Locate appropriate handshield and decide which mounting holes will position the handshield for best protection. Next, position plastic bolt plate over upper (B-1) or lower (B-2) mount holes of the plastic handshield and insert 5mm phillips head bolts through the bolt plate, through the handshield and thread into the aluminum Stealth bracket (C-1). It is a very highly suggested that thread lock or loc-tite be used in this step to keep the hardware from coming loose during riding.

6 - Follow this same procedure on the other side of the handlebar and be sure to check that all controls are free and clear of any obstruction. Now you should be ready to ride!

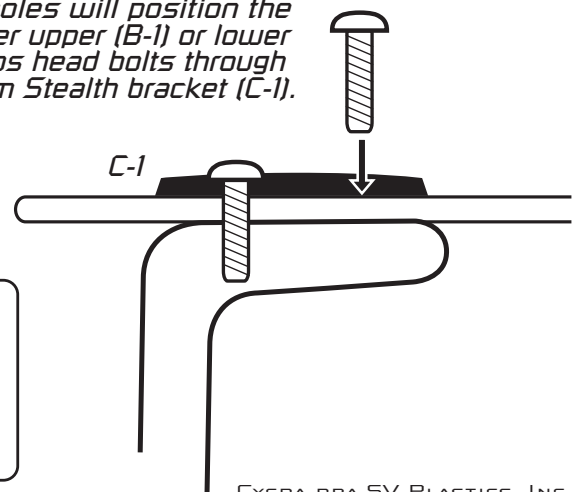

If you choose to mount under the lever you may need to use the provided plastic spacers to gain clearance and the long clamp bolts as well.



(2) Plastic Spacers



(4) 5mm phillips head long clamp bolt

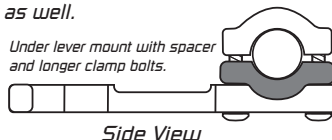

Under lever mount with spacer and longer clamp bolts.

Side View