

**FEEL THE HEAT!**

Revision No: 01  
Revision Date: 12-18-2018

## RZR 4 Doors

Part # **07-1802** Polaris RZR XP 4 1000 & Turbo (2015 - 2018) Black

Congratulations on your purchase of the DragonFire RZR 4 Doors! These doors have been specifically engineered to fit with OEM latches and hinges; OEM fit with full coverage. Be sure to check out the full line of DragonFire Accessories for your Polaris vehicle at your local authorized dealer or online at <http://www.DragonFireRacing.com>

### **WARNING**

- Read and understand these instructions before installing product
- This product does not provide roll over protection
- Ensure doors are securely latched and locked prior to operating vehicle
- Do not use product if there are any signs of damage, fatigue, or malfunction
- Intended for recreational use only

### Disclaimer

Off road activities can be hazardous and could lead to injury, dismemberment, paralysis and death. No warranty of representation is made as to the products ability to protect the user from any injury or death. The user assumes that risk. The acceptance and /or use of this merchandise purchased from DragonFire by the customer hereby shall release DragonFire from any and all liability pertaining to the use of such merchandise.

**Pre-installation:** Lay out components and compare to list and images. Images may not portray the full detail or exact shape of the parts; however, they represent parts that have same or similar function.

Refer to DragonFire Racing Website for ensure that you have the latest revision of instructions & templates.

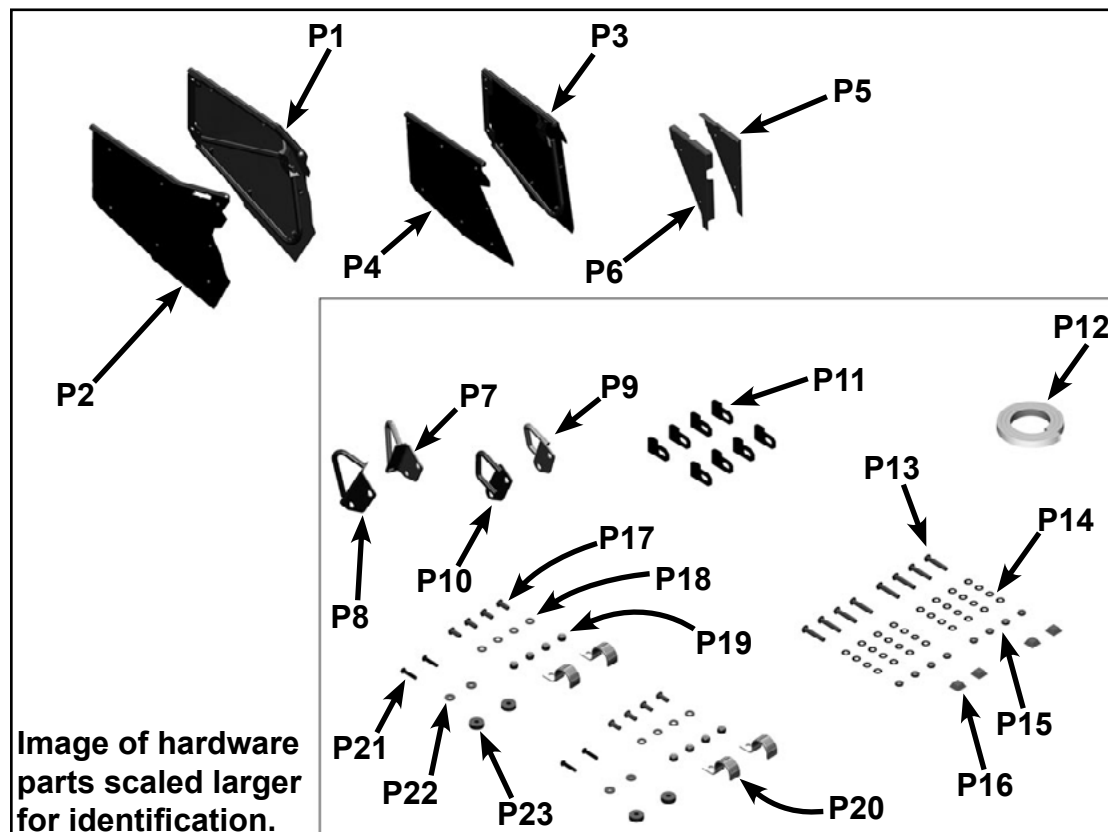

### Tools Required

T40 Torx
T27 Torx
T25 Torx
Hex Bit or Allen Wrench
13mm Wrenches
13mm Socket
Ratchet

**Note:** An assistant may be needed to hold the product in place during installation.

Part & Hardware List					
ITEM	QTY	SIZE	LENGTH	TYPE	STEP USED
P1	1	-	-	Front Door - Driver Side	11
P2	1	-	-	Front Door - Passenger Side	11
P3	1			Rear Door - Driver Side	18
P4	1			Rear Door - Passenger Side	18
P5	1	-	-	Filler Panel Driver	4
P6	1	-	-	Filler Panel Passenger	4
P7	1	-	-	Front Door Striker Pin Driver	13
P8	1	-	-	Front Door Striker Pin Passenger	13
P9	1	-	-	Rear Door Striker Pin Driver	19
P10	1	-	-	Rear Door Striker Pin Passenger	19
P11	8	-	-	Door Limit Bracket	15
P12	1	-	25"	Weatherstripping	3
Hardware List 1					
P13	8	M8 x 1.25	45mm	Button Head Cap Screw, Black	7
P14	32	M8	-	External-Tooth Lock Washer	7
P15	8	M8 x 1.25	-	Thin Jam Hex Nut	7
P16	4	1/2"	-	Square Adhesive-Back Bumper	22
Hardware List 2					
P17	8	M8 x 1.25	20mm	Button Head Cap Screw	4
P18	8	M8	-	Flat Washer, 16mm OD	4
P19	8	M8 x 1.25	-	Nylon Insert Locknut	4
P20	4	1-5/16"	-	Saddle Clamp, Vinyl Coat	3
P21	4	M6 x 1.00	30mm	Button Head Cap Screw	19
P22	4	M6	-	Flat Washer Oversized, 16mm OD	19
P23	4	.328"	5/16"	Aluminum Spacer, 3/4" OD	19

**Step 1:** Place vehicle on a flat and level surface. Place gear selector in "Park" and remove keys from the ignition.

**Step 2:** Start with one side: remove factory doors from the factory hinges and rear filler panel (Figure A). Retain factory hinge hardware for later use. The rest of the factory hardware & parts will not be use; discard if desire.

**Step 3:** Cut 2 weather stripping [P12] at approximately 4 to 5 inches and then place them on the frame where rear filler panel was removed. Install saddle clamp [P20] around upper tube of rear door frame. Make sure that the flat side of clamp faces outward and the round side faces inward (Figure B).

**Step 4:** Align Filler Panel [P5 or P6] onto the rear frame (Figure C). Align the hole on the panel to the hole on the clamp and then install using M8 x 20mm supplied bolt [P17], washer [P18], and locknut [P19]. Hand-tighten the hardware and then repeat clamp installation for the bottom hole.

**Step 5:** Tighten all hardware until Filler Panel is secured. **Do Not** overtighten hardware; overtightening will cause dimples in panel.



**Step 6:** Using a flat head screwdriver, remove c-clips retaining door hinge pins for upper & lower mounts (Figure D). Discard c-clips and pins.

**Step 7:** Remove and replace hinge pins with supplied hardware: M8 x 45mm long bolt [P13], lock washer [P14], and thin nut [P15]. We recommend applying threadlocker to the bottom of the new bolts. The bolt will push down through the hinge mount and will be secured with the lock washer and nut on the bottom side (Figure E). Slowly add increments of torque until the hinge bracket has reached the preferred amount of opening and closing resistance. Repeat for the rest of hinge brackets.

**Note:** This is the anti-rattle kit. It will prevent rattles in the hinge mounts.

**Step 8:** Remove the 2 factory bolts to the latch on the front door (Figure F). Retain bolts for reuse.



**Step 9:** Loosen or remove the 2 factory bolts near the latch on the front door (Figure G).

**Step 10:** Remove the factory bolt toward the middle and then remove the latch from the door (Figure H).

**Step 11:** Align latch to the DragonFire Front Door [P1 or P2]. Obtain the 2 factory bolts removed in Step 8 and then hand-tighten (Figure I).

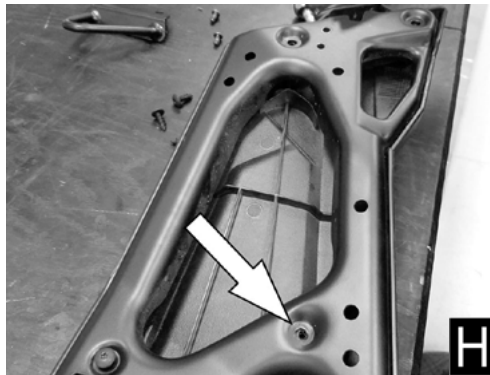
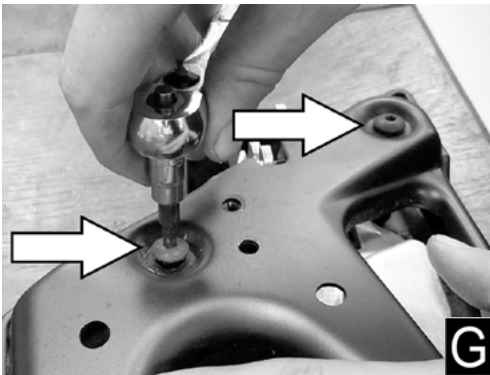

**Step 12:** Remove front factory striker pin (Figure J). Retain 2 factory bolts for reuse. The factory striker pin will be replaced.

**Step 13:** Obtain supplied front striker pin [P7 or P8] and hand-tighten using the 2 factory bolts from previous step (Figure K).

**Step 14:** Obtain DragonFire RZR Front Door [P1 or P2] with latch installed.





**Step 15:** Align slots on the door to the holes on the hinges. Place a Door Limit Bracket [P11] as shown (Figure L). Then loosely install the factory bolts removed in Step 2 (Figure M).

**Note:** For ease of installation, move the hinges to the open position (approximately 90° from the closing position).

**Step 16:** Repeat previous step for the lower hinge bracket (Figure N). Once done, install the other 2 factory bolts to the holes next to the brackets. Leave door hardware slightly loose for alignment with striker pin.

**Note:** For front door only, check the middle cross tube on door frame. If there is any gap between skin and frame, place a supplied weatherstripping (length 3" to 5") at the location to dampen any noise.

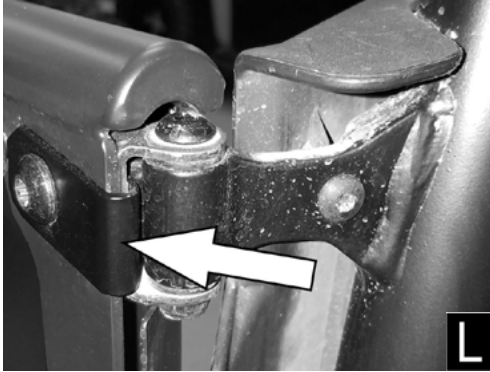

**Step 17:** Align and close the door. Once the door is closed and is at desired alignment, tighten all hinge hardware (Figure O). Tighten striker pin until it is fully secured and then open/close door to check for proper operation.

**Note:** If needed, hinge area on the door and the striker pin can be adjusted slightly.

**Step 18:** Uninstall factory latch from factory rear door (Figure O) and then install factory latch onto the DragonFire Rear Door [P3 or P4].

**Step 19:** Uninstall the rear factory striker pin. Install the supplied rear striker pin [P9 or P10] with the following hardware: 2 M6 bolts [P21], 2 washers [P22], and 2 spacers [P23]. Place spacers between the striker pin plate and the vehicle mount (Figure P).

**Step 20:** Repeat Step 15 to 17 for the DragonFire Rear Door (Figure Q).



**Step 21:** Inspect and tighten any loose door hardware until they are fully secured (Figure R).

**Note:** If the doors do not align to plastic as desired, the door can be adjusted by twisting or bending the frame.



**Step 22:** For Front Door only, place the adhesive side of the rubber bumper [P16] on the skin of the door (Figure S). Pinch the rubber bumper & skin hard to ensure it adheres to the surface.

**Step 23:** To not cause dimples, hardware attaching the door skin to door frame might be loose. Inspect hardware and tighten as necessary. Be careful not to dimple skin.

**Step 24:** Repeat step 2 to 23 for opposite side.

**Step 25:** This completes installation. Time to ride and enjoy!

**ProTip:**

- Periodically check all hardware and re-tighten if needed.
- If there is any vibration noise from the doors, use weatherstripping where appropriate to dampen noise.

For further assistance please contact us at [customerservice@dragonfireracing.com](mailto:customerservice@dragonfireracing.com) or 1-800-708-9803.

