

Thank you for purchasing this Dynojet kit. This kit has been developed for a motorcycle which is set to the parameters listed at the right in the "Stage" description. If your motorcycle does not meet any of these parameters please check with Dynojet before installation. For technical assistance contact your Dynojet distributor or call Dynojet U.S.A. (800)-992-4993

2191 Mendenhall Dr. Suite 105  
 North Las Vegas, NV 89031  
 TEL: 702-399-1423  
 FAX: 702-399-1431  
 8am-5pm Pacific Time  
 Monday through Friday

Website Address  
<http://www.dynojet.com>

The manufacturer and seller make no warranties express or implied which extend beyond the description of the goods contained herein. Any description of this product is for the purpose of identifying it and shall not be deemed to create an express warranty.



**1142.001**  
 U.S Models Only  
 1992-2004 Honda CB750  
 Nighthawk

**Stage 1**

For mildly tuned machines using the stock air-box, with stock or K&N filter. May also be used with a good aftermarket exhaust system  
 K&N filter #HA-7591

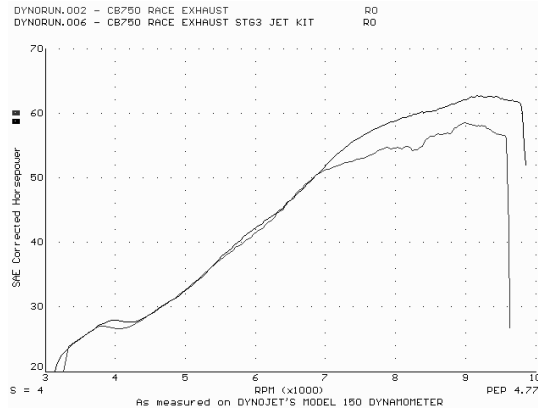

*This graph shows a typical gain with a Dynojet jet kit.*

# WARNING

**NO SMOKING!  
 NO OPEN FLAME!  
 WHILE INSTALLING  
 YOUR DYNOJET KIT**

Parts List		
4	Main Jets	DJ102
4	Main Jets	DJ106
1	Slide Drill	DD #7/64
4	Fuel Needles	DNO110
4	Adjusting Washers	DW0001
4	E-clips	DE0001
1	Plug Drill	DD #5/32
1	Screw	DS0001

## STAGE ONE INSTRUCTIONS

**DYNOJET**  
1142.001

1. Remove vacuum slides from carbs. Remove stock needles and spacers, noting order of assembly (Fig. A). Using drill bit provided (DD #7/64) to enlarge your slide lift holes. The picture may not show your slide exactly. Drill only the stock slide lift holes, do **not** drill the needle hole or any new holes. One lift hole may already be this size from stock, if so only one hole needs enlarged.

2. Install Dynojet needles on groove #2 from the top. Use all stock spacers (Fig. A). Install the small Dynojet washers above the E-clip. After installing the slide in the carbs be sure to check slide movement manually.

3. Remove the stock main jets and replace with Dynojet main jets provided. If you are running the stock exhaust use the DJ102 main jets. If you are running an aftermarket header or slip-on with high flowing baffle use the DJ106 main jets. Be sure that the jet you are changing is the main jet.

4. Locate the fuel mixture plug (Fig. B). If you see a screw head at Fig. B proceed to the adjusting procedure. With the 5/32 drill bit provided, carefully drill through the plugs. **NOTE:** The mixture screw is directly underneath this plug, be ready to pull back on the drill the instant you break through. Use screw provided to secure and remove this plug. Carefully turn mixture screws clockwise until lightly seated, then turn out 2-1/2 turns.

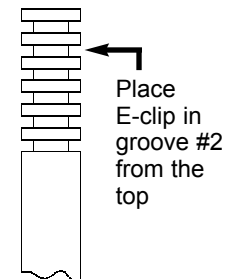

Fig. A

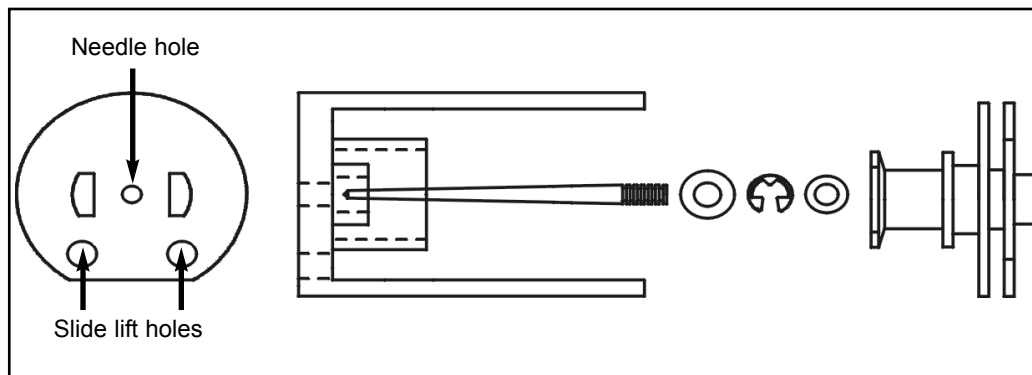

Fig. B

