

Thank you for purchasing this Dynojet kit. This kit has been developed for a motorcycle which is set to the parameters listed at the right in the "Stage" description. If your motorcycle does not meet any of these parameters please check with Dynojet before installation. For technical assistance contact your Dynojet distributor or call Dynojet U.S.A. (800)-992-4993

2191 Mendenhall Dr. Suite 105
North Las Vegas, NV 89031
TEL: 702-399-1423
FAX: 702-399-1431
8am-5pm Pacific Time
Monday through Friday

Website Address
<http://www.dynojet.com>

The manufacturer and seller make no warranties express or implied which extend beyond the description of the goods contained herein. Any description of this product is for the purpose of identifying it and shall not be deemed to create an express warranty.



3146.001

U.S. Models Only

1994-96 Suzuki RF600R

Stage 1

For mildly tuned machines using the stock airbox, with stock or K&N filter. May also be used with a good aftermarket exhaust system
K&N filter #SU-0004

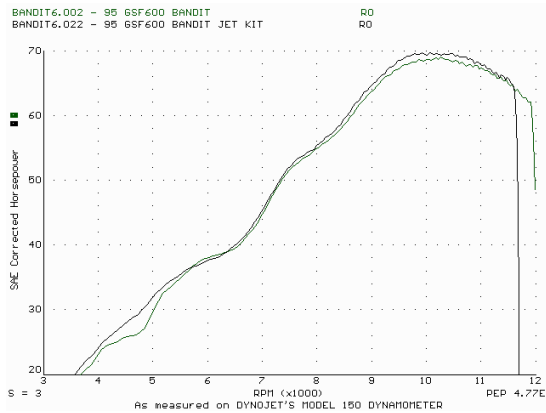

This graph shows a typical gain with a Dynojet jet kit.

WARNING

NO SMOKING!
NO OPEN FLAME!
WHILE INSTALLING
YOUR DYN0JET KIT

Parts List

4	Main Jets	DJ104
4	Main Jets	DJ108
4	Main Jets	DJ112
4	Fuel Needles	DNO361
4	Adjusting Washers	DW0001
4	E-Clips	DE0001
1	Plug Drill	DD #5/32
1	Screw	DS0001

STAGE ONE INSTRUCTIONS

1. Remove the vacuum slide from the carbs. Remove the stock needles & spacers, noting the order of assembly.
2. Install the Dynojet needles on groove #5, using all stock spacers (Fig. A). Install the Dynojet washer above the E-clip.
3. Install the Dynojet main jets provided. Use the DJ108 main jets with stock exhaust pipe, or use the DJ112 main jets with aftermarket header or slip-on with high flowing baffles. Be sure that the jets you are changing are the main jets.
4. Locate the fuel mixture plug (Fig. B), if you see a screw head, proceed to adjusting procedure. With the DD #5/32 drill bit provided, carefully drill thru the plugs. NOTE: the mixture screw is directly underneath this plug, be ready to pull back on the drill the instant you break thru. Use screw provided to secure and remove the plug. Carefully turn mixture screw clockwise until seated, then back out 2-1/2 turns.

DYNOJET

3146.001

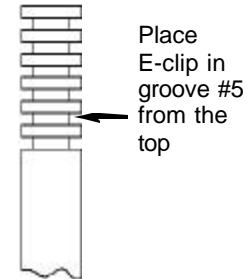

Fig. A

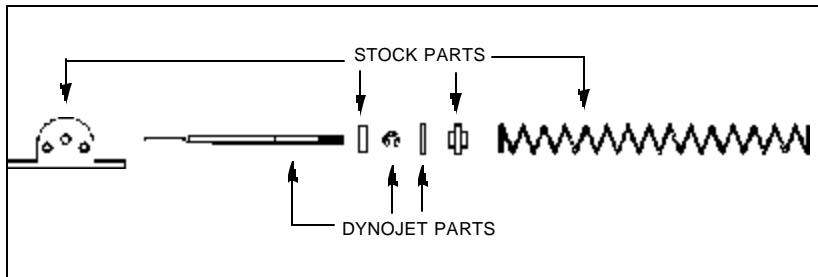

Fig. B

