

Q702.001

2000~2007 Bombardier

DS650

Stage 1&3

Stage 1

For mildly tuned machines using the stock airbox with stock or aftermarket filter. May also be used with a good aftermarket exhaust system.

Stage 3

For mildly tuned machines with the stock airbox removed and an individual K&N air filter. Should also be used with a good aftermarket exhaust system. K&N Filter # SN-2550.

<i>Parts List</i>		
1	Main Jet	DJ165
1	Main Jet	DJ170
1	Main Jet	DJ175
1	Main Jet	DJ180
1	Main Jet	DJ185
1	Main Jet	DJ190
1	Main Jet	DJ195
1	Main Jet	DJ200
1	Fuel Needle	DNO711
1	Needle Spring	DSP77
1	Adjusting Washer	DW0001
1	E-Clip	DE0001

STAGE ONE INSTRUCTIONS

1. Remove the top of the carb. Remove the slide spring, slide and needle noting order of the stock spacers (Fig. A).
2. Install the Dynojet needle on groove #2 from the top, using all stock spacers (Fig.A). NOTE: The needle spring (DSP77) does not need to be used at this time. It is supplied in case the stock spring is misplaced. Reinstall the slide, slide spring, and carb top.
3. Remove stock main jet (Fig.B). Install the Dynojet main jet. If you are running the stock exhaust use the DJ175 below 3000 feet, DJ170 from 3000 to 6000 feet and DJ165 above 6000Feet. If you are running a e slip-on exhaust, use the DJ180 below 3000 feet, DJ175 from 3000 to 6000 feet and DJ170 above 6000 feet. If you are using a full race exhaust with a high flow baffle us the DJ185 below 3000 feet, DJ180 from 3000 to 6000 feet and the DJ175 above 6000 feet. Be sure that the jet you are changing is the main jet.
4. Locate the fuel mixture screw (Fig.B). Using a flat blade screwdriver, turn the mixture screw clockwise until it lightly seats, then turn out 2 turns.

Fig.A

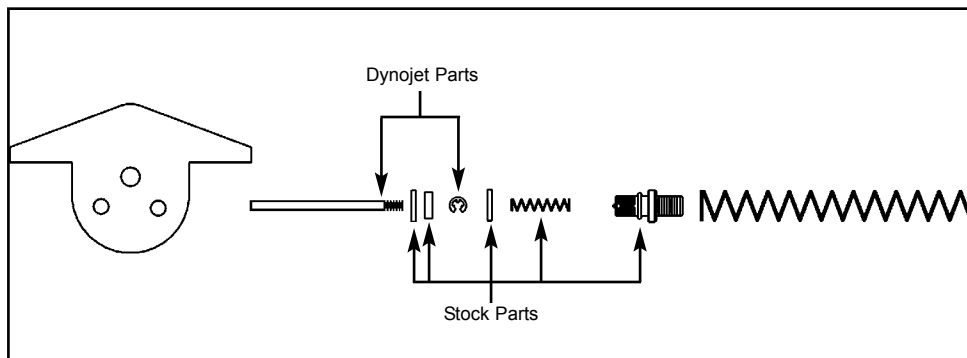

STAGE THREE INSTRUCTIONS

1. **Remove the airbox and install K&N filter SN-2550 on to the carburetor**
2. Remove the top of the carb. Remove the slide spring, slide and needle noting order of the stock spacers (Fig. A).
3. Install the Dynojet needle on groove #3 from the top, using all stock spacers (Fig.A). NOTE: The needle spring (DSP77) does not need to be used at this time. It is supplied in case the stock spring is misplaced. Reinstall the slide, slide spring, and carb top.
4. Remove stock main jet (Fig.B). Install the Dynojet main jet. If you are running the stock exhaust use the DJ185 below 3000 feet, DJ180 from 3000 to 6000 feet and DJ175 above 6000Feet. If you are running a slip-on exhaust, use the DJ190 below 3000 feet, DJ185 from 3000 to 6000 feet and DJ180 above 6000 feet. If you are using a full race exhaust with a high flow baffle us the DJ195 below 3000 feet, DJ190 from 3000 to 6000 feet and the DJ185 above 6000 feet. Be sure that the jet you are changing is the main jet.
5. Locate the fuel mixture screw (Fig.B). Using a flat blade screwdriver, turn the mixture screw clockwise until it lightly seats, then turn out 2 1/4 turns.

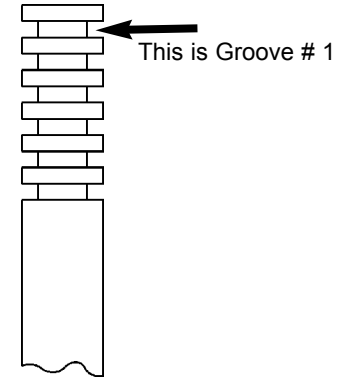

Fig.B

