

POWER COMMANDER 6

Installation Guide for: PC6-25032

Model Coverage: 2017-2023 Ski-Doo 850

PARTS LIST



- | | | | |
|---|--------------------|---|------------------------|
| 1 | POWER COMMANDER 6 | 2 | POWER COMMANDER DECALS |
| 1 | INSTALLATION GUIDE | 2 | VELCRO STRIPS |
| 1 | USB CABLE | 1 | ALCOHOL SWAB |
| 2 | DYNOJET DECALS | 1 | POSI-TAP |

**PLEASE READ ALL DIRECTIONS BEFORE STARTING INSTALLATION.
THE IGNITION MUST BE TURNED OFF BEFORE INSTALLATION.**



IPC6-25032.01



INPUT ACCESSORY GUIDE

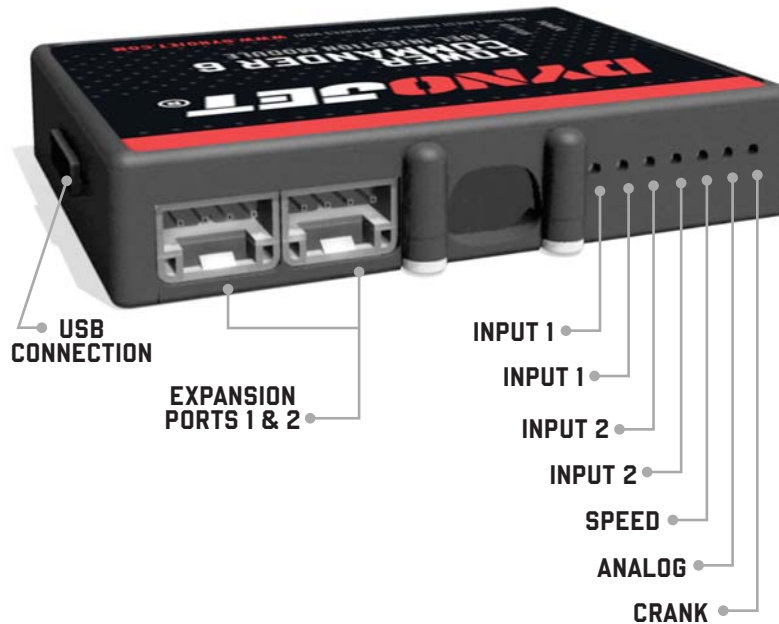

OPTIONAL ACCESSORY INPUTS

- Map** (Input 1 or 2) The PC6 has the ability to hold 2 different base maps. You can switch on the fly between these two base maps when you hook up a switch to the MAP inputs. You can use any open/close type switch. The polarity of the wires is not important.
- Shifter** (Input 1 or 2) Used for clutch-less full throttle upshifts. Insert the wires from the Dynojet quick shifter into either Input 1 or Input 2. The polarity of the wires is not important. Set to Input 2 by default.
- Speed** If your application has a speed sensor then you can tap into the signal side of the sensor and run a wire into this input. This will allow you to calculate gear position in the Control Center Software. Once gear position is setup you can alter your map based on gear position and setup gear dependent kill times when using a quick shifter.
- Analog** This input is for a 0-5v signal such as engine temp, boost, etc. Once this input is established you can alter your fuel curve based on this input in the Power Core software.
- Launch** You can connect a wire to either Input 1 or Input 2 and then the other end to a switch. This switch when engaged (continuity) will only allow the RPM to be raised to a certain limit (set in the software). When released, you will have full RPM.

WIRE CONNECTIONS

To input wires into the PC6 first remove the rubber plug on the backside of the unit and loosen the screw for the corresponding input. Using a 22-24 gauge wire, strip about 10mm from its end. Push the wire into the hole of the PC6 until it stops and then tighten the screw. Make sure to reinstall the rubber plug.

NOTE: If you tin the wires with solder it will make inserting them easier.



INSTALLING THE POWER COMMANDER 6



- 1 Remove both side panels and the clutch guard.



- 2 Remove the gauge.



- 3 Remove the hood.

- 4 Using the supplied velcro, secure the PC6 to the front of the oil tank or the plastic shield behind the oil tank as shown.

Make sure to clean both surfaces with the alcohol swab before attaching.

- 5 Route the PC6 harness inward toward the engine and up along the left frame spar.



- 6 Locate the 6-pin coil connector next to the oil tank.

- 7 Using the supplied posi-tap, attach the green wire from the PC6 harness to the orange/green wire within the coil connector as shown.

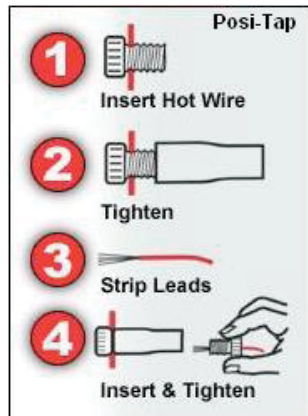

- 8 Continue routing the PC6 main harness up the left frame spar.
- 9 Attach the ground lug from the PC6 harness to the bolt securing the small supporting frame member (which also passes through the air box) as shown.
- 10 Slide the fuel tank back and pull the air box rearward from the throttle bodies to access the injectors.

Note: Removal of the air box is not required for installation but can assist in accessing the connectors.



- 11 Cross the PC6 harness over to the right side of the machine and route the harness down and behind the ECU to the throttle bodies.
- 12 Locate and unplug the booster injector connectors on the throttle bodies.
- 13 Attach the connectors with the yellow wires from the PC6 to the stock MAG injector connector and the MAG injector as shown.
- 14 Attach the connectors with the orange wires from the PC6 to the stock PTO injector connector and the PTO injector.

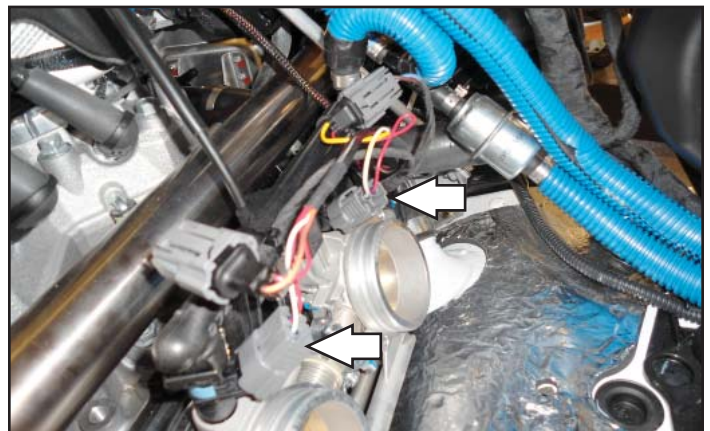

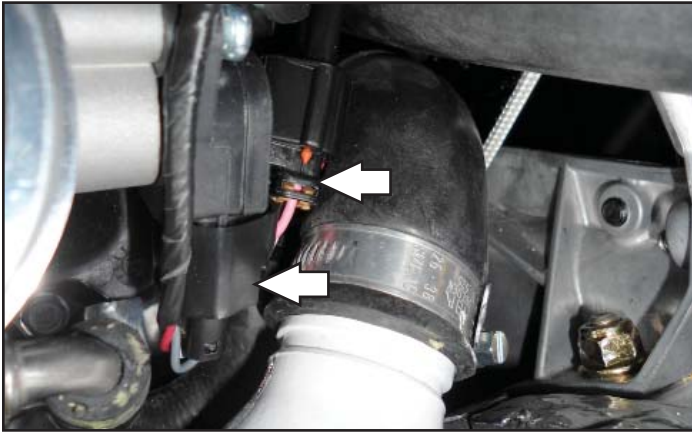

- 15 Locate and unplug the TPS connector located at the MAG end of the throttle body.
- 16 Attach the connectors from the PC6 to the TPS connector and TPS stock harness as shown.
- 17 Using the supplied zip ties, secure the PC6 harness in the engine compartment.
- 18 Replace the hood, gauge, clutch guard, and side panels.

Download the latest map files from our web site at dynojet.com/tunes.



**PUSH
THE
LIMIT**

2191 MENDENHALL DRIVE, NORTH LAS VEGAS, NV 89081 - 800-992-4993 - DYNOJET.COM
© 2017-2022 DYNOJET RESEARCH ALL RIGHTS RESERVED