

DRY-TECH® BAGS

MODULAR PACKING SYSTEM



BASE BAGS

TABLE OF CONTENTS

Meteor 25L Tail Bag	4
Reactor Saddlebags	6
Ballistic 50L Tail Bag	8
Slip-lock Strap System	10
Meteor/Meteor Combo	12
Meteor/Ballistic Combo	14
Meteor/Reactor Combo	16
Ballistic/Reactor Combo	18
Full Suite Combo	20

Meteor 25L Tail Bag



Meteor/Meteor Combo

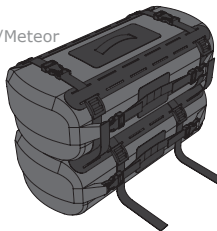

Ballistic/Reactor Combo

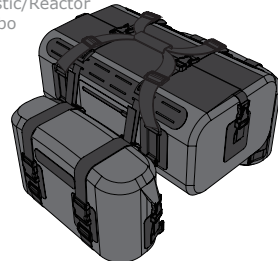

Reactor Saddlebags

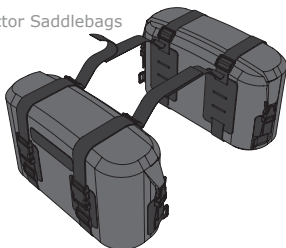

Meteor/Ballistic Combo

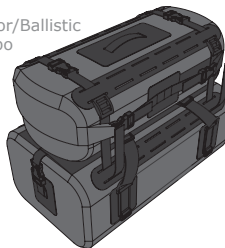

Full Suite Combo

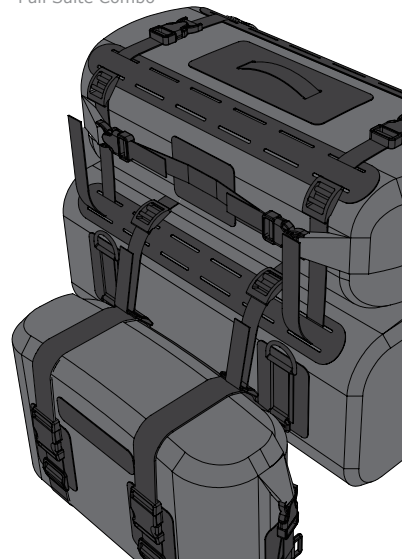

Ballistic 50L Tail Bag



Meteor/Reactor Combo

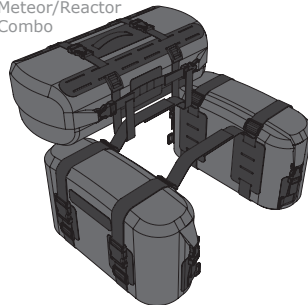

MODULAR PACKING

The three-bag Dry-Tech® Series system makes packing and organizing your gear easier, allows for quicker access, and enables strategic separation of your gear.

Each Joe Rocket Dry-Tech® Series bag is also designed to mount directly to your bike.

METEOR 25L TAIL BAG

BASE BAG

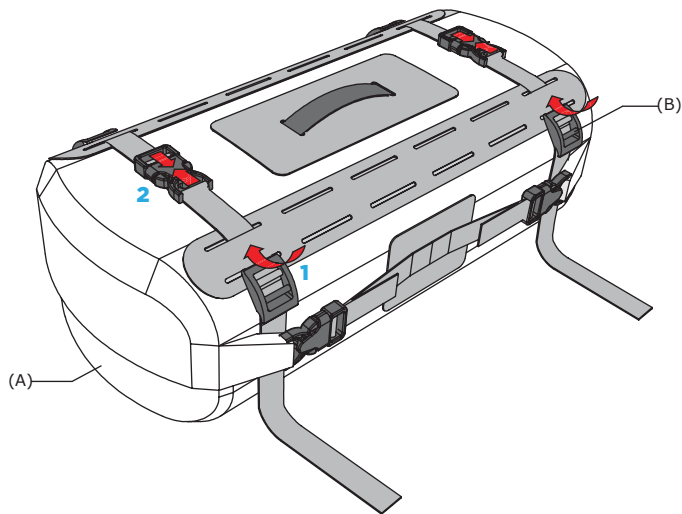

ASSEMBLY

Meteor Components

- (A) Meteor Tail Bag QTY 1
(B) Tension Lock Mounting Strap QTY 2

Step One: To install the tension lock mounting straps onto the tail bag, first disconnect the side release buckle at the center of each strap. Pass the side release buckle end of each strap under the daisy chain on the side.

Step Two: Reconnect the buckles at the center of the bag. The tension lock will remain on the outer side of the daisy chain. This enables the straps to stay in place on the bag when it is not mounted.

Note: There are plastic strap keepers on each of the roll-top closure straps to secure any excess webbing. For best results, fold the excess webbing up to 3 layers thick before tucking it under the tab on the strap keeper.

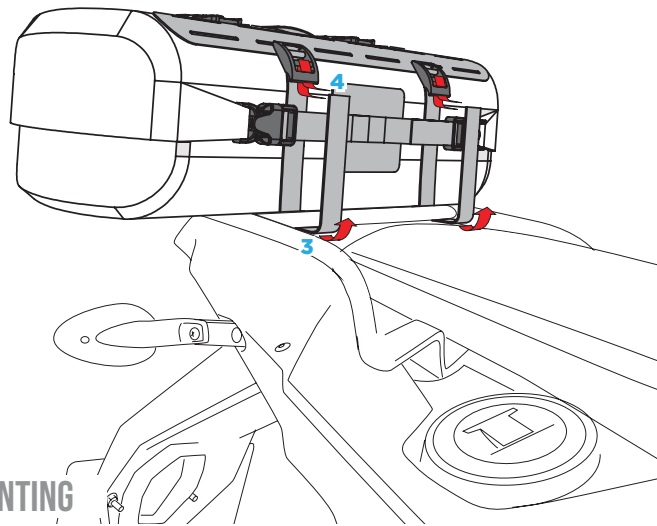

MOUNTING

Step Three: Pass the end of the tension lock mounting straps under your desired mounting point.

Step Four: Feed the strap end into the tension lock buckle, pass it over the middle bar, and exit the buckle the same place you came in.

Note: There are plastic strap keepers on each of the mounting straps to secure any excess webbing. For best results, fold the excess webbing up to 3 layers thick before tucking it under the tab on the strap keeper.

Tip: The straps that come with the bag are optimized for mounting to points directly under the bag minimizing excess webbing to manage. If you plan to mount your Meteor bag to points further away from the bag like the passenger foot peg (for example) you will need a longer universal mounting strap. These are available from your dealer.

REACTOR SADDLEBAGS

BASE BAG

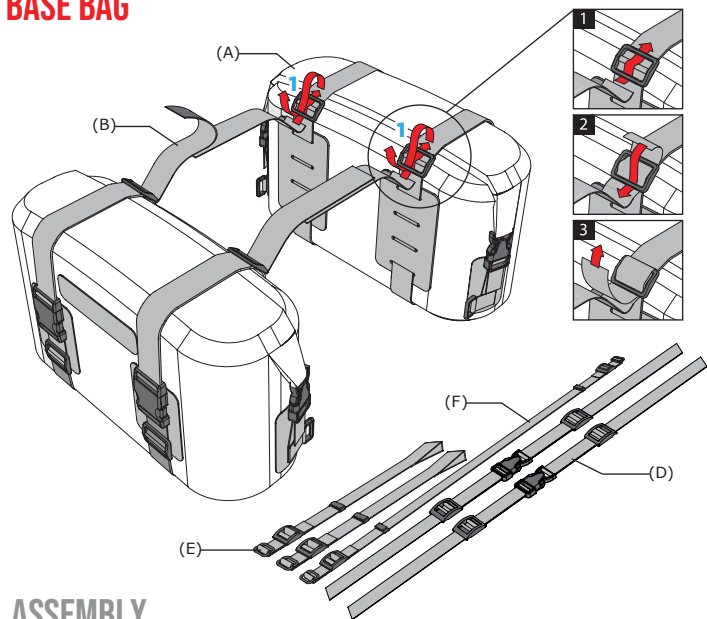

ASSEMBLY

Reactor Components

(A) Reactor Bag	QTY 2
(B) Velcro Center Strap	QTY 2
(C) Solid Nylon Center Strap	QTY 2
(D) Ballistic/Reactor Combo Strap	QTY 2
(E) Slip-Lock Mounting Strap(s)	QTY 2
(F) Dual-End Slip-Lock Strap.....	QTY 1

Step One: To install the center straps to the bag, feed the end of the strap through the 3-bar slide on the top rear of each compression strap. Use the velcro option for quick adjustability or use the nylon strap for extra security in muddy conditions. To adjust the length of either center strap, feed more of the strap end through the 3-bar slide. Strap (D) is designed for use as the center strap for the Ballistic/Reactor bag combo. See the Ballistic/Reactor Combo assembly page for details.

The center support strap options (B or C) connect the two bags together and are designed to be interchangeable.

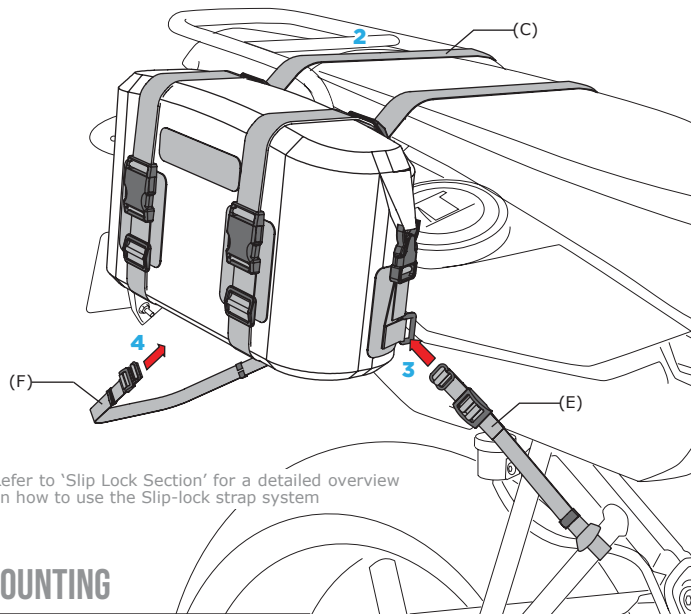

Refer to 'Slip Lock Section' for a detailed overview on how to use the Slip-lock strap system

MOUNTING

Step Two: Place the connected bags over the rear section of the bike. Adjust the center strap lengths to fix the height of the bags. **Tip:** You can secure excess webbing of the center strap by passing it back under the far side of the 3-bar slide.

Step Three: Pass the loop end of the slip lock strap (E) around the frame and then feed the slip-lock through the 1" plastic loop on the front side of the bags.

Step Four: Use the dual-end slip-lock strap (F) to connect the rear mounting points of the bags around the lower tail section of the bike. On most bikes the license plate bracket or tail light assembly create the perfect spot to loop the strap underneath. **Tip:** For best results, anchor the straps as low as possible so when you tension the straps it pulls the bags downward, not just front to back.

BALLISTIC 50L TAIL BAG

BASE BAG

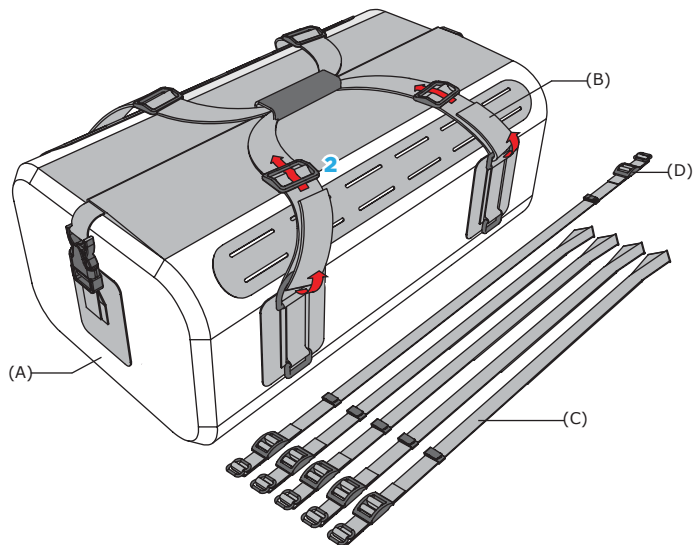

ASSEMBLY

Ballistic Components

(A) Ballistic Bag	QTY 1
(B) Removable Carry Handle	QTY 1
(C) Slip-Lock Mounting Strap (L)	QTY 4
(D) Dual-End Slip-Lock Strap	QTY 1

Step One: The carry handle is adjustable and removeable. To install the carry handle pass the end of the straps through the D-rings on the side of the bag.

Step Two: Feed the strap end through the 3-bar slide on each side of the carry handle.

Note: The carry handle can be adjusted all the way out to function as a shoulder strap, or adjusted all the way down to function as a grab handle while eliminating any excess webbing from blowing and tangling in the wind.

Tip: To adjust the handle length, hold the 3-bar slide and the webbing end at the same time, then slide all together up or down.

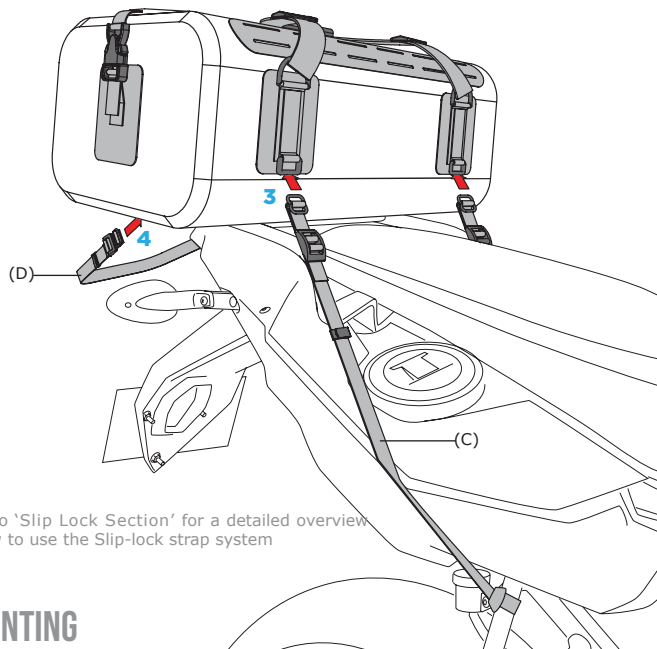

Refer to 'Slip Lock Section' for a detailed overview on how to use the Slip-lock strap system

MOUNTING

First decide whether you want to mount the bag parallel or perpendicular to your seat.

Step Three: Pass the loop end of the slip-lock strap (C) around the frame and then feed the slip-lock through the 1' plastic loop on the front side of the bag. Note: There are plastic strap keepers on each of the mounting straps to secure any excess webbing. For best results, fold the excess webbing up to 3 layers thick before tucking it under the tab on the strap keeper.

Step Four: For the rear mounting points you have the option of a regular slip-lock strap like the front, or a dual-end slip-lock strap. Use the dual-end strap if possible as it will make removing and attaching the bag faster. To use the dual-end slip-lock strap (D) connect the rear mounting points of the bags around the lower tail section of the bike. On most bikes the license plate bracket or tail light assembly create the perfect spot to loop the strap underneath.

SLIP-LOCK STRAP SYSTEM

HOW TO USE THE SLIP-LOCK STRAPS

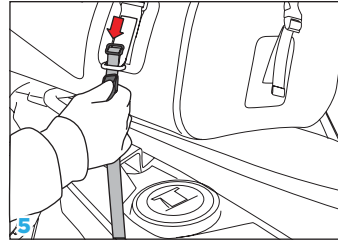
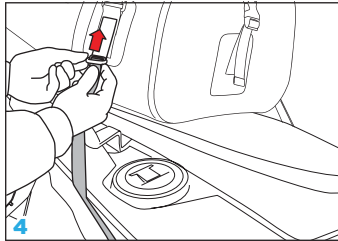
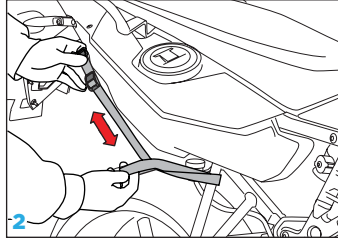
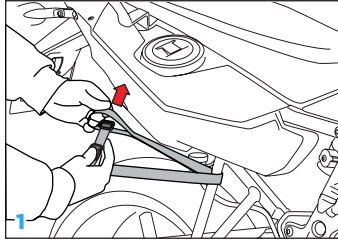

MOUNTING

Slip-lock mounting straps feature a 3/4" metal slip-lock at the end of each strap that is designed to mate with the 1" plastic loops on the bags. The straps create the most durable and most low-profile attachment system available. Slip-lock straps are included with the Reactor, Ballistic, and all modular combinations.

Step One: Identify the mounting points you plan to use for each of the four straps. Any closed part of the bike will work (like the frame or rear foot peg bracket).

Step Two: Wrap the loop-end around the mounting point then pass the slip-lock end through the loop. Pull the slip-lock end up towards the bag to secure the strap around the bike. Repeat this step for all four straps.

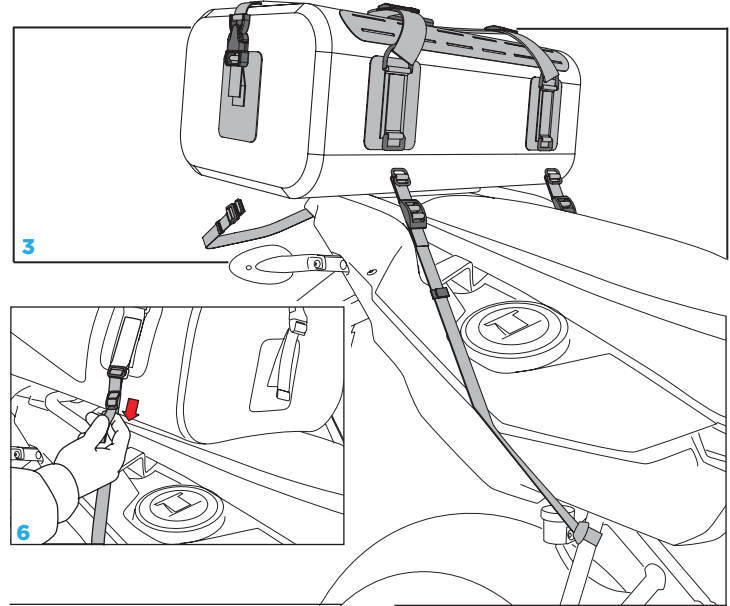

Step Three: Note: In many situations, the dual ended slip-lock strap is easier to use in place of the regular slip-lock straps on the rear. It creates a closed loop that can be passed under a license plate bracket or tail light assembly.

Step Four: With the slip-lock flat to the strap, pass the slip-lock completely through the underside of the plastic loop on the bag. Repeat this for all four straps.

Step Five: Once the slip-lock passes through the plastic loop, notice that it will not pass back through the loop without holding the slip lock flat to the strap with your other hand.

Step Six: Once all four slip-lock straps are attached to the bag pull the end of the strap downward to tighten the bag to the bike. Tuck the remaining strap ends under the plastic strap keepers to keep them from blowing and tangling in the wind.

METEOR/METEOR

MODULAR COMBINATION

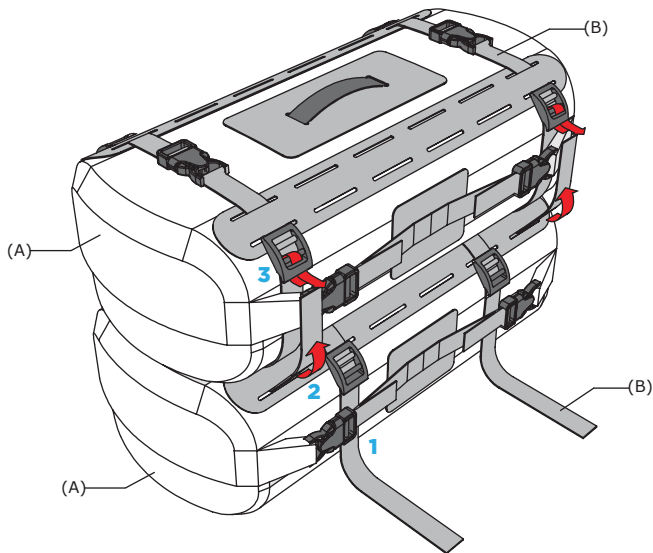

ASSEMBLY

Meteor/Meteor Components

- (A) Meteor Tail Bag QTY 2
- (B) Tension Lock Mounting Strap QTY 4

In this combo, the tension lock straps are used for both connecting the bags together as well as mounting the bags to your bike.

Step One: Make sure to install the tension lock straps to each bag as described on the Meteor page.

Step Two: Pass the end of the tension lock straps from the upper bag under and through the daisy chain on the lower bag.

Step Three: Then, feed the strap end into the tension lock buckle on the top bag, pass it over the middle bar, and exit the buckle the same place you came in. The tension lock straps from the lower bag will be used to mount this combo to your bike.

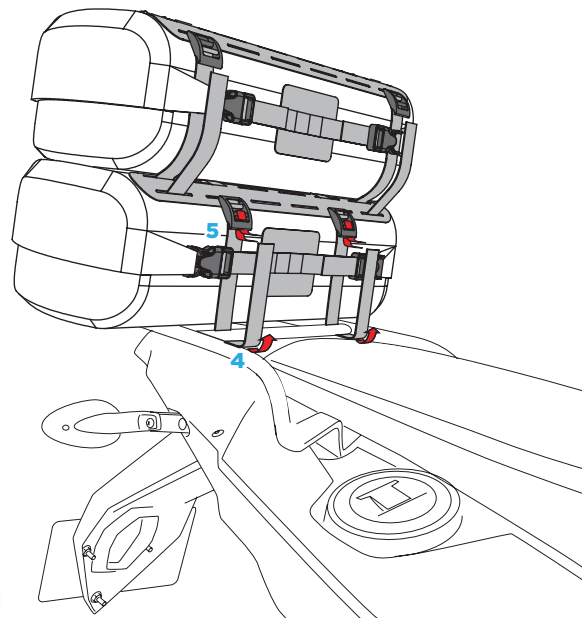

MOUNTING

Now that the bags are connected they can be quickly attached and removed from your bike as one unit.

Step Four: To mount this combo, pass the end of the tension lock straps from the lower bag under your desired mounting point.

Step Five: Then, feed the strap end into the tension lock buckle on the lower bag, pass it over the bar, and exit the buckle the same place you came in.

Note: There are plastic strap keepers on each of the mounting straps to secure any excess webbing. For best results, fold the excess webbing up to 3 layers thick before tucking it under the tab on the strap keeper.
Tip: Separate the two Meteor bags in the combo, to create the ideal expansion bag set to mount to the top of side panniers. The included tension lock straps are already optimized for this use, so no additional straps are necessary.

METEOR/BALLISTIC

MODULAR COMBINATION

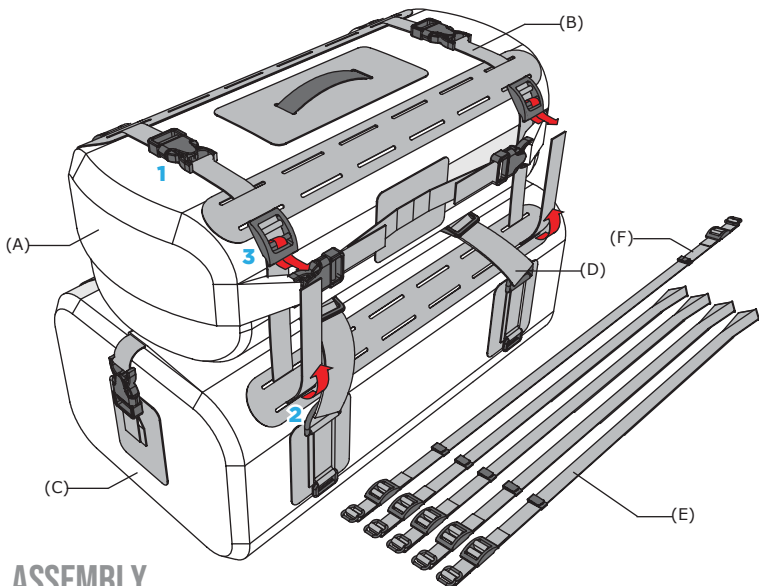

ASSEMBLY

Meteor/Ballistic Components

- (A) Meteor Tail Bag Qty 1
- (B) Tension Lock Mounting Strap Qty 2
- (C) Ballistic Tail Bag Qty 1
- (D) Removable Carry Handle Qty 1
- (E) Slip-Lock Mounting Strap (L) Qty 4
- (F) Dual-End Slip-Lock Strap Qty 1

Step One: First, make sure to install the tension lock straps on the tail bag as described in those instructions.

Step Two: Pass the end of the tension lock straps from the Meteor bag under and through the daisy chain on the Ballistic bag.

Step Three: Then, feed the strap end into the tension lock buckle, pass it over the middle bar, and exit the buckle the same place you came in. Fold any excess webbing up to three layers thick before tucking it under the strap keepers. Now that the bags are connected they can be quickly attached

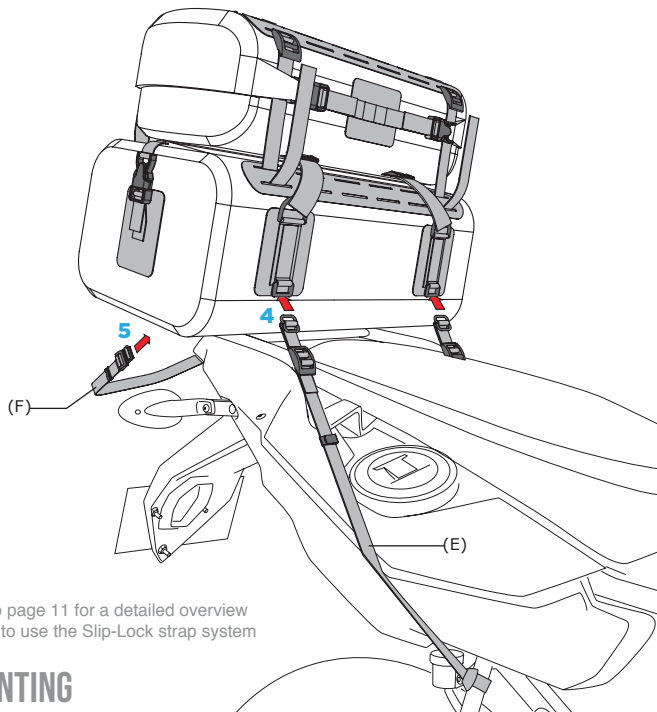

Refer to page 11 for a detailed overview on how to use the Slip-Lock strap system

MOUNTING

and removed from your bike as one unit using only the lower bags mounting straps.

Step Four: To mount the Meteor/Ballistic combo, pass the loop end of the slip-lock strap (E) around the frame and then feed the slip-lock through the 1" plastic loop on the front side of the Ballistic.

Note: For best results, fold the excess webbing up to 3 layers thick before tucking it under the tab on the strap keeper on the mounting strap.

Step Five: For the rear mounting points you have the option of a regular slip-lock strap like the front, or a dual-end slip-lock strap. Use the dual-end strap if possible as it will make removing and attaching the bag faster. To use the dual-end slip-lock strap (F) connect the rear mounting points of the bags around the lower tail section of the bike. On most bikes the license plate bracket or tail light assembly create the perfect spot to loop the strap underneath.

METEOR/REACTOR

MODULAR COMBINATION

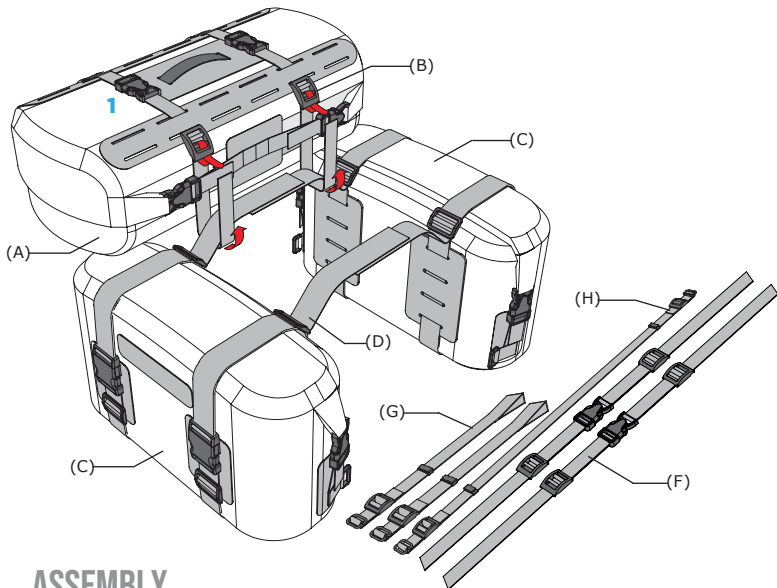

ASSEMBLY

Meteor/Reactor Components

(A) Meteor Tail Bag.....	Qty 1
(B) Tension Lock Mounting Strap.....	Qty 2
(C) Reactor Saddlebags.....	Qty 2
(D) Velcro Center Strap.....	Qty 2
(E) Solid Nylon Center Strap.....	Qty 2
(F) Ballistic/Reactor Combo Strap.....	Qty 2
(G) Slip-Lock Mounting Strap(s).....	Qty 2
(H) Dual-End Slip-Lock Strap.....	Qty 1

Note: The Meteor/Reactor combo can be assembled in both a parallel and perpendicular configuration (illustrated above). To assemble the parallel configuration (not shown) simply connect the tension lock straps from the tail bag through the 3-bar slides on the top rear of the saddlebags.

Step One: To assemble the Meteor/Reactor combo in a perpendicular configuration

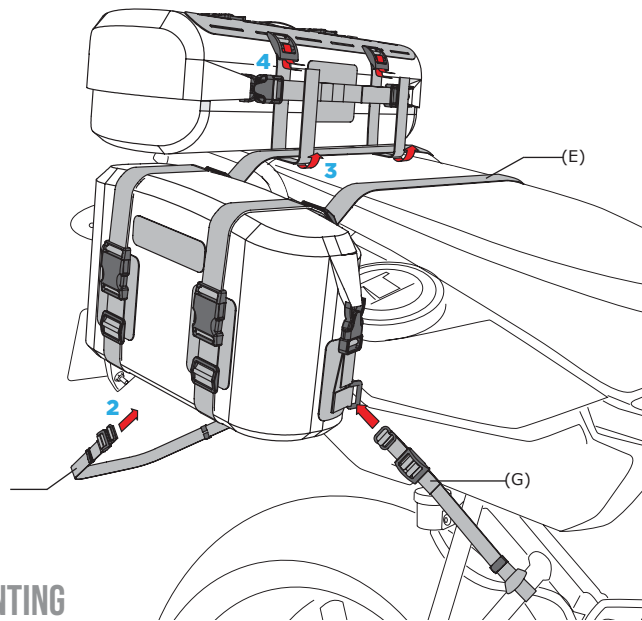

MOUNTING

(as shown) first install the tension lock straps on to the Meteor.

Step Two: Mount the saddlebags to your bike in the standard mounting orientation as described on its instruction page.

Step Three: Place the tail bag over the saddlebag center straps. Pass the end of the tension lock straps from the tail bag under the center straps on the saddlebags.

Step Four: Feed the strap end into the tension lock buckle, pass it over the middle bar and exit the buckle the same place you came in.

Tip: You can mount the front straps of the tail bag to the rear center strap of the saddlebags to create more space for you & your passenger. This is the ideal setup for the Meteor/Reactor combo if your bike has suitable mounting points for the rear tension lock straps of the tail bag to pass under.

BALLISTIC/REACTOR

MODULAR COMBINATION

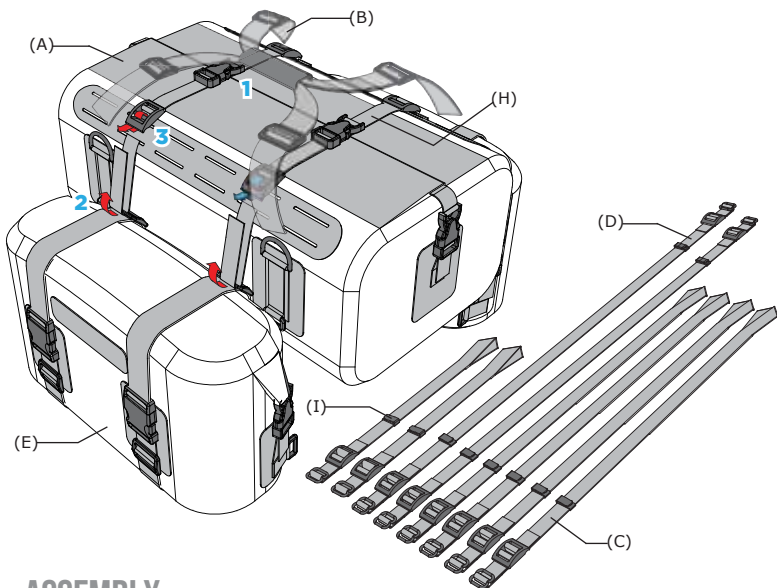

ASSEMBLY

Ballistic/Reactor Components

(A) Ballistic Bag	Qty 1
(B) Removable Carry Handle	Qty 1
(C) Slip-Lock Mounting Strap (L)	Qty 4
(D) Dual-End Slip-Lock Strap	Qty 1
(E) Reactor Saddlebags	Qty 2
(F) Velcro Center Strap	Qty 2
(G) Solid Nylon Center Strap	Qty 2
(H) Ballistic/Reactor Combo Strap	Qty 2
(I) Slip-Lock Mounting Strap (S)	Qty 2
(J) Dual-End Slip-Lock Strap	Qty 1

Step One: Install the combo strap to the tail bag. With the combo strap connected at the center, pass each end of the strap through the daisy chain from the center out.

Note: The tension lock buckle will remain on the outside of the daisy chain. This is important because it allows you to access the top of the tail bag without loosening your mounting tension of the combo.

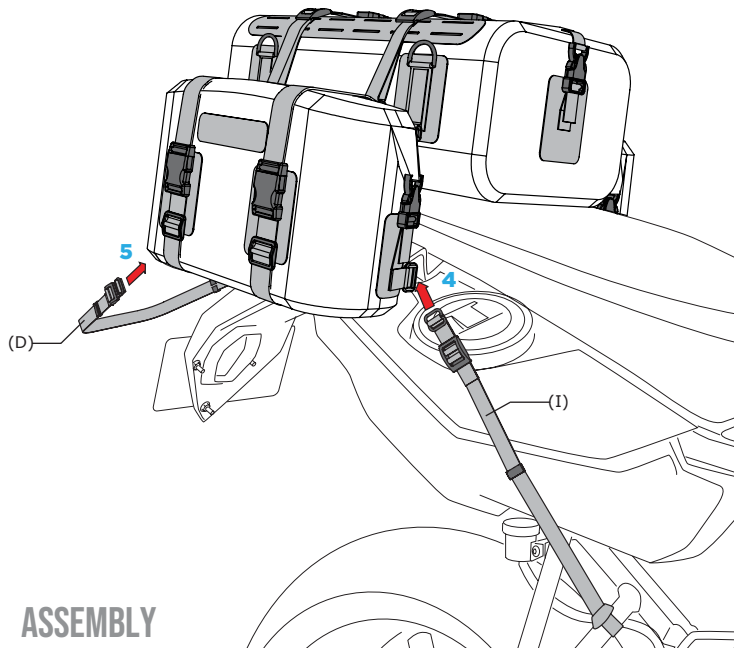

ASSEMBLY

Step Two: Pass the end of the combo straps from the tail bag under and through the top bar of the 3-bar slide on the back of the saddlebags.

Step Three: Then, feed the strap end into the tension lock buckle, pass it over the middle bar, and exit the buckle the same place you came in. Note: You can now adjust the height that the saddlebags are suspended from the tail bag at these tension lock buckles.

Now that the bags are connected they can be quickly attached and removed from your bike as one unit using only the lower bags mounting straps. Follow the instructions on the Reactor page to mount the Ballistic/Reactor combo the same way you would mount just the saddlebags.

Tip: For best results, anchor the straps as low as possible so when you tension the straps it pulls the bags downward, not just front to back.

FULL SUITE

MODULAR COMBINATION

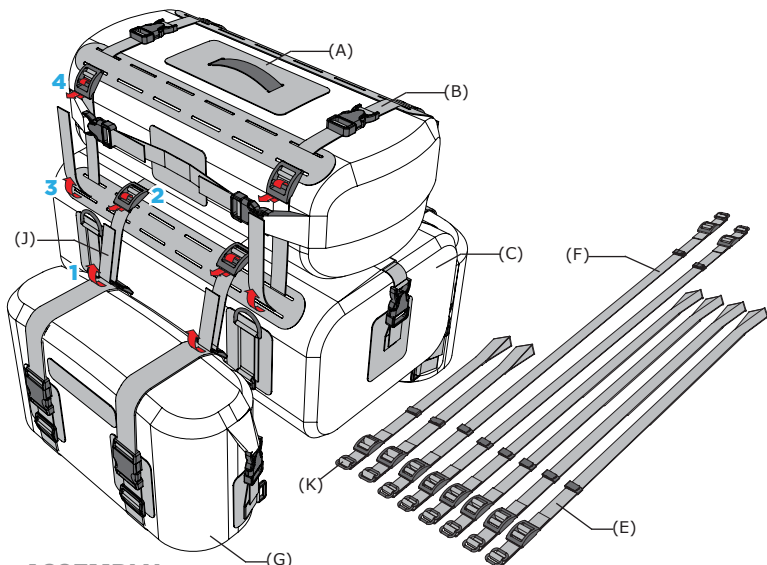

ASSEMBLY

Full Suite Components

(A) Meteor Tail Bag	Qty 1
(B) Tension Lock Mounting Strap	Qty 2
(C) Ballistic Tail Bag	Qty 1
(D) Removable Carry Handle	Qty 1
(E) Slip-Lock Mounting Strap (L)	Qty 4
(F) Dual-End Slip-Lock Strap	Qty 1
(G) Reactor Saddle Bags	Qty 2
(H) Velcro Center Strap	Qty 2
(I) Solid Nylon Center Strap	Qty 2
(J) Ballistic/Reactor Combo Strap	Qty 2
(K) Slip-Lock Mounting Strap(s)	Qty 2
(F) Dual-End Slip-Lock Strap	Qty 1

Step 1-4: To assemble the full suite first refer to the Ballistic/Reactor page to connect the saddlebags to the 50L tail bag. Then refer to the Atomic/Ballistic page to connect the 25L tail bag to the 50L tail bag. Now that the bags are connected into the full suite combo, they can be quickly attached and removed from your bike as one unit using only the lower bags mounting straps.

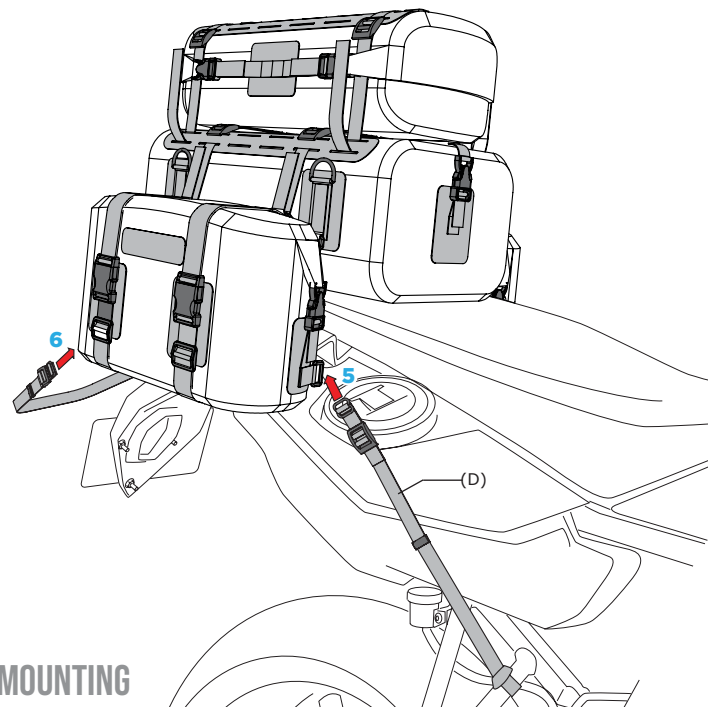

MOUNTING

Step 5-6: To mount the full suite, follow the instructions on the saddle bag page to mount the Ballistic/Reactor combo the same way you would mount just the saddlebags. **Tip:** For best results, anchor the straps as low as possible so when you tension the straps it pulls the bags downward, not just front to back.

Tip: Keep in mind that complete strap sets for all three bags are included in the full suite combo. You will only need to use the straps shown above to assemble and mount the full suite. This also means you can use each of the bags individually or assembled into any of the modular combos illustrated in this manual. Refer back to each base bag and combo bag pages for detailed instruction on assembly and mounting.