

FAIRLEAD PLOW PULLEY (STANDARD/WIDE)

Pulley Bracket Part # 105270, 105465
 Hardware Kit: HK-138

Kit Components:

Qty.	Part Description
1.....	Pulley Bracket
2.....	Nylon Spacer
1.....	Nylon Bushing
1.....	KFI Pulley
1.....	3/8"-16 X 1 1/2" Carriage Bolt
1.....	3/8"-16 Nylock Flange Nut
2.....	3/8"-16 X 3/4" Bolt
2.....	3/8" Lock Washer
2.....	3/8"-16 Jam Nut
2.....	3/8" SAE Washer

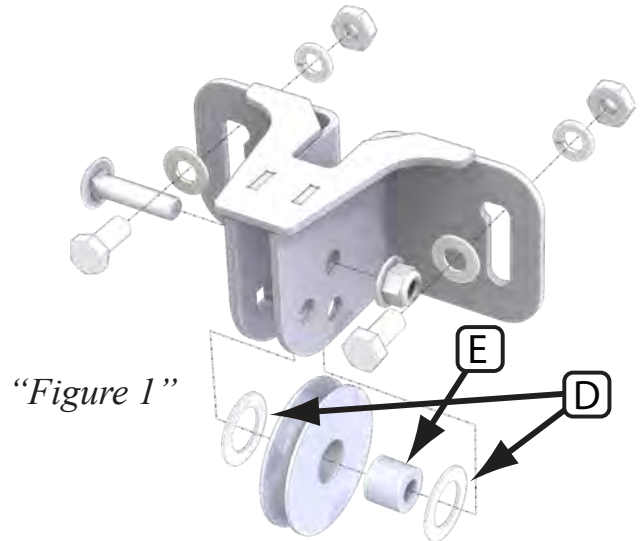

“Figure 1”

INSTALLATION INSTRUCTIONS:

1. Place cable over pulley and decide if upper (A), lower (B) or forward (C) position is best for your winch.

Note: Keep in mind that your cable needs to clear your fairlead bracket.

2. Install Nylon Spacers (D) and Nylon Bushing (E) to Pulley as shown in Figure 1.
3. Place cable over pulley and install to Pulley Bracket using the 1 1/2" Carriage Bolt and Flange Nut as shown in Figure 1.
4. Loosely install 3/8" bolt, washer, lock washer and nut (F) through fair-lead bracket and pulley bracket as shown in Figure 1&3. Slots have been cut into the brackets to adjust for clearance of plastic on the machine.

Note: You may also need to use the forward position (C) to clear the plastic.

5. Once desired position is found tighten down all nuts.
Note: Make sure the cable is as close to 90 degrees from the ground as you can get it. Most plows come with 3 or more hook points for winches that are offset from the center of the machine.

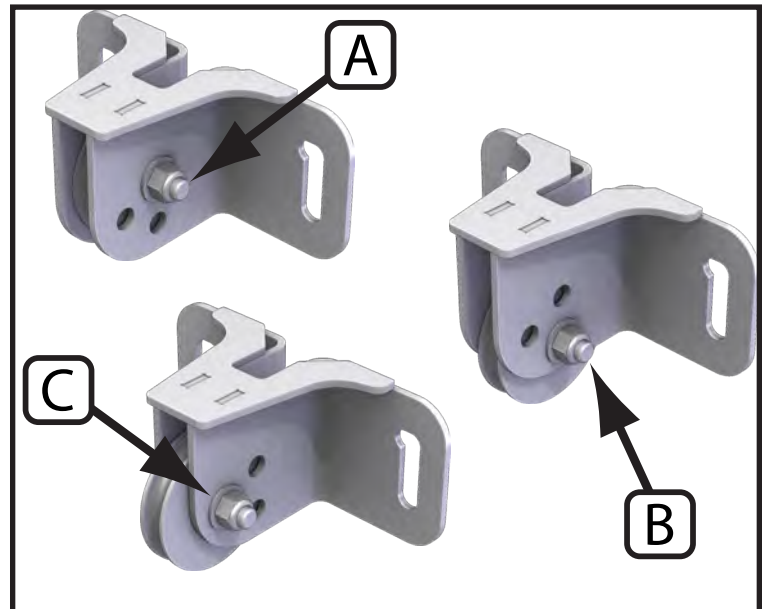

“Figure 2” Pulley Position

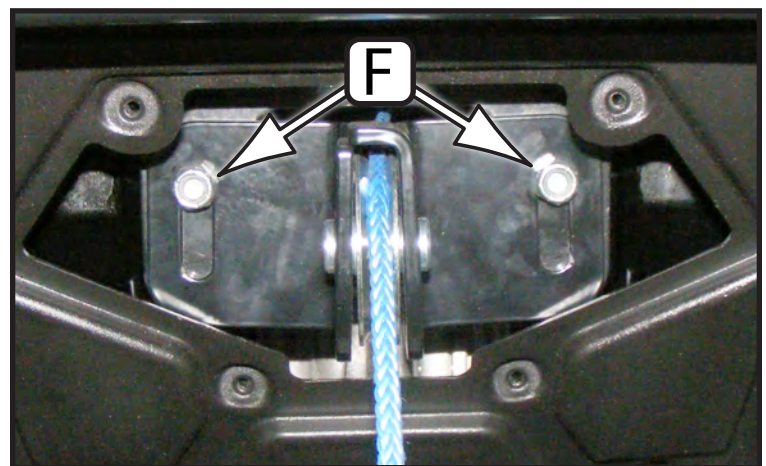

“Figure 3” Pulley Bracket Install

