



MID-MOUNT KIT

FOR HONDA ATV's

P/N 15-1591

ASSEMBLY / OWNERS MANUAL

Application

PLOW PUSH FRAME NO. 15-0070, 33-0000 or 33-0070

Before you begin, please read these instructions and check to be sure all parts and tools are accounted for. The following instructions contain details required to install and service the contents of this kit.

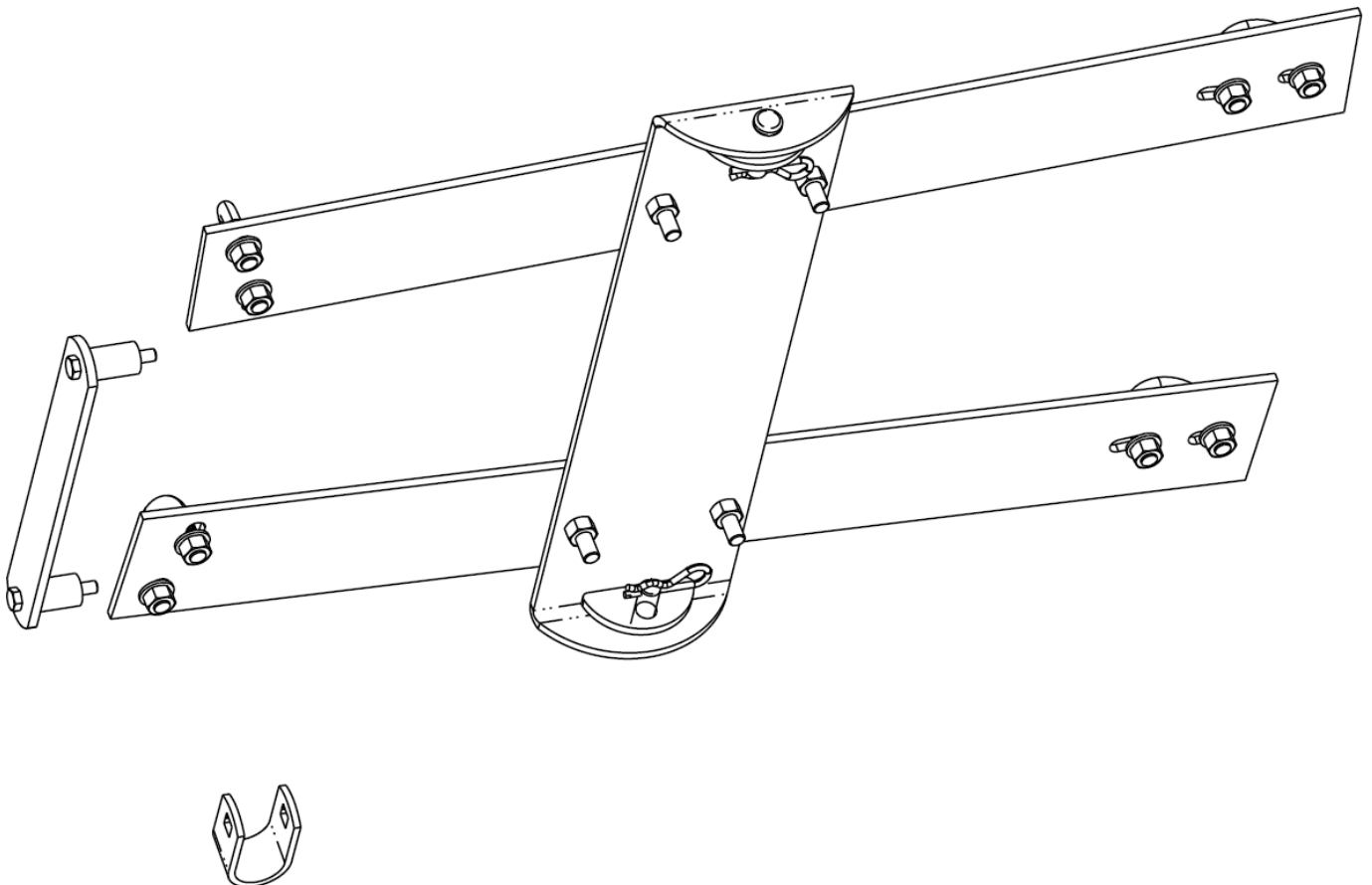

OPERATING INSTRUCTIONS

Congratulations! You've just purchased the most durable plow component in the industry. Kolpin plow components work great for summer or winter plowing. With proper care and maintenance, your Kolpin plow system will last for years to come!

NOTICE

Plow operation requires additional components for operation: *Kolpin Plow Blade, Kolpin Plow Push Frame, High Rise Plow Push Frame, Winch Kit* and/or manual lift*

**These components may be specific to your vehicle.*

Please read and understand all assembly instructions, notices and warnings before assembling and operating your Kolpin plow system.

Follow these guidelines to ensure satisfactory operation:

- Read this manual and your ATV/ UTV operators manual before use.
- Periodically check for wear and tightness of all fasteners. Replace or re-torque fasteners as necessary.
- Before first use, set plow in the furthest right or left angled position to check for interference with the vehicle.
- Operate with extreme caution on slopes and rough terrain. Be familiar with the area before you plow.
- Be aware of immovable objects that could be hidden in the area you are plowing.
- To avoid damage when pushing snow into a pile, reverse direction before raising the plow blade.
- Do not ram the plow blade into piles of snow.
- For best results, set the suspension preload of your ATV/ UTV to the stiffest setting.
- To reduce steering effort and increase mobility, set the air pressure of your tires to the maximum pressure specification.
- The plow skids are adjustable. General skid setting is even with the plow wear bar bottom edge, higher settings reduce the chance of rocks and gravel from being collected.
- To increase traction during plow operation, operators can try: Securing weight to the ATV/ UTV for additional tire downforce, reducing tire air pressure, or installing tire chains.

SAFETY INFORMATION

Our plow systems were designed with your safety in mind. Please read and understand all Cautions, Notices and Warnings in this manual before you begin. In order to protect you and your ATV/UTV, certain parts of the plow system and/or hardware are designed to fail when the equipment is over-stressed.



DANGER



TO AVOID SERIOUS INJURY OR DEATH:

1. **DO NOT EXCEED 5 MPH (8 KMH) WITH BLADE INSTALLED.**
2. **OPERATE WITH EXTREME CAUTION ON SLOPES, STEEP GRADES, AND ROUGH TERRAIN.**
3. **ALLOW NO RIDERS ON BLADE OR ATV/UTV WHILE MOVING OR STATIONARY.**
4. **KEEP BYSTANDERS AWAY FROM THE BLADE OR ATV/UTV WHILE MOVING OR STATIONARY.**
5. **WHEN PUSHING HEAVY MATERIAL, DIRECTION CONTROL MAY BECOME DIFFICULT.**
6. **BEFORE ADJUSTING BLADE: STOP ATV/UTV ENGINE; SET AND LOCK BRAKES; RAISE AND LOCK BLADE IN UP POSITION. DO NOT ATTEMPT TO RAISE BLADE BY HAND; USE THE LIFT MECHANISM ONLY.**
7. **LOWER BLADE TO DOWN POSITION WHEN BLADE AND ATV/UTV ARE NOT IN USE.**
8. **READ BLADE'S INSTRUCTION SHEETS AND ATV/UTV OWNER MANUAL.**

Kit Contents:

Item	Qty	Part Description	Part Number
1	1	Blade Mount Weldment	-
2	2	Attaching Bracket	CYC4703
3	1	Strap Protecting Bracket	-
4	1	1" U-Clamp	-
5	2	Clevis Pin, Zinc Plated, 10mm x 35mm	PUR1209
6	2	Hair Pin, Zinc Plated, #3	PUR1249
7	2	Hex Bolt, Zinc Plated, M6-1.0 x 40mm	PUR3006
8	8	Hex Locknut, Zinc Plated, M8-1.25	PUR3068
9	4	U-Bolt, Zinc Plated, M8-1.25 x 35mm x 50mm	PUR3191
10	4	Carriage Bolt, Zinc Plated, M8-1.25 x 20mm	PUR3052
11	8	Flat Washer, Zinc Plated, M8	PUR3087
12	1	Instruction Guide (not shown)	-

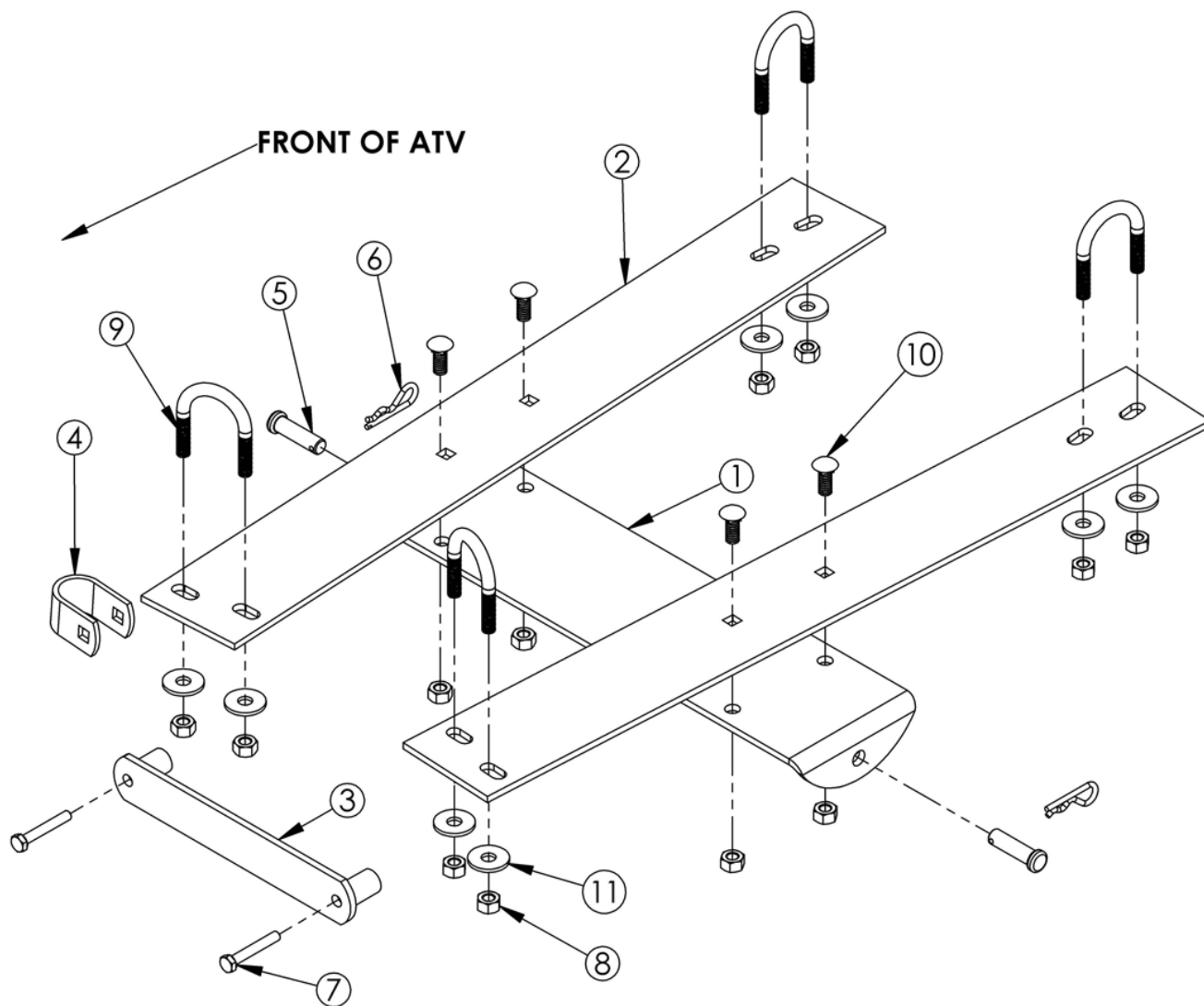

BEFORE YOU BEGIN:

- Your Kolpin accessory is exclusively designed for your vehicle
- Please read and understand all instructions
- Verify all parts and tools are accounted for
- To ensure a satisfactory installation, follow all steps correctly and in the sequence described
- Keep these instructions for future reference or for informational requests
- To facilitate installation, make sure that your vehicle is clean and free of debris
- All directions referring to right and left are when the rider is sitting on the machine

TOOLS REQUIRED:

- Basic Metric Hand Wrench and Socket Set
- Torque Wrench
- Do Not use impact tools to install hardware

APPROXIMATE ASSEMBLY TIME: 15 minutes

Note: If any hardware is missing, do not return to the store. Call us to help, Toll Free 1-877-956-5746.

SPARE KITS		Hardware kit
Item	Description	P/N CYC5769
5	Clevis Pin, Zinc Plated, 10mm x 35mm	2x
6	Hair Pin, Zinc Plated, #3	2x
7	Hex Bolt, Zinc Plated, M6-1.0 x 40mm	2x
8	Hex Locknut, Zinc Plated, M8-1.25	8x
9	U-Bolt, Zinc Plated, M8-1.25 x 35mm x 50mm	4x
10	Carriage Bolt, Zinc Plated, M8-1.25 x 20mm	4x
11	Flat Washer, Zinc Plated, M8	8x

Mount Plate Installation Prep:

1. Pre-assemble blade mount (item #1) and attaching brackets (item #2) using the carriage bolts (item #10) and locknuts (item #8) as shown. (See illustration 1-1). **Note, do not fully tighten carriage bolts at this time.**

Mount Plate Installation:

1. Place u-bolts (item #9) around the frame in the locations shown.
2. Place the rear holes of the support brackets over the u-bolts just installed and loosely secure with the locknuts (item #8).
3. Raise the front of the attaching bracket to the ATV frame and secure with the u-bolts and locknuts as shown. (See illustrations 1-2 and 1-3).
4. Tighten all fasteners to specification.

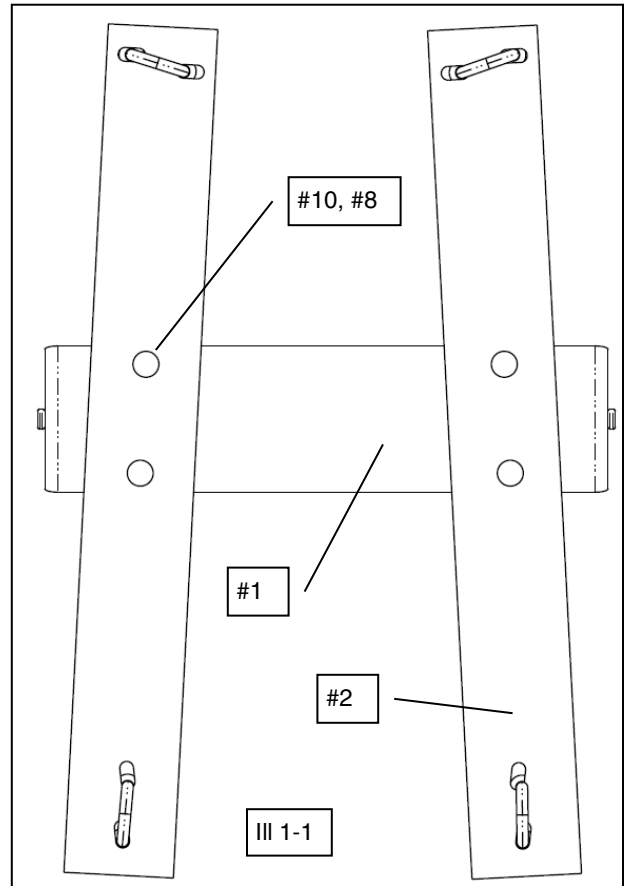

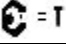
 = T
8MM FASTENER TORQUE: 17 ft. lbs. (23 Nm)

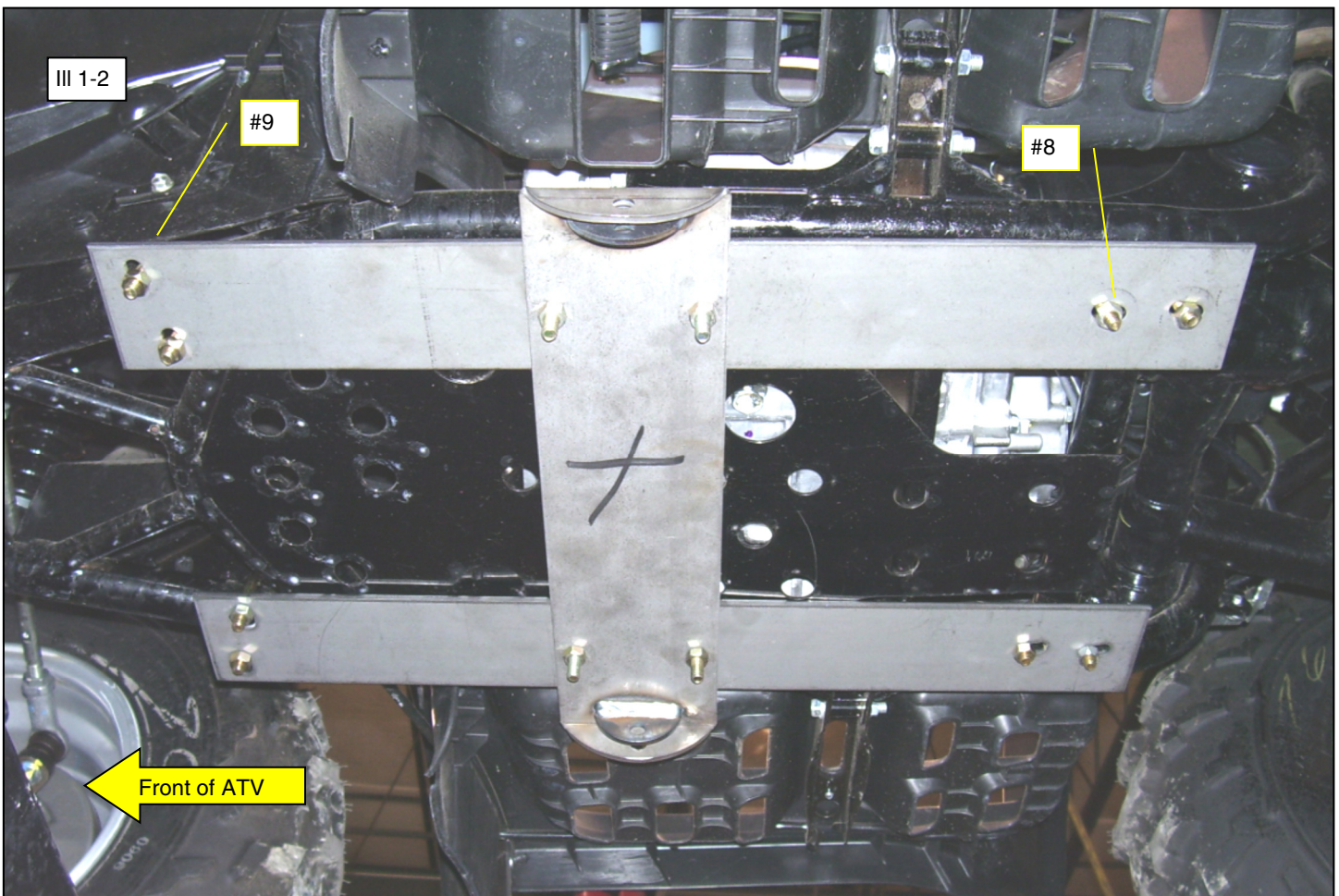

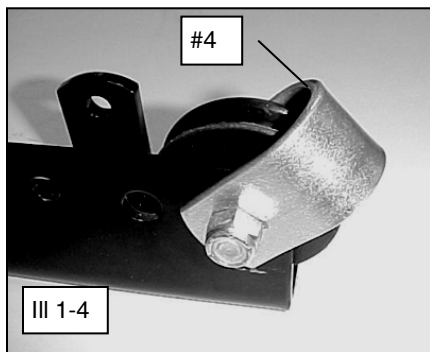
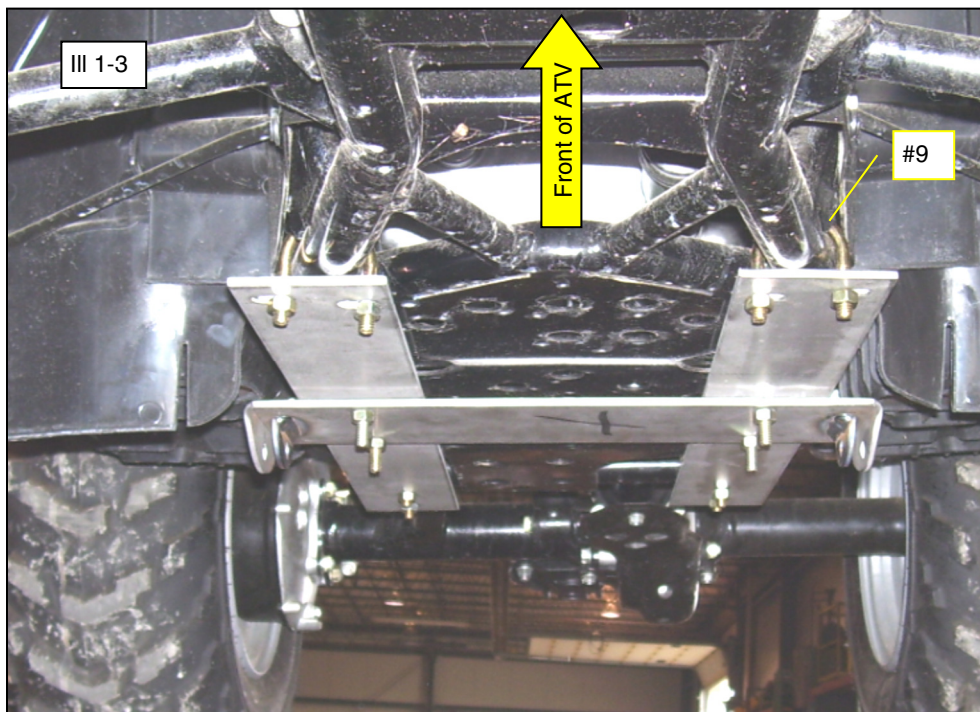

Manual Hand Lift Kit Compatibility Installation:

1. If you are using the Kolpin Manual Lift Kit PN 15-0090, the u-clamp (item #4) needs to be installed over the pulley to protect it. The u-clamp fits outside of the cable guide and outside of the blade position lever bracket as shown. (See illustration 1-4).
2. Tighten all bolts and u-bolts to specification.



8MM FASTENER TORQUE:
17 ft. lbs. (23 Nm)



3. Included is a strap protecting bracket pictured below. (See illustration 1-5). The bracket (item #3) is designed to protect the front plastic grill from wear by the lift strap.
4. To install, remove existing bolts from front grill.
5. Install bracket (item #3) with the M6 bolts (item #7) included in the kit.



One Year Limited Warranty

For the period of one (1) year from the purchase date, Kolpin will replace for the original purchaser, free of charge, any part or parts found upon examination by Kolpin to be defective in material, workmanship, or both.

All transportation costs incurred submitting product to Kolpin for warranty consideration must be borne by the purchaser. If Kolpin determines that the product must be returned to the factory for credit, please call 1-877-956-5746 for a Return Merchandise Authorization (RMA) number and shipping instructions.

This warranty does not apply to parts that have been damaged by accident, alteration, abuse, improper maintenance, normal wear, or other causes beyond the manufacturer's control. In order to protect you and your ATV, certain parts of the plow system and/or hardware are designed to fail when the equipment is over-stressed. Parts that are lost due to loosening and improper maintenance are not covered under warranty. This warranty does not cover removal or reinstallation labor fees of the plow system and related components.

Peripheral products such as engines, electric motors, and actuators may carry an original manufacturer's warranty. Most hardware is general in nature and is easily obtained locally. Be sure to replace with minimum metric class 8.8 specification.

Kolpin Outdoors, Inc.

Telephone: (763)-478-5800

Toll Free: (877)-956-5746

Fax Number: (800)-245-7569

www.kolpin.com

Email: customerservice@kolpin.com