



# MID-MOUNT KIT

FOR CAN-AM / JOHN DEERE ATV's

P/N 15-7511

ASSEMBLY / OWNERS MANUAL

Application

PLOW PUSH FRAME NO. 15-0070, 33-0000 or 33-0070

Before you begin, please read these instructions and check to be sure all parts and tools are accounted for. The following instructions contain details required to install and service the contents of this kit.

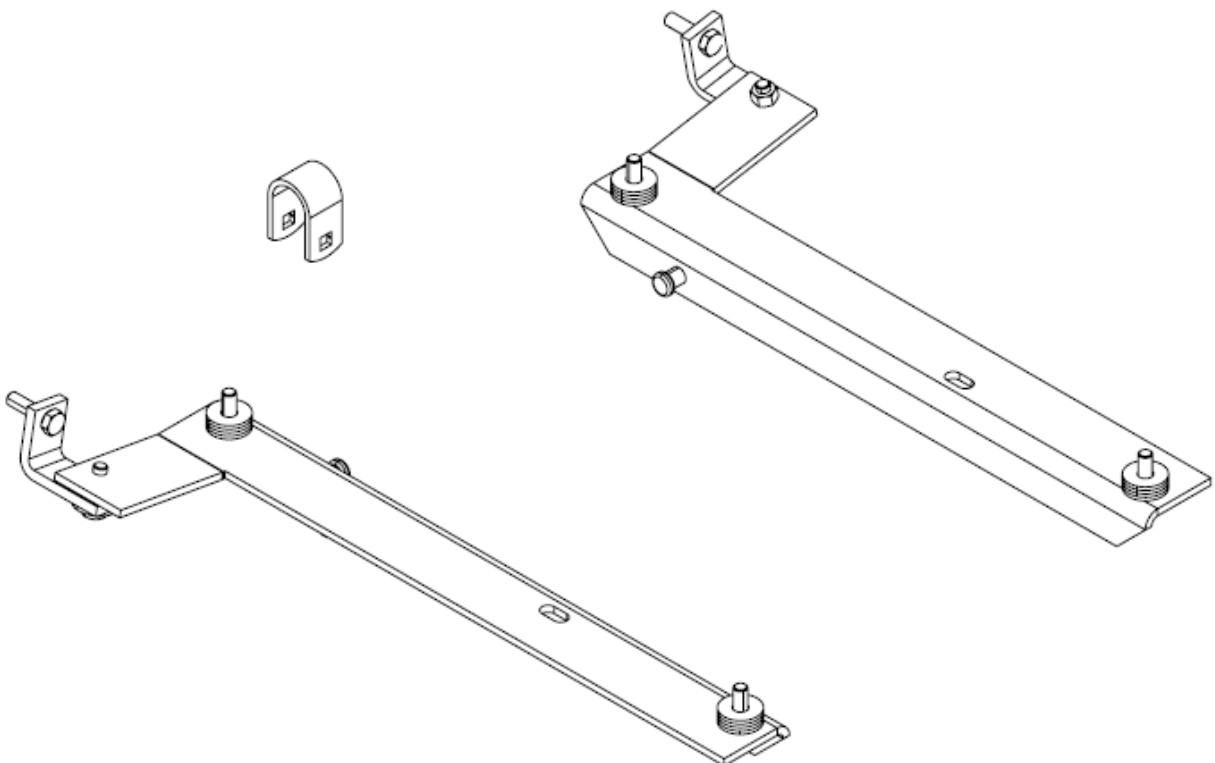

## OPERATING INSTRUCTIONS

Congratulations! You've just purchased the most durable plow component in the industry. Kolpin plow components work great for summer or winter plowing. With proper care and maintenance, your Kolpin plow system will last for years to come!

### NOTICE

Plow operation requires  
additional components for operation: *Kolpin Plow  
Blade, Kolpin Plow Push Frame, High Rise Plow  
Push Frame, Winch Kit\* and/or manual lift*

*\*These components may be specific to your vehicle.*

Please read and understand all assembly instructions, notices and warnings before assembling and operating your Kolpin plow system.

#### Follow these guidelines to ensure satisfactory operation:

- Read this manual and your ATV/ UTV operators manual before use.
- Periodically check for wear and tightness of all fasteners. Replace or re-torque fasteners as necessary.
- Before first use, set plow in the furthest right or left angled position to check for interference with the vehicle.
- Operate with extreme caution on slopes and rough terrain. Be familiar with the area before you plow.
- Be aware of immovable objects that could be hidden in the area you are plowing.
- To avoid damage when pushing snow into a pile, reverse direction before raising the plow blade.
- Do not ram the plow blade into piles of snow.
- For best results, set the suspension preload of your ATV/ UTV to the stiffest setting.
- To reduce steering effort and increase mobility, set the air pressure of your tires to the maximum pressure specification.
- The plow skids are adjustable. General skid setting is even with the plow wear bar bottom edge, higher settings reduce the chance of rocks and gravel from being collected.
- To increase traction during plow operation, operators can try: Securing weight to the ATV/ UTV for additional tire downforce, reducing tire air pressure, or installing tire chains.

## SAFETY INFORMATION

Our plow systems were designed with your safety in mind. Please read and understand all Cautions, Notices and Warnings in this manual before you begin. In order to protect you and your ATV/UTV, certain parts of the plow system and/or hardware are designed to fail when the equipment is over-stressed.



## WARNING



#### TO AVOID SERIOUS INJURY OR DEATH:

1. DO NOT EXCEED 5 MPH (8 KMH) WITH BLADE INSTALLED
2. OPERATE WITH EXTREME CAUTION ON SLOPES, STEEP GRADES, AND ROUGH TERRAIN
3. ALLOW NO RIDERS ON BLADE OR ATV WHILE MOVING OR STATIONARY
4. KEEP BYSTANDERS AWAY FROM THE BLADE OR ATV WHILE MOVING OR STATIONARY
5. WHEN PUSHING HEAVY MATERIAL, DIRECTION CONTROL MAY BECOME DIFFICULT
6. BEFORE ADJUSTING BLADE: STOP ATV ENGINE; SET AND LOCK BRAKES; RAISE AND LOCK BLADE
7. LOWER BLADE TO DOWN POSITION WHEN BLADE AND ATV ARE NOT IN USE
8. READ BLADE INSTRUCTION SHEETS AND ATV OWNER'S MANUAL

## Kit Contents:

Item	Qty	Part Description	Part Number
1	1	Left Attaching Bracket	-
2	2	Right Attaching Bracket	-
3	2	Attaching Bracket Strap	-
4	1	U-Clamp, 1.00" Diameter	-
5	2	Clevis Pin, Zinc Plated, 10mm x 35mm	PUR1209
6	2	Hair Pin, Zinc Plated, #3	PUR1249
7	2	Hex Bolt, Zinc Plated, M8 -1.25 x 25mm LG	-
8	6	Hex Bolt, Zinc Plated, M8 - 1.25 x 30mm LG	-
9	18	Flat Washer, Zinc Plated, M8	-
10	4	Lock Washer, Zinc Plated, M8	-
11	2	Hex Locknut, Zinc Plated, M8-1.25	-
12	1	Instruction Guide (not shown)	-

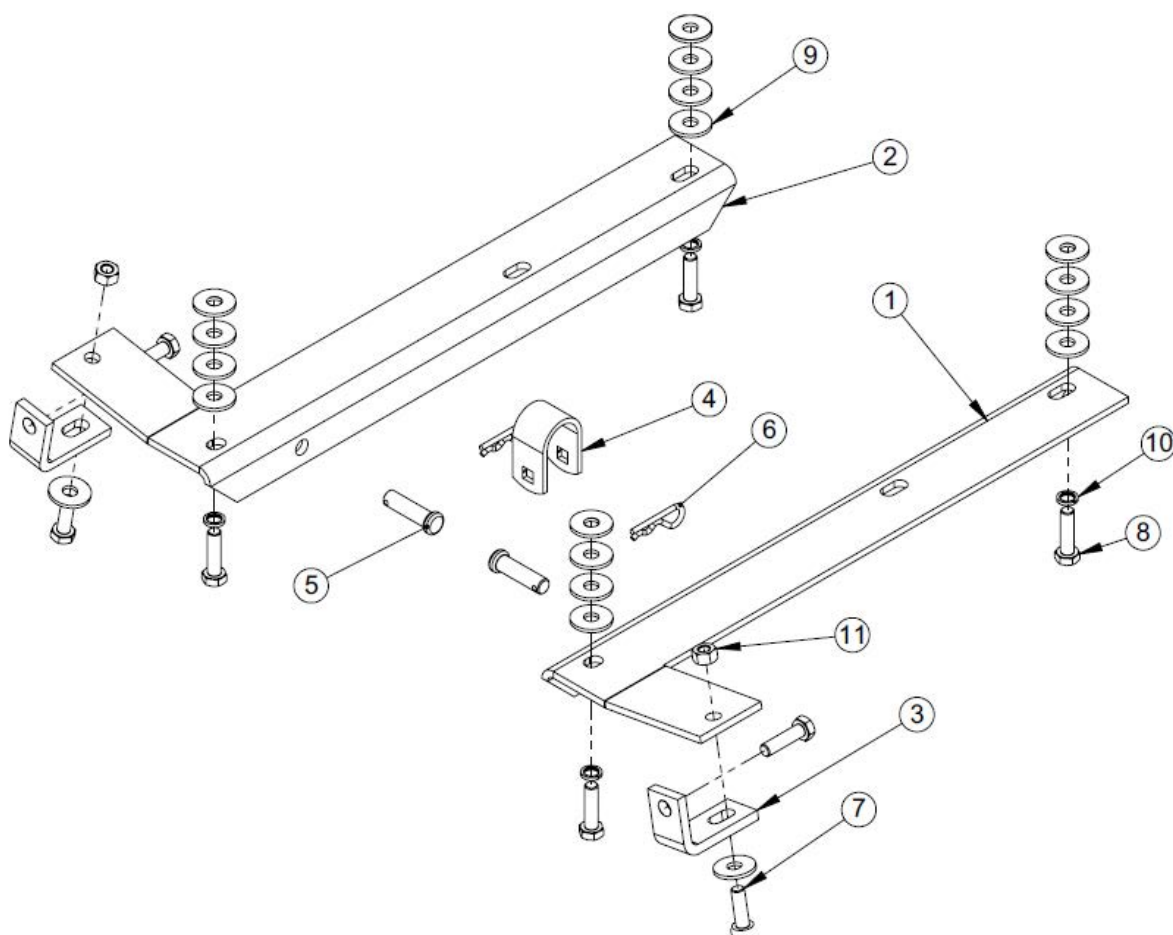

## **BEFORE YOU BEGIN:**

- Your Kolpin accessory is exclusively designed for your vehicle
- Please read and understand all instructions
- Verify all parts and tools are accounted for
- To ensure a satisfactory installation, follow all steps correctly and in the sequence described
- Keep these instructions for future reference or for informational requests
- To facilitate installation, make sure that your vehicle is clean and free of debris
- All directions referring to right and left are when the rider is sitting on the machine

## **TOOLS REQUIRED:**

- Basic Metric Hand Wrench and Socket Set
- Torque Wrench
- Do Not use impact tools to install hardware

## **APPROXIMATE ASSEMBLY TIME: 15 minutes**

**Note:** Removal of the plastic skid plate is recommended.

Note: If any hardware is missing, do not return to the store. Call us to help,

Toll Free 1-877-956-5746.

## Installation:

1. Locate and remove the outside fastener from the front of each of the footpad silver tubes. Retain OEM fasteners for reinstall use when attaching brackets are removed. The metric nuts will be reused on the longer 8mm x 30mm bolts which replaced the original bolts. (See illustration 1-1.)
2. There are four (4) 8mm x 25mm bolts under the machine that hold the skidpan in place. Retain these for use when attaching brackets are removed. These will be replaced one at a time with 8mm x 30mm bolts and lockwashers and used to attach the right and left attaching brackets. First, remove the left-front 8mm x 25mm bolt, shown in picture. Insert the front 8mm x 30mm bolt on the **Left** attaching bracket (make sure the (4) flatwashers stay in place, as they are used as spacers and must fit up into the recessed area of the skid pan). Turn it only 3 – 4 turns so the attaching bracket can be easily moved and rotated.
3. Now remove the rear 8mm x 25mm bolt from the **Left** side of the ATV and insert the rear 8mm x 30 mm bolt into the rear of the **Left** attaching bracket. At this time, you should be able to align the hole in the attaching bracket strap with the hole for the bolt removed in step #1 and attach with the supplied 8mm x 30mm bolt. It will probably be necessary to loosen the 8mm x 25mm bolt and nylock nut that attaches the attaching bracket strap to the attaching bracket.
4. Tighten all fasteners to specification.

 = T
<b>8MM FASTENER TORQUE:</b> 17 ft. lbs. (23 Nm)

5. Repeat all steps for the right side Attaching Bracket.
6. Note: If using a Manual Lift kit, the U-Clamp (item #4) has to be installed over the pulley to protect it. The U-clamp fits outside of the cable guide and outside of the blade position lever bracket. (See illustration 1-2.)

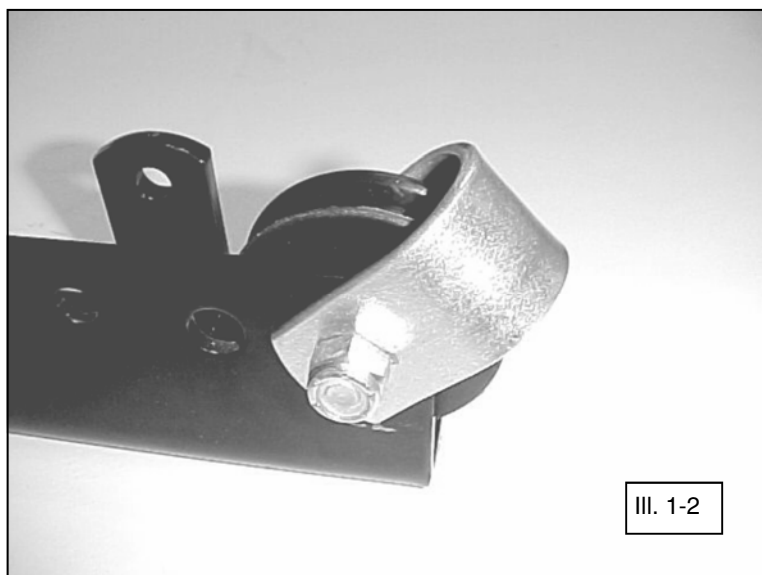
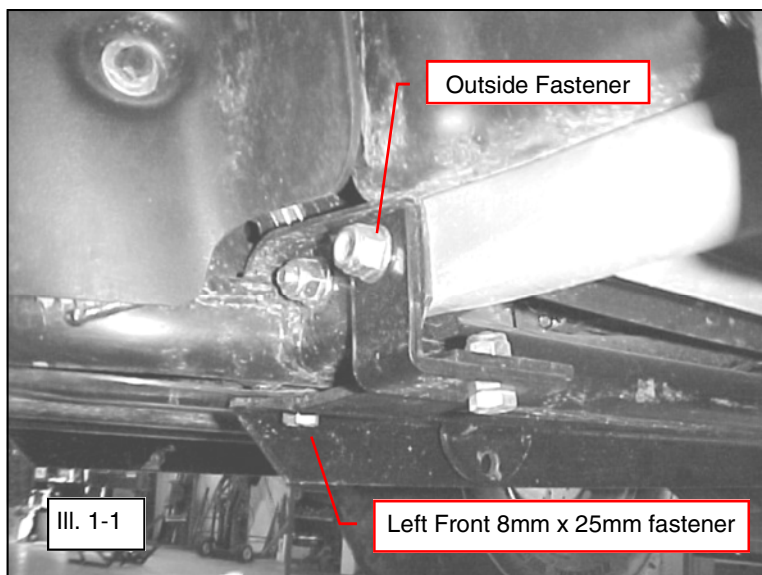



## **One Year Limited Warranty**

For the period of one (1) year from the purchase date, Kolpin will replace for the original purchaser, free of charge, any part or parts found upon examination by Kolpin to be defective in material, workmanship, or both.

All transportation costs incurred submitting product to Kolpin for warranty consideration must be borne by the purchaser. If Kolpin determines that the product must be returned to the factory for credit, please call 1-877-956-5746 for a Return Merchandise Authorization (RMA) number and shipping instructions.

This warranty does not apply to parts that have been damaged by accident, alteration, abuse, improper maintenance, normal wear, or other causes beyond the manufacturer's control. In order to protect you and your ATV, certain parts of the accessory system and/or hardware are designed to fail when the equipment is over-stressed. Parts that are lost due to loosening and improper maintenance are not covered under warranty. This warranty does not cover removal or reinstallation labor fees of the plow system and related components.

Peripheral products such as engines, electric motors, and actuators may carry an original manufacturer's warranty. Most hardware is general in nature and is easily obtained locally. Be sure to replace with minimum metric class 8.8 specification.

**Kolpin Outdoors, Inc.**

**Telephone: (763)-478-5800**

**Toll Free: (877)-956-5746**

**Fax Number: (800)-245-7569**

**[www.kolpin.com](http://www.kolpin.com)**

**Email: [customerservice@kolpin.com](mailto:customerservice@kolpin.com)**