



● Thank you for purchasing the our product. Before installing, please read the instruction carefully and keep it for future reference.

⚠ Attention!

- For installation, please follow the steps described in manual. Any damage caused by wrong installation shall be imputed to the users.
- Don't break or modify the wire. To avoid the short circuit, please don't pull the wire when installing.
- Do not disassemble or change any parts excluding the manual description.
- The interior examination or maintenance should be executed by our professionals.

● MARK MEANING:

- NOTE** You could get the installation details from the information behind the mark.
- ⚠** Some processes must be followed to avoid the affection caused by wrong installation.
- ⚠ WARNING!** Some processes must be followed to avoid damages to yourself or the public.
- ⚠ CAUTION!** Some processes must be followed to avoid the damage to the vehicle.

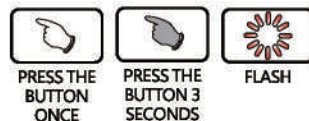

1 Accessories

| | | | |
|----------------------------|--|---|-------------------------------|
| 1 LCD meter X1 | 2 Meter cover X1 | 3 M3 X L20 HEX socket set screw X2 | 4 M3 X P0.5 nut X2 |
| 5 Velcro X1 set | 6 PT 1/8 water temp sensor X1 | 7 Temp sensor wire X1 | |

NOTE Contact your local distributor, if the items received in the box are not the same as the items listed above.

1-2 Option accessory

| | |
|-------------------------------|---|
| 1 Fin Temp. Sensor | 2 Water temp sensor adapter M14 M16.M18 M22.M26mm |
|-------------------------------|---|

NOTE Some of the option accessories may not sell. For the details, please contact the local distributor.

2-1 Installation Instructions

A

B

Follow the steps below during installation.

A

- 1.LCD meter(Accessory 1)
- 2.M3 X L20 HEX socket set screw(Accessory 3)
- 3.M3 X P0.5 nut(Accessory 4) $\times 0.65 \text{ Nm (6.5 kgf.cm)}$
- 4.Meter cover(Accessory 2)

B

- 1.LCD meter(Accessory 1)
- 2.Meter cover(Accessory 2)
- 3.Velcro-male(Accessory 5)
- 4.Velcro-female(Accessory 5)

⚠ When removing the meter cover, please use appropriate tool to open the meter cover from the groove (as shown) on the side of the meter. Please do not directly disconnect the cover vertically to avoid making damages to the meter cover.

NOTE Choose either Method A or B according to your need.

2-2 Battery Installation Instructions

CR2032

⚠ Please change the battery when the meter is off!
NOTE Please follow the arrow direction to press before remove the battery.

2-3 Wiring Installation Instructions

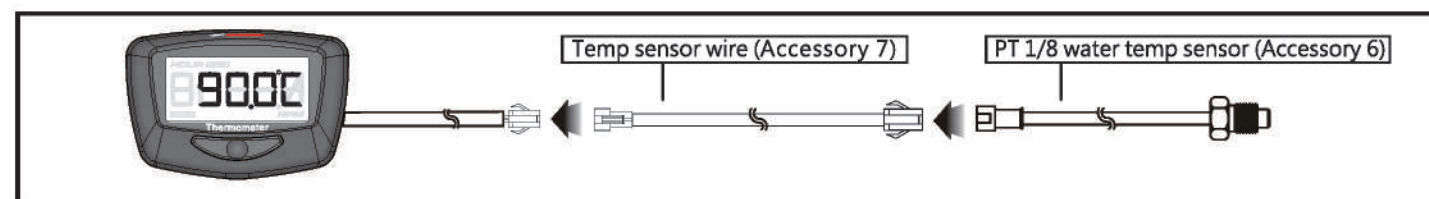

3 Functions, Settings Description



| | |
|------------------------------------|--|
| ● Temperature | Display range : 0.0~120 °C (32.0~248.0 °F) Display unti : 0.1 °C (°F) |
| ○ Display internal | <0.5 Sec. |
| ○ Max. temperature record | Display range : 0.0~120 °C (32.0~248.0 °F) Display unti : °C /°F |
| ● Internal battery type | CR 2032 |
| ● Battery life time (continuously) | About 1 year |
| ● Effective temperature range | -10~60 °C |
| ● Water-Proof Standard | JIS D 0203 |
| ● Meter size | W48.5 X L32.6 X H17 mm |
| ● Meter weight | About 32.5 g |

NOTE Design and specifications are subject to change without notice!

4 Display Switching Instruction

- When meter is OFF, press the button once to enter the temperature display screen.
- In temperature display screen, press the button once to enter the Max. temperature record screen.
- In Max. temperature record screen, press the button once to go back to the temperature display screen.
- Press and hold the button for 3 seconds to reset the Max. temperature record.

NOTE Press and hold the button for 6 seconds. Within 1 minute, the temperature changes shall be lower by 2 degree and shall shut down automatically.

NOTE The meter will show the current temperature after the Max. record is reset.

5 Temperature Unit Setting



- In temperature display screen, press and hold the button for 3 seconds to enter the temperature unit setting.



- Press and hold the button for 3 seconds to enter the temperature warning setting.
- Press the button once to switch the temperature unit.



NOTE Setting range :
°C (Celsius) and °F (Fahrenheit)
Default value : °C



- Example : To set temperature warning value to 95 °C.
- Press and hold the button for 3 seconds to move to the digit you want to set.

NOTE Setting range : 0~120 °C (32~248 °F)
Default value : 90 °C

⚠ WARNING! Do not check the record while driving to avoid injuries.



- Press the button once to choose the setting number.



- EX : Set temperature warning value from 90 °C to 95 °C.
- Press and hold the button for 3 seconds to go back to the temperature display screen.



- Back to temperature display screen.

6 Trouble shooting

The following situations do not indicate malfunction of the meter. Please check the following points, before taking it in for repairs.

| Trouble | Check item |
|---|---|
| The meter doesn't display or display error. | <ul style="list-style-type: none"> ● Maybe poor connection of the sensor. → Please make sure the sensor is connected correctly. ● Maybe the problem is caused by the insufficient power. → Please change the inner battery. |

※ If the problem persists after reviewing the options above, please contact your local distributor.