



INSTALLATION

USB POWER PORT—UNIVERSAL

1688

PARTS INCLUDED

- 1 USB Power Port
- 1 Hardware Kit Containing:
 - 1 Alcohol Pad
 - 1 Dielectric Grease Pack
 - 1 Double Sided Tape Strip
 - 1 1" Handlebar Adapter Assembly
 - 1 Screw Plate Adapter Assembly
 - 6 4" Black Nylon Cable Ties
 - 2 #6-32 X 3/8" Phillips Head Pan Screws
- 1 Installation Instructions

Please read and understand entire instructions before starting installation.

THANK YOU FOR CHOOSING KÜRYAKYN!

IN ORDER TO PROTECT YOU AND OTHERS FROM POSSIBLE INJURY AND/OR PROPERTY DAMAGE OR LOSS, PLEASE PAY CLOSE ATTENTION TO ALL INSTRUCTIONS, WARNINGS, CAUTIONS AND NOTICES REGARDING THE USE AND CARE OF THIS PRODUCT.

WARNING

THIS INDICATION ALERTS YOU TO THE FACT THAT IGNORING THE CONTENTS DESCRIBED HEREIN CAN RESULT IN POTENTIAL DEATH OR SERIOUS INJURY.

NOTICE

This indication alerts you to the fact that ignoring the contents described herein may negatively affect product performance and functionality.

NOTICE

IF INSTALLING THIS PRODUCT FOR ANOTHER PARTY, PLEASE MAKE SURE THEY RECEIVE THIS COPY OF THE INSTALLATION INSTRUCTIONS SO THEY ARE AWARE OF THE IMPORTANT INFORMATION CONTAINED IN THEM.

TOOLS SUGGESTED

Set of Combination Wrenches, Phillips Screwdriver

STRICTLY OBSERVE THE FOLLOWING GUIDELINES IN ORDER TO USE THE PRODUCT PROPERLY AND AVOID POTENTIALLY DANGEROUS ACCIDENTS.

STEP 1

Read and understand all steps in the instructions before starting the installation. Park the motorcycle on a hard, level surface and turn off the ignition. Let cool.

WARNING

YOU WILL BE WORKING AROUND THE ENGINE AND EXHAUST SYSTEM DURING INSTALLATION. ENSURE THAT THE ENGINE AND EXHAUST SYSTEM HAVE FULLY COOLED TO PREVENT INJURY.

NOTICE

Kuryakyn is not responsible for any damage to any device being used with this Power Port.

CUSTOMER SERVICE

877.370.3604 (toll free)

INSTALLATION QUESTIONS

techsupport@kuryakyn.com
or call 715.247.2983

LIMITED WARRANTY

Kuryakyn warrants that any Kuryakyn products sold hereunder, shall be free of defects in materials and workmanship for a period of one (1) year from the date of purchase by the consumer excepting the following provisions:

- Kuryakyn shall have no obligation in the event the customer is unable to provide a receipt showing the date the customer purchased the product(s).
 - The product must be properly installed, maintained and operated under normal conditions.
 - Kuryakyn makes no warranty, expressed or implied, with respect to any gold plated products.
 - Kuryakyn shall not be liable for any consequential and incidental damages, including labor and paint, resulting from failure of a Kuryakyn product, failure to deliver, delay in delivery, delivery in nonconforming condition, or for any breach of contract or duty between Kuryakyn and a customer.
- Kuryakyn products are often intended for use in specific applications. Kuryakyn makes no warranty if a Kuryakyn product is used in applications other than intended.

Kuryakyn electrical products are warranted for one (1) year from the date of purchase by the consumer. L.E.D.'S contained in components of Kuryakyn products will be warranted for defects in materials and workmanship for 3 years from the date of purchase where as all other components shall be warranted for one(1) year. This includes, but is not limited to; control modules, wiring, chrome & other components.

Kuryakyn makes no warranty of any kind in regard to other manufacturer's products distributed by Kuryakyn. Kuryakyn will pass on all warranties made by the manufacturer and where possible, will expedite the claim on behalf of the customer, but ultimately, responsibility for disposition of the warranty claim lies with the manufacturer.

For purchasing Kuryakyn® products, you can receive a complete catalog free of charge. Send the Proof-of-Purchase below with your address to: Kuryakyn, P.O. Box 339, Somerset, WI 54025. Please indicate either Accessories Catalog for Harley-Davidson® or GL & Metric Cruisers.

Be sure to ask your local dealer about other Kuryakyn® products, the motorcycle parts and accessories designed for riders by riders.

ABOUT OUR CATALOG

For purchasing Kuryakyn® products, you can receive a complete catalog free of charge. Send the Proof-of-Purchase below with your address to: Kuryakyn, P.O. Box 339, Somerset, WI 54025. Please indicate either Accessories Catalog for Harley-Davidson® or GL & Metric Cruisers.

Be sure to ask your local dealer about other Kuryakyn® products, the motorcycle parts and accessories designed for riders by riders.

©2005 Kuryakyn USA® All Rights reserved.



kuryakyn.com

NOTICE

The Power Port is weather resistant, not water proof! Do Not use the Power Port in rain or inclement weather. Use the attached rubber plugs to keep water out of the ports when riding in rain or inclement weather.

NOTICE

To prevent damage to, or dislodging the Power Port, always use both hands to connect or disconnect the mobile device. Hold the Power Port in place and use your other hand to connect or disconnect the mobile device.

NOTE: Mount in a protected area of the motorcycle, with the ports facing down or to the side and slightly down, to help prevent water from entering the Power Port. If you think that you could have water in the Power Port, lift the back flap and lightly blow into the front.

NOTE: The top port on the Power point is approximately 2.0 amp capable. The bottom port is approximately 1.0 amp capable.

STEP 2

Decide on a mounting area for the Power Point and which mounting base (if needed) will work the best for the chosen location. With the wire harness of the Power Point facing the notch in the base, tip the Power Point down into the mount. PIC 2 Line up the grooves on the sides of the Power Point with the ridges in the base. PIC 2 Slide the Power Point onto the ridges on the mount until it snaps into place.

NOTE: This is a tight fit. It will take some pressure to slide the Power Point into the base. Make sure both grooves of the Power Point are secured on the ridges of the mount.

STEP 3

Remove the seat or side cover (depending on model) to gain access to the battery.

STEP 4

Temporarily position the Power Point in the desired location and route the wire harness of the Power Point to the battery to ensure there is enough harness to reach to the battery. If satisfied with the routing, use the included cable ties to secure the wire harness out of harms way.

NOTE: There is a black four pin connector located in the middle of the Power Point harness. PIC 3 This may be disconnected to ease routing of the harness. If it is disconnected, use a dab of the supplied dielectric grease on each connector before plugging it together.

NOTICE

Secure all wiring away from any moving parts, pinch points or extreme heat. Kuryakyn WILL NOT issue a warranty on any electrical component that fails due to pinched, crimped, broken, abraded, melted or frayed wires.

STEP 5

Disconnect the negative wire from the battery first, then loosen the fastener on the positive wire. Slide the terminal on the **RED** wire from the Power Point under the fastener on the positive wire and tighten the fastener securely. Attach the terminal on the **BLACK** ground wire from the Power Point and the negative wire to the negative post on the battery. Tighten securely

STEP 6

Plug a mobile device into the Power point and check to see if it is charging correctly. If the mobile device does not show charging, check the 5 amp fuse in the **RED** power wire and check that all battery connections are tight.

MOUNTING WITH ADHESIVE TAPE—WITH OR WITHOUT HANDLEBAR MOUNT

STEP 7

Determine the mounting area for the Power Port. If mounting without the handlebar mount, you will need a 1" X 1" flat area. Thoroughly clean the installation area with soapy water and a clean rag. Rinse and dry the area completely. Wipe the installation area with the included alcohol pad to remove any residue and dry completely.

-cont.-

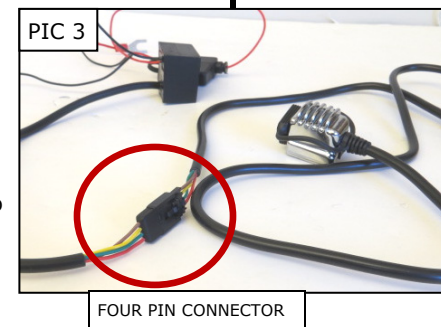
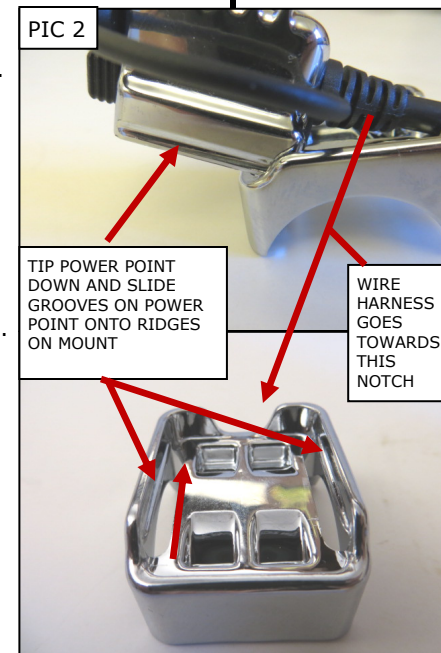
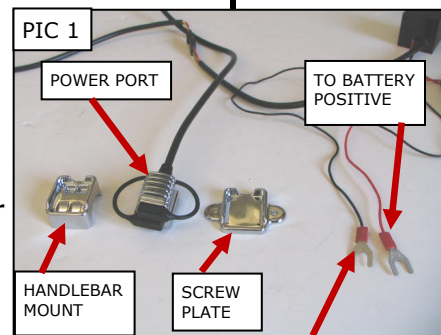

NOTICE

Ensure the area of installation is free of grease, oil, dirt or other debris including wax/polish products and bugs to ensure proper adhesion. Küryakyn WILL NOT issue a warranty on any parts lost due to improper installation.

NOTICE

The adhesive will not bond correctly if applied at temperatures less than 50°F. Do not attempt this installation in temperatures less than 50°F.

STEP 8

If using just the adhesive pad—Rub the backing of the adhesive tape with your fingernail to activate it. Remove the backing and press tape to the underside of the Power Point for one minute. Rub the backing of the adhesive now attached to the Power Point with your fingernail to activate it. Remove the backing and press the Power Point to the desired location for one minute. Full bonding will occur in 24 hours.

If using the handlebar mount—Rub the backing of the adhesive tape attached to the Handlebar Mount with your fingernail to activate it. Remove the backing and press the Power Point/Handlebar Mount to the desired location for one minute. Full bonding will occur in 24 hours.

NOTE: If the motorcycle is to be operated before the 24 hour cure time has expired, use a good quality masking or painter's tape over the Power Point to assist in holding it in place until the cure time is over.

MOUNTING WITH THE SCREW PLATE**STEP 9**

Determine the location for the Plate. Mark the location of the two holes to be drilled. Remove the Power Point/Mount and, with a center punch, mark the center of each hole.

NOTICE

MEASURE TWICE – DRILL ONCE. Double check all reference marks made on the fairing BEFORE drilling. Küryakyn will not be responsible for incidental or consequential damages resulting from this installation.

STEP 10

Determine that nothing is beneath or behind the location of the holes will be damaged or interfered with. Using a 1/8" drill bit, carefully drill the mounting holes.

STEP 11

Rub the backing of the adhesive tape on the Screw Plate with your fingernail to activate it. Remove the backing. Using the included #6-32 X 3/8" Phillips screws, mount the Plate to the location.

STEP 12

Replace the seat or side cover.

WARNING

AFTER INSTALLING THE SEAT, PULL UP ON IT TO ENSURE IT IS LOCKED INTO PLACE. A LOOSE SEAT CAN SHIFT AND CAUSE LOSS OF CONTROL RESULTING IN SERIOUS INJURY OR DEATH.

STEP 13

Use the fins on top of the Power Port to store the rubber plugs when using the Power Port by pressing the retaining cord in between the fins. PIC 4

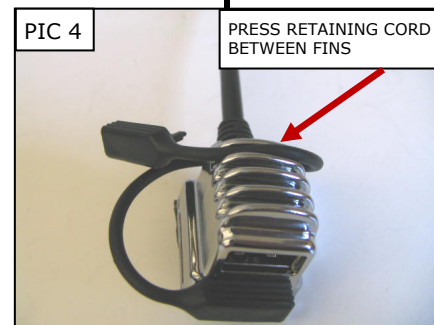

PAGE

3*Ride On!***USB POWER PORT****INSTALLATION**