





TORPEDO INDICATOR LIGHTS

2508

THANK YOU FOR CHOOSING KÜRYAKYN!

PROTECT YOURSELF AND OTHERS FROM POSSIBLE INJURY AND/OR PROPERTY DAMAGE OR LOSS. PAY CLOSE ATTENTION TO ALL INSTRUCTIONS, WARNINGS, CAUTIONS, AND NOTICES REGARDING THE INSTALLATION, USE, AND CARE OF THIS PRODUCT.

	THIS INDICATION ALERTS YOU TO THE FACT THAT IGNORING THE CONTENTS DESCRIBED HEREIN CAN RESULT IN POTENTIAL DEATH OR SERIOUS INJURY.
	This indication alerts you to the fact that ignoring the contents described herein can result in minor or moderate potential injury.
	This indication alerts you to the fact that ignoring the contents described herein may negatively affect product performance and functionality or damage the product itself or the product to which it is being attached.

MAKE SURE THE FOLLOWING PARTS HAVE BEEN INCLUDED IN THE KIT:

- 2 Torpedo Indicator Lights
- 1 Hardware kit containing:
 - 8 Female T-Tap Connectors
 - 8 Male spade Connectors
 - 1 Dielectric Grease Pack
- 1 Installation Instructions

TOOLS SUGGESTED:

Set of combination wrenches, test light, wire crimping tool, and pliers

STEP 1

Read and understand all steps in the instructions before starting the installation. Park the motorcycle on a hard, level surface and turn off the ignition. Allow the engine and exhaust system to cool.

NOTICE

These installation instructions contain important information. Ensure that the end user receives this copy and is aware of its importance for future reference.

Torpedo Indicator Lights are ECE compliant.

STEP 2

Remove the nuts from both of the Torpedo Indicator Lights mounting studs. Set the nuts aside for now; they will be reused.

CUSTOMER SERVICE

877.370.3604 (toll free)

INSTALLATION QUESTIONS

techsupport@kuryakyn.com
or call 715.247.2983

LIMITED WARRANTY

Kuryakyn warrants that any Kuryakyn products sold hereunder, shall be free of defects in materials and workmanship for a period of one (1) year from the date of purchase by the consumer excepting the following provisions:

- Kuryakyn shall have no obligation in the event the customer is unable to provide a receipt showing the date the customer purchased the product(s).
 - The product must be properly installed, maintained and operated under normal conditions.
 - Kuryakyn makes no warranty, expressed or implied, with respect to any gold plated products.
 - Kuryakyn shall not be liable for any consequential and incidental damages, including labor and paint, resulting from failure of a Kuryakyn product, failure to deliver, delay in delivery, delivery in nonconforming condition, or for any breach of contract or duty between Kuryakyn and a customer.
- Kuryakyn products are often intended for use in specific applications. Kuryakyn makes no warranty if a Kuryakyn product is used in applications other than intended.
- Kuryakyn electrical products are warranted for one (1) year from the date of purchase by the consumer. L.E.D.'S contained in components of Kuryakyn products will be warranted for defects in materials and workmanship for 3 years from the date of purchase where as all other components shall be warranted for one(1) year. This includes, but is not limited to; control modules, wiring, chrome & other components.
- Kuryakyn makes no warranty of any kind in regard to other manufacturer's products distributed by Kuryakyn. Kuryakyn will pass on all warranties made by the manufacturer and where possible, will expedite the claim on behalf of the customer, but ultimately, responsibility for disposition of the warranty claim lies with the manufacturer.

ABOUT OUR CATALOG

For purchasing Kuryakyn® products, you can receive a complete catalog free of charge. Send the Proof-of-Purchase below with your address to: Kuryakyn
454 County Road V V
Somerset, WI 54025-9031
Please indicate either Accessories Catalog for Harley-Davidson® or GL & Metric Cruisers.

Be sure to ask your local dealer about other Kuryakyn® products, the motorcycle parts and accessories designed for riders by riders.

©2005 Kuryakyn USA® All Rights reserved.



kuryakyn.com

STEP 3 Determine the mounting locations for both of the Lights. Refer to **PIC 1**. The threaded mounting studs are 3/8" diameter. The stud extends about an inch from the base of the Light. The threaded stud is M10 X 1.25.

STEP 4 Install one Torpedo Light at a time. Insert the wiring and stud through the mounting hole; secure the Light to the mount with the nut removed in **STEP 2**. **DO NOT** over-tighten the nut.

NOTE: Refer to **PIC 1**. Seal the open ends of the Torpedo Light studs with silicone to prevent moisture from damaging the L.E.D.s.

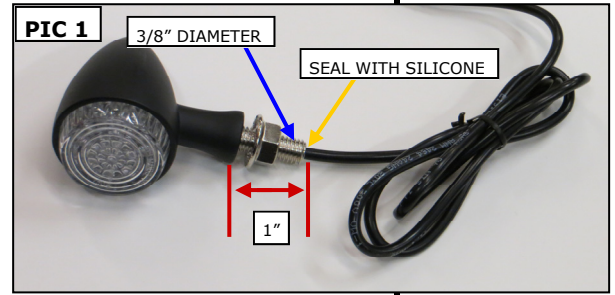

STEP 5 Repeat **STEP 4** for the other side.

STEP 6 Turn the key "ON".

Use a test light or the wiring diagram for your bike to locate the left and right turn-signal power wires and ground wire. Record the color of the wires here.

LEFT TURN	GROUND	RIGHT TURN

STEP 7 Turn the key "OFF". Disconnect the negative battery cable.

STEP 8 Refer to **PIC 2**. Attach an included Female T-Tap connector to each turn signal wire and ground wire from **STEP 6**.

STEP 9 Refer to **PIC 3**. Crimp an included Male Spade onto each Torpedo Light wire.

NOTICE

Dielectric grease inhibits moisture and prevents corrosion. Kuryakyn recommends the use of the included dielectric grease on ALL electrical connections. Apply dielectric grease directly to mating surfaces.

STEP 10 Refer to **FIG 1** and **PIC 4**. Connect the RED wire from the Torpedo Light to the T-Tap on the turn signal wire from **STEP 6**. Connect the BLACK wires to the ground wire from **STEP 6**. Repeat for the other side.

NOTICE

Secure all wiring away from any moving parts, pinch points or extreme heat. Kuryakyn WILL NOT warranty any electrical component that fails due to pinched, crimped, broken, abraded, melted or frayed wires.

STEP 11 Reconnect the negative battery cable. Ensure ALL lights operate correctly. Secure the wiring out of harms way.

If; erratic or fast turn-signal flash,
then, install a Load Equalizer (available at kuryakyn.com)

WARNING

VISIBILITY IS A MAJOR CONCERN FOR MOTORCYCLISTS. A LIGHT MALFUNCTION COULD RESULT IN DEATH OR SERIOUS INJURY. ENSURE PROPER LIGHT OPERATION BEFORE RIDING THE MOTORCYCLE.

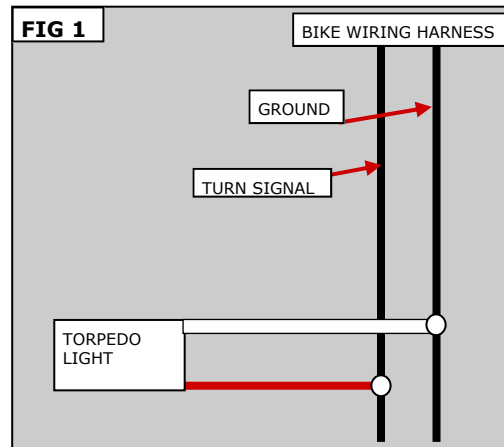
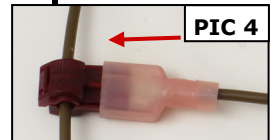
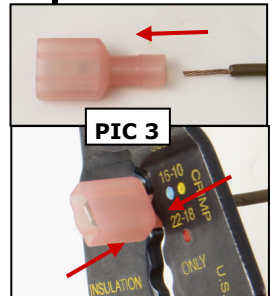
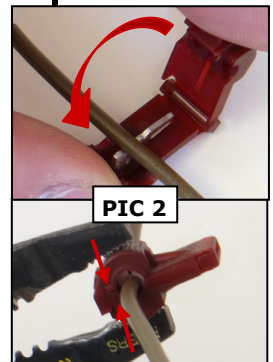

Ride On!