





STEALTH PASSENGER ARMRESTS

8958

THANK YOU FOR CHOOSING KÜRYAKYN!

PROTECT YOURSELF AND OTHERS FROM POSSIBLE INJURY AND/OR PROPERTY DAMAGE OR LOSS. PAY CLOSE ATTENTION TO ALL INSTRUCTIONS, WARNINGS, CAUTIONS, AND NOTICES REGARDING THE INSTALLATION, USE, AND CARE OF THIS PRODUCT.

 WARNING	THIS INDICATION ALERTS YOU TO THE FACT THAT IGNORING THE CONTENTS DESCRIBED HEREIN CAN RESULT IN POTENTIAL DEATH OR SERIOUS INJURY.
 CAUTION	This indication alerts you to the fact that ignoring the contents described herein can result in minor or moderate potential injury.
 NOTICE	This indication alerts you to the fact that ignoring the contents described herein may negatively affect product performance and functionality or damage the product itself or the product to which it is being attached.

MAKE SURE THE FOLLOWING PARTS HAVE BEEN INCLUDED IN THE KIT:

- 1 Right-Side Armrest Assembly
- 1 Left-Side Armrest Assembly
- 1 Right-Side Mounting Bracket
- 1 Left-Side Mounting Bracket
- 1 Right Backer Plate
- 1 Left Backer Plate
- 1 Right Mounting Plate with Studs
- 1 Left Mounting Plate with Studs
- 1 Hardware kit containing:
 - 6 1/4" flat washers
 - 6 1/4" nylock nuts
 - 4 5/16"-18 X 5/8" socket head cap screws
 - 2 foam pads
 - 4 5/16" hi-collar lock washers
 - 2 #6-32 X 1/4" set screws
- 1 Installation instructions

TOOLS SUGGESTED

Set of combination wrenches, socket set and ratchet, set of hex wrenches, drill and drill bit set, center punch, marker

 **These installation instructions contain important information. Ensure that the end user receives this copy and is aware of its importance for future reference.**

- STEP 1** Read and understand all steps in the instructions before starting the installation. Park the motorcycle on a hard, level surface and turn off the ignition.

CUSTOMER SERVICE
877.370.3604 (toll free)

INSTALLATION QUESTIONS
techsupport@kuryakyn.com
or call 715.247.2983

LIMITED WARRANTY

Kuryakyn warrants that any Kuryakyn products sold hereunder, shall be free of defects in materials and workmanship for a period of one (1) year from the date of purchase by the consumer excepting the following provisions:

- Kuryakyn shall have no obligation in the event the customer is unable to provide a receipt showing the date the customer purchased the product(s).
 - The product must be properly installed, maintained and operated under normal conditions.
 - Kuryakyn makes no warranty, expressed or implied, with respect to any gold plated products.
 - Kuryakyn shall not be liable for any consequential and incidental damages, including labor and paint, resulting from failure of a Kuryakyn product, failure to deliver, delay in delivery, delivery in nonconforming condition, or for any breach of contract or duty between Kuryakyn and a customer.
- Kuryakyn products are often intended for use in specific applications. Kuryakyn makes no warranty if a Kuryakyn product is used in applications other than intended.
- Kuryakyn electrical products are warranted for one (1) year from the date of purchase by the consumer. L.E.D.'S contained in components of Kuryakyn products will be warranted for defects in materials and workmanship for 3 years from the date of purchase where as all other components shall be warranted for one(1) year. This includes, but is not limited to; control modules, wiring, chrome & other components.

• Kuryakyn makes no warranty of any kind in regard to other manufacturer's products distributed by Kuryakyn. Kuryakyn will pass on all warranties made by the manufacturer and where possible, will expedite the claim on behalf of the customer, but ultimately, responsibility for disposition of the warranty claim lies with the manufacturer.

ABOUT OUR CATALOG

For purchasing Kuryakyn® products, you can receive a complete catalog free of charge. Send the Proof-of-Purchase below with your address to: Kuryakyn
454 County Road V V
Somerset, WI 54025-9031
Please indicate either Accessories Catalog for Harley-Davidson® or GL & Metric Cruisers.

Be sure to ask your local dealer about other Kuryakyn® products, the motorcycle parts and accessories designed for riders by riders.

©2005 Kuryakyn USA® All Rights reserved.



BIKE PREP:

STEP 2 Refer to **PIC 1**. Locate the included Left Backer Plate.

STEP 3 Refer to **PIC 2**. Open the tour pak lid and locate the two flange-nuts (1). Remove the nuts and set them aside; they will not be re-used.

STEP 4 Center the Left Backer Plate over the two threaded studs as shown in **PIC 3**. Mark the center of the hole with a marker. Remove the plate and set it aside for now.

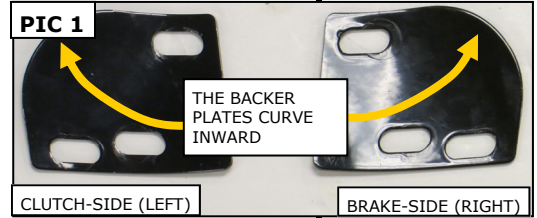

NOTICE

Refer to **PIC 2**. Secure the tour pak lid as you remove the brake-side flange nuts (2) and tether. Unexpected release of the tether can allow the lid to fully open resulting in damage.

STEP 5 Refer to **PIC 2**. Remove the two brake-side (2) flange nuts and tether. Remove the two plastic locating pins from the outside of the lid. Set the nuts and pins aside; they will not be re-used. Center the Right Backer Plate over the threaded studs; mark the center of the hole with a marker. Remove the plate and set it aside for now.

STEP 6 Remove the two center nuts (3) and backing plate (if equipped). Shut the lid and carefully pull the backrest away from the lid. Set the nuts and backrest aside for now.

NOTICE

MEASURE TWICE – DRILL ONCE. Double check all reference marks made on the lid **BEFORE** drilling. Kuryakyn will not be responsible for incidental or consequential damages resulting from this installation.

STEP 7 Open the lid. Use a center punch to mark the locations made in **STEPS 4 and 5**.

STEP 8 Using an 11/32" drill bit, drill holes at the marks made in **STEP 7**. Enlarge the existing holes (at 1, 2, and 3) to 11/32". Shut the lid.

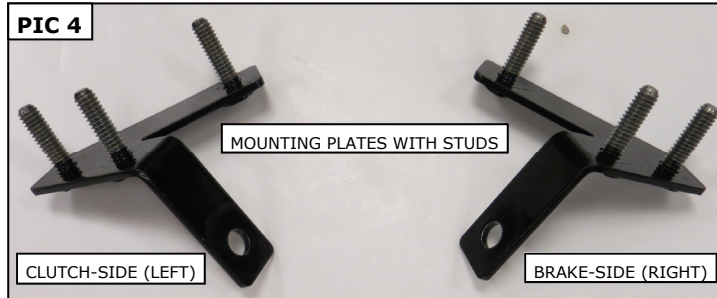

INSTALL THE MOUNTING PLATES:

STEP 9 Refer to **PIC 4**. Locate the included Right Mounting Plate with Studs.

STEP 10 Refer to **PIC 5**. On the backside of the passenger backrest pad, locate the OEM brake-side (right) mounting bracket.

STEP 11 Mark the OEM mounting bracket position on the rubber lug with a marker. It is very important to install the new Mounting Plate in the same position.

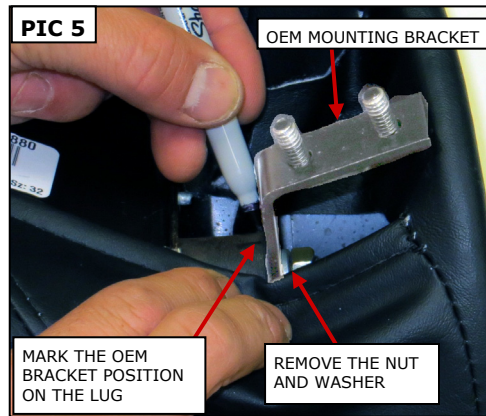

STEP 12 Refer to **PIC 5**. Remove the nut and lock washer securing the mounting bracket to the rubber lug. Remove the OEM bracket and set it aside; it will not be re-used.

STEP 13 Install the Right Mounting Plate with Studs; align it with the mark from **STEP 11**. Secure the Mounting Plate with the nut and lock washer removed in **STEP 12**.

STEP 14 Repeat **STEPS 9 through 13** for the clutch side (left).



-cont.-

INSTALL THE BACKREST PAD:

NOTICE

Avoid damage to the motorcycle. Protect painted surfaces with a soft cloth or blanket.

- STEP 15** Refer to **PIC 6**. Align the two center studs on the backrest pad with the holes in the lid; carefully insert the studs through the holes. Open the lid; temporarily secure the backrest pad to the lid with the nuts (and OEM backing plate, if equipped) from **STEP 6**. Shut the lid.
- STEP 16** Refer to **PIC 7**. Locate the included Right-Side Mounting Bracket and foam pads. Remove the adhesive backing from one of the foam pads and stick it to the inside of the Mounting Bracket as shown in **PIC 7 and 8**.
- STEP 17** Refer to **PIC 8**. Carefully pull the brake side of the backrest pad away from the lid; position the Right-Side Mounting Bracket over the three studs of the Mounting Plate with Studs. The Bracket will be between the backrest and the lid.
- STEP 18** Carefully insert the three studs through the holes in the lid.
- STEP 19** Refer to **PIC 9 and 10**. Locate the Right Backer Plate. Open the lid; position the Right Backer Plate over the three studs protruding from the inside of the lid.
- STEP 20** Refer to **PIC 10**. Position the tether plate over the studs as shown; secure the plates to the lid with two of the included Nylock Nuts and Flat Washers. Tighten the nuts securely.
- STEP 21** Install an included Nylock Nut and Washer on the remaining stud shown in **PIC 10**. Tighten the nut securely.
- STEP 22** Shut the lid and repeat **STEPS 16 through 21** for the clutch side.
- STEP 23** Tighten the OEM nuts (**PIC 2, #3**) on the center studs. Shut the lid.

INSTALL THE ARMREST ASSEMBLY:

- STEP 24** Locate the Right-Side Armrest Assembly. Refer to **PIC 13** on **PAGE 4**. Install the included set screws; do not thread the screws all the way in at this time.

NOTE: Refer to **PIC 11**. The Armrest Assembly can be mounted in either the upper or lower position. Decide which position works best for you before continuing.

- STEP 25** Position the Right-Side Armrest Assembly over the threaded bosses in the desired position. Secure the Armrest Assembly to the Bracket with the included 5/16" Screws and Lock Washers.
- STEP 26** Repeat **STEPS 24 and 25** for the clutch side.

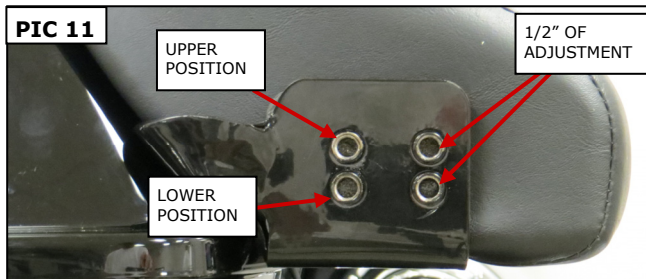
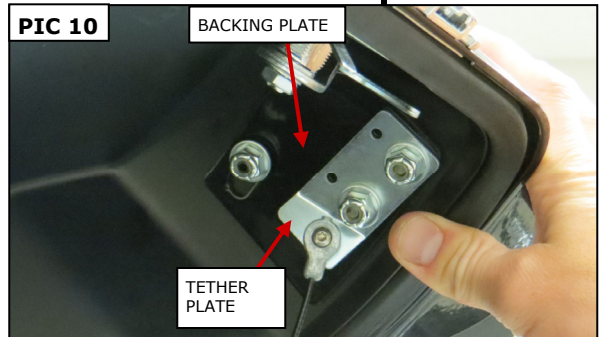
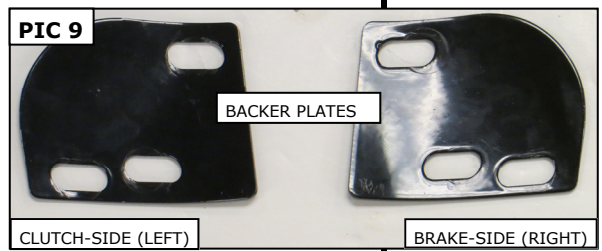
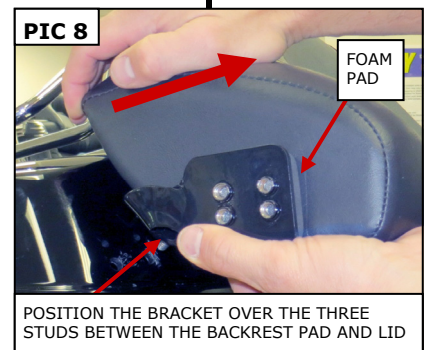
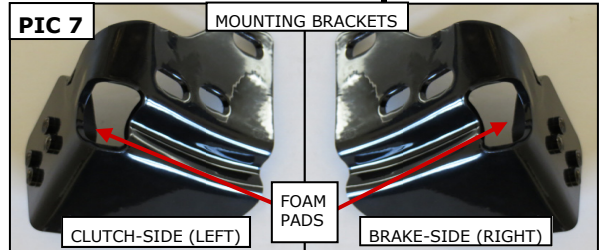
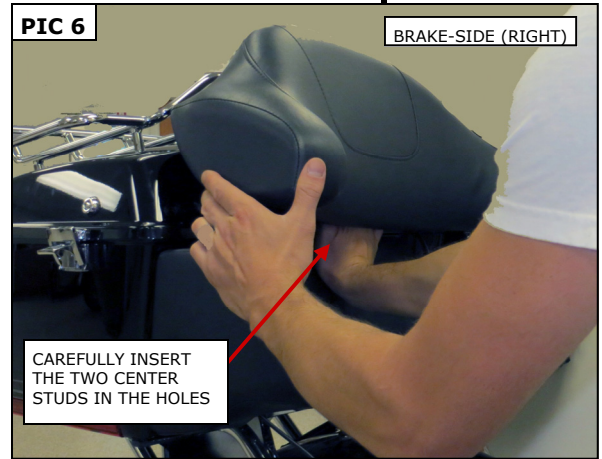

-cont.-

STEALTH PASSENGER ARMREST PAD ADJUSTMENT:

Küryakyn®

STEP 27

Refer to **PIC 12 and 13**. Locate the set screw on the underside of the armrest mount. Turn the set screw in (clockwise) to raise the angle of the armrest pad. Turn the set screw out (counterclockwise) to lower the angle of the armrest pad.

NOTE:

The armrest assembly has been removed from the bike for clarity. There is no need to remove the armrest assembly to adjust the set screws.

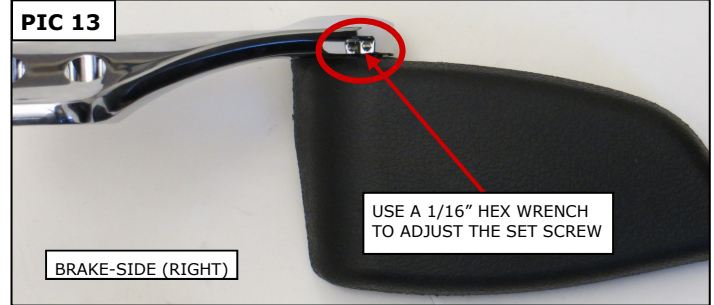
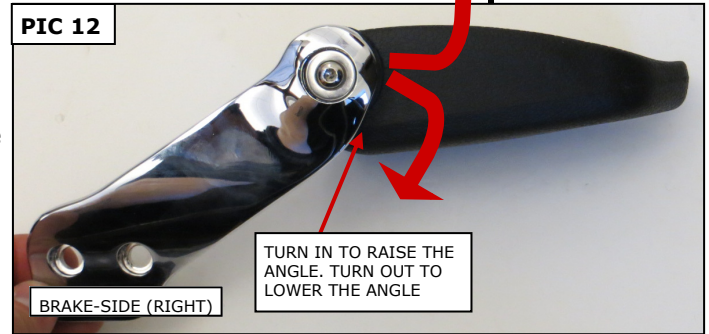

WARNING

PASSENGER ARMRESTS ARE NOT SAFETY RESTRAINING DEVICES. FAILURE TO HOLD ONTO THE MOTORCYCLE MAY RESULT IN SERIOUS INJURY OR DEATH.

CAUTION

This product was designed for use as a passenger armrest only. Do not use the armrest to mount or dismount the motorcycle. Do not apply your full body weight to the armrests to adjust your seating position.

NOTICE

It is the end user's responsibility to ensure that all of the fasteners (including pre-assembled) are tightened before operation of the motorcycle. Küryakyn will not provide warranty coverage on products or components lost due to improper installation or lack of maintenance. Periodic inspection and maintenance is required on all fasteners.

Ride On!

PAGE

4

STEALTH PASSENGER ARMRESTS

INSTALLATION