

# microSHIFT

## ADVENT X Rear Derailleur User Manual

# ADVENT X

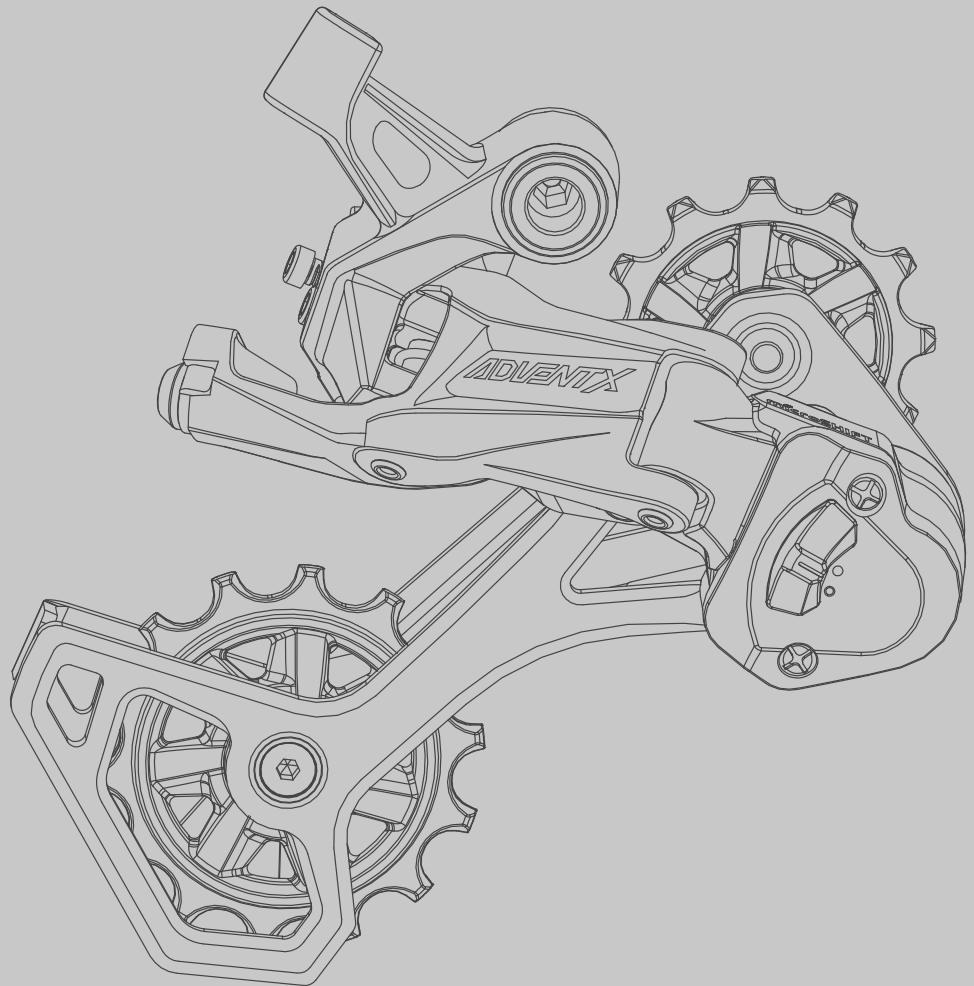

# Important Notice



## REMINDER

Before installing the products, please read and understand the installation procedures. Improper installation can lead to premature product failures or even injuries. If you have any questions on how to install, please contact us or consult with a professional bicycle mechanic.



**Deraillleurs with “VER.2” marking have a different B-tension adjustment than the original ADVENT X. For more info, see Step 10 for B-tension adjustment.**

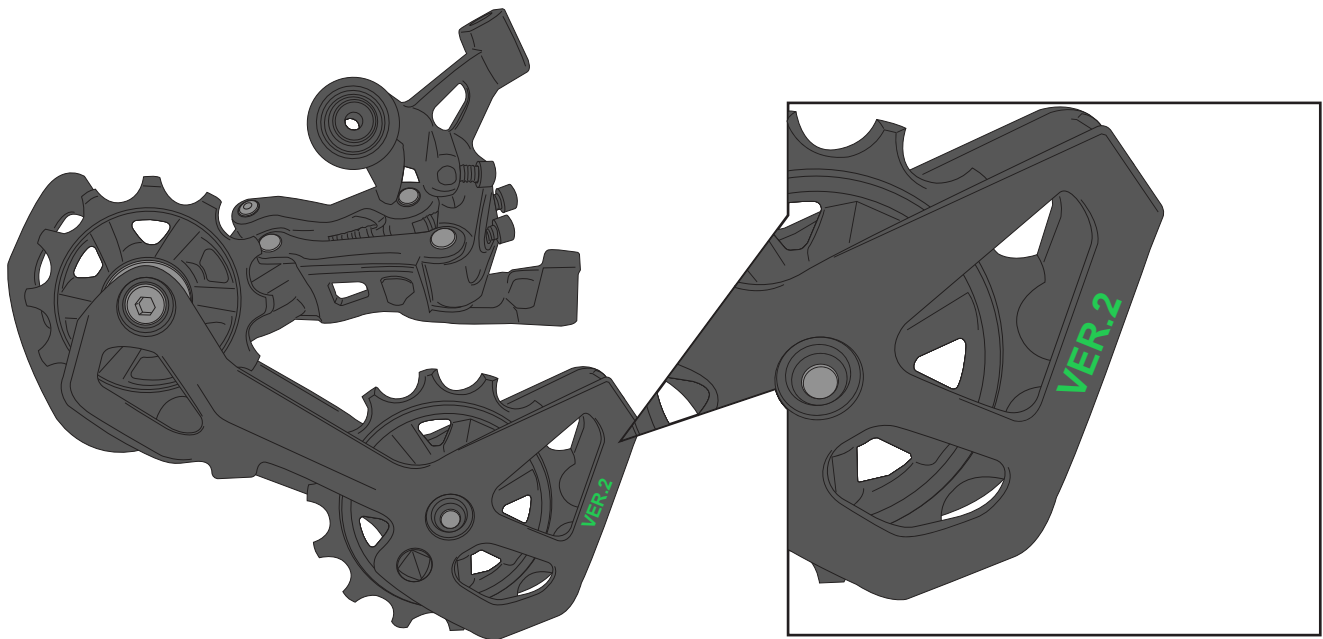

# INDEX

|                                     |          |
|-------------------------------------|----------|
| <b>Tools and Supplies</b>           | <b>3</b> |
| <b>Rear Derailleur Installation</b> | <b>4</b> |
| Rear Derailleur Attachment          | 4        |
| H-Limit Screw Adjustment            | 6        |
| Proper Cable Housing                | 7        |
| Cable Installation                  | 9        |
| Disable Clutch                      | 13       |
| Chain Sizing                        | 14       |
| Chain Installation                  | 19       |
| Shifting Adjustment                 | 20       |
| L-Limit Screw Adjustment            | 23       |
| B-Tension Screw Adjustment          | 25       |

# Tools and Supplies

1. Torque wrench
2. 4mm & 5mm Hex bits
3. Allen wrenches
4. Chain breaker
5. Cable cutter
6. Tape measurer
7. Derailler adjustment tool (optional)

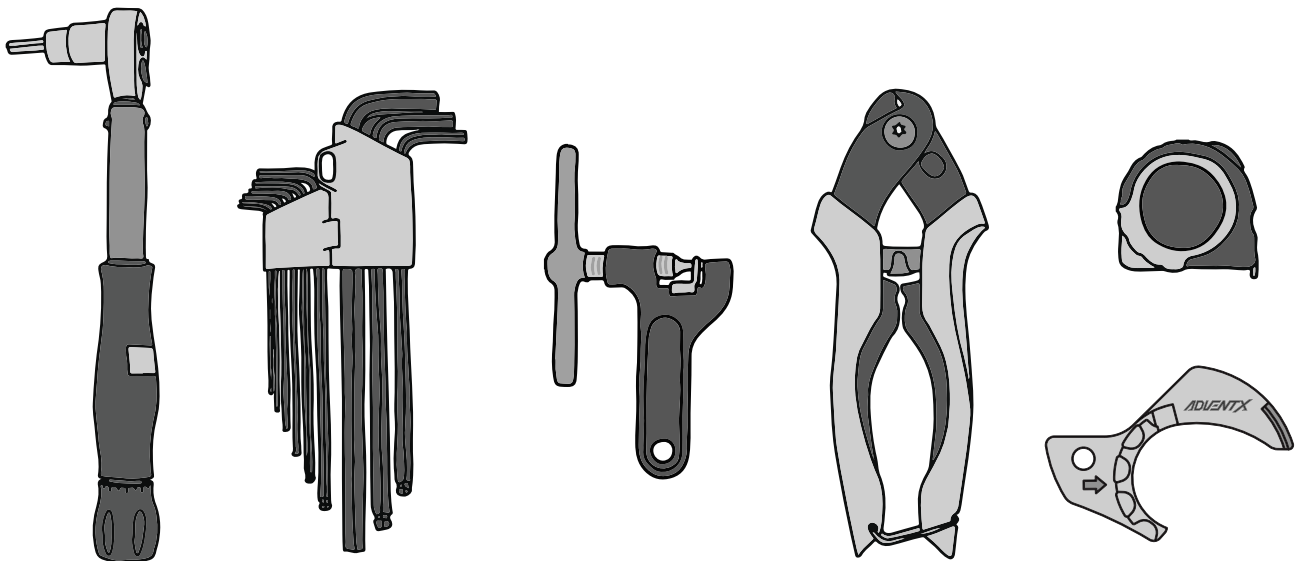

# 1. Rear Derailleur Attachment

Part I

Attach rear derailleur to the bike. Make sure the **B-tension washer** is above the **derailleur dropout** and engages correctly with the **B-tension adjustment screw**.

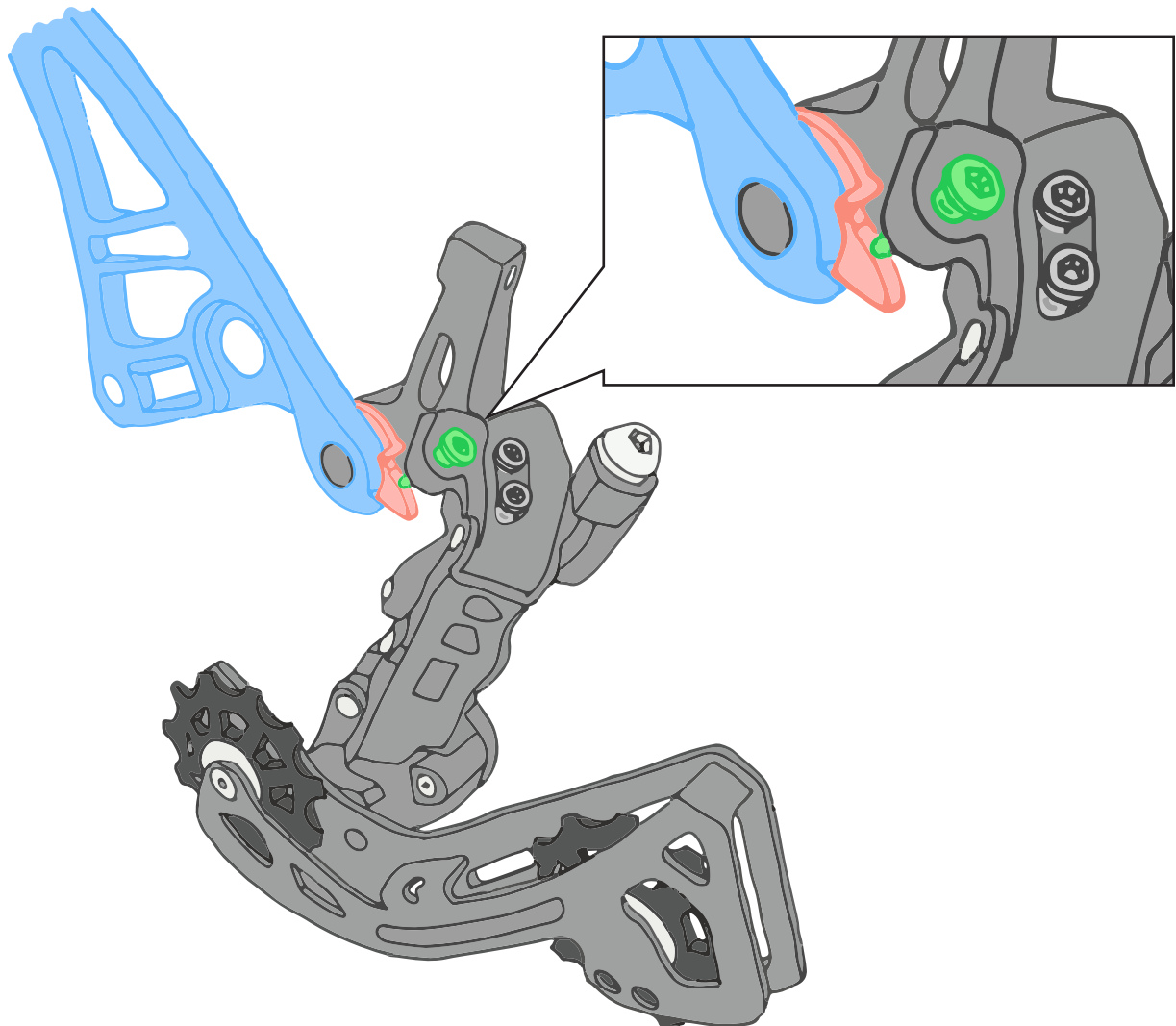

# 1. Rear Derailleur Attachment

Part II

Tighten the rear derailleur fixing bolt to **8-10 Nm** with a **5mm hex bit torque wrench**. Check to make sure that the derailleur can rotate freely.

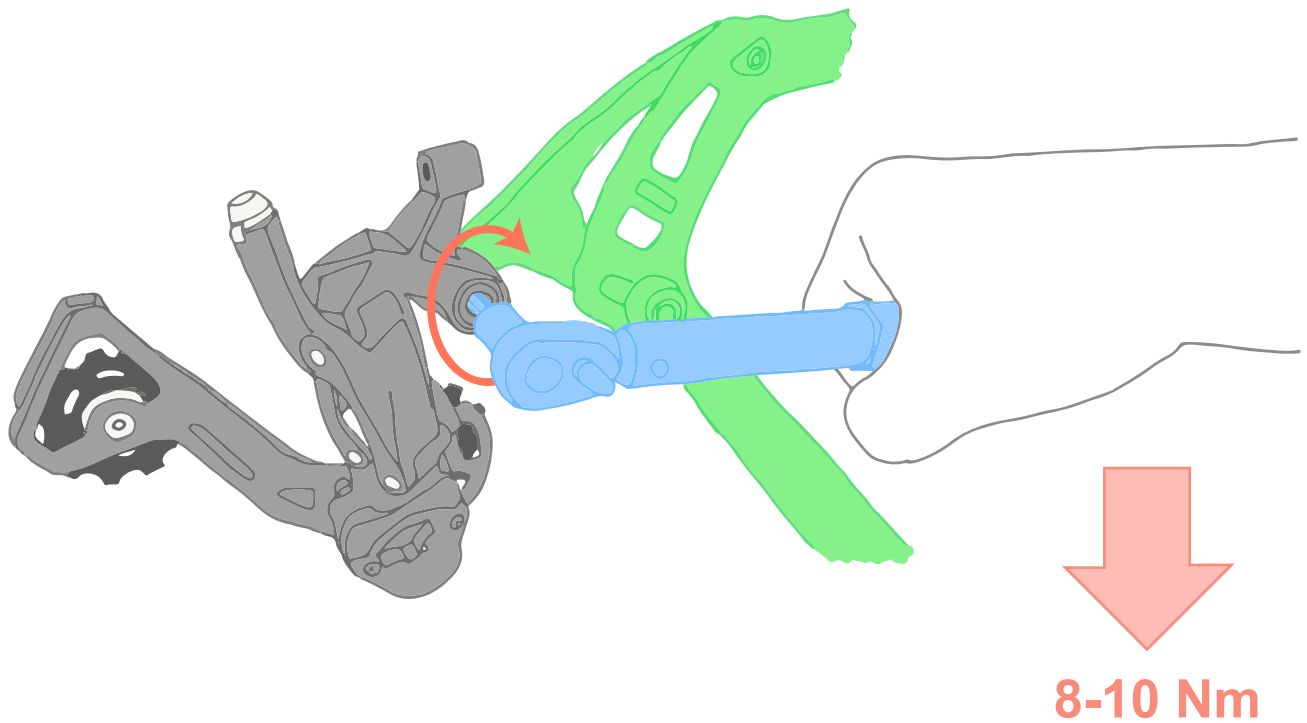

## 2. H-Limit Screw Adjustment

Adjust the **high-limit screw** until the guide pulley aligns with the outer edge of the smallest cog.

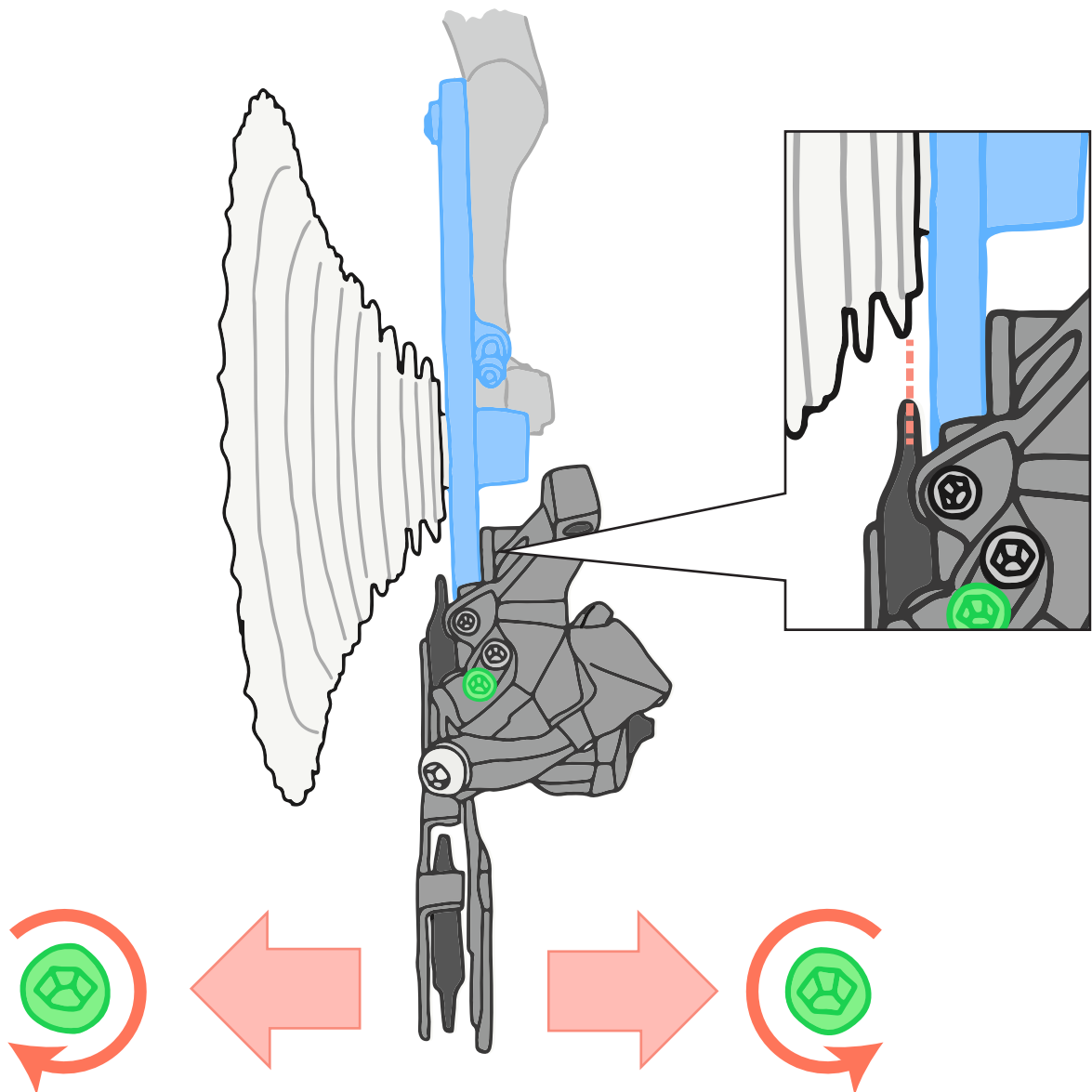

### 3. Proper Cable Housing

Part I

Every frame manufacturer has different cable routing guidelines, so make sure you consult those before cutting the housing. ADVENT works best when there is not too much of a curve in the housing, and not too little slack either. Make sure the end of the housing is sitting against the rear derailleur as well.

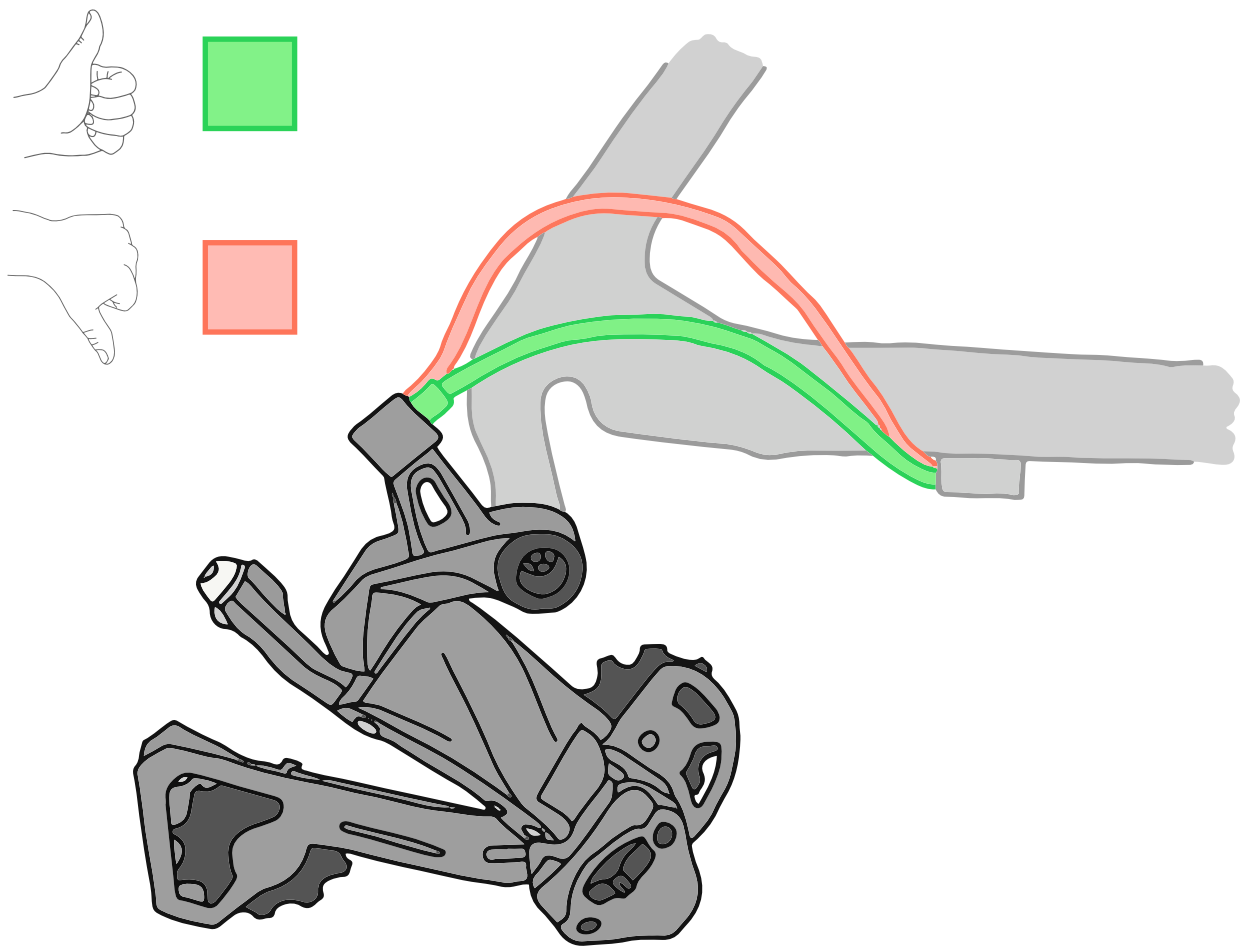



### 3. Proper Cable Housing

Part II

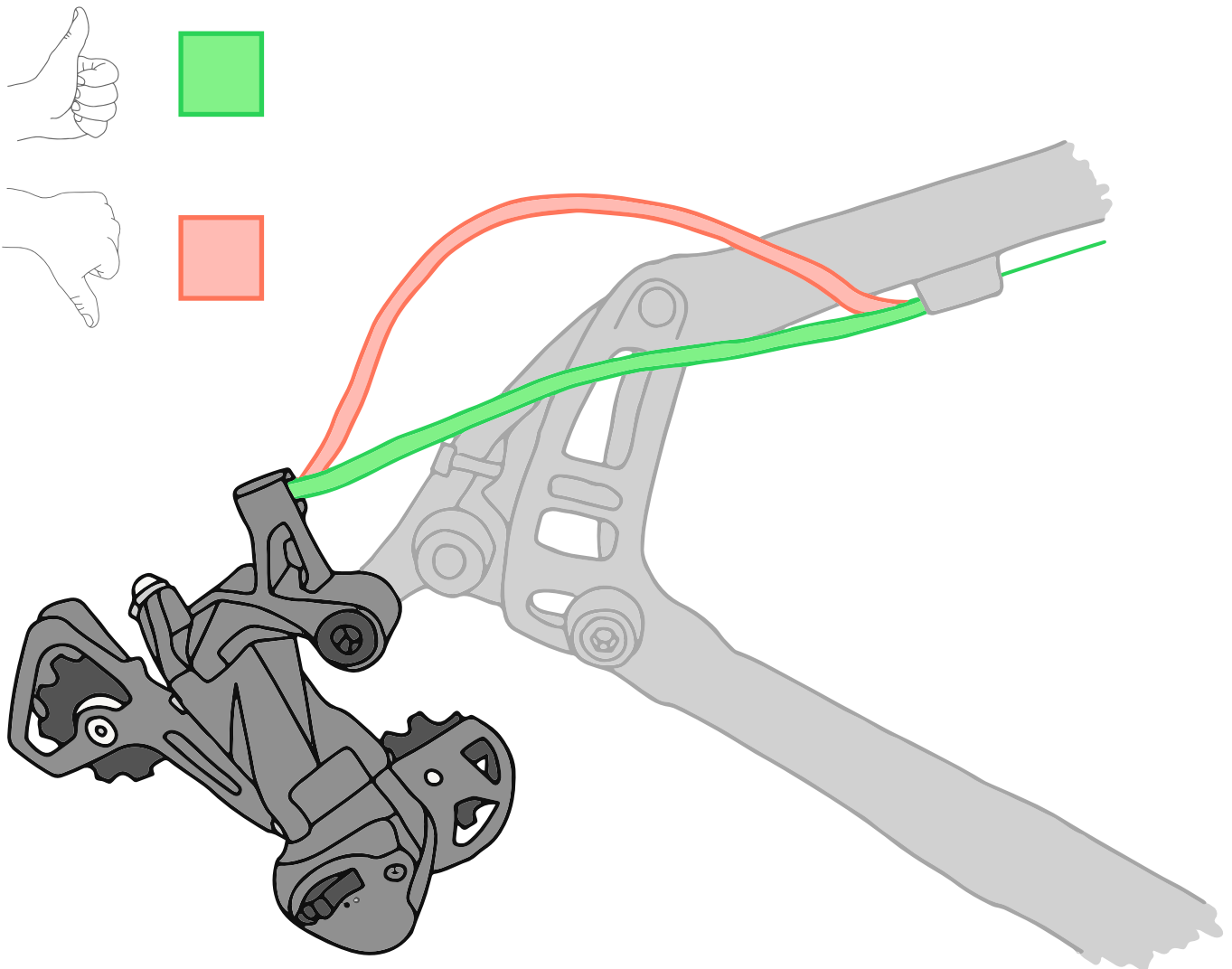

## 4. Cable Installation

Part I

Before installing the cable, use the **trigger lever** to shift to the highest gear.

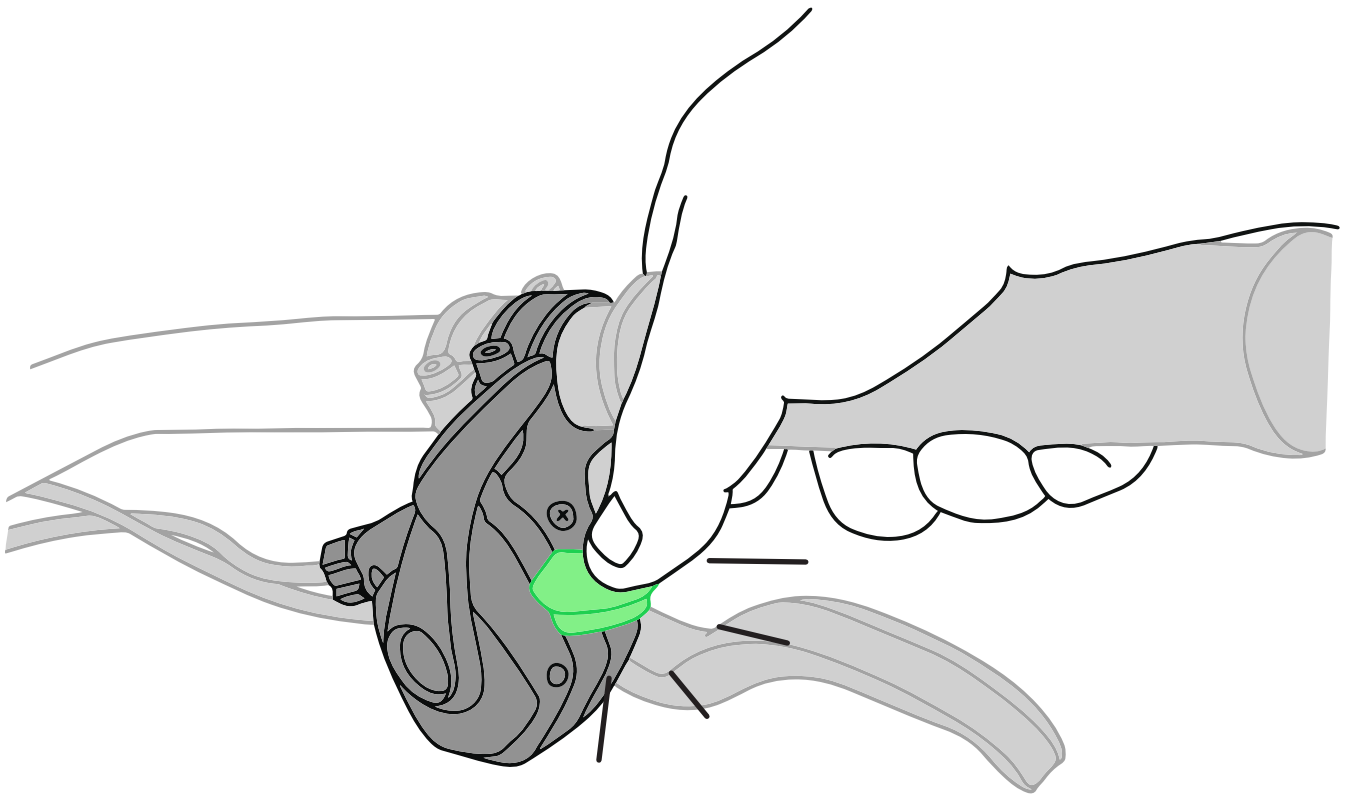

## 4. Cable Installation

Part II

Route the **cable** through the shifter, housing, and rear derailleur.

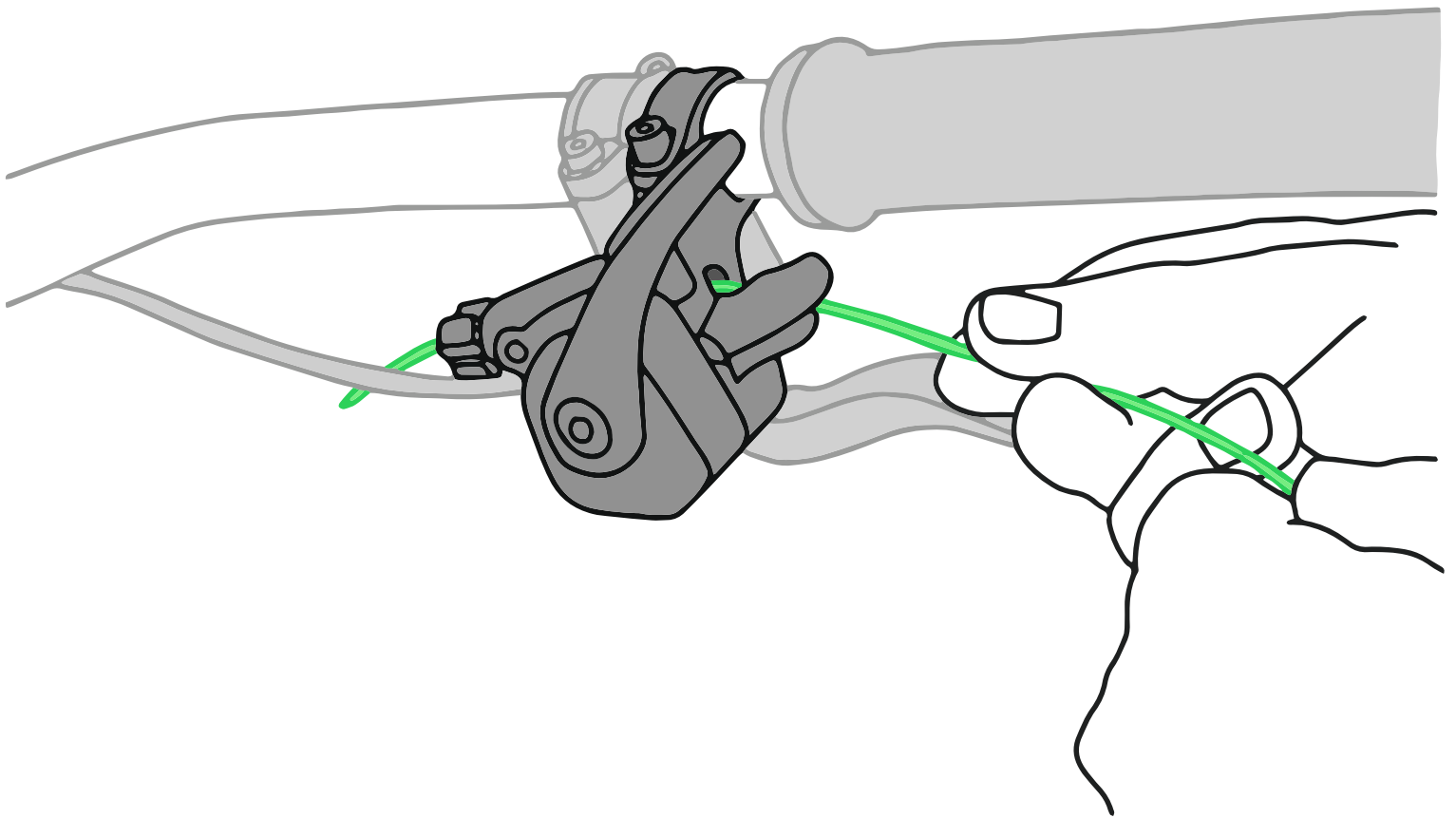

## 4. Cable Installation

Part III

Route **the cable** underneath the cable fixing bolt and washer. Make sure **the cable** is resting in the groove under the washer. Tighten to **5-7 Nm**.

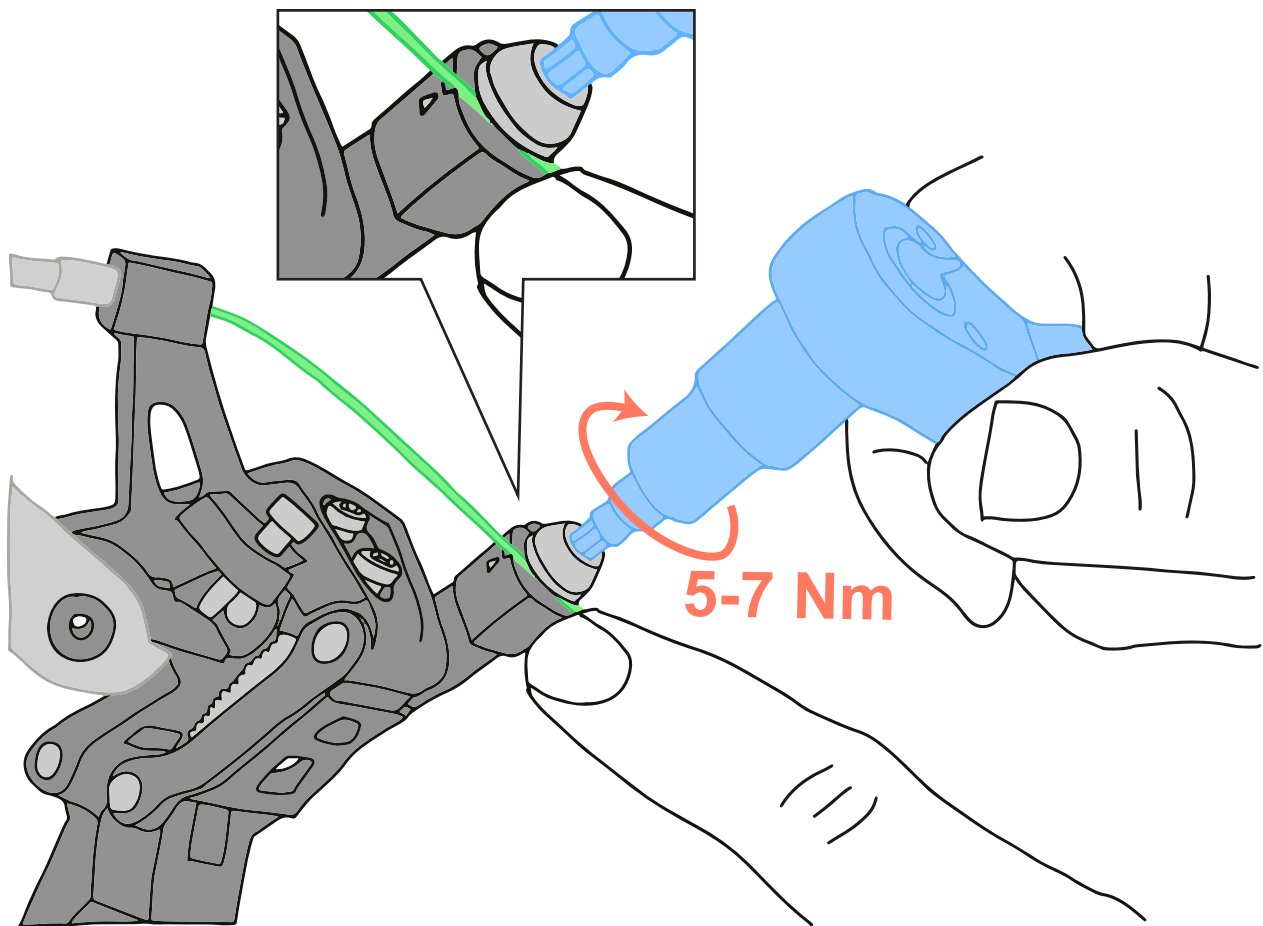

## 4. Cable Installation

Part IV

Cut the cable and attach the  **cable end**.

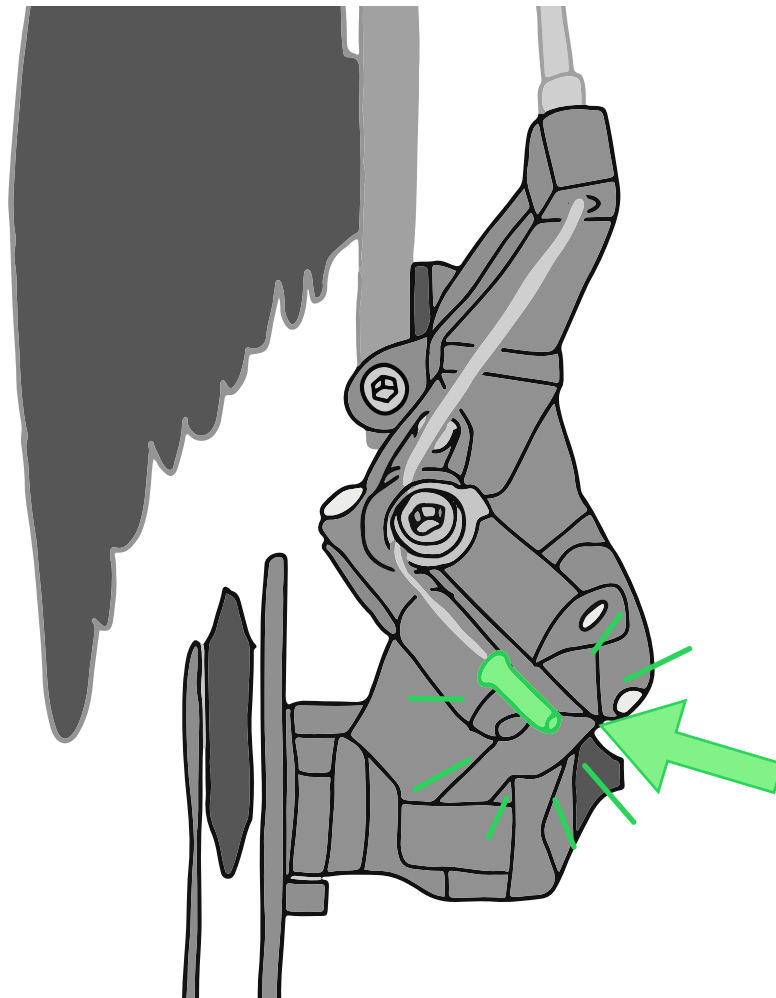

## 5. Disable Clutch



### Clutch Rear Derailleur Only

Disable the clutch by moving the **switch** on the side of the derailleur to the open circle position

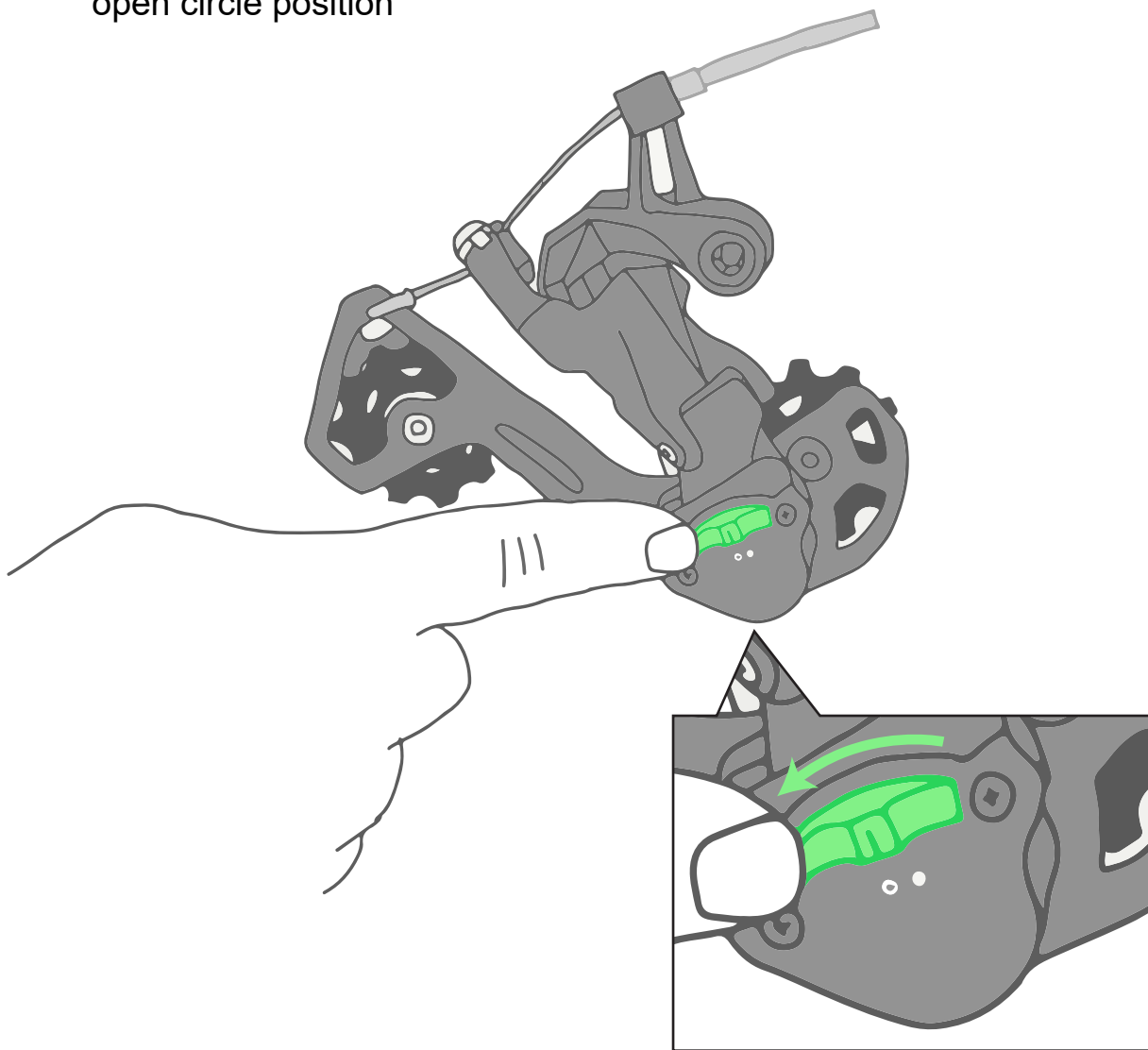

## 6. Chain Sizing

Part I



### Full Suspension Bike Only

To properly size the chain on a full suspension bike, release air from the rear shock or remove the shock completely.

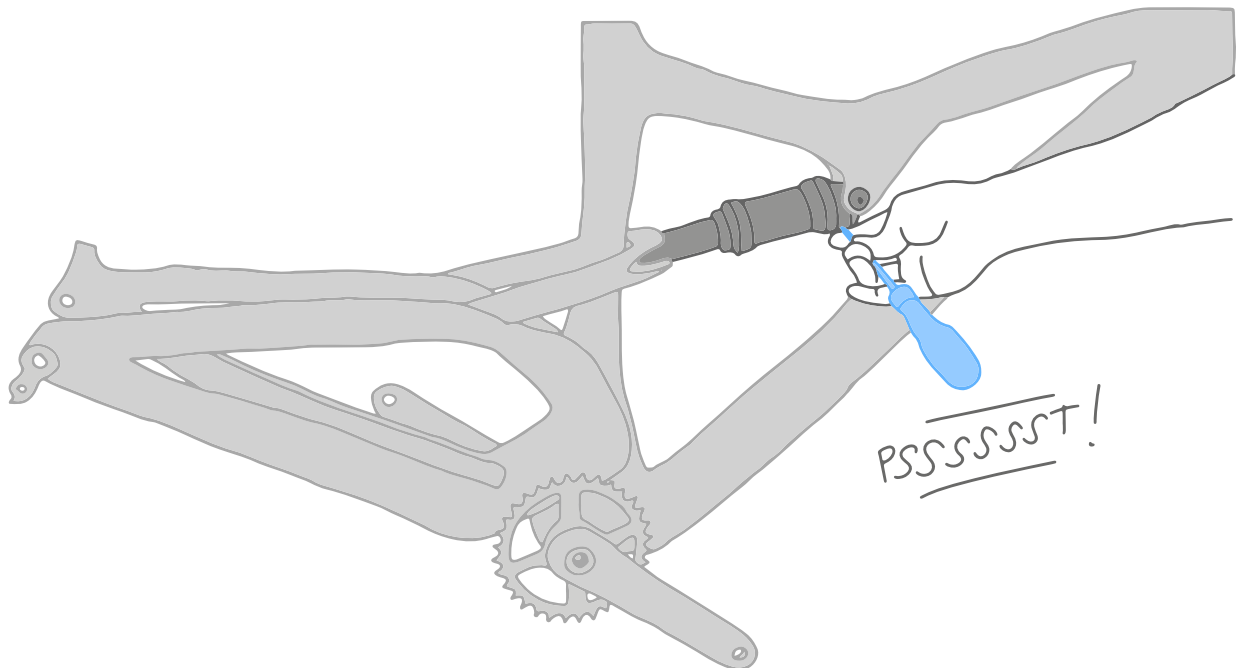

## 6. Chain Sizing

Part II



### Full Suspension Bike Only

Move the rear axle up and down as you measure the distance between **the bottom bracket** and **the rear axle**. Find the position where they are furthest apart and perform the next step at this position.

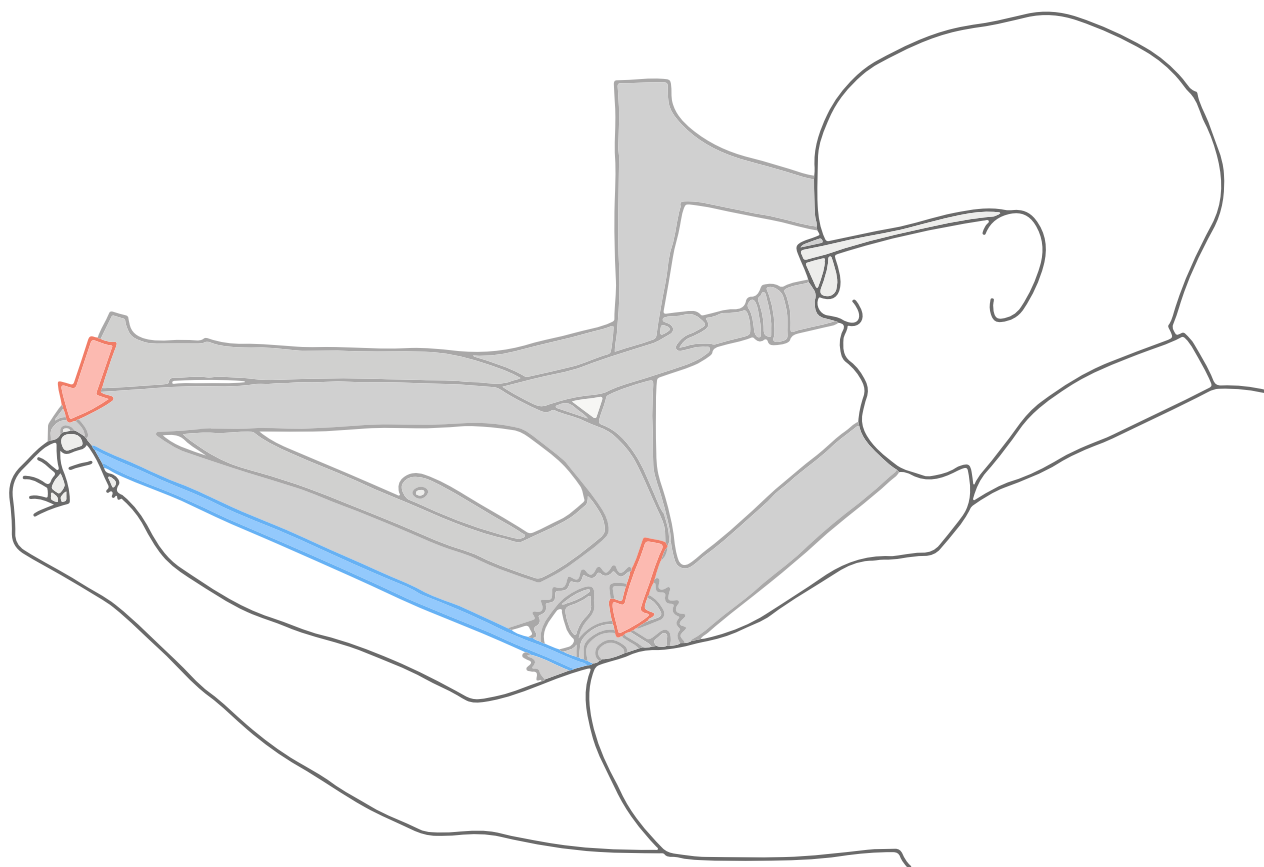



## 6.Chain Sizing

Part III

### Hardtail

Place **two inner links** next to each other on the chainring. **Add one inner link** and **cut the chain there**.

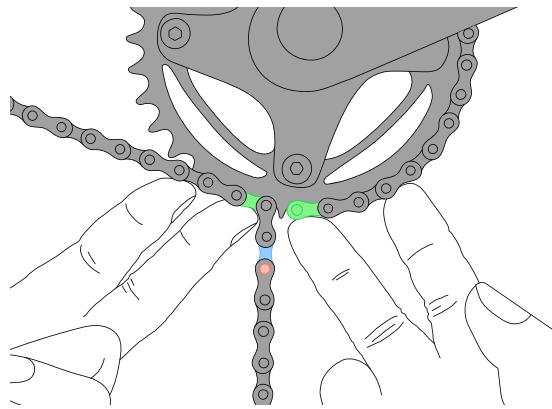

### Dual Suspension

Place **two inner links** next to each other on the chainring. **Add two extra inner links** and **cut the chain there**.

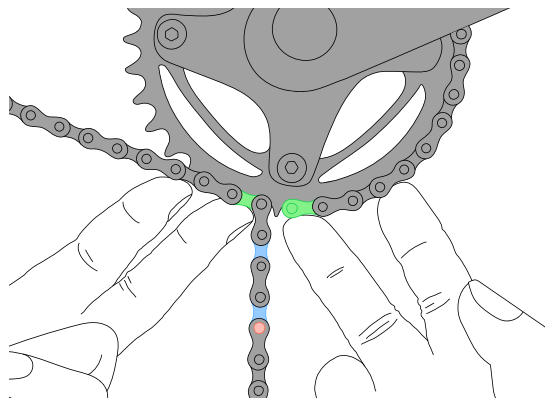

## 6. Chain Sizing

Part IV

Cut the chain using a **chain breaker**.

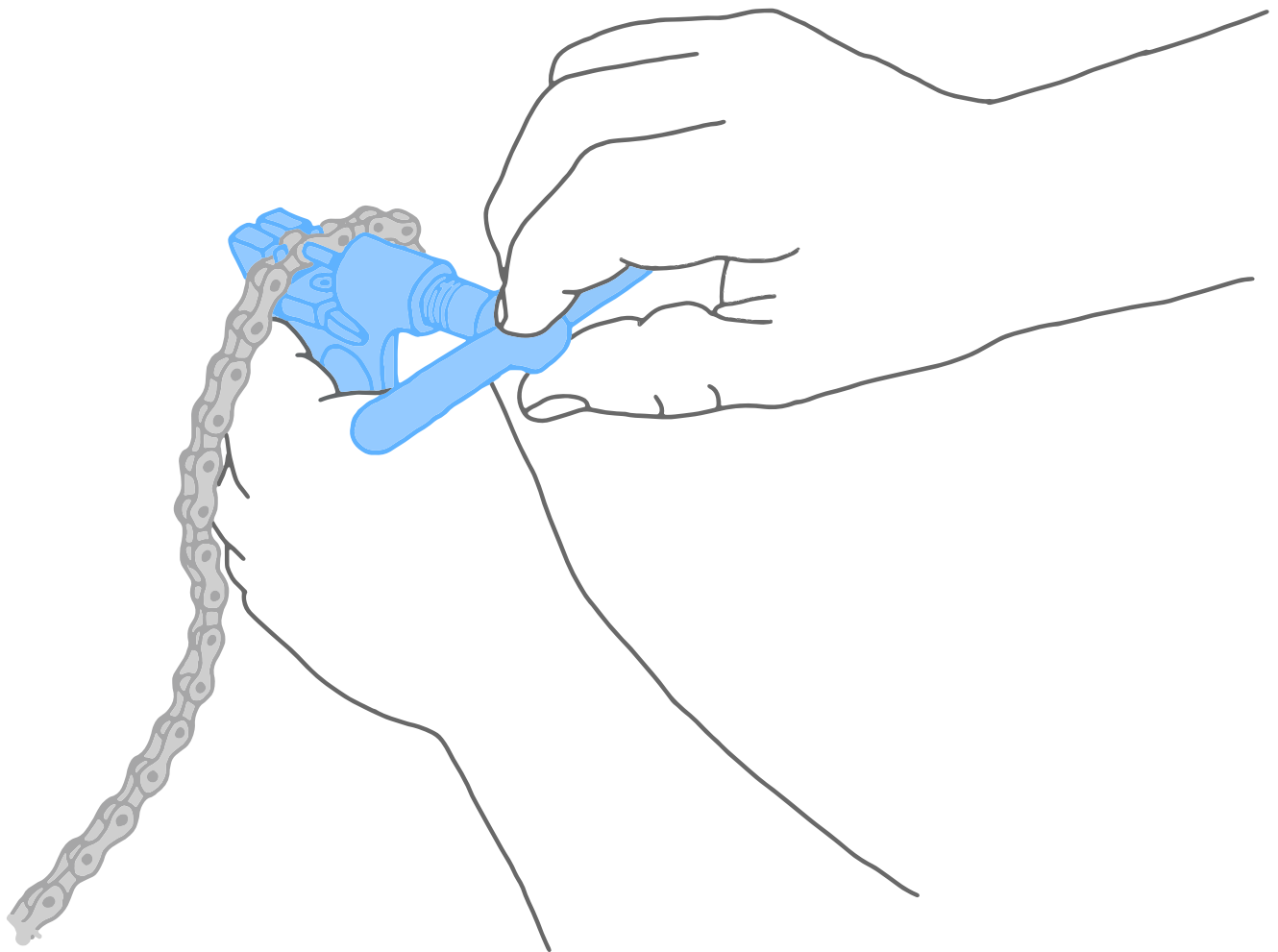

## 7. Chain Installation

Route **the chain** over the smallest cog, in front of the guide pulley, **behind the derailment prevention plate**, and behind the tension pulley. Wrap the chain around the chainring and connect the chain according to the chain manufacturer's instruction manual.

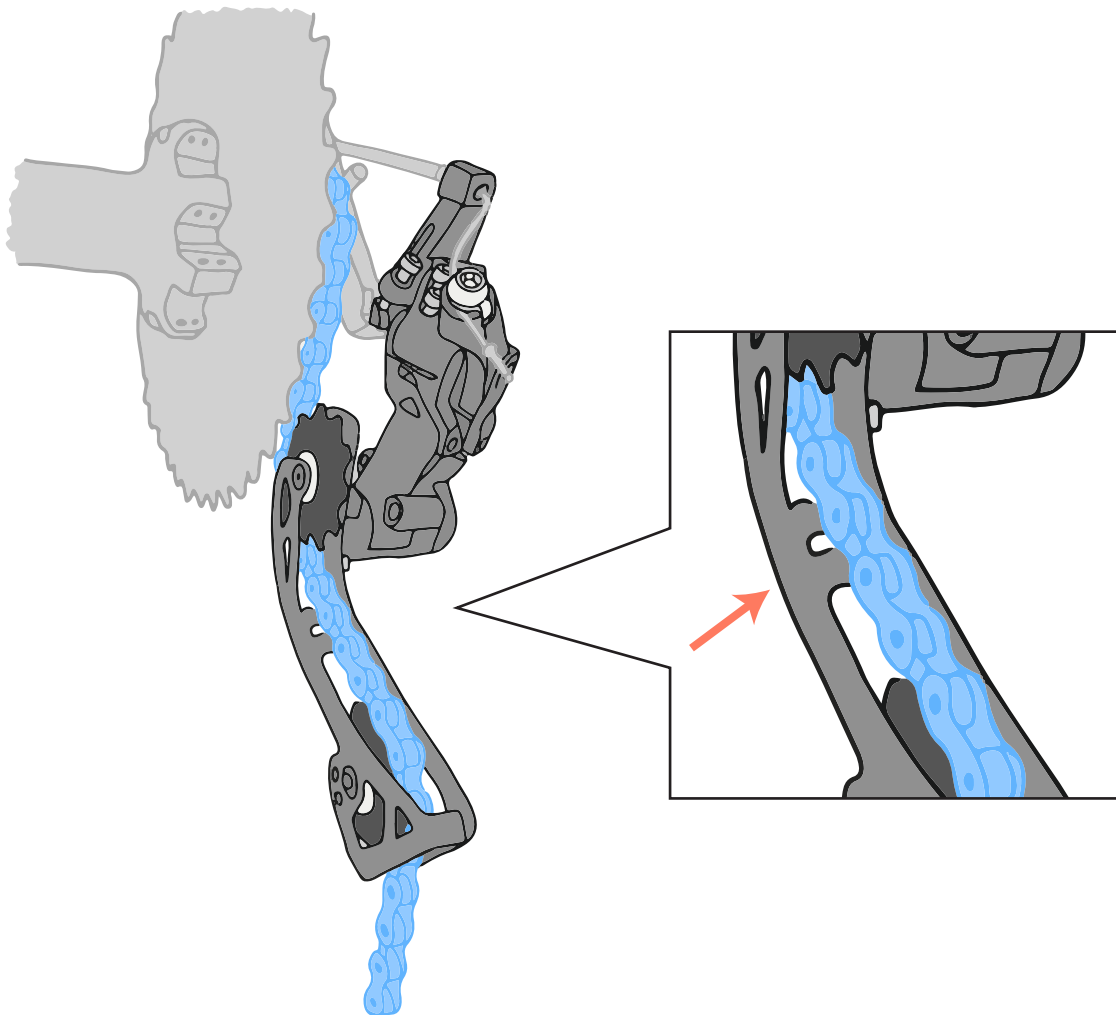

## 8. Shifting Adjustment

Part I



### Clutch Rear Derailleur Only

Before adjusting the shifting, enable the clutch by moving the **switch** on the side of the derailleur to the closed circle position.

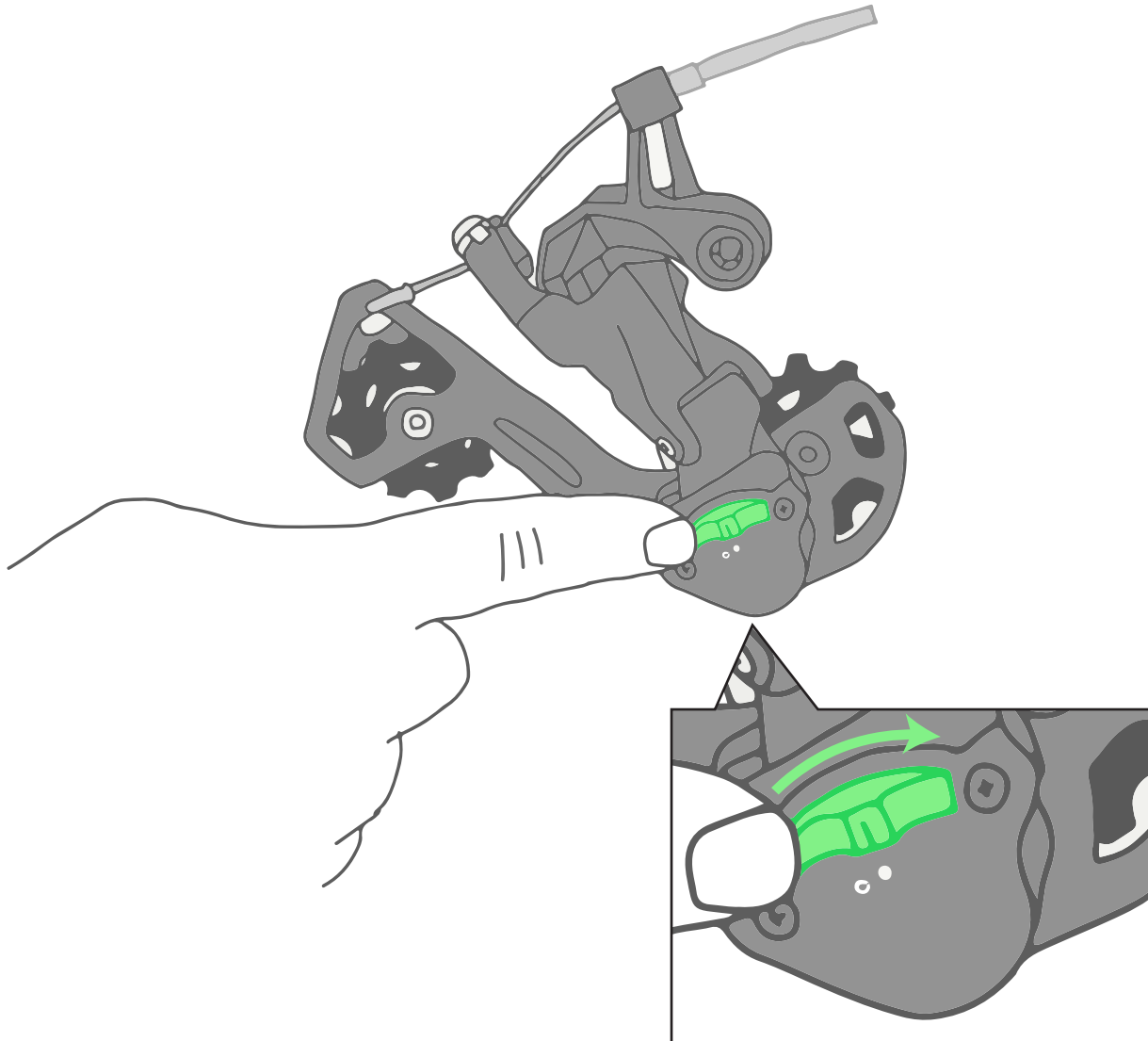

## 8. Shifting Adjustment

Part II

Shift from the smallest cog to the 2nd smallest cog by pressing the **lower thumb trigger lever** on the shifter. If the chain doesn't move, turn the **barrel adjuster** on the shifter counter-clockwise. Repeat until the derailleur shifts to the 2nd smallest cog.

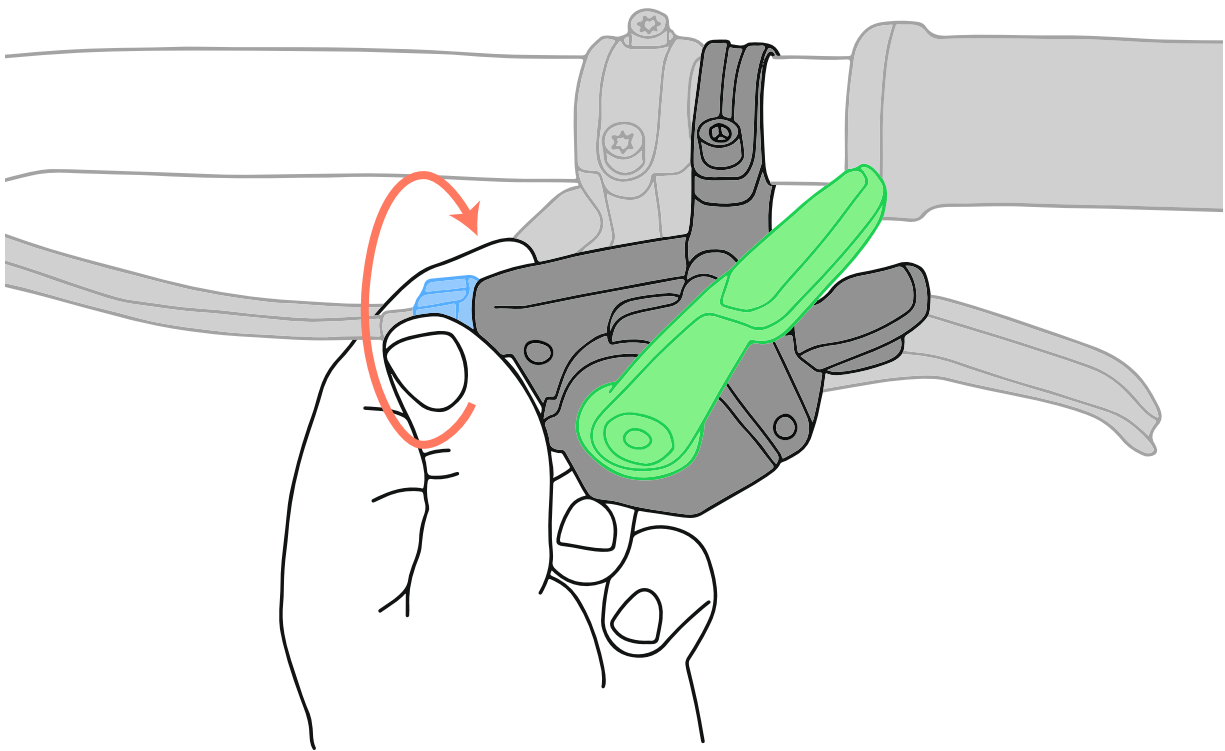

## 8. Shifting Adjustment

Part III

Now make several shifts up and down the cassette. If shifting is slow to move to a larger cog, turn the **barrel adjuster** counter-clockwise. If the shifting is slow to move to a smaller cog, turn the **barrel adjuster** clockwise.

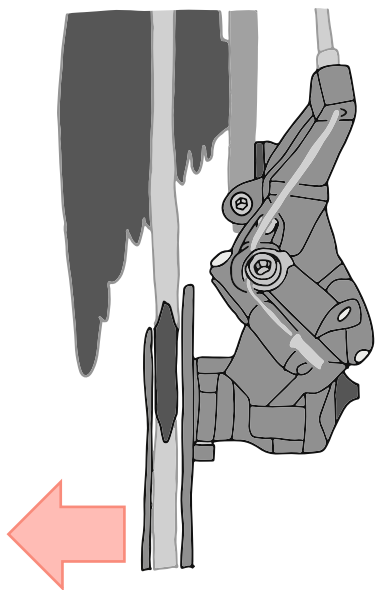

Slow to shift to larger cogs

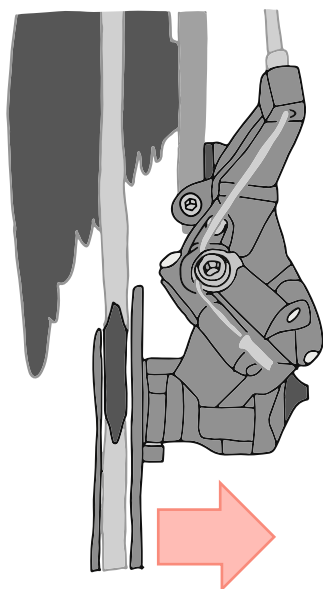
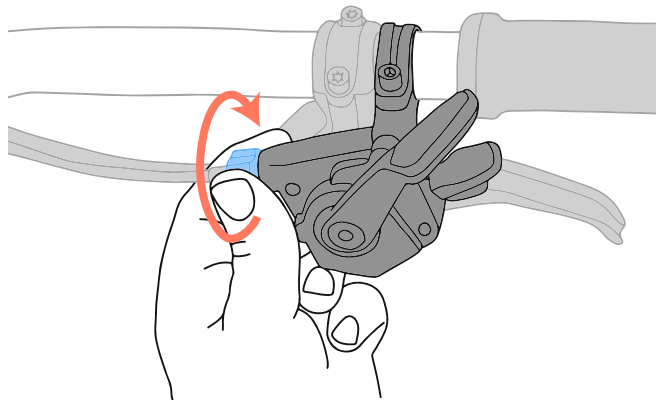

Slow to shift to smaller cogs

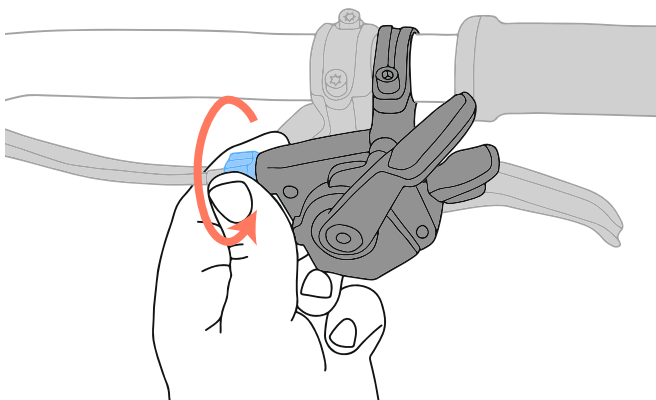

## 9. L-Limit Screw Adjustment

Part I

Shift to the largest cog on the cassette. Using your hand, try to push the rear derailleur past the largest cog. If the derailleur can move past the cog, adjust the low limit screw.

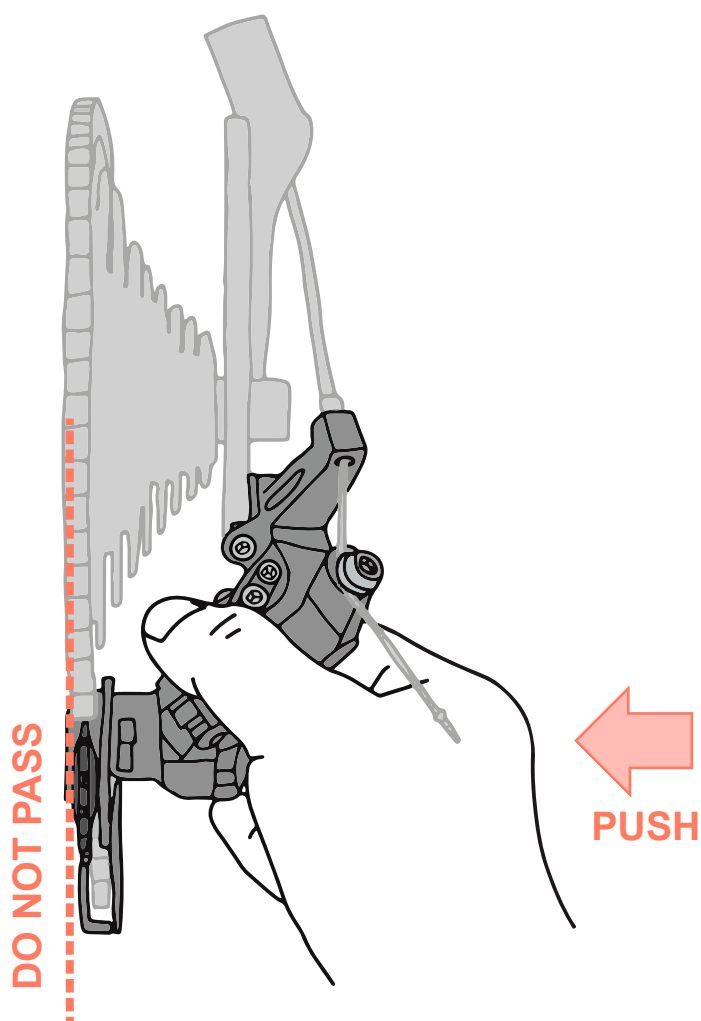

## 9. L-Limit Screw Adjustment

Part II

Tighten the **low limit screw** until you can't move the derailleur past the largest cog. Shift down and back up to the largest cog. If it is slow to shift to the largest cog, loosen the **low limit screw**.

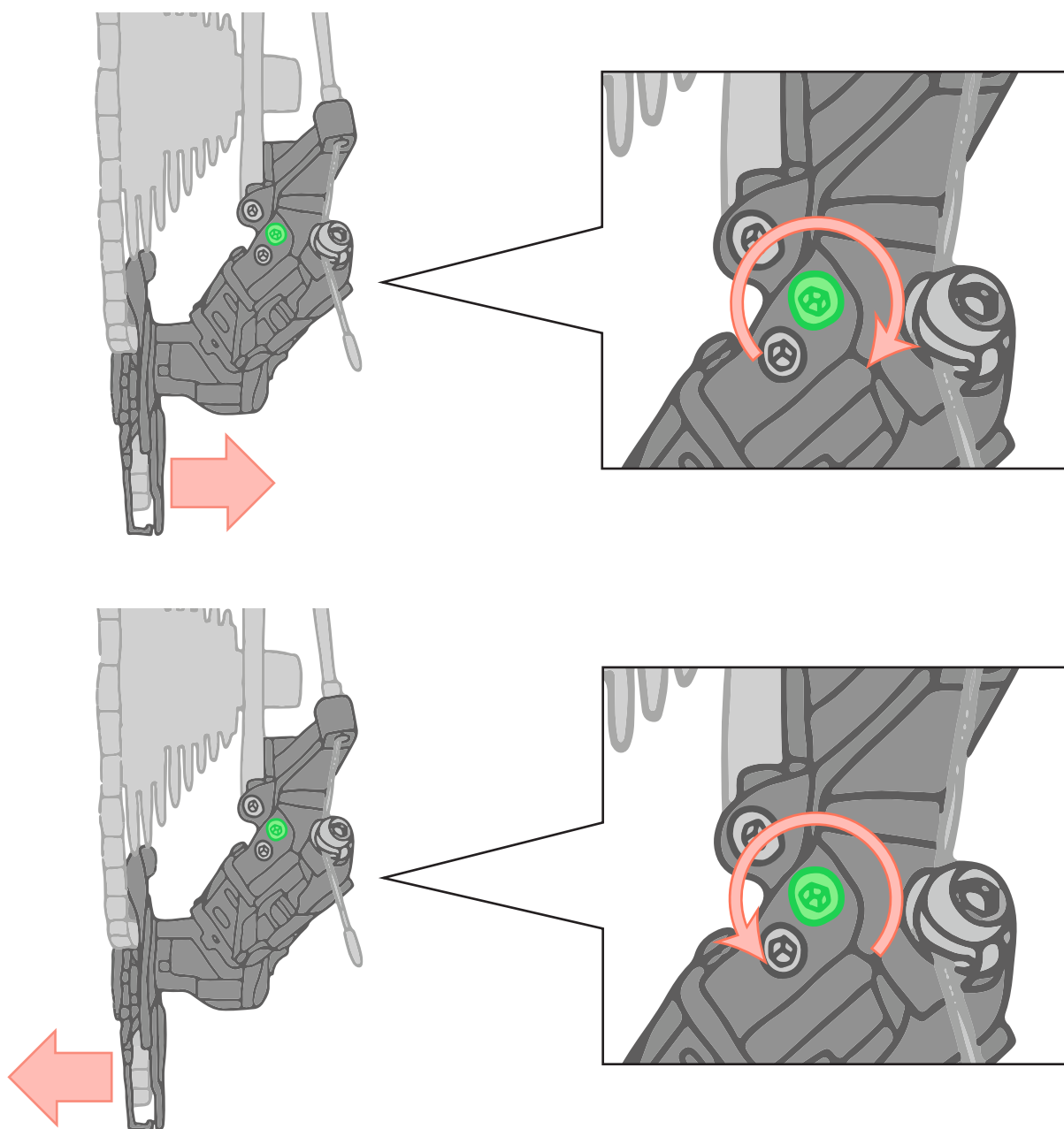



## 10. B-Tension Screw Adjustment

Part I



Identify your derailleur version, and adjust B-tension with the correct tool.

Use Version 1 ADVENT X tool

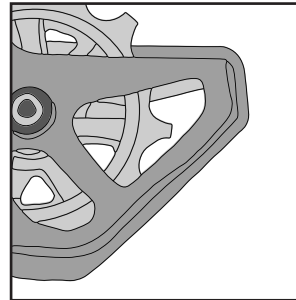

Use Ver. 2 ADVENT X tool

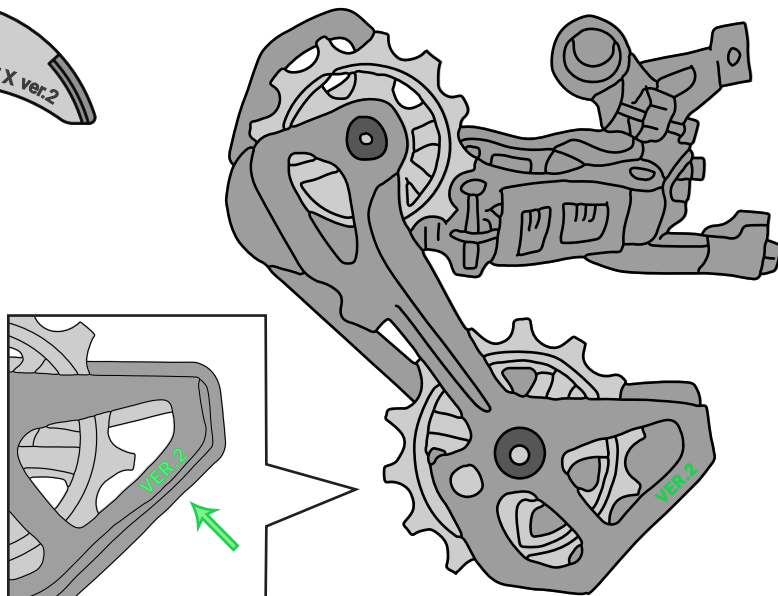
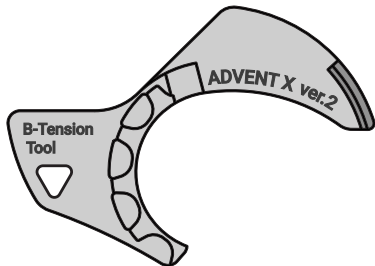

## 10. B-Tension Screw Adjustment

Part II

With the chain in the largest cog, tighten the **B-tension screw** to move the **guide pulley** away from the **the largest cog**.

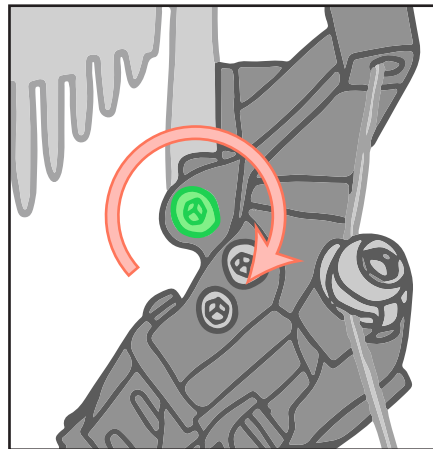
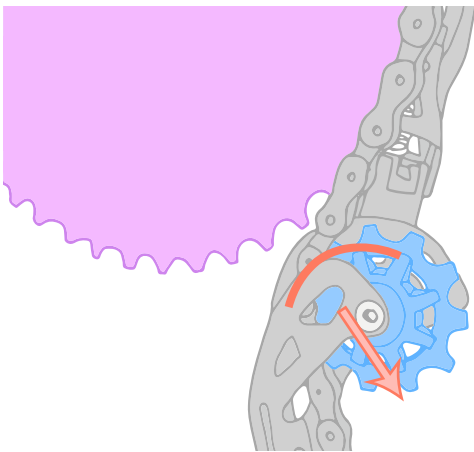

Snap **the derailleur adjustment tool** on to the **guide pulley**. Make sure **the tool** is touching the **chain** but not touching the **cassette cog**. Tighten the B-tension screw if the tool does not have enough room.

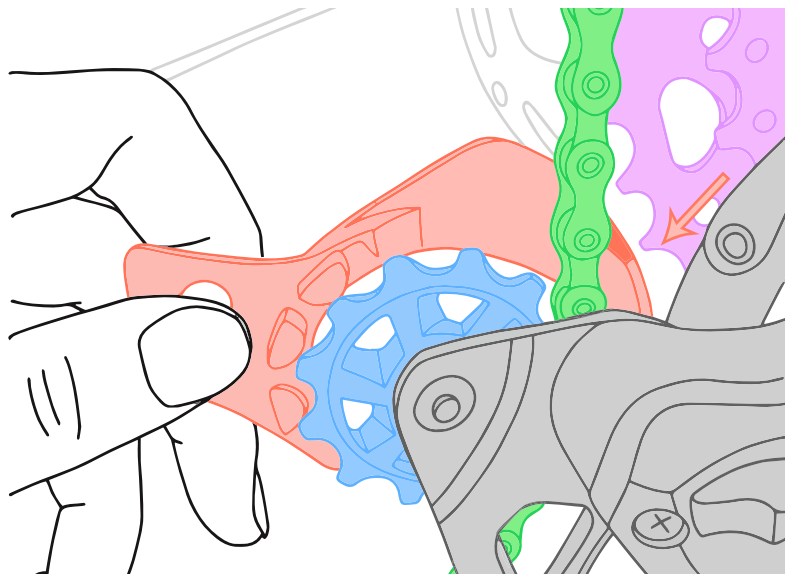

## 10. B-Tension Screw Adjustment

Part III

Loosen the **B-tension screw** until **the derailleur adjustment tool** lightly touches **the tallest tooth of the largest cog**. Remove the tool when finished.

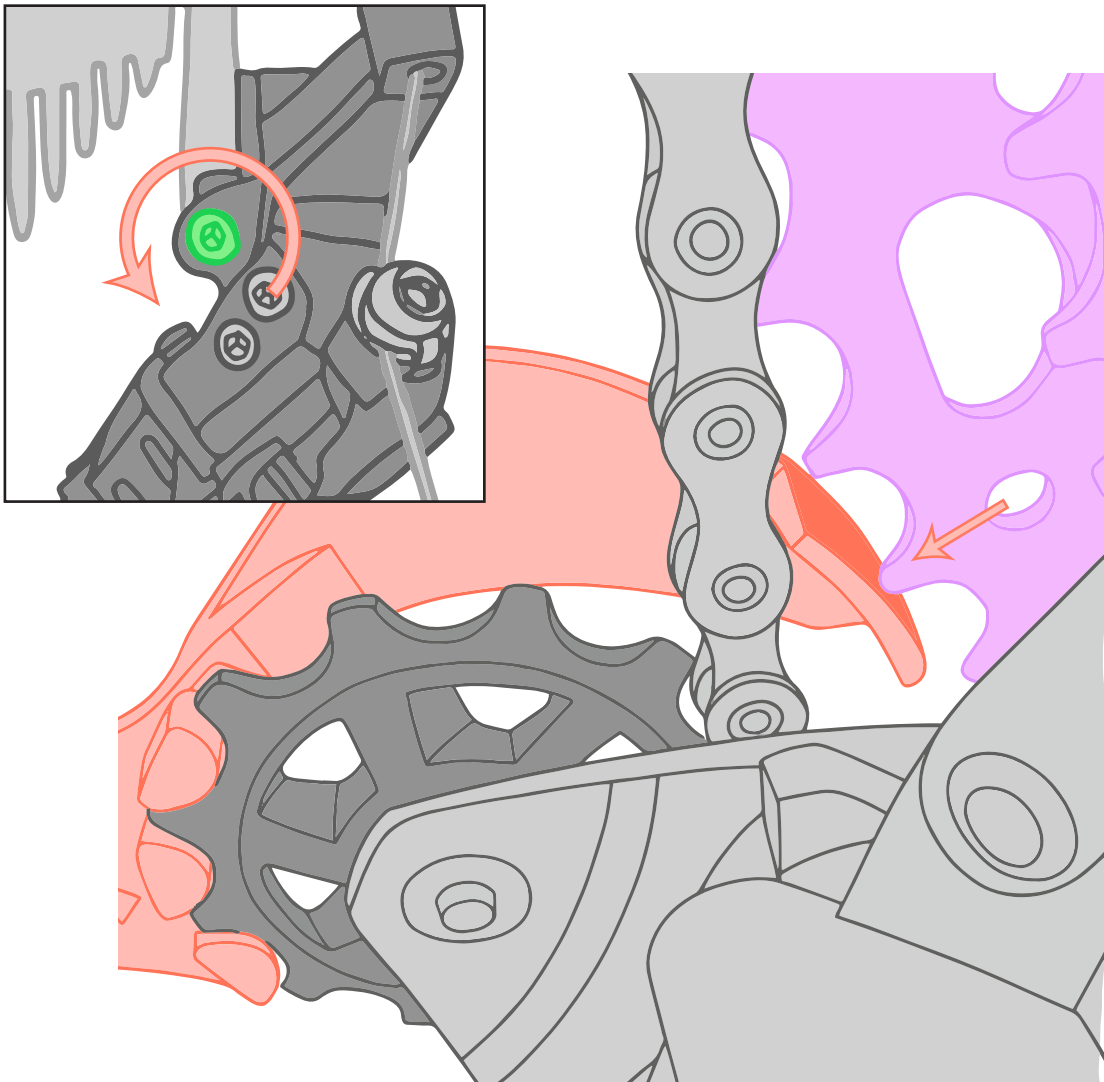

## 10. B-Tension Screw Adjustment

Part IV



Optional: Adjust B-tension WITHOUT an adjustment tool

Adjust the **B-tension** screw until there is a **proper spacing** between the **guide pulley** and the **tallest teeth of the largest cog**.

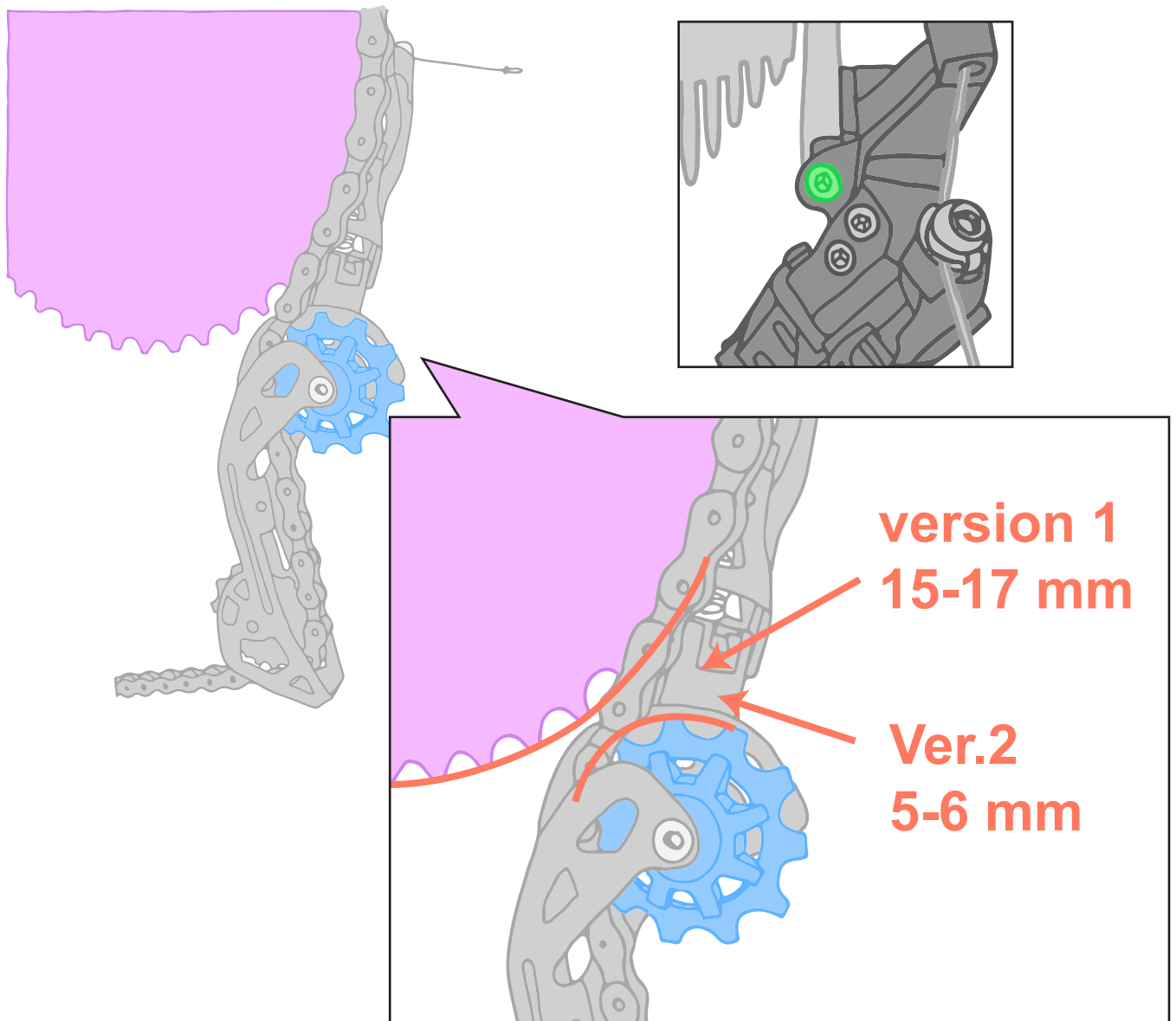

# microSHIFT

---

[www.microSHIFT.com](http://www.microSHIFT.com)

**International**  
[service-tw@microSHIFT.com](mailto:service-tw@microSHIFT.com)

**North America**  
[service@microSHIFT.com](mailto:service@microSHIFT.com)