



Ref.	Qty.	Part#	Description
1	1	2480-100	Mount Plate
2	2	HDW9110	1/2" Hex Bolt
3	2	HDW7078	1/2" Nut
4	4	HDW9048	3/8" Lock Washer
5	4	HDW4146	Plastic Knob

# RM4 Plow Mount Installation Instructions

2009-11 Polaris Ranger 500/700/800 XP

Part Number: 4501-0308

The RM4 Mount kit is designed to allow for quick removal when not needed for plowing. This mount design uses the Ranger front bumper and frame member to push against and distribute the load when plowing. The knob bolt is to lock the mount in place and will not take the load. The retractable pins on the push tube that extend into either side of the mount are to keep the plow in place on the machine and do not take the plowing force, they just hold the plow in position. See below for installation instructions of the mount kit.

## INSTALLATION:

1. The studs and locating pins on the inside of the mount will align with the holes in the front bumper. The threaded studs will line up with the top and bottom holes on each side and the larger locating pins will align with the center holes. The plastic strips help distribute the load and reduce paint wear on the bumper.
2. Hold the mount in place while installing a lock washer and threaded knob onto each of the studs from behind the factory bumper. NOTE: You may need to re-tighten the knobs occasionally after plowing.
3. Install the 1/2" bolts (#3) and 1/2" nuts (#4) into the front of the mount. These are used as droop stops to keep the plow from dropping down too far. Thread them in about half way for now. You can now attach your push tube and plow assembly.
4. Once the complete plow assembly has been installed on the machine, put the blade straight and on the ground. Adjust both droop stop bolts so there is about 3/4" clearance between the bolt heads and the bottom of the push tube. Tighten the lock nuts.



Install lock washers and knobs onto the mount from behind the bumper

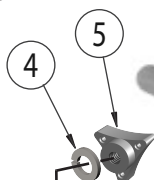
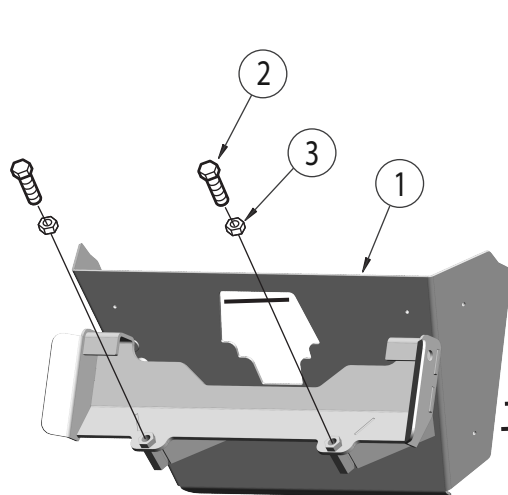

FOR QUESTIONS OR COMMENTS PLEASE CALL THE MANUFACTURER: **763-689-4800**

All images used are copyrighted property of CMP and may not be used without permission.

Inst2480 11/1/10