



Hitch Installation Instructions

HONDA

03'-05' TRX650 Rincon, '06-'12 TRX680 Rincon

P/N: 1226M

Qty.	Component P/N	Description
1	1226-70	Hitch
2	HDW1040	10mm Nylock nut
2	HDW1076	10mm x 50mm Hex bolt

INSTRUCTIONS:

1. Slide the hitch over the 2 holes at the back of the frame per the illustration and install and tighten the provided bolts and nuts.

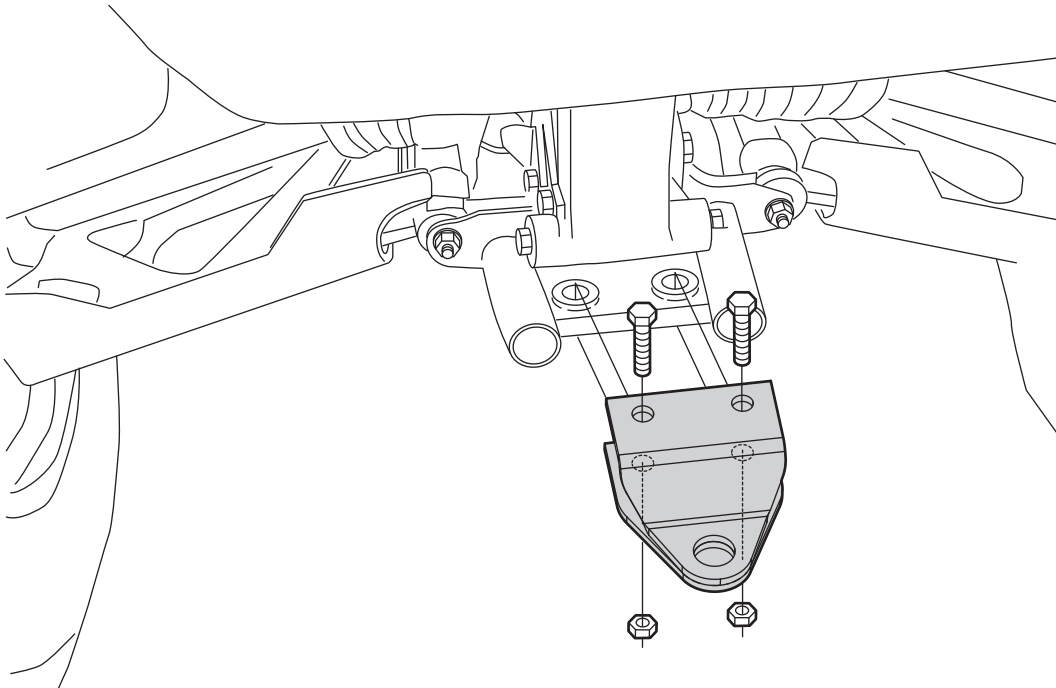

FOR QUESTIONS OR COMMENTS PLEASE CALL THE MANUFACTURER: **763-689-4800**

All images used are copyrighted property of CMP and may not be used without permission.

Inst1226M 10/23/06