



WINCH MOUNT INSTRUCTIONS

01-04 Honda 500 Rubicon

PART# 4505-0658

ITEM	QTY.	PART#	DESCRIPTION
1	1	1559-1	Winch Mount Plate
2	4	HDW9407	7/8" U-Clamp
3	4	HDW2004	1/4 x 1-3/4 Hex Bolt
4	4	HDW7050	1/4 Nylock Nut

1. Remove the front plastic bumper guard.
2. Position the winch mount behind the front bumper and align with the arms of the bumper as illustrated.
3. Install the four u-clamps from the inside out on the bumper arms as shown. Next install the winch mount to the underside on the u-clamps on the bumper arms using the 1/4 x 1-3/4 hex bolts and nuts to secure.
4. Install winch to mount using hardware provided with winch. Cable should come out between winch and winch mount. NOTE: Winch will hang upside down.
5. Install fairlead with hardware provided with winch.
6. Using the instructions provided with the winch, wire accordingly.
7. Before reattaching the plastic front bumper guard, trim the opening where the roller fairlead goes through. The opening is between the (4) mounting bolts of the guard. Trim straight down from the bottom edge of the opening 3-1/2" or to the top of the skid plate behind the guard and then straight across from side cut to side cut, removing this piece.
8. Reinstall the plastic front bumper guard and bolts. Tighten all bolts evenly.

NOTE: Roller fairlead not included with this kit!

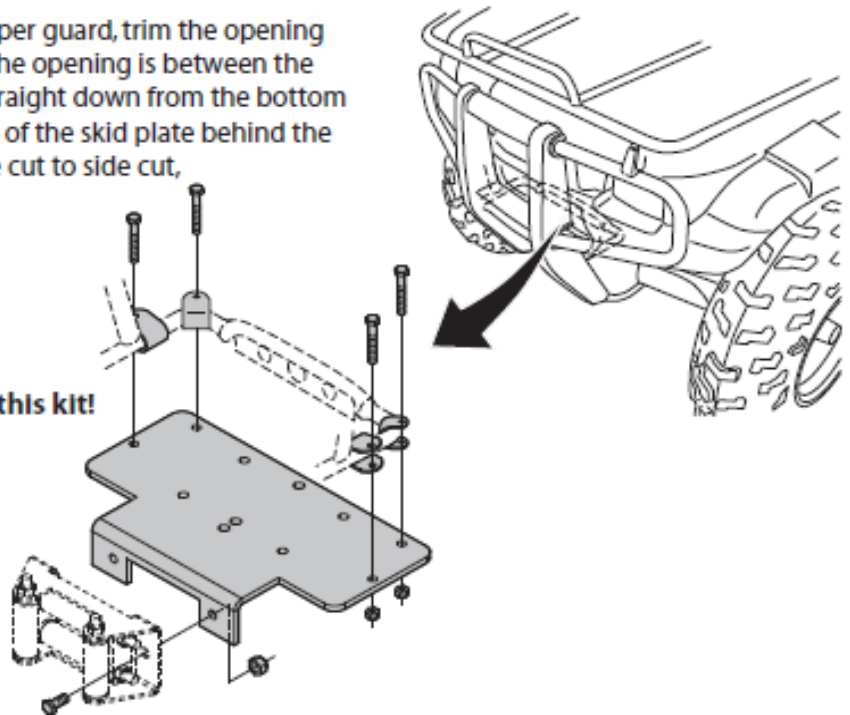

FOR QUESTIONS OR COMMENTS PLEASE CALL: 320-964-1616 (7:00 to 4:30 CST Monday through Thursday).

INST1559PF