



Motion Pro, Inc.  
867 American Street  
San Carlos, CA 94070  
Tel 650.594.9600 Fax 650.594.9610  
www.motionpro.com

# INSTRUCTIONS

## Chain Breaker and Riveting Tool P/N 08-0058

Thank you for purchasing the Motion Pro Chain Breaker and Riveting Tool. This tool is designed for light to medium-duty use. It will break chains up to size #630, press master link plates on chains up to #530, and rivet **hollow nosed master link pins** on chains up to #630. For heavy-duty applications or for solid-nosed riveting please refer to Motion Pro part number 08-0135 Jumbo Chain Tool and part number 08-0142 Quad Stake Riveting Tool.

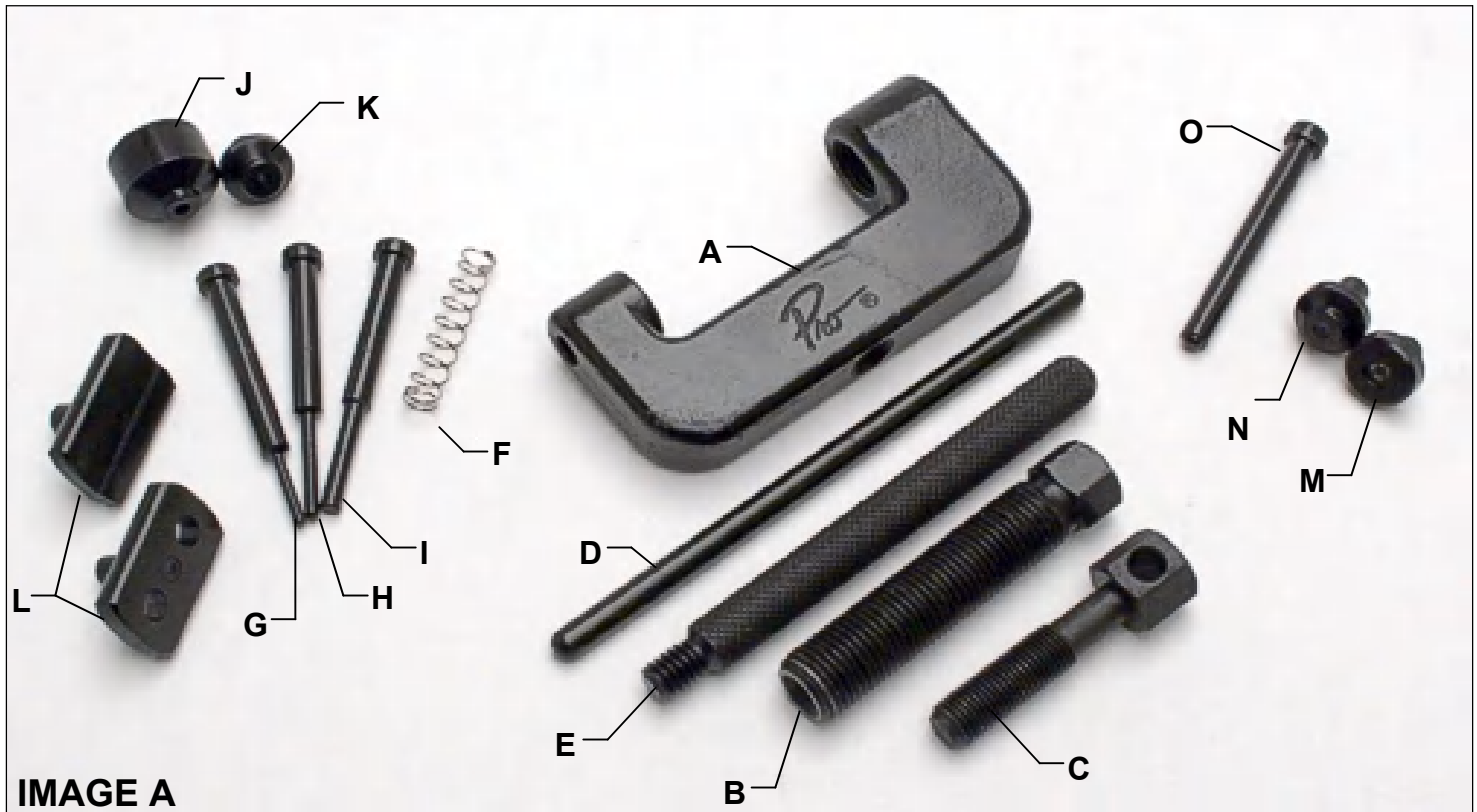

- |                                     |  |  |
|-------------------------------------|--|--|
| A – Body, <u>C08-058A</u>           | F – Spring, <u>C08-001D</u>            | K – Lower Guide for 2.2mm tip          |
| B – Alignment Bolt, <u>C08-058B</u> | G – 2.2mm Breaking Tip, <u>08-0059</u> | L – Press Plates (set), <u>08-0067</u> |
| C – Push Bolt, <u>C08-058C</u>      | H – 2.9mm Breaking Tip, <u>08-0060</u> | M – Large Anvil, <u>C08-058D</u>       |
| D – Lever                           | I – 3.8mm Breaking Tip, <u>08-0061</u> | N – Small Anvil                        |
| E – Handle                          | J – Upper Guide for 2.2mm tip          | O – Rivet Tip, <u>08-0062</u>          |

**-Read all instructions for each procedure before beginning. Improper use of the tool can cause breakage.**

-Make sure the tool is clean and apply grease to all threads before assembling and using. This will help the tool operate more smoothly and allow you to feel tension when using the tool.

**-When breaking #520 or larger drive chain, it is recommended to grind off the rivet heads first.** This will significantly reduce the load on the tool and help prevent premature wear or damage to the breaking tips.

-All tightening procedures are to be performed **by hand only**, using the lever or a 14mm wrench. **Do not use extensions or power tools** of any kind or the tool may be damaged.

## BREAKING CHAINS

Use *only* the correct breaking tip for your application, or you will damage the tip.

2.2mm breaking tip for most cam chains.

2.9mm breaking tip for chains #25 - #35 only.

3.8mm breaking tip for drive chains #428 - #630.

Assemble the tool as shown in **Image B** and the diagram below for breaking chains. Thread the alignment bolt into the body. Insert the breaking tip into the spring and drop them into the alignment bolt with the spring under the tip head. Thread the push bolt into the alignment bolt above the tip. (When breaking cam chains with the 2.2mm breaking tip, the 'Upper Guide for 2.2mm Tip' will be threaded onto the alignment bolt and the 'Lower Guide for 2.2mm Tip' will be placed in the hole in the tool body to support the 2.2mm breaking tip. Cover the cam chain tunnel with a rag to prevent parts from falling into the motor.) **Image B** shows a drive chain in place.

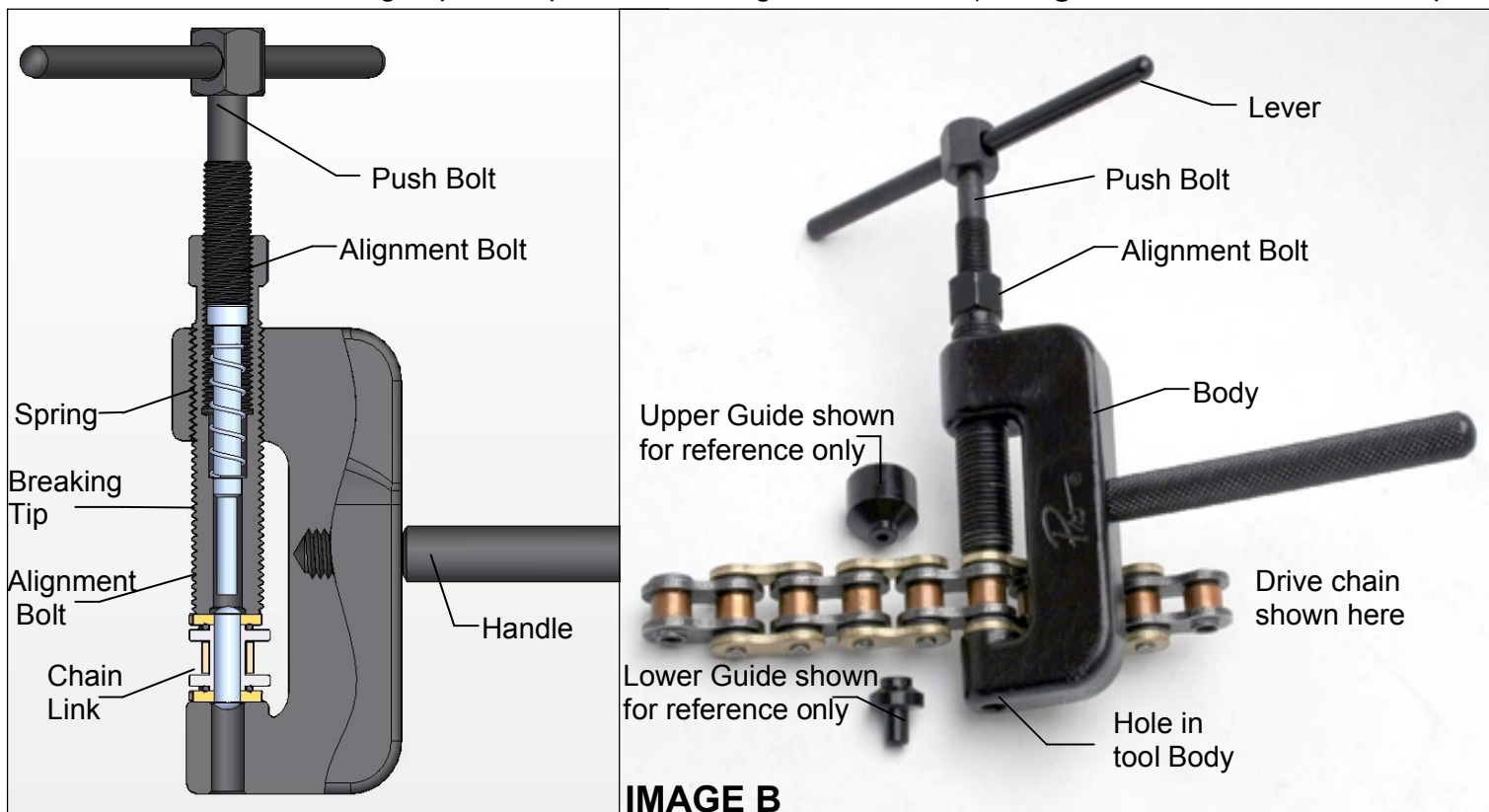

**IMAGE B**

1-Place the tool over the chain as shown in **Image B**. The breaking tip must be withdrawn at least 2mm into the alignment bolt to clear the end of the chain pin. Do not withdraw the breaking tip too far into the alignment bolt or it can get hung up inside the alignment bolt. One end of the chain pin will be held in position by the end of the alignment bolt, while the other end is held in position by the hole of the tool body.

2-Tighten the alignment bolt **securely against the side plate** of the chain, but do not over-tighten or the alignment bolt and tip could drift out of position. The alignment bolt is for aligning and supporting the breaking tip, so do not attempt to break the chain with the alignment bolt retracted or you will damage the breaking tip.

3-**Read this step all the way through before beginning.** Tighten the push bolt **by hand only** with the lever or a 14mm wrench until the chain pin is pushed completely out and through the hole in the tool body. You will feel some initial tension as the chain pin begins to shear, but afterwards the breaking tip should push smoothly into the chain link. **IMPORTANT:** If the chain pin doesn't start to break free, or you don't feel the breaking tip going into the chain link smoothly, back out the alignment bolt just enough to check that the breaking tip is correctly lined up with the chain pin. Once the breaking tip and chain pin are aligned properly, tighten the alignment bolt back down and start over at the beginning of this step. **Do not** apply excessive force or use air tools or you may damage the tool.

## PRESSING SIDE PLATES

Assemble the tool as shown in **Image C** for pressing side plates. The alignment bolt will be threaded into the body, with the **breaking tip, spring and push bolt removed**. The press plate with the holes will be inserted into the alignment bolt, and the press plate with the groove will be placed in the hole in the tool body.

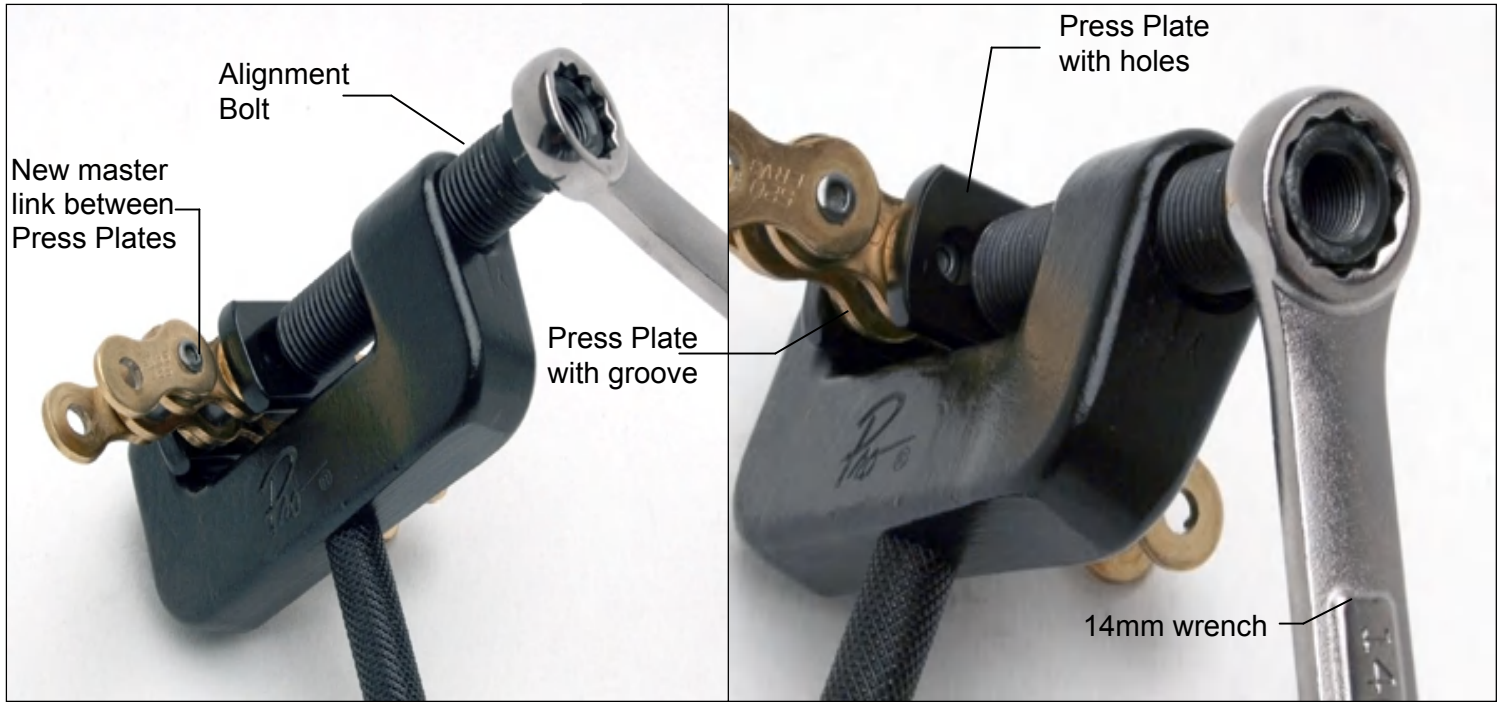

**IMAGE C**

**IMAGE D**

1-Assemble the new chain with the master link, side plate and o-rings (if applicable) **as specified by the chain manufacturer**. Position the assembled master link in the tool as shown in **Image D**. The side plate with the pins will be placed against the grooved press plate, and the side plate with the holes will be placed against the press plate with the holes.

2-Lightly hand-tighten the alignment bolt until the press plates touch the master link side plates. Check that the master link chain pins are properly aligned with the groove and holes in the press plates before final tightening.

3-Using a 14mm wrench, tighten the alignment bolt until the chain pins protrude past the face of the side plate. For clip type master links, the pins should protrude enough to install the clip into the grooves in the chain pin. For rivet type master links, the chain pins should protrude enough to be properly flared over the side plate. A simple technique is to measure the width of the side plates on an adjacent link with a caliper, and then press the master link side plate on until you achieve the same width dimension.

**\* Refer to the chain manufacturer's specifications for distance of chain pin protrusion, and direction and installation of master link clips. All chains are different, and Motion Pro cannot provide the exact specifications for your chain.**

## RIVETING CHAIN PINS

Assemble the tool as shown in **Image E** for riveting hollow-nosed master link pins. Thread the alignment bolt into the body. Insert the rivet tip into the spring and drop them into the alignment bolt with the spring under the tip head. (Refer to internal diagram with Image B). Thread the push bolt into the alignment bolt above the tip. Place the anvil in the hole in the tool body per **Image G**. (Small anvil used for up to 3-series cam chains only).

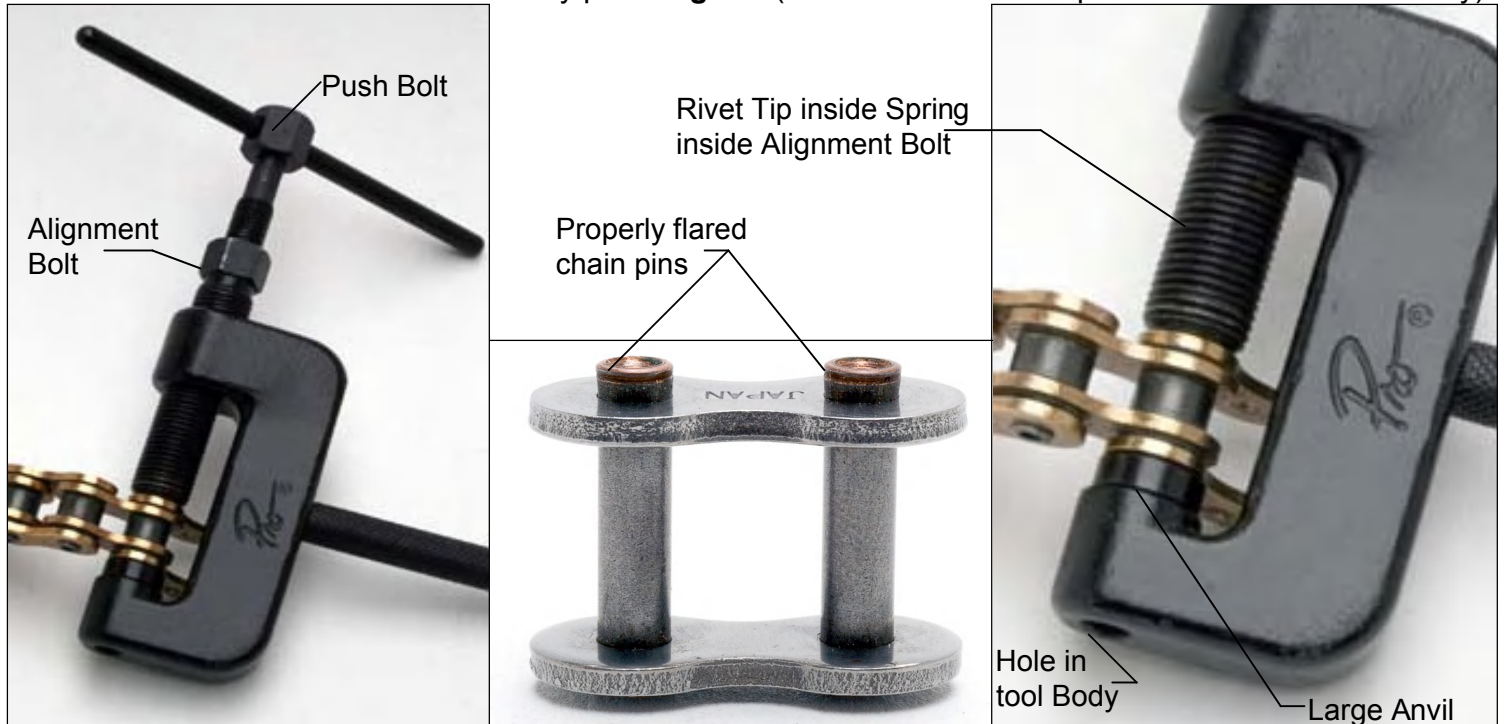

**IMAGE E**

**IMAGE F**

**IMAGE G**

1-The new master link side plates should already be pressed (see [Pressing Side Plates](#)) so that the chain pin protrudes past the face of the master link's side plate. Refer to the chain manufacturer's specifications for the proper protrusion distance. Do not attempt to re-use broken master links, or use a clip on a rivet type master link. Position the tool over the chain pin to be riveted, with the hollow end of the chain pin facing the rivet tip, and the solid end facing the anvil.

2-Make sure the rivet tip is withdrawn enough to clear the end of the chain pin. Tighten the alignment bolt **securely against the side plate** of the chain, but do not over-tighten.

3-Using the lever or a 14mm wrench, tighten the push bolt very tightly until the rivet tip spreads the hollow nose of the chain pin. The end of the chain pin should be flared over the side plate just enough so that the side plate is solidly held in place. Repeat this procedure on the other chain pin. The amount of flare of a rivet -type master link varies among chain manufacturers. Some specify as little as 0.006" and generally no more than 0.028". This is a very small amount of flare. Do not attempt to flare the chain pin flush with the side plate, or the chain pin can crack and be weakened, and you risk damaging the tool as well. Measure the un-flared chain pin with a caliper, and then check the flare often with the caliper to insure you do not over-flare the chain pin. One turn of the push bolt equals one millimeter of travel, so a typical flare will require less than a full turn. **Image F** shows a properly flared hollow-nosed master link.

4-Withdraw the tool from the chain, and visually check that both chain pins show the same size flares. Check that the riveted-on side plate is in alignment with the side plates of adjacent chain links.

**\* It is very important that chain master links be clipped or riveted properly. Improper installation can lead to great bodily harm or death. If you are unfamiliar or uncomfortable with this process, please have your work supervised by a qualified technician or bring your vehicle to a qualified facility for repair.**