

Description:	Quantum® Hardcoated Polycarbonate, 6mm UTV Windshield, Full Size	Model:	BRP Commander
Part Number:	N30401	Installation Time:	30 min.

Thank you for purchasing a National Cycle product. Read these instructions carefully and thoroughly before beginning work. Dealers, if installing this windshield for a customer, please give them this manual. It contains information needed to properly maintain and use this product.



**Attention:**

Special notes and cautionary measures which can prevent damage to the accessory or vehicle.



**Note:**

Tips for facilitation of operation, control and adjustment, as well as maintenance work.

**PREPARATION**

This Kit has been carefully packed and inspected at the factory. Report any missing part directly to National Cycle, Inc. along with the Bag No. and Date on outside of Windshield Carton.

Carefully unpack the windshield, sort the parts, and make sure you have everything required to complete the installation to the vehicle.

**TOOL LIST**

Flat Blade Screwdriver

#2 or #3 Phillips Screw Driver or Phillips Bit for Drill

7/16" Wrench or Driver

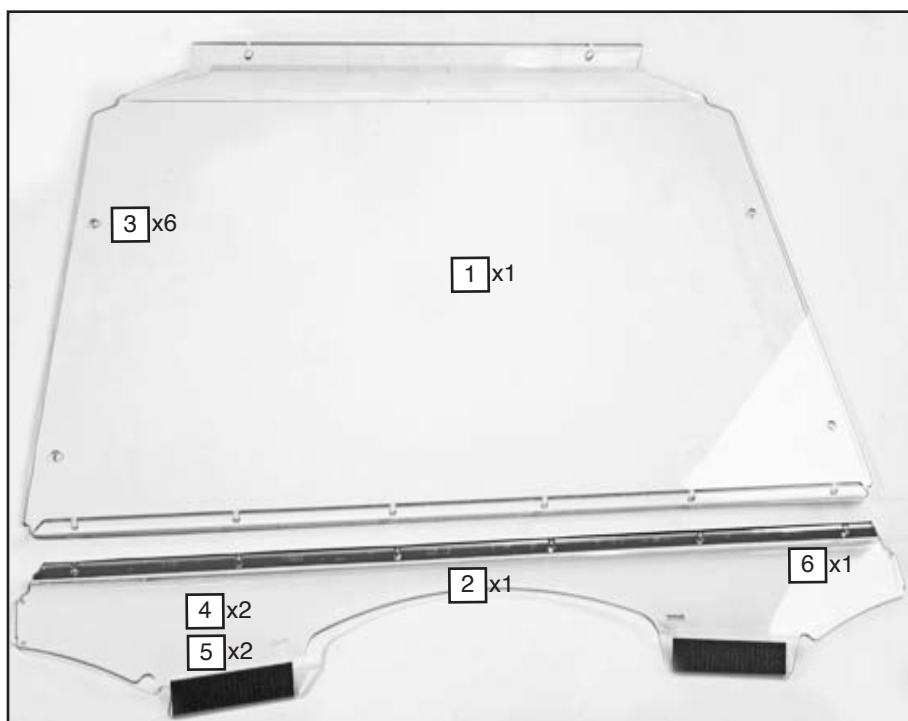

**Parts Installed on Two-Part Windscreen**

**Tools Required**

Item	Part No.	Description	Qty.	Notes and Tools
1	20-290407-000	Windscreen, Upper Section	1	Grommets Installed
2	20-290481-000	Windscreen, Lower Section	1	Grommets and Velcro Fastener Installed
3	44-447159-000	Grommets for Windshield	6	Installed on Windscreen
4	77-771157-000	Marine Grade Velcro, Hook	2	Installed on Windscreen
5	77-771158-000	Marine Grade Velcro, Loop	2	Installed on Windscreen
6	44-447004-000	Foam Tape, 1/8 x 1" W	1	Installed on Windscreen

**Parts List Continues on Next Page**

### BAG#1144

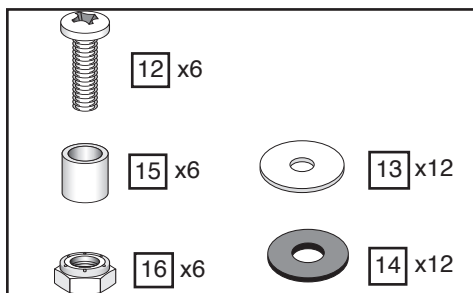

Keep this page as a reference guide during the assembly process.

### BAG#1139

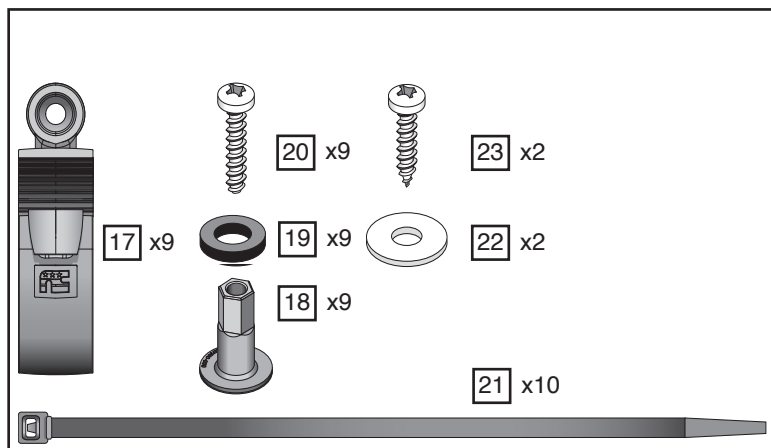

Parts Included in Bags				Tools Required
Item	Part No.	Description	Qty.	Notes and Tools
<b>Bag#1144</b>				Parts to attach upper and lower screens
12	55-563145-000	Screw, Phillips, 1/4-20 x 1.25"	6	#2 or #3 Phillips Screw Driver
13	49-490491-000	Washer, Flat, .265 x .875 x .062"	12	
14	75-762021-000	Washer, Rubber, 7/8 OD x 3/8 ID	12	
15	34-346056-000	Spacer, .375 x .277 x .69"	6	
16	42-423242-000	Nut, Nylon Insert, 1/4-20	6	7/16" Wrench or Driver
<b>Bag#1139</b>				
17	44-449372-000	Clamp, Wraparound	6	
18	44-449380-000	Retaining Pin	6	
19	49-490355-000	Washer, Flat, Black	6	
20	55-563131-000	Screw, Phillips, #12 x 1.25", SS	6	#2 or #3 Phillips Screw Driver

## WINDSHIELD INSTALLATION

### ATTACH UPPER AND LOWER SHIELD TOGETHER

1. Assemble six hardware sets using the Panhead Machine Screw (12), Flat Zinc Washer (13), Rubber Washer (14) and Windshield Spacer (15).

#### Illustration A

2. Insert the assembled components into each of the mounting holes where the lower edge of the Windshields Upper Section meets the top edge of the Windshields Lower Section. Make sure the Windshield Spacers do not come loose and fall out.

#### Illustration A

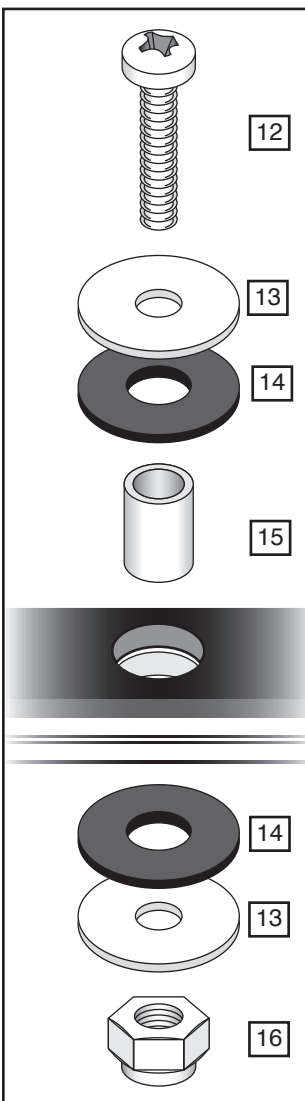



Illustration A

3. From the bottom of the two edges, assemble a Rubber Washer (14), Flat Zinc Washer (13), and Nylon Insert Nut (16), and tighten the Nuts finger-tight for now.

#### Figure 20

 The Spacers (15) should fit through the Rubber Washers (14) and up against the metal washers (13).

4. Make certain the Upper and Lower Windshields are flush with each other and the side edges are in line.

5. Tighten the 6 Screws (12) and Nuts (16) securely.

#### Figure 20



Figure 20

During step 1, the windshield will not be in position.



Figure 21

Illustration B

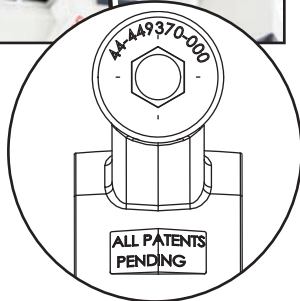

## WINDSHIELD INSTALLATION

1. Snap 2 Wraparound Clamps (17) on the top frame of the vehicle. Orient the top clamps facing up and male half (with embossed part number) toward the front of the vehicle.

### Figure 21 and Illustration B

 Read these helpful tips for a smooth installation:

Place fasteners within reach of assembling clamps.

Note the hex shape of Retainer Pin (18), and male Clamp (17) half.

Place Spacing Washer (19) between Grommets (3) and Clamps (17).

Start Machine Screws (20) but do not tighten.

The tabbed section of the Windshield should be touching the hood of the vehicle.

2. Place Windshield on hood. Using Screws (20) install top Clamps (17), but do not fully tighten.

### Figure 22, 23 and Illustration C (Phillips Screwdriver or Power Drill on low setting)

3. Snap the remaining 4 Wraparound Clamps (17) on the frame of the vehicle. Orient the clamps so that the male half (with embossed part number) is toward the front of the vehicle. Install Clamps, but do not fully tighten.

### Figure 21, 22, 23 and Illustration B,C (Phillips Screw Driver or Power Drill on low setting)

4. Check the alignment and position of the windshield and make sure it is even and symmetrical.



Figure 22

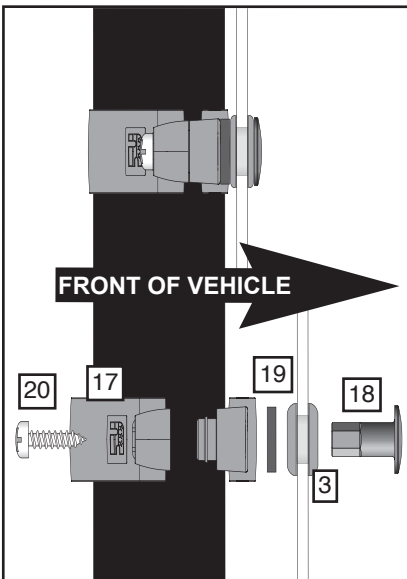

Illustration C

Perspective from top of top frame looking down.



Figure 23



Figure 24

**WINDSHIELD INSTALLATION, continued**

5. Remove the adhesive backing from the Velcro loop material and then press the windshield tab firmly onto the hood of the vehicle.

**Figure 24**

**FINAL TIGHTENING**

1. Securely tighten the Machine Screws (20) in all Wrap-around Clamps (17). **(Phillips Screw Driver or Power Drill on low setting)**

**Enjoy Your New UTV Windshield!**

**CLEANING AND MAINTENANCE**

To clean the screen, wash with a clean soft cloth, plenty of warm water and if necessary, a non-abrasive soap such as dishwashing liquid. Flannel or soft chamois make good cleaning cloths. **Paint, glue residue or grease removal:** Moisten cotton with naphtha or turpentine followed by a wash as above.

National Cycle **Shield Wash™** (N1401-01) makes a good daily cleaner and comes with a handy travel size bottle. Shield Wash is safe for all windshields and helmet visors.

Do not clean polycarbonate in hot sun or high temperatures. Do not clean the screen with glass cleaners. Do not allow brake fluid, alcohol, or strong solvents to contact the screen.

**RAIN REPELLENT**

Do not use rain protective products made for glass. We recommend National Cycle's **RainZip®** (N1410-01) to help shed water in rainy weather.



**Register your windshield online at [www.nationalcycle.com](http://www.nationalcycle.com)**

**National Cycle's UTV Windshield 3-Year Limited Warranty**

National Cycle hereby warrants to the original registered owner of a National Cycle polycarbonate windshield for a period of three years from the date of purchase against breakage. This limited warranty is expressly limited to the replacement of the polycarbonate windscreen. This limited warranty does not include scratches, coating failure, cosmetic wear and tear, replacement of hardware, or any consequential damages or expenses including labor cost of installation, removal and/or replacement, inconvenience, inbound or replacement outbound freight expenses (outbound freight must be paid in advance by cc or check) or damage to any other component of the vehicle or any other accessories. Certain chemicals, generally known as acidic hydrocarbons, are known to cause polycarbonate damage and will not be covered under this limited warranty. Please refer to the cleaning instructions supplied with your UTV Windshield.

**⚠ WARNING**

Never operate your vehicle with loose accessory mounting hardware. Check the hardware for tightness regularly.

UTVs are built with enough frame rigidity to withstand the moderate loads imposed on them by the foreseeable addition of an accessory(ies). If an accessory(ies) adversely affects your vehicle's stability, immediately remove the accessory(ies). Do not operate a vehicle that exhibits unsafe handling traits.

Have experienced service personnel correct any problem before driving with the accessory(ies) installed. For further questions concerning handling problems associated with an accessory(ies), contact your dealer, UTV manufacturer, or accessory manufacturer.

**CAUTION:** Do not clean polycarbonate in hot sun or high temperatures. Do not clean the screen with glass cleaners. Certain chemicals, generally known as acidic hydrocarbons, are known to cause polycarbonate damage. Do not allow brake fluid, alcohol, or strong solvents to contact the screen.

**CAUTION:** Do not use rain protective products made for glass. We recommend National Cycle's **RainZip®** (N1410-01) to help shed water in rainy weather.

**CAUTION:** Always face windshield forward (in direction of travel) while carrying on truck or trailer.