

RAM-B-342U INSTALLATION INSTRUCTIONS

PARTS LIST

- A- 1 QTY. RAM STEM BASE CASTING WITH 1" DIA. BALL
- B- 1 QTY. RUBBER EXPANSION PLUG
- C- 1 QTY. EACH 5mm ID X 12mm, 14mm, 16mm, 18mm, 20mm, 28mm OD STST FLAT WASHERS
- D- 1 QTY. 5mm BRASS NYLOCK NUT
- E- 1 QTY. 5mm X 60mm LONG FLAT HEAD STST MACHINE SCREW
- F- 1 QTY. WASHER SET WITH NUT POCKET AND GRIPPER TEETH (SET OF 6 SIZES)

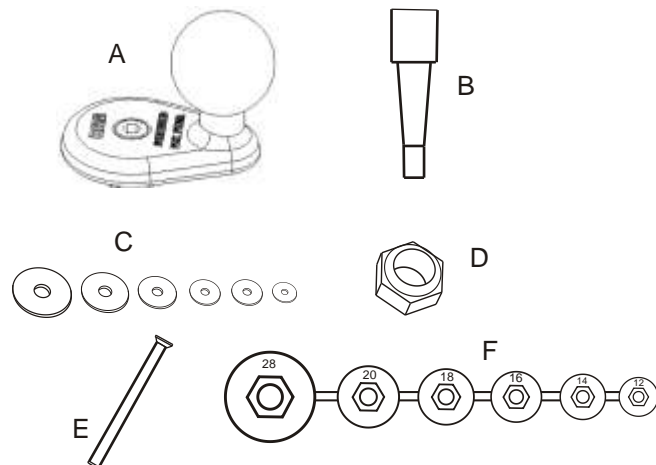

STEP 1

INSERT EXPANSION PLUG (PART B) INTO MOTORCYCLE STEM HOLE, PRESS DOWN UNTIL SNUG.

- MARK POINT ON PART B WHERE IT MEETS AT STEM HOLE OPENING (TOP MARK)
- REMOVE AND CUT PART B AT TOP MARK
- MEASURE 1" DOWN (TOWARD SMALLER DIAMETER) FROM TOP MARK AND CUT BOTTOM OF EXPANSION PLUG
(DIAGRAM REFERENCES ARE EXAMPLE MARKS ONLY, INDIVIDUAL MEASUREMENTS WILL VARY)

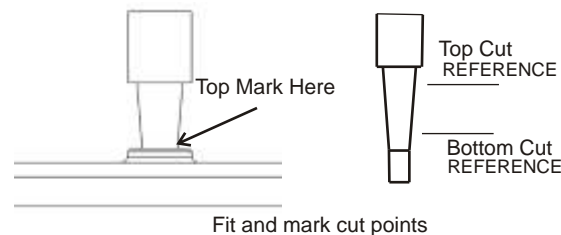

STEP 2

ASSEMBLE RAM-B-342U AS SHOWN USING LARGEST STST FLAT WASHER (C) AND WASHER WITH NUT POCKET & GRIPPER TEETH (F) THAT WILL FIT IN THE STEM HOLE. TIGHTEN ASSEMBLY ENOUGH TO HOLD TOGETHER. (DO NOT INSTALL IN STEM HOLE FOR THIS PROCESS).

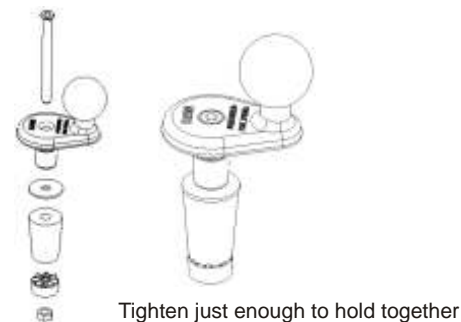

STEP 3

PRIOR TO INSTALLING STEM BASE ASSEMBLY IN STEM HOLE, PRE-TIGHTEN SCREW ASSEMBLY TO EXPAND RUBBER PLUG SO THAT IT IS A SNUG FIT WHEN PRESSED IN THE STEM HOLE. (THIS WILL HELP HOLD NUT FROM TURNING). PLACE ASSEMBLY INTO STEM HOLE AND POSITION IT.

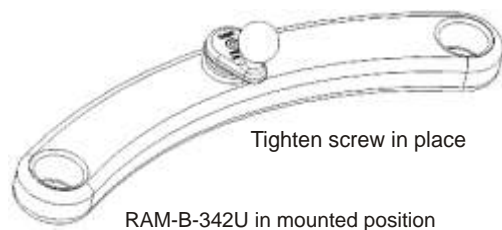

STEP 4.

TIGHTEN MACHINE SCREW WITH ALLEN WRENCH (NOT SUPPLIED). ONCE TIGHT, ROTATE ENTIRE ASSEMBLY CLOCKWISE TO TIGHTEN EVEN FURTHER.

