

Saddlemen™

USER GUIDE & INSTALLATION INSTRUCTIONS

www.saddlemen.com



EXPRESS BAG

3503-0049
3503-0050
* 3503-0051
* shown at left

FEATURES OF THE EXPRESS SISSY BAR BAG:

- Express Crusin' Sissy Bar Bag (3503-0049) has smooth, clean styling that matches Saddlemen's Crusin' saddlebags. Easy-open lid features lockable twist-lock (lock included) supplemented by a sturdy hook-and-loop strip.
- Express Drifter Sissy Bar Bag (3503-051) has smooth, clean styling with chrome buckles and genuine leather straps with lockable quick-release hidden buckles (keys included) that match Saddlemen's Drifter saddlebags.
- Express Desperado Sissy Bar Bag (3503-0050) has nostalgic-look styling; matches Saddlemen's Desperado saddlebags. Each Desperado bag features bright chrome studs, chrome buckles and genuine leather straps with lockable, quick-release hidden buckles (keys included).
- Mounting loop on bag let's you slip it on your belt to keep valuables handy. Express bag dimensions: 11" H x 9.5" W x 4.5".

⚠ WARNING

READ THESE INSTRUCTIONS THOROUGHLY BEFORE INSTALLATION!

Because of the variety of motorcycle configurations, other accessories, and the features and intended use of this Saddlemen accessory, there are many different mounting options. You are responsible for the proper installation of this accessory on your motorcycle. Your attention to these installation instructions and recommendations will permit safe and proper use of this accessory. You must mount this accessory properly and securely before riding your motorcycle. If you lack the ability to safely and properly install this accessory, seek out a qualified motorcycle technician for assistance. During installation, support the motorcycle with a suitable stand or lift so it will not tip over and injure you, or damage the vehicle. Using or mounting this accessory improperly could result in a loss of control of the motorcycle which could result in damage to your motorcycle or other personal property, the property of third parties, and/or personal injury to yourself or others, up to and including death.

BE SURE TO THOROUGHLY READ AND CLOSELY FOLLOW THE MOUNTING INSTRUCTIONS THAT ARE INCLUDED WITH THIS ACCESSORY:

- The accessory bag must be installed and securely fastened to the sissy bar or similar foundation on the motorcycle.
- Install your bag securely so it will not shift or move while riding. Make sure the bag's mounting straps do not contact the wheels, suspension or any other moving parts of the motorcycle.
- If you do not understand the mounting instructions DO NOT install the bag. Remove the mounting straps or any items you may have already installed on your motorcycle.
- Thoroughly inspect your motorcycle luggage before every ride. Do not use the bag if the mounting system has been modified, has deteriorated, loosened or is beginning to fail.
- Before riding, secure your cargo inside the bag and completely close any lid or flap.
- Continually check the security of your mounted bag at each stop as you ride. Straps can loosen during operation, so be sure to check them frequently.
- Do not use this accessory if you have any doubts as to whether it is properly mounted to your motorcycle.
- Do not exceed 5 pounds of total cargo weight (including the weight of the bag) in your bag.
- Do not transport or store flammable or potentially explosive materials in your bag.
- When using this accessory, do not exceed your vehicle's Maximum Gross Vehicle Weight as listed on your motorcycle or in its owner's manual.
- If your accessory bag is ever damaged, do not use it until it has been inspected by your local professional motorcycle dealer. Replace the bag immediately if it has sustained damage that will prevent it from being properly secured to your motorcycle or being able to securely hold cargo.

DO NOT ATTEMPT TO USE THIS ACCESSORY IF:

- You do not understand these installation and use instructions,
- You do not understand any part of the accessory's mounting system,
- You have any doubts as to the security of the mounting system.

If you have any concerns or questions, seek help at your qualified motorcycle dealer or call the Saddlemen support line at (310) 638-1222.

Remember: Motorcycling can be a dangerous activity. Installation of any accessory can increase your risk if it is not installed properly. You are responsible to install this accessory so it will not contact any portion of the drive train, suspension or steering, or if it will in any way interfere with the operation of your motorcycle.

PARTS INCLUDED WITH THE EXPRESS SISSY BAR BAG:

Part	Qty.
Express accessory bag	1
Mini padlock & keys (<i>keys only on Drifter & Desperado models</i>)	1
Instruction set	1

RECOMMENDED TOOLS:

Scissors to cut excess mounting strap material. NOTE: *Other tools may be required, depending upon your vehicle and how you mount the bag.*



The images in this instruction set may be different than your accessory or motorcycle.

Continued on next page...

INSTALLATION INSTRUCTIONS:

Your Saddlemen Express Sissybar Bag is a universal-fit accessory bag that uses two straps to mount to your motorcycle's sissybar or backrest.

Set the bag on the motorcycle so the location strap ① fits snugly to the top of the sissybar ②. Wrap the wide mounting strap ③ around the sissybar so there is no play between the bag and the sissybar. Press firmly on the mounting strap to make sure the hook and loop fastener materials is engaged.

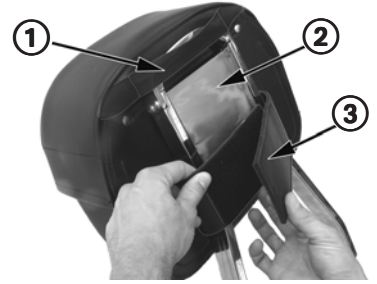

OPTIONAL, PERMANENT MOUNTING

Harley-Davidson and other brand accessory sissybars have two- or three- holes and bolts in the back. You can use this same hole pattern to mount your Express Sissybar Bag, by simply drilling matching holes into the hard back of the sissybar bag ④.

Carefully use a utility knife to cut the thread seams holding the mounting strap to the back of the bag. Remove the strap and any thread remnants and then drill the holes in the required locations. Mount the bag using the sissybar's original nuts and bolts (or obtain additional hardware from your motorcycle dealer).

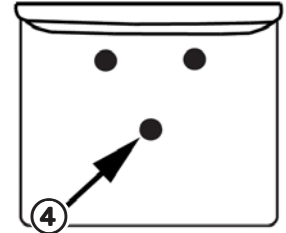

SECURING YOUR CARGO

Use the included mini-padlock ⑤ to add additional security to your bag. Slip the lock's hasp through the bag's quarter turn latch or buckle to secure the flap.



IMPORTANT:

Failure to install this accessory properly may allow portions of the bag or its mounting materials to contact the vehicle's moving parts. It is vital that you verify that the accessory and/or any of its parts will not touch, or interfere with other components throughout the vehicle's entire range of motion. **DO NOT** connect any straps to flexible or moving parts (items such as rubber mounted turn signals, swingarm or shock absorbers). Make sure that your bag does not touch the exhaust or other non-moving components, as well, as they may be damaged from contact with, or damage, the accessory. After 50 miles (80 kilometers), recheck all of the mounting straps and your bag to make sure they are still tight and secure. Inspect your bag and its related hardware before and during each ride. A loose bag or hardware can interfere with the vehicle's operation and cause an unsafe riding condition.



CARE OF YOUR SADDLEMEN BAG:

Your Saddlemen Express Bag requires almost no maintenance, other than periodic cleaning. Simply wipe down the bag with a clean, damp cloth and keep the bag away from extreme heat sources like your bike's exhaust pipes.

LEATHER HIDES AND STRAPS USED ON THE DRIFTER & DESPERADO BAGS MAY CONTAIN NATURAL BLEMISHES WHICH ARE NOT CONSIDERED TO BE FLAWS.

For leather (Drifter and Desperado models) use a good leather conditioner, like mink oil, to keep the leather soft and pliable.

To protect the SaddleHyde finish and enhance the appearance of your Crusin' bag with Saddlemen's Seat & Saddlebag Fabric Conditioner (#3103).

SADDLEMEN LIMITED ONE-YEAR WARRANTY

Saddlemen warrants its products for defects in materials, design or workmanship for a period of one year after retail purchase. Items that are defective will be repaired or replaced by Saddlemen at its sole discretion. Damage caused by improper use or improper installation is not a defect; therefore repair or replacement of a damaged accessory will not be covered under this warranty. This warranty contains other provisions and conditions, so please visit www.saddlemen.com for additional information. Thank you for purchasing your new Express Bag. You can count on Saddlemen's quality, innovation, service and style. We want you to be completely satisfied. If you have any comments, or are not satisfied with the performance of your Saddlemen accessory, please contact the Saddlemen support line at (310) 638-1222.



www.saddlemen.com

17801 SOUTH SUSANA ROAD, RANCHO DOMINGUEZ, CA 90221 (310) 638-1222 2 / 2

The images in this instruction set may be different than your accessory or motorcycle.

11-400172 (rev 2 10/17/2011)