

**SENA**

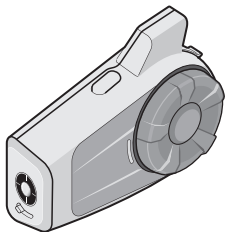

# 10C EVO

MOTORCYCLE BLUETOOTH® CAMERA  
AND COMMUNICATION SYSTEM

**HD** SPEAKERS

QUICK START GUIDE

# RIDE CONNECTED

Blast your favorite tunes, talk over the intercom with your buddies, hear directions from your GPS and more, all through your headset. With built-in Bluetooth® capabilities, UHD camera, HD speakers and a microphone using Advanced Noise Control™, technology has never felt so minimal or freeing.



Bluetooth® Integrated



1.6 Km (1.0 Mile) Intercom



UHD Camera Integrated



Four-Way Intercom



Smart Audio Mix™



Advanced Noise Control™



WiFi Enabled



Audio Multitasking™



Audio Source Priority

# GETTING STARTED

1. This product comes with a Quick Start Guide, which is a basic version of the User's Guide. **A FULL VERSION OF THE USER'S GUIDE CAN BE DOWNLOADED AT [SENA.COM](http://SENA.COM).**
2. Update this product for free with the latest firmware to fully enjoy the new advanced features built into this product. Visit [sena.com](http://sena.com) to see how to update your product.
3. Users can follow Sena on Facebook, YouTube, Twitter and Instagram to receive the most up to date information on products, helpful tips and all other announcements regarding Sena products.

**SENA**

SENA Technologies, Inc.



Customer Support: [sena.com](http://sena.com)

# GETTING STARTED

## How to Use This Guide

The legend and callouts are here to help you read the illustrations. New technology can be confusing, but we've created a simple way to perform actions using illustrations.



## Buttons

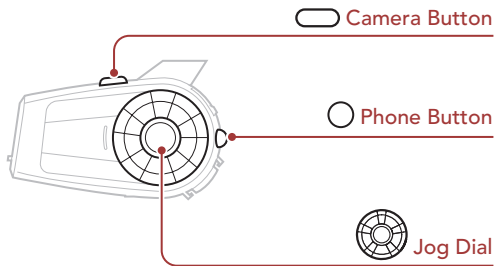

# GETTING STARTED

## Icon Legend



**Tap** button/Jog Dial the specified number of times



**Press and Hold** button/Jog Dial for the specified amount of time



**Rotate** Jog Dial clockwise (right) or counterclockwise (left).



**Rotate while Pressing** Jog Dial clockwise (right) or counterclockwise (left).



"Hello"

**Audible prompt**

# QUICK START GUIDE

## Product Details

Antenna

Camera Button

Lens

Field of view: 125 degrees  
Aperture: F/2.4

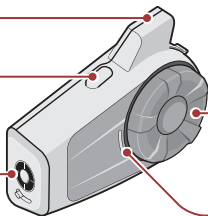

Jog Dial

Status LED

DC Power  
Charging & Firmware  
Upgrade Port

Phone Button

MicroSD Card Slot

Speaker and  
Microphone Port

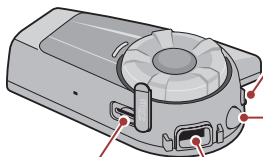

# QUICK START GUIDE

## Installation

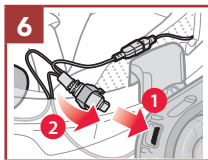
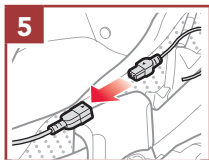
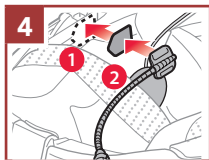
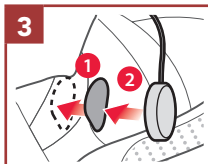
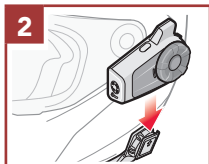
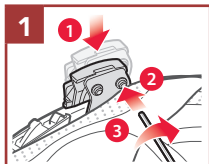

## Sena Utility App

- Download
  - Android: Google Play Store > **Sena Utility**
  - iOS: App Store > **Sena Utility**

# QUICK START GUIDE

## Sena Camera App

The **Sena Camera App** allows you to see a live preview from the camera, manage recorded videos as well as configure the video settings using the built-in WiFi feature on camera system. When the camera and the **Sena Camera App** are connected, the camera is synchronized with the smartphone's date and time. Download the **Sena Camera App** for Android and Apple operating systems from [sena.com](http://sena.com).

## Sena Device Manager

The **Sena Device Manager** allows you to upgrade the firmware and configure its settings directly from your PC or Apple computer. Download the **Sena Device Manager** from [sena.com](http://sena.com).

## Basic Operations

### Powering On



### Powering Off



### Volume Up



### Volume Down





# QUICK START GUIDE

## Checking the Battery Level

### Visual Method

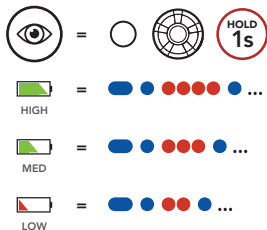

### Audible Method

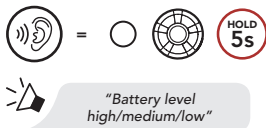

## Bluetooth Pairing (Phone, MP3, GPS)

### Mobile Phone Pairing

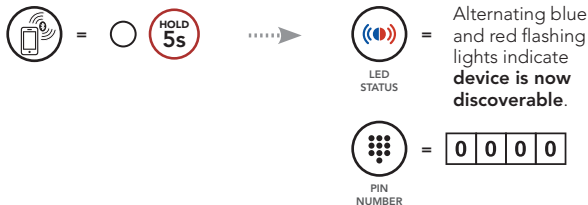

# QUICK START GUIDE

## Mobile Phone

Answer a Call

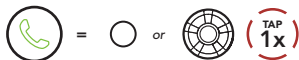

Reject a call



End a Call

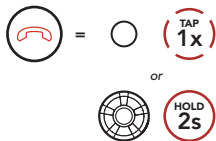

Make Call with Voice Dialer

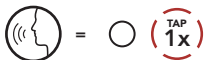

## Music Controls

Play/Pause



Track forward



Track backward



# QUICK START GUIDE

## Camera Controls

### Camera On

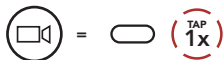

### Camera Off



### Taking Photos

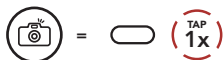

#### Note:

If the video resolution is 2160p/30fps, you cannot take a photo during video recording.

### Start Recording

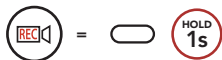

### Stop Recording

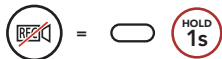

#### Note:

- You cannot record videos without a microSD card.
- Your microSD card needs to be formatted before using the camera.
- microSD cards up to 128 GB and U3 or higher cards are compatible.

### Format SD Card

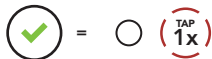
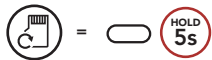

# QUICK START GUIDE

Change WiFi Channel  
(Default: 5 GHz)

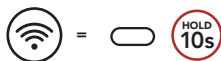

Select 5 GHz



Select 2.4 GHz

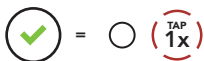

**Note:**

IF YOUR SMARTPHONE OR REGION DOES NOT SUPPORT 5 GHz,  
YOU MUST CHANGE THE WiFi CHANNEL TO 2.4 GHz.

# QUICK START GUIDE

## Intercom

Up to three other people can be paired with the headset for Bluetooth intercom conversations.

### Pairing Headset A with Headset B



YOU

and

=



YOU

or

=



LED  
STATUS

=

Flashing blue LED  
confirms **intercoms  
are paired.**

### Start/End Intercom with Headset B



=



# QUICK START GUIDE

## Headset Configuration Menu

Accessing the Headset Configuration Menu



Navigating Between Menu Options



Execute Menu Options

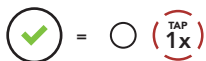

## Troubleshooting

Factory Reset

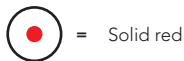
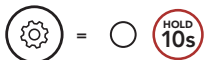



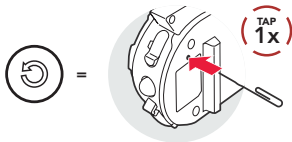





















Fault Reset

























**Note:** Fault Reset will not restore the headset to factory default settings.

# QUICK REFERENCE

TYPE	OPERATION	BUTTON COMMANDS
 Basic Operations	Power on / Power off	  
		  
	Volume up / Volume down	  or 
 Mobile Phone	Answer phone call	 or  
	End phone call	 
		or  
	Reject phone call	 
	Voice dial	 
Speed dial	 	

# QUICK REFERENCE

TYPE	OPERATION	BUTTON COMMANDS
 Music	Play/Pause music	 
	Track forward	 
	Track backward	 
 Camera	Camera On	 
	Camera Off	  
	Start/Stop recording	 
	Taking Photos	 
 Intercom	Intercom pairing	 
		 
	Start/End intercom	