

SNOWTALK 2

Snow Sports Bluetooth® Communication System

© 1998–2020 Sena Technologies, Inc. All rights reserved.

Sena Technologies, Inc. reserves the right to make any changes and improvements to its product without providing prior notice.

Sena™ is a trademark of Sena Technologies, Inc. or its subsidiaries in the USA and other countries. SF1™, SF2™, SF4™, SFR™, SRL™, Momentum™, Momentum INC™, Momentum Lite™, Momentum Pro™, Momentum INC Pro™, Momentum EVO™, Cavalry™, Latitude SR™, Latitude SX™, Latitude S1™, 30K™, 50S™, 50R™, 5S™, 20S EVO™, 20S™, 10S™, 10CT™, 10C PRO™, 10C EVO™, 10U™, 10Upad™, 10R™, 3S™, 3S PLUS™, SMH5™, SMH5-FM™, SMH5 MultiCom™, SMH10™, SMH10R™, SPH10™, SPH10H-FM™, Savage™, Prism Tube WiFi™, Prism™, Bluetooth Audio Pack for GoPro®, R1™, R1 EVO™, R1 EVO CS™, M1™, M1 EVO™, RC1™, RC3™, RC4™, Handlebar Remote™, Wristband Remote™, PowerPro Mount™, Powerbank™, FreeWire™, WiFi Docking Station™, WiFi Sync Cable™, WiFi Adapter™, +Mesh™, +Mesh Universal™, MeshPort Blue™, MeshPort Red™, Econo™, OUTRUSH™, OUTSTAR™, EcoCom™, Parani M10™, Snowtalk™, Snowtalk 2™, SR10™, SR10i™, SM10™, X1™, X1 Pro™, X1S™, Expand™, Bluetooth Mic & Intercom™, Tufftalk™, Tufftalk Lite™, Tufftalk M™ are trademarks of Sena Technologies, Inc. or its subsidiaries. These trademarks may not be used without the express permission of Sena.

GoPro® is a registered trademark of Woodman Labs of San Mateo, California. Sena Technologies, Inc. (“Sena”) is not affiliated with Woodman Labs, Inc. The Sena Bluetooth Pack for GoPro® is an aftermarket accessory specially designed and manufactured by Sena Technologies, Inc. for the GoPro® Hero3 and Hero4 allowing for Bluetooth capabilities.

The Bluetooth® word mark and logos are owned by the Bluetooth SIG, Inc. and any use of such marks by Sena is under license. iPhone® and iPod® touch are registered trademarks of Apple Inc.

CONTENTS

1	PACKAGE CONTENTS	4
2	INSTALLING THE HEADSET ON YOUR HELMET	5
3	GETTING STARTED	6
3.1	Button Operation	6
3.2	Sena Softwares	7
3.2.1	Sena Outdoor App	7
3.2.2	Sena Device Manager	7
3.3	Powering On and Off	7
3.4	Charging	7
3.5	Checking the Battery Level	8
3.5.1	LED Indicator	8
3.5.2	Voice Prompt Indicator	8
3.6	Volume Adjustment	8
4	PAIRING THE HEADSET WITH OTHER BLUETOOTH DEVICES	8
4.1	Phone Pairing	8
4.1.1	Initially Pairing the Headset	8
4.1.2	Pairing When the Headset Is Turned Off	9
4.1.3	Pairing When the Headset Is Turned On	9
5	MOBILE PHONE USAGE	9
5.1	Mobile Phone Call Making and Answering	9
6	STEREO MUSIC	10
6.1	Bluetooth Stereo Music	10
7	BLUETOOTH INTERCOM	10
7.1	Intercom Pairing	10
7.1.1	Pairing with Other Headsets for Intercom Conversation	10
7.2	Two-Way Intercom	11
7.2.1	Starting Two-Way Intercom	11
7.2.2	Ending Two-Way Intercom	11
7.2.3	HD Intercom	11
7.2.4	Advanced Noise Control™ (Always On)	11
7.3	Multi-Way Intercom	12
7.3.1	Starting Three-Way Intercom	12
7.3.2	Starting Four-Way Intercom	12
7.3.3	Ending Multi-Way Intercom	13
7.4	Group Intercom	13
8	UNIVERSAL INTERCOM	14
9	FUNCTION PRIORITY	15
10	CONFIGURATION SETTING	15
10.1	Unit Language	15
11	FIRMWARE UPGRADE	16
12	TROUBLESHOOTING	16
12.1	Fault Reset	16
12.2	Factory Reset	17

1 PACKAGE CONTENTS

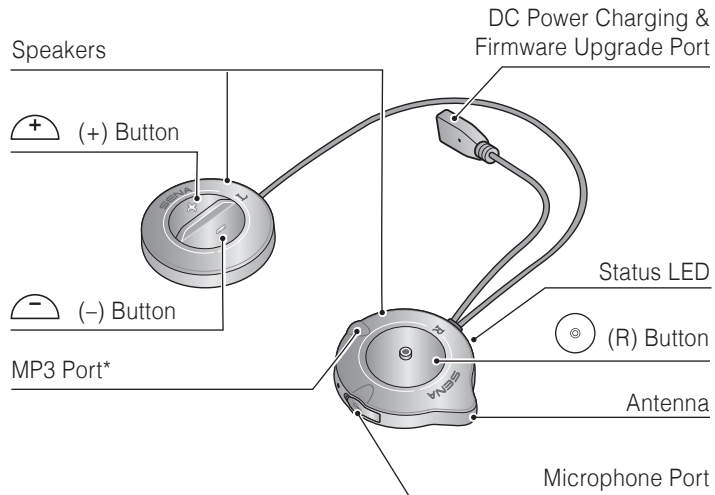

*Note: *You can plug in any 3.5 mm stereo audio jack cable into the port. Audio jack cable is not included in the package.*

• **Wired Microphone**

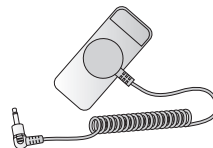

• **USB Power & Data Cable (USB-C)**



2 INSTALLING THE HEADSET ON YOUR HELMET

1. Insert the wired microphone to the right speaker.

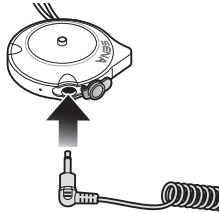

2. Place the left and right speakers in the ear pockets of your helmet. Make sure the speakers are facing towards your ears. Check if you can press the buttons well.

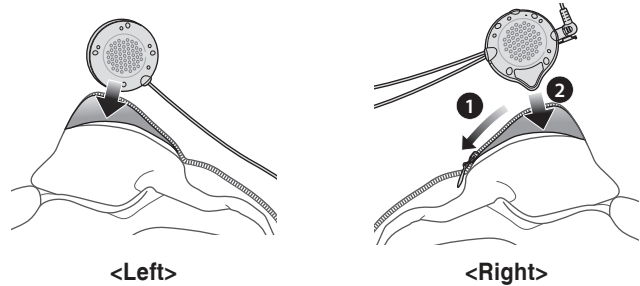

Note: The bulged part of the right speaker is the antenna. Make sure that the antenna is facing towards the sky.

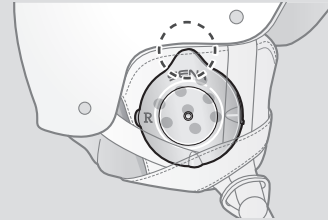

- Secure the wired microphone to the chin strap so that the wired microphone is facing closest to your mouth.

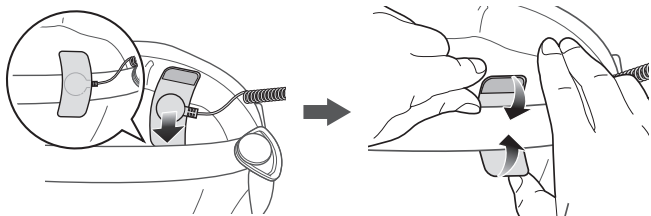

- Hide the wires in the back of the helmet.

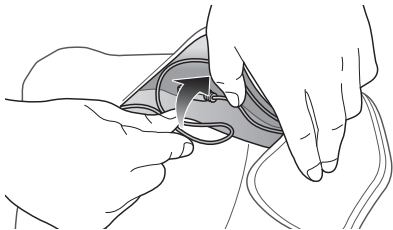

3 GETTING STARTED

3.1 Button Operation

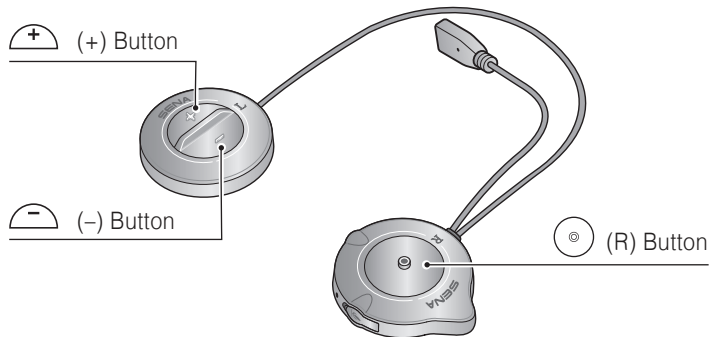

3.2 Sena Softwares

3.2.1 Sena Outdoor App

By simply pairing your phone with your headset, you can use the **Sena Outdoor App** for quicker, easier setup and management.

- App Features
 - Music, Device settings, Quick Start Guide, and User's Guide.
- Download
 - Android: Google Play Store > **Sena Outdoor**
 - iOS: App Store > **Sena Outdoor**

3.2.2 Sena Device Manager

The **Sena Device Manager** allows you to upgrade firmware and configure settings directly from your PC. Download the **Sena Device Manager** from www.sena.com.

3.3 Powering On and Off

To power on the headset, press and hold the **(+) Button** and the **(-) Button** for **1 second**. To power off the headset, tap the **(+) Button** and the **(-) Button**.

3.4 Charging

The headset will be fully charged in about 3 hours. The charging time may vary depending on the charging method.

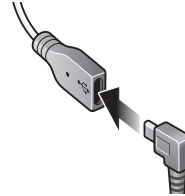

Note:

- Please make sure to take off your headset while charging. The headset automatically turns off during charging.
- Any 3rd party USB charger can be used with Sena products if the charger is approved by either the FCC, CE, IC or other locally approved agencies that Sena accepts.
- The headset is compatible with 5 V/1 A input USB-charged devices only.

3.5 Checking the Battery Level

You can check the battery level in two different ways.

3.5.1 LED Indicator

When the headset is powering on, the red LED flashes rapidly indicating the battery level.

4 flashes = High, 70 ~ 100%

3 flashes = Medium, 30 ~ 70%

2 flashes = Low, 0 ~ 30%

3.5.2 Voice Prompt Indicator

Press and hold the **(+) Button** for **3 seconds**. Then you will hear a voice prompt indicating the battery level is high, medium, or low.

Note: The voice prompt indicator does not work while playing music or talking on the phone.

3.6 Volume Adjustment

You can raise or lower the volume by tapping the **(+) Button** or the **(-) Button**. Volume is set and maintained independently at different levels for each audio source, even when the headset is rebooted.

4 PAIRING THE HEADSET WITH OTHER BLUETOOTH DEVICES

When using the headset with other Bluetooth devices for the first time, they will need to be “paired.” This enables them to recognize and communicate with one another whenever they are within range. The headset can pair with multiple Bluetooth devices such as a mobile phone and MP3 player. The pairing operation is required only once for each Bluetooth device.

4.1 Phone Pairing

There are three ways to pair the phone.

4.1.1 Initially Pairing the Headset

The headset will automatically enter the phone pairing mode when you initially turn on the headset or in the following situation:

- Rebooting after executing **Factory Reset**

1. Press and hold the **(+) Button** and **(-) Button** for **1 second**.
2. You will hear a voice prompt, “**Phone pairing**”.

3. Search for Bluetooth devices on your mobile phone. Select **Sena Snowtalk 2** in the list of devices detected.
4. If your mobile phone asks for a PIN, enter 0000.

Note:

- The phone pairing mode lasts for **3 minutes**.
- To cancel pairing, tap the **(R) Button**.

4.1.2 Pairing When the Headset Is Turned Off

1. While the **headset** is turned off, press and hold the **(+) Button** and **(-) Button** for **5 seconds**.
2. You will hear a voice prompt, “**Phone pairing**”.
3. Search for Bluetooth devices on your mobile phone. Select **Sena Snowtalk 2** in the list of devices detected.
4. If your mobile phone asks for a PIN, enter 0000.

4.1.3 Pairing When the Headset Is Turned On

1. While the **headset** is turned on, press and hold the **(R) Button** for **10 seconds**.
2. You will hear a voice prompt, “**Phone pairing**”.
3. Search for Bluetooth devices on your mobile phone. Select **Sena Snowtalk 2** in the list of devices detected.
4. If your mobile phone asks for a PIN, enter 0000.

5 MOBILE PHONE USAGE

5.1 Mobile Phone Call Making and Answering

1. When you have an incoming call, simply tap the **(R) Button** to answer the call.
2. To end a call, press the **(R) Button** for **2 seconds**, or wait for the called person to end the call.
3. To reject a call, press the **(R) Button** for **2 seconds** while the phone is ringing.
4. There are several ways to make a phone call:
 - Enter numbers on your mobile phone's keypad and make a call. Then the call is automatically transferred to the headset.
 - In stand-by mode, press the **(R) Button** for **3 seconds**, to activate the voice dialing of your mobile phone. For this, the voice dialing function must be available on the mobile phone. Refer to your mobile phone manual for further instruction.

6 STEREO MUSIC

6.1 Bluetooth Stereo Music

1. To play or pause music, press and hold the **(R) Button** for **1 second**.
2. To track forward or track back, press and hold the **(+) Button** or the **(-) Button** for **1 second**.

Note: Plug your MP3 Player directly to headset's MP3 port using a 3.5mm stereo audio jack cable (not included in the package). In this way, you can listen to music even if your headset is out of battery or powered off. You can control volume only from the MP3 player.

7 BLUETOOTH INTERCOM

7.1 Intercom Pairing

7.1.1 Pairing with Other Headsets for Intercom Conversation

The headset can be paired with up to three other headsets for Bluetooth intercom conversation.

1. Press and hold the **(R) Button** of the **headset A and B** for **5 seconds** until red LEDs of the both units start to flash rapidly.
2. Simply tap the **(R) Button** of any one of the **two headsets A and B**, and wait until the LEDs of both headsets turn to blue and intercom connection is automatically established.

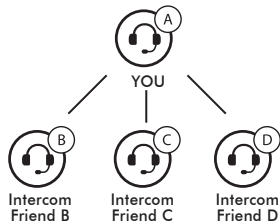

3. You can make other pairings between **headsets A and C**, and between **headsets A and D** by following the same procedure as above.
4. The intercom pairing queue is '**Last-Come, First-Served**'. If a headset has multiple paired headsets for intercom conversations, the last paired headset is set as **first intercom friend**. The previous intercom friend becomes **second intercom friend**, and **third intercom friend**.

7.2 Two-Way Intercom

7.2.1 Starting Two-Way Intercom

You can start an intercom conversation with one of any intercom friends by tapping the **(R) Button**: single tap to intercom with the **first intercom friend**, double tap to intercom with the **second intercom friend**, and triple tap to intercom with the **third intercom friend**.

7.2.2 Ending Two-Way Intercom

You can end an intercom conversation with one of any intercom friends by tapping the **(R) Button**: single tap to end intercom with the **first intercom friend**, double tap to end intercom with the **second intercom friend**, and triple tap to end intercom with the **third intercom friend**.

7.2.3 HD Intercom

HD Intercom enhances the two-way intercom audio from normal quality to HD quality. when you enter into a multi-way intercom, **HD Intercom** will be automatically disabled. If this feature is disabled, the intercom audio will change to normal quality.

- **HD intercom** is only active for two-way intercom.

7.2.4 Advanced Noise Control™ (Always On)

The background noise is reduced during an intercom conversation.

7.3 Multi-Way Intercom

Multi-Way Intercom enables conference-call-style conversations with up to three intercom friends at the same time. While multi-way intercom is in progress, mobile phone connection is temporarily disconnected. However, as soon as multi-way intercom terminates, the mobile phone connection will be reestablished.

7.3.1 Starting Three-Way Intercom

1. You (A) need to be paired with two other friends (B & C) for three way conference intercom.
2. Start an intercom conversation with one of the two friends in your intercom group.
3. You (A) can call the second intercom friend (C) by double tapping the **(R) Button**, or the second intercom friend (C) may join the intercom by making an intercom call to you (A).

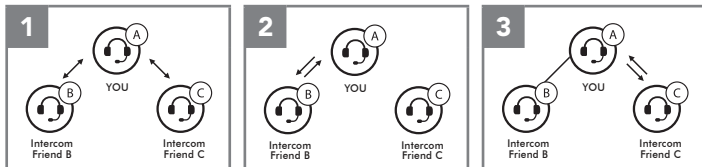

7.3.2 Starting Four-Way Intercom

With three intercom friends connected, a new participant (D) can make it a four-way intercom conference by making an intercom call to either (B) or (C).

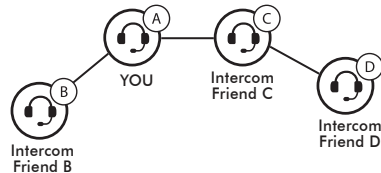

7.3.3 Ending Multi-Way Intercom

You can completely terminate the conference intercom or just disconnect an intercom connection with one of your active intercom friends.

1. Press and hold the **(R) Button** for **1 second** until you hear a beep to terminate all intercom connections.
2. Tap the **(R) Button** to disconnect from your first intercom friend. Double tap the **(R) Button** to disconnect from your second intercom friend.

Note: Multiple headsets are connected during multi-way intercom. With various signals interfering each other, the intercom distance of multi-way intercom is relatively shorter than that of two-way intercom.

7.4 Group Intercom

Group Intercom allows you to instantly create a multi-way conference intercom with three other most recently paired headsets.

1. Go through intercom pairing with up to three headsets you want to have **Group Intercom** with.
2. Tap the **(R) Button** and **(+) Button** to begin **Group Intercom**. The LED will flash purple.
3. To terminate **Group Intercom**, press and hold the **(R) Button** for **1 second** during **Group Intercom**.

8 UNIVERSAL INTERCOM

Universal Intercom allows you to have intercom conversations with users of non-Sena Bluetooth headsets. Non-Sena Bluetooth headset can be connected to the Sena Bluetooth headset if they support the Bluetooth Hands-Free Profile (HFP). You can pair the headset with only one non-Sena headset at a time. The intercom distance depends on the performance of the Bluetooth headset to which it's connected.

When a non-Sena Bluetooth headset is paired with the headset, if another Bluetooth device is paired via **Second Mobile Phone Pairing**, it will be disconnected.

1. Press and hold the **(R) Button** for **5 seconds** to enter into **Intercom Pairing Mode**.
2. Within **2 seconds**, tap the **(+) Button**. You will hear a voice prompt, **"Universal intercom pairing"**.
3. Put the non-Sena Bluetooth headset in Pairing Mode. The headset will automatically pair with a non-Sena Bluetooth headset.

4. You can have a two-way intercom or multi-way intercom communication with up to three intercom friends using non-Sena headset.

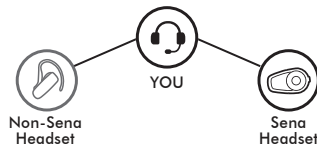

Three-Way Universal Intercom

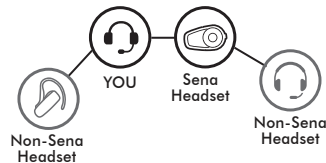

Four-Way Universal Intercom

Note: Some non-Sena headsets may not support Multi-Way Universal Intercom.

9 FUNCTION PRIORITY

The headset operates in the following order of priority:

- (Highest)** Mobile phone
 Intercom
- (Lowest)** Bluetooth stereo music

A lower priority function is always interrupted by a higher priority function.

10 CONFIGURATION SETTING

You can change the settings of the headset through the **Sena Device Manager** or the **Sena Outdoor App**.

10.1 Unit Language

You can select the device language. The selected language is maintained even when the headset is rebooted.

11 FIRMWARE UPGRADE

The headset supports firmware upgrades. You can update firmware using the **Sena Device Manager**. Please visit Sena Bluetooth website at www.sena.com to check the latest software downloads.

12 TROUBLESHOOTING

12.1 Fault Reset

When the headset is not working properly, you can easily reset the unit:

1. Locate the pin-hole reset button at the back of the right speaker.
2. Gently insert a paper clip into the hole and press and **Fault Reset Button** with light pressure.

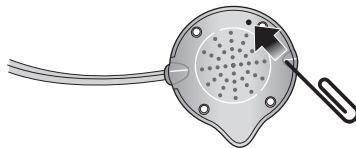

*Note: **Fault Reset** will not restore the headset to the factory default settings.*

12.2 Factory Reset

To erase all of your settings and start fresh, the headset can be restored to factory default settings.

1. Press and hold the **(R) Button** for **15 seconds** until you hear a voice prompt, **“Factory Reset”**.
2. Tap the **(R) Button** to confirm reset, the headset automatically restores the default settings and turns off.

