

SENA

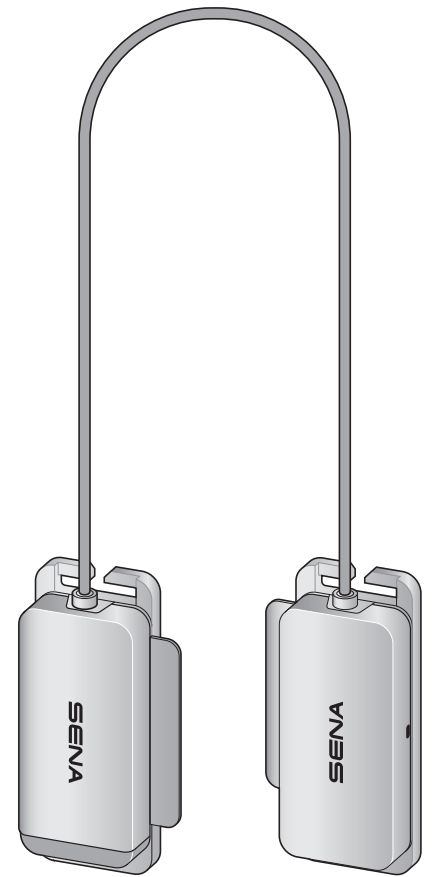

Pi

**BLUETOOTH COMMUNICATION HEADSET
FOR HELMETS**

USER'S GUIDE

TABLE OF CONTENTS

1. ABOUT pi	4
1.1 Product Features	4
1.2 Product Details	4
1.3 Package Contents	5
2. INSTALLING THE HEADSET ON YOUR HELMET	6
3. GETTING STARTED	7
3.1 Downloadable Sena Software	7
3.1.1 Sena Utility App	7
3.1.2 Sena Device Manager	7
3.1.3 Firmware Upgrades	7
3.2 Charging	8
3.3 Powering On and Off	8
3.4 Checking the Battery Level	8
3.5 Volume Adjustment	9
4. PAIRING THE HEADSET WITH OTHER BLUETOOTH DEVICES	10
4.1 Phone Pairing	10
4.1.1 Initially Pairing the pi	10
4.1.2 Pairing When the pi Is Turned Off	11
4.1.3 Pairing When the pi Is Turned On	11
4.2 Second Mobile Phone Pairing - Second Mobile Phone and GPS	12

5.	MOBILE PHONE USAGE	13
5.1	Making and Answering Calls	13
5.2	Bluetooth Stereo Music	13
6.	BLUETOOTH INTERCOM	14
6.1	Intercom Pairing	14
6.1.1	Using the Smart Intercom Pairing (SIP)	14
6.1.2	Using the Button	15
6.2	Two-Way Intercom	15
6.2.1	HD Intercom	15
7.	UNIVERSAL INTERCOM	16
7.1	Universal Intercom Pairing	16
7.2	Two-Way Universal Intercom	16
8.	FUNCTION PRIORITY	17
9.	CONFIGURATION SETTING	18
9.1	Headset Configuration Menu	18
9.2	Software Configuration Setting	18
9.2.1	Unit Language	19
9.2.2	Voice Prompt (Default: Enable)	19
9.2.3	Advanced Noise Control™ (Always on)	19
10.	TROUBLESHOOTING	20
10.1	Fault Reset	20
10.2	Factory Reset	20

1. ABOUT pi

1.1 Product Features



Bluetooth® 4.1



Two-Way Intercom



Intercom up to 400 m (0.2 mi)*



Advanced Noise Control™

* in open terrain

1.2 Product Details

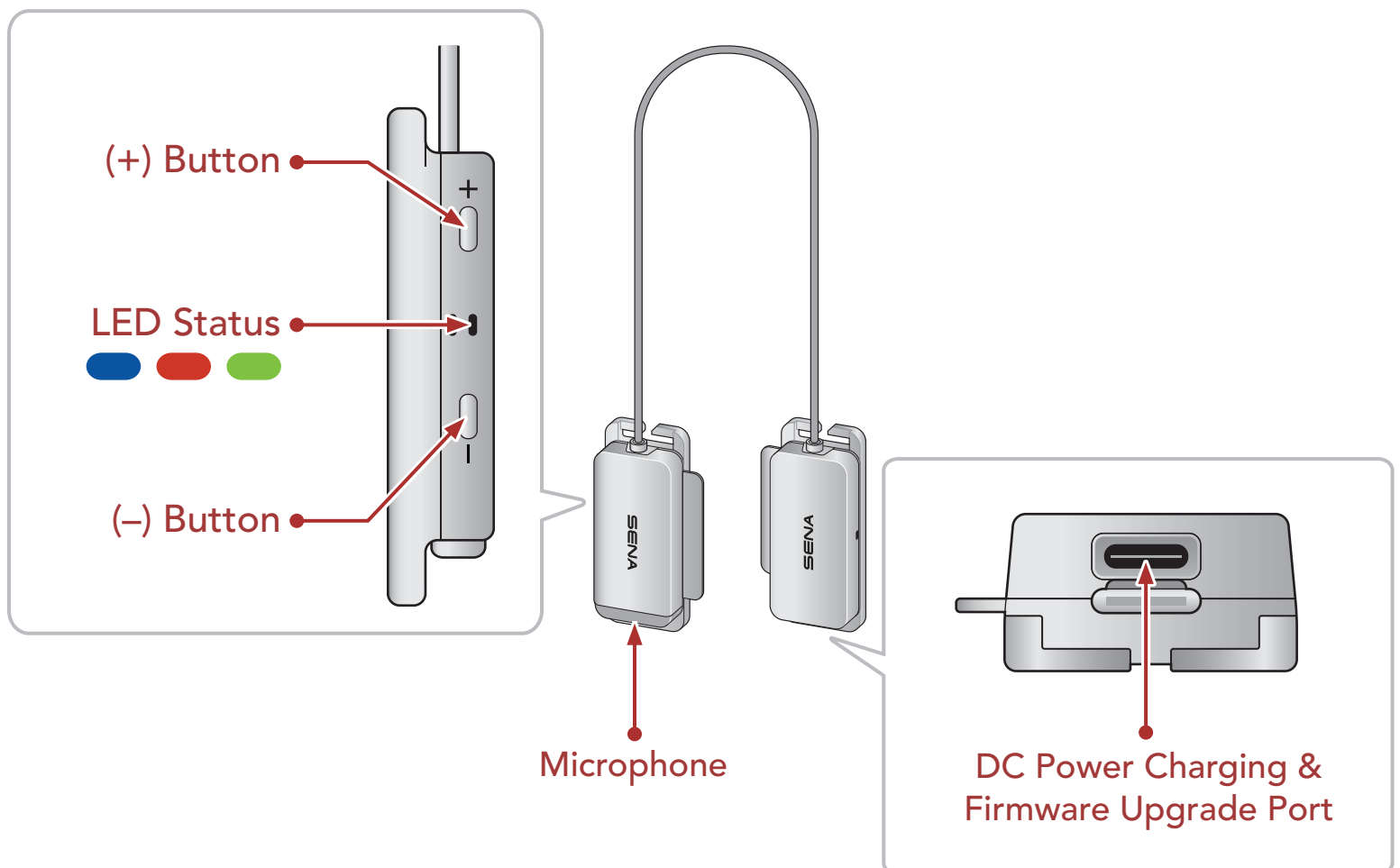

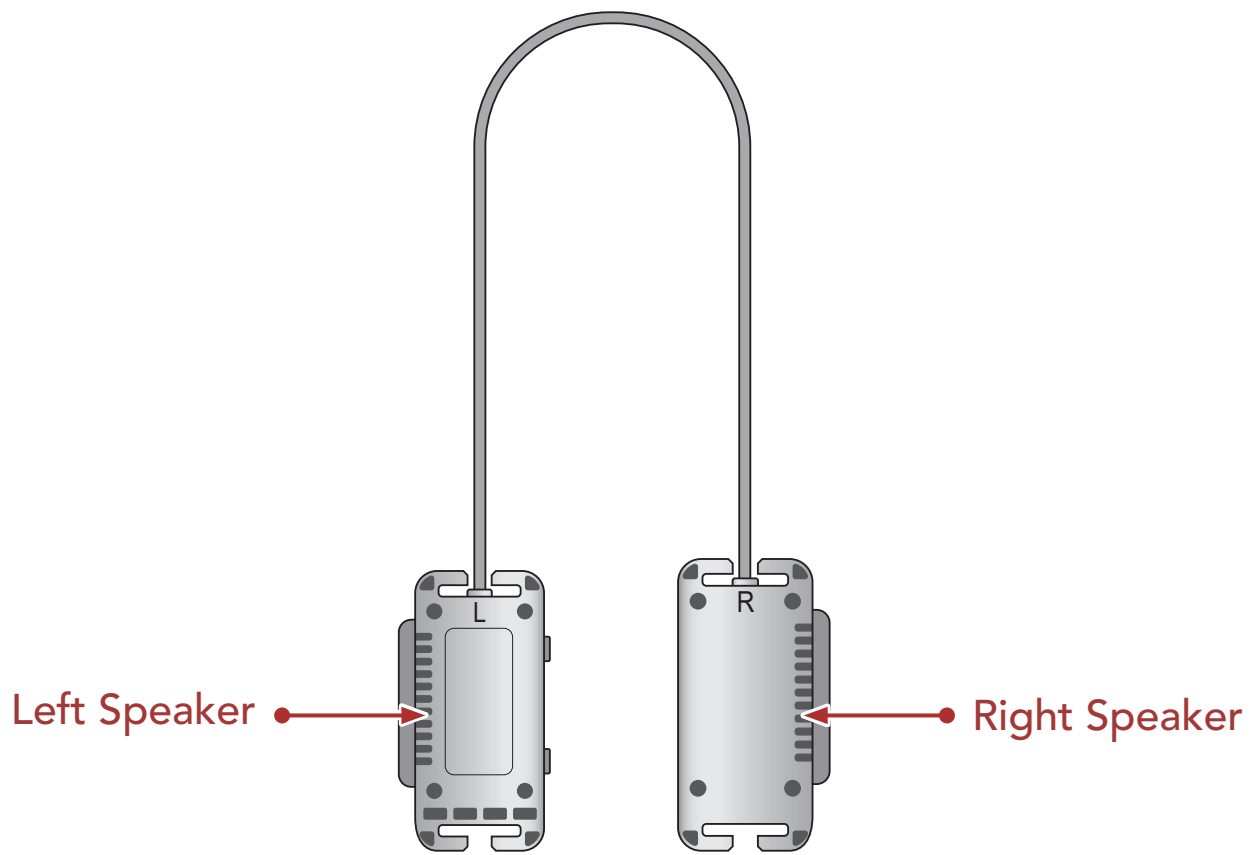

1.3 Package Contents

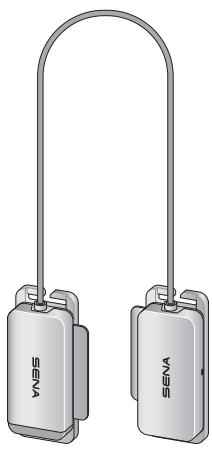

Headset

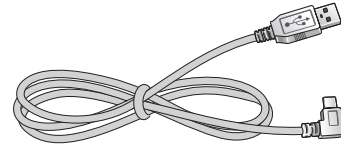

USB Power & Data Cable
(USB-C)

2. INSTALLING THE HEADSET ON YOUR HELMET

- ① Secure the headset to the chinstrap using the strap hooks on both sides.
- ② Slide the headset as close to the helmet as possible.

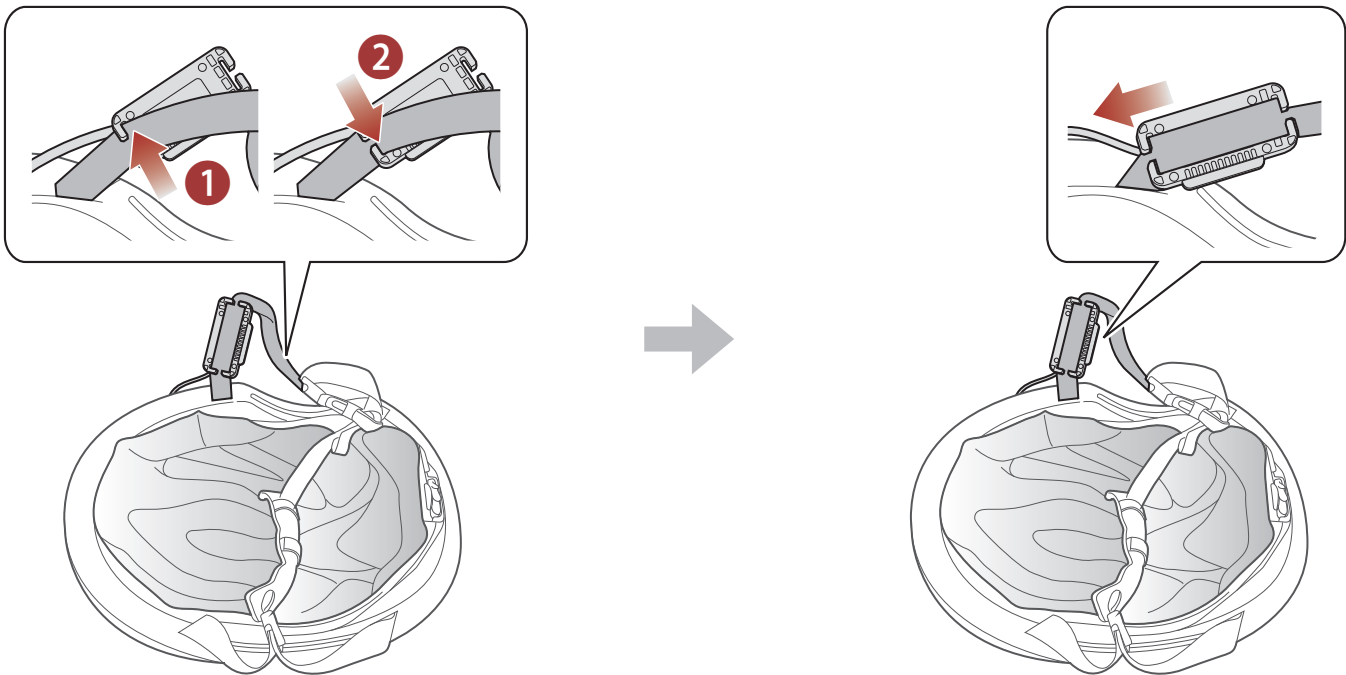

Note:

- The (R) and (L) markings are located on the back of the headset.
- Make sure that the cable is facing toward the helmet.

- ③ Hide the cable under the inner pad in the front of the helmet.
- ④ Adjust the headset upward or downward so that the speakers are facing your ears.

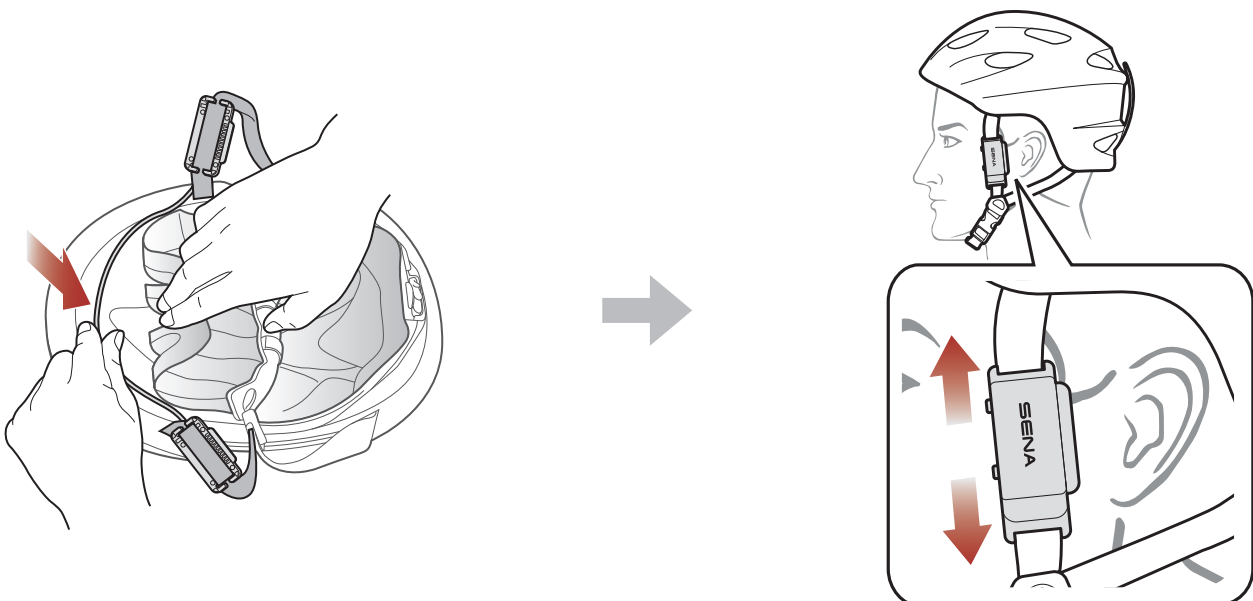

Note: The **SENA** logo will appear as above after proper installation.

3. GETTING STARTED

3.1 Downloadable Sena Software

3.1.1 Sena Utility App

By simply pairing your phone with your headset, you can use the **Sena Utility App** for quicker, easier set up and management.



- Download **Sena Utility App** on **Google Play Store** or **App Store**.

3.1.2 Sena Device Manager

The **Sena Device Manager** allows you to upgrade firmware and configure settings directly from your PC.



- Download the **Sena Device Manager** at sena.com.

3.1.3 Firmware Upgrades

The headset supports firmware upgrades.

Please visit sena.com to check for the latest software downloads.

- Download the **firmware** at sena.com.

3.2 Charging

Charging the Headset

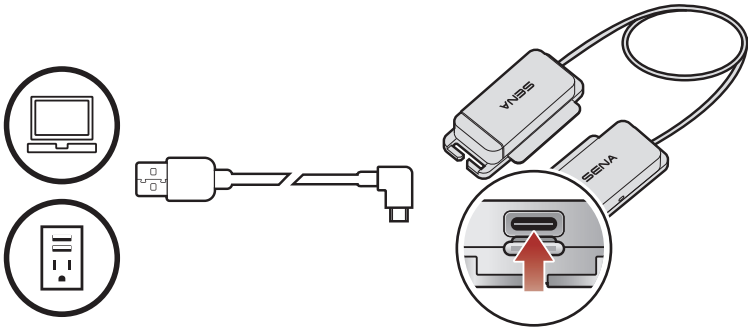

Depending upon the charging method, the headset will be fully charged in about 2.5 hours.

Note:

- Please make sure to take off your headset while charging. The headset automatically turns off during charging.
- Any 3rd party USB charger can be used with Sena products if the charger is approved by either the FCC, CE, IC or other locally approved agencies that Sena accepts.
- The **pi** is compatible with 5 V input USB-charged devices only.

3.3 Powering On and Off

Powering On

- Press and hold the **(+) Button** and the **(-) Button** for **1 second**.

Powering Off

- Tap the **(+) Button** and the **(-) Button**.

3.4 Checking the Battery Level

There are two ways to check battery level:

1) Visual Method

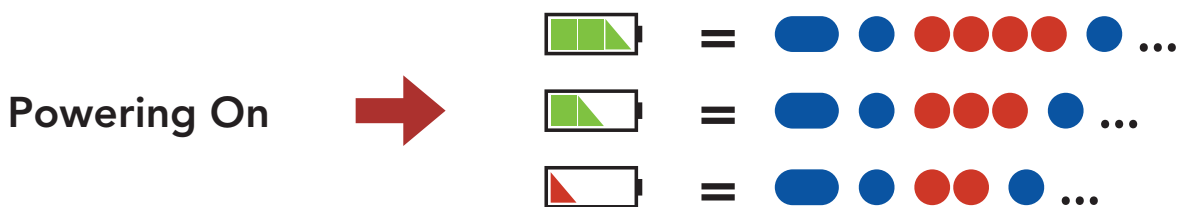

2) Audible Method

- While the headset is on, press and hold the **(-) Button** for **3 seconds**. → *"Battery level is high/medium/low"*

Note:

- The battery performance may be reduced over time with usage.
- Battery life may vary depending on conditions, environmental factors, functions of the product in use, and devices used with it.

3.5 Volume Adjustment

Volume is set and maintained independently at different levels for each audio source, even when the headset is rebooted.

Volume Up/Down

- Tap the **(+) Button** or the **(-) Button**.

4. PAIRING THE HEADSET WITH OTHER BLUETOOTH DEVICES

When using the headset with other Bluetooth devices for the first time, they will need to be “paired.” This enables them to recognize and communicate with one another whenever they are within range.

The pairing operation is required only once for each Bluetooth device. The headset can pair with multiple Bluetooth devices such as a mobile phone, GPS, or MP3 player via **Mobile Phone Pairing** and **Second Mobile Phone Pairing**.

4.1 Phone Pairing

There are three ways to pair the phone.

4.1.1 Initially Pairing the pi

The headset will automatically enter the phone pairing mode when you initially turn on the headset or in the following situation:

- Rebooting after executing **Factory Reset**.

① Press and hold the **(+) Button** and the **(-) Button** for **1 second**.



Blinking 
 *“Phone Pairing”*

② Select **pi** in the list of Bluetooth devices detected.

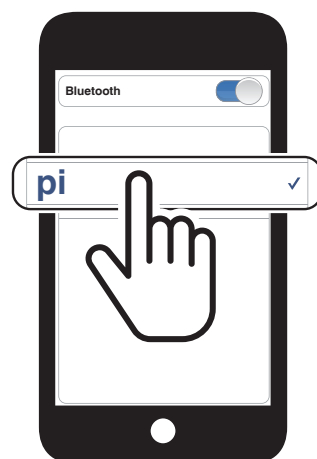

Note:

- The phone pairing mode lasts for **3 minutes**.
- To cancel pairing, tap the **(+) Button** or **(-) Button**.

4.1.2 Pairing When the pi Is Turned Off

- ① While the headset is off, press and hold the **(+) Button** and the **(-) Button** for **5 seconds**.



Blinking 
 "Phone Pairing"

- ② Select **pi** in the list of Bluetooth devices detected.

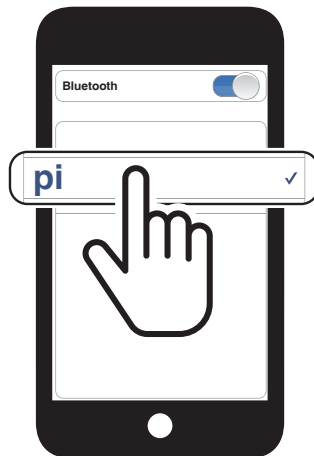

4.1.3 Pairing When the pi Is Turned On

- ① While the headset is on, press and hold the **(+) Button** for **5 seconds**.



Blinking 
 "Phone Pairing"

- ② Select **pi** in the list of Bluetooth devices detected.

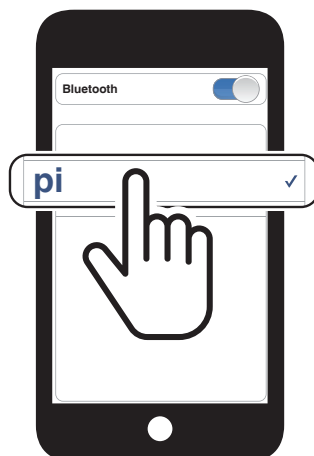

4.2 Second Mobile Phone Pairing - Second Mobile Phone and GPS

① Press and hold the **(+) Button** for **10 second**.



 *"Configuration menu"*

② Tap the **(+) Button**.



Blinking 
 *"Second mobile phone pairing"*

③ Select **pi** in the list of Bluetooth devices detected.

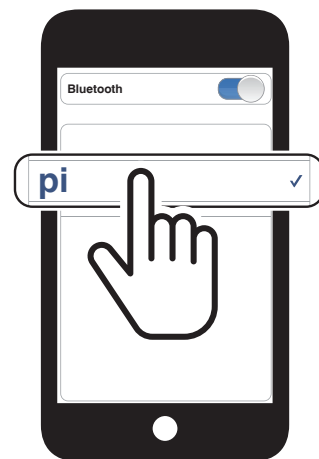

5. MOBILE PHONE USAGE

5.1 Making and Answering Calls

Answer a Call

- Tap the **(+) Button**.

End a Call

- Press and hold the **(+) Button** for **2 seconds**.

Reject a Call

- Press and hold the **(+) Button** for **2 seconds**.

Voice Dial

- Press and hold the **(+) Button** for **3 seconds** in stand-by mode.

5.2 Bluetooth Stereo Music

Play/Pause

- Press and hold the **(+) Button** for **1 second**.

Track Forward

- Press and hold the **(+) Button** for **2 seconds**.

Track Backward

- Press and hold the **(-) Button** for **2 seconds**.

6. BLUETOOTH INTERCOM

The headset can be paired with another headset for Bluetooth intercom conversation.



6.1 Intercom Pairing

There are two ways to pair the headset.

6.1.1 Using the Smart Intercom Pairing (SIP)

SIP allows you to quickly pair with your friends for intercom communication by scanning the QR code on the **Sena Utility App** without remembering the button operation.

- ① Pair the mobile phone with the headset.
- ② Open the **Sena Utility App**.
- ③ Click the **Smart Intercom Pairing Menu**.
- ④ Click the **Add Button** to open the QR scanning screen.
- ⑤ Scan the **QR code** displayed on your friend **(B)**'s mobile phone.
 - Your friend **(B)** can display the QR code on the mobile phone by opening the **Sena Utility App** and clicking the **Smart Intercom Pairing Menu**.

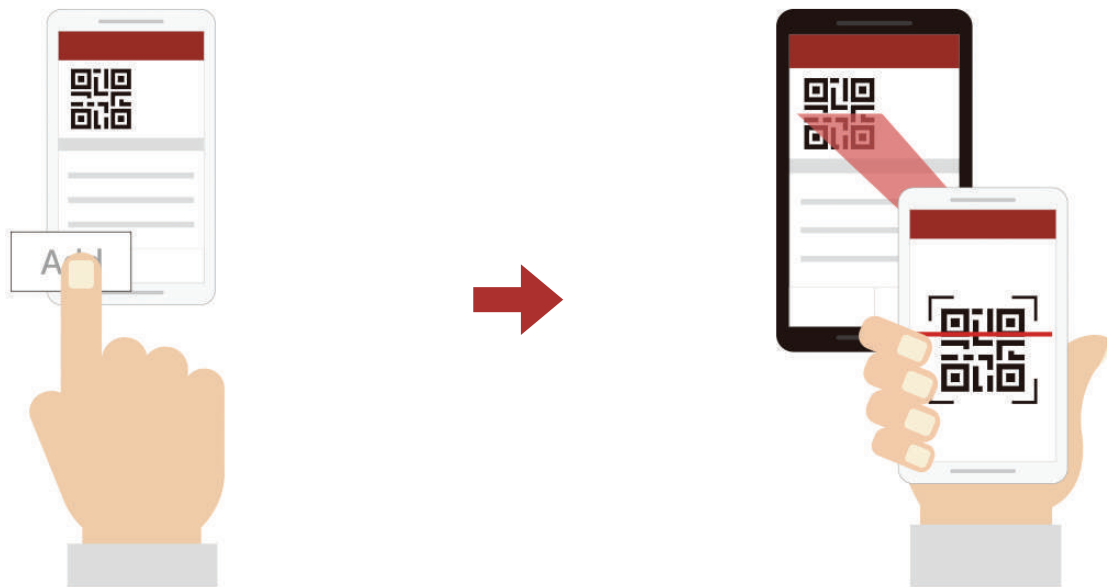

- ⑥ Click the **Confirm Button** and check that your friend **(B)** is paired with **you (A)** correctly.

Note: The **Smart Intercom Pairing (SIP)** is not compatible with Sena products that use **Bluetooth 3.0** or **below**.

6.1.2 Using the Button

- ① Press and hold the **(-) Button** on the **headsets (A and B)** for **5 seconds**.



Blinking 



"Intercom Pairing"

- ② The **two headsets (A and B)** will be automatically paired.



Turns blue 



6.2 Two-Way Intercom

Start/End Conversation with the Intercom Friend

- Press and hold the **(-) Button** for **1 second**.





6.2.1 HD Intercom

HD Intercom enhances the two-way intercom audio from normal quality to HD quality. If this feature is disabled, the two-way intercom audio will change to normal quality.

7. UNIVERSAL INTERCOM

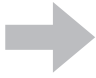
Universal Intercom allows you to have Two-way intercom conversations with users of non-Sena Bluetooth headsets. Non-Sena Bluetooth headset can be connected to the Sena headset if they support the Bluetooth Hands-Free Profile (HFP). You can pair the headset with only one non-Sena headset at a time. The intercom distance depends on the performance of the headset to which it's connected. When a non-Sena headset is paired with the headset, if another Bluetooth device is paired via **Second Mobile Phone Pairing**, it will be disconnected.

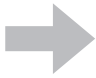
7.1 Universal Intercom Pairing

- ① Press and hold the **(+) Button** for **10 seconds** to enter the **configuration menu**.   *"Configuration menu"*
- ② Double tap the **(+) Button**.   *"Universal intercom pairing"*
- ③ Tap the **(-) Button** to enter into **Universal Intercom Pairing** mode.
- ④ Put the non-Sena Bluetooth headset in Hands-free Pairing Mode. The headset will automatically pair with a non-Sena Bluetooth headset.

7.2 Two-Way Universal Intercom

You can initiate the **Universal Intercom** connection with non-Sena Bluetooth headsets using the same intercom connection method as you would between other Sena headsets.

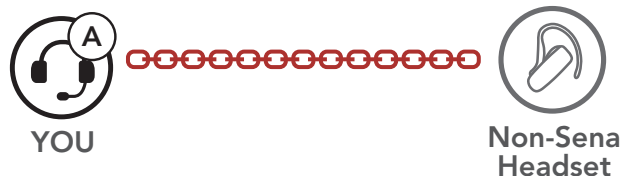

You may start/end a **Two-Way Universal Intercom** using the same way as you do in a normal **Two-Way Intercom**. Please refer to **section 6.2, "Two-Way Intercom"**.

8. FUNCTION PRIORITY

The headset operates in the following order of priority:

- (highest)** Mobile phone
- Bluetooth Intercom
- (lowest)** Bluetooth stereo music

A lower priority function is always interrupted by a higher priority function.

9. CONFIGURATION SETTING

9.1 Headset Configuration Menu

Accessing the Configuration Menu

- Press and hold the **(+) Button** for **10 seconds**.

Navigating Between Menu Options

- Tap the **(+) Button**.

Execute Menu Options

- Tap the **(-) Button**.

Voice Configuration Menu	Tap the (-) Button
Second Mobile Phone Pairing	None
Universal Intercom Pairing	Execute
Factory Reset	Execute
Exit Configuration	Execute

9.2 Software Configuration Setting

You can change the settings of the headset through the **Sena Device Manager** or the **Sena Utility App**.



9.2.1 Unit Language

You can select the device language. The selected language is maintained even when the headset is rebooted.

9.2.2 Voice Prompt (Default: Enable)

You can disable voice prompts by software configuration settings, but the following voice prompts are always on.

- Headset configuration menu

9.2.3 Advanced Noise Control™ (Always on)

The background noise is reduced during an intercom conversation.

10. TROUBLESHOOTING

Please visit [sena.com](https://www.sena.com) for more troubleshooting information.

- Customer Support: [sena.com](https://www.sena.com)

10.1 Fault Reset

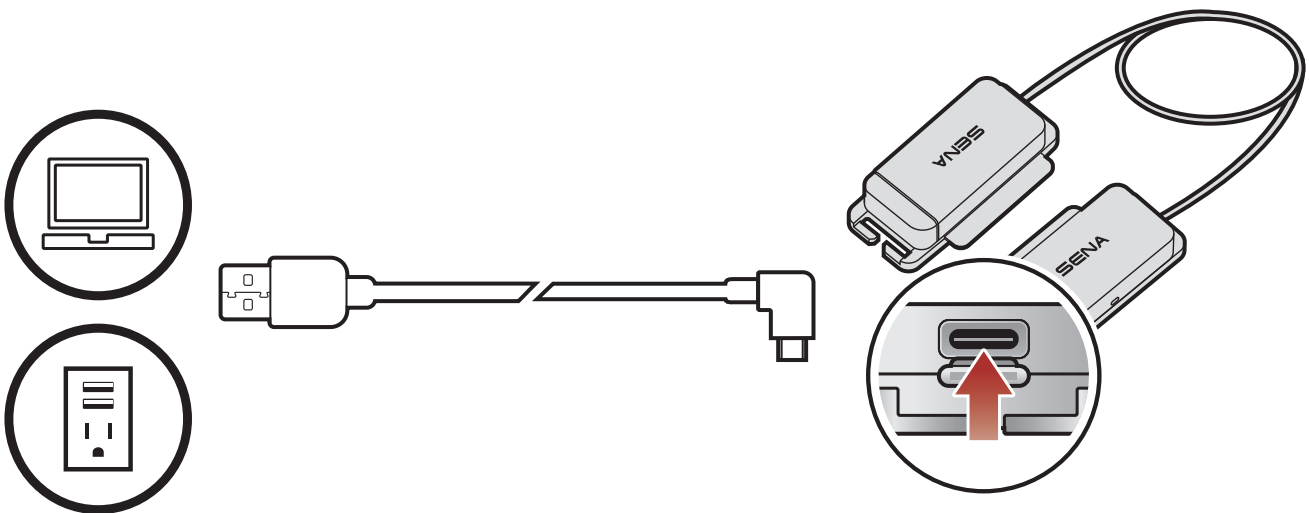

When the USB charging & data cable connects a power supply to the headset, the headset will automatically be turned off and a fault reset will occur.



Note: Fault Reset will not restore the headset to the factory default settings.

10.2 Factory Reset

To erase all of your settings and start fresh, use the **Factory Reset**. The headset automatically restores the default settings and turns off.

- ① Press and hold the **(+) Button** for **10 seconds** to enter the **configuration menu**. →  *"Configuration menu"*
- ② Tap the **(+) Button** **three times**. →  *"Factory Reset"*
- ③ Tap the **(-) Button** to execute **Factory Reset**. →  *"Headset reset, good-bye"*



Copyright © 2021 Sena Technologies, Inc.
All rights reserved.

© 1998–2021 Sena Technologies, Inc. All rights reserved.

Sena Technologies, Inc. reserves the right to make any changes and improvements to its product without providing prior notice.

Sena™ is a trademark of Sena Technologies, Inc. or its subsidiaries in the USA and other countries. SF1™, SF2™, SF4™, SFR™, SRL™, Momentum™, Momentum INC™, Momentum Lite™, Momentum Pro™, Momentum INC Pro™, Momentum EVO™, Cavalry™, Latitude SR™, Latitude SX™, Latitude S1™, 30K™, 33i™, 50S™, 50R™, 5S™, 20S EVO™, 20S™, 10S™, 10C™, 10C PRO™, ProRide EVO™, 10C EVO™, 10U™, 10Upad™, 10R™, 3S™, 3S PLUS™, SMH5™, SMH5-FM™, SMH5 MultiCom™, SMH10™, SMH10R™, SPH10™, SPH10H-FM™, Savage™, Prism Tube WiFi™, Prism™, Bluetooth Audio Pack for GoPro®, R1™, R1 EVO™, R1 EVO CS™, M1™, M1 EVO™, RUMBA™, RC1™, RC3™, RC4™, Handlebar Remote™, Wristband Remote™, PowerPro Mount™, Powerbank™, FreeWire™, WiFi Docking Station™, WiFi Sync Cable™, WiFi Adapter™, +mesh™, +Mesh Universal™, MeshPort Blue™, MeshPort Red™, Econo™, OUTRUSH™, OUTRUSH R™, OUTSTAR™, EcoCom™, Parani A10™, Parani A20™, Parani M10™, pi™, Snowtalk™, Snowtalk2™, SR10™, SR10i™, SM10™, SPIDER RT1™, SPIDER ST1™, X1™, X1 Pro™, X1S™, Expand™, Expand Boom™, Bluetooth Mic & Intercom™, Tufftalk™, Tufftalk Lite™, Tufftalk M™ are trademarks of Sena Technologies, Inc. or its subsidiaries. These trademarks may not be used without the express permission of Sena.

GoPro® is a registered trademark of Woodman Labs of San Mateo, California. Sena Technologies, Inc. ("Sena") is not affiliated with Woodman Labs, Inc. The Sena Bluetooth Pack for GoPro® is an aftermarket accessory specially designed and manufactured by Sena Technologies, Inc. for the GoPro® Hero3 and Hero4 allowing for Bluetooth capabilities.

The Bluetooth® word mark and logos are owned by the Bluetooth SIG, Inc. and any use of such marks by Sena is under license. iPhone® and iPod® touch are registered trademarks of Apple Inc.

Address: 152 Technology Drive Irvine, CA 92618