

Copyright © 2019 by Big Bike Parts, Inc. No part of this instruction sheet may be reproduced without the written permission of Big Bike Parts, Inc.

PART NO. 52-930

HANDLEBAR RISER SET

FITMENT: HONDA GOLDWING/GOLDWING TOUR 2018-NEWER

7/24/2019

TOOLS NEEDED:	5MM ALLEN WRENCH	6MM ALLEN WRENCH	PHILLIPS SCREWDRIVER	8MM SOCKET WRENCH	14MM WRENCH
	MASKING TAPE	NEEDLE NOSE PLIERS	DRILL	REMOVABLE THREAD LOCK	TORQUE WRENCH (ft. lbs)
	CLEAN TOWEL	15/32" OR 12MM DRILL BIT			

PLEASE READ THROUGH AND UNDERSTAND THESE INSTRUCTIONS BEFORE BEGINNING. **USE REMOVABLE THREAD LOCK ON ALL BOLTS AND SCREWS ESTIMATED INSTALLATION TIME: 120 TO 180 MIN. (USING "ALTERNATE CONSOLE ACCESS" TIME: 60 TO 90 MIN.)**

INSTALLATION:

1. OPEN BOTH SADDLEBAG LIDS AND REMOVE BOTH SIDE PANELS. SEE FIG. 1.
2. USING A 6MM ALLEN WRENCH REMOVE THE TWO SEAT BOLTS AND WASHERS. SEE FIG. 2.
3. ON THE RIGHT SIDE DISCONNECT THE CONNECTOR FOR THE SEAT HARNESS. SEE FIG. 3.
4. FOR HONDA'S ADVISED BUTTON INSTALLATION GO TO STEP 5. FOR A QUICKER INSTALLATION METHOD GOTO "ALTERNATE CONSOLE ACCESS" BELOW.
5. STARTING ON THE RIGHT SIDE OF THE BIKE USE A 5MM ALLEN WRENCH AND REMOVE THE SCREW SHOWN IN FIG. 4. PULL THE TRIM DOWN TO REMOVE IT. REPEAT THIS ON THE LEFT SIDE.
6. USING AN 8MM SOCKET WRENCH REMOVE THE TWO BOLTS HOLDING THE MIRROR TO THE BIKE SHOWN IN FIG. 5. PULL THE MIRROR OUT AND UNPLUG THE CONNECTOR. REPEAT THIS ON LEFT SIDE.
7. USING A 5MM ALLEN WRENCH REMOVE THE TWO SCREWS (ONE ON EACH SIDE) NEAR THE MIRRORS SHOWN IN FIG. 6.
8. ON THE RIGHT SIDE REMOVE THE TWO SCREWS SHOWN IN FIG. 7. PULL THE PANEL OUT AND REMOVE IT. REPEAT THIS ON THE LEFT SIDE.
9. USING THE POINT ON A PHILLIPS SCREW DRIVER PUSH IN THE CENTER OF THE PLASTIC RIVET SHOWN IN FIG. 8. REMOVE THE RIVET. REPEAT THIS ON THE LEFT SIDE. **NOTE: AFTER REMOVING ALL PLASTIC RIVETS PUSH THE CENTER OF THE RIVET BACK TO RESET THE RIVET FOR INSTALLATION.**
10. GO TO THE INNER RIGHT COWL ON THE FRONT OF THE BIKE AND REMOVE THE TWO SCREWS AND THREE PLASTIC RIVETS SHOWN IN FIG. 9. PULL THE PANEL LOOSE BUT DO NOT REMOVE IT. REPEAT THIS ON THE LEFT INNER COWL.
11. BEHIND THE PANELS YOU JUST LOOSENED REMOVE ONE PLASTIC RIVET ON EACH SIDE. THE RIGHT SIDE RIVET IS SHOWN IN FIG. 10.
12. STARTING ON THE RIGHT SIDE PANEL PULL THE PANEL OUTWARD TO REMOVE IT. SEE FIG. 11. REPEAT THIS FOR THE LEFT SIDE PANEL.
13. ON THE RIGHT SIDE ONLY DISCONNECT THE TWO CONNECTORS SHOWN IN FIG. 12. ALSO PUSH THE WIRE STAY IN TO RELEASE IT FROM THE PANEL.
14. ON BOTH THE RIGHT AND THE LEFT SIDES REMOVE THE TWO SCREWS MARKED "4" AND "8" IN FIG. 13. SCREW NUMBER "8" ON BOTH SIDES HAS A METAL COLLAR THAT ALSO NEEDS TO BE REMOVED.
15. ON THE RIGHT SIDE ONLY REMOVE THE ONE PLASTIC RIVET AT THE FRONT OF THE RIGHT AIR GUIDE. SEE FIG. 13. REMOVE THE REST OF THE SCREWS SHOWN IN FIG. 13 AND PULL THE AIR GUIDE OUT AND REMOVE IT.
16. ON THE RIGHT SIDE DISCONNECT THE FUEL DOOR CABLE. SEE FIG. 14.
17. TO REMOVE THE SHELTER FIRST REMOVE THE THREE PLASTIC RIVETS SHOWN IN FIG. 15. THE PLASTIC RIVET THAT IS ON THE LEFT REAR OF THE SHELTER IS ON THE INSIDE BRACKET POINTING OUT.
18. USING A 5MM ALLEN WRENCH REMOVE THE TWO SILVER SCREWS SHOWN IN FIG. 15.
19. STARTING AT THE REAR OF THE SHELTER CAREFULLY PULL UP AND LIFT THE SHELTER TO REMOVE IT. NOTE: THE FUEL DOOR IS PART OF THE SHELTER. THE GLOVE BOX OR AIR BAG IS NOT PART OF THE SHELTER.
20. REMOVE THE CONSOLE PANEL BY FIRST REMOVING THE TWO PLASTIC RIVETS SHOWN IN FIG. 16. THESE RIVETS ARE DIFFERENT FROM THE OTHERS. YOU PULL THE CENTER OF THESE RIVETS UP TO RELEASE THEM FROM THE BIKE.
21. USING A 5MM ALLEN WRENCH REMOVE THE TWO SCREWS SHOWN IN FIG. 16. PULL UP ON THE FRONT OF THE CONSOLE PANEL TO RELEASE IT. NOTE: YOU DO NOT NEED TO DISCONNECT THE WIRING ON THE CONSOLE PANEL. FLIP THE CONSOLE PANEL UP SO YOU CAN ACCESS THE HANDLEBAR COVER.
22. USING A PHILLIPS SCREWDRIVER REMOVE THE TWO SCREWS FROM THE HANDLEBAR COVER. PULL THE COVER UP TO REMOVE IT. SEE FIG. 17. NOTE: THESE SCREWS WILL NOT BE REUSED.
23. STARTING ON THE RIGHT HANDLEBAR USING A 14MM WRENCH REMOVE THE TWO BOLTS ON THE RIGHT SIDE SHOWN IN FIG. 18.
24. PLACE THE HANDLEBAR ON A CLEAN TOWEL. USING A 15/32" (12MM) DRILL BIT ENLARGE BOTH HOLES AND REMOVE ANY BURRS. SEE FIG. 19.
25. REPEAT STEPS 23 AND 24 FOR THE LEFT HANDLEBAR.
26. IF YOU WANT THE HANDLEBARS TO MOVE FORWARD USE FIG. 20 TO INSTALL THE RISER SET. IF YOU WANT THE HANDLEBARS TO MOVE BACK (CLOSER TO RIDER) USE FIG. 21 TO INSTALL THE RISER SET.
27. APPLY REMOVABLE THREAD LOCK TO THE BOLTS. ALIGN THE ANGLED WASHER TO THE HANDLEBAR AND THE BOLTS. **TIGHTEN ALL FOUR BOLTS TO 20 FOOT POUNDS.**
28. APPLY REMOVABLE THREAD LOCK TO THE TWO M5 X 14MM SCREWS SUPPLIED WITH RISERS.
29. REINSTALL THE HANDLEBAR COVER USING THE TWO NEW SCREWS.
30. REASSEMBLE THE REST OF THE BIKE IN REVERSE ORDER.

ALTERNATE CONSOLE ACCESS:

1. PLACE A PIECE OF MASKING TAPE ON EACH SIDE OF THE CONSOLE AS SHOWN IN FIG. 4A. SLIDE THE TAPE UNDER THE EDGES OF THE SHELTER AS SHOWN IN FIG. 4A. REMOVE THE 2 PLASTIC RIVETS SHOWN IN FIG. 4A.
2. CAREFULLY LIFT THE FRONT EDGE OF THE SHELTER AS SHOWN IN FIG. 5A. THERE IS A TAB THAT WILL RELEASE FROM BELOW. REPEAT ON THE LEFT SIDE OF CONSOLE.
3. USING A "L" STYLE 5MM ALLEN WRENCH REMOVE THE TWO SCREWS UNDER THE SHELTER. SEE FIG. 5A AND FIG. 6A.
4. USING A NEEDLE NOSE PLIERS REMOVE THE PLASTIC RIVET SHOWN IN FIG. 7A. REPEAT ON THE LEFT SIDE RIVET.
5. SLIDE THE CONSOLE FORWARD AND LIFT THE FRONT. FLIP IT UP AS SHOWN IN FIG. 8A. FROM HERE GO TO STEP 22 TO COMPLETE INSTALLATION.

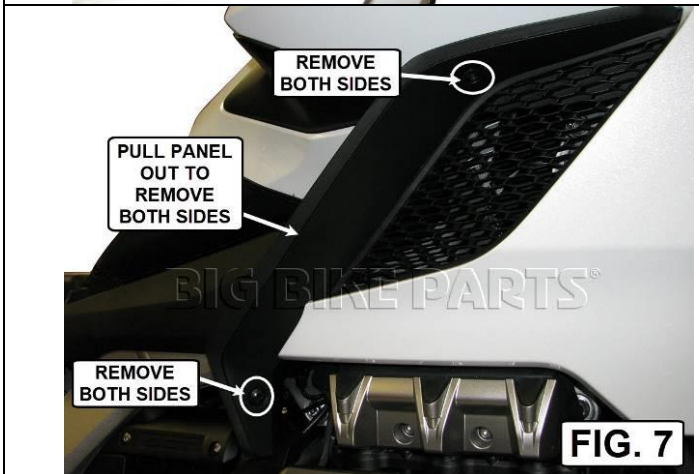
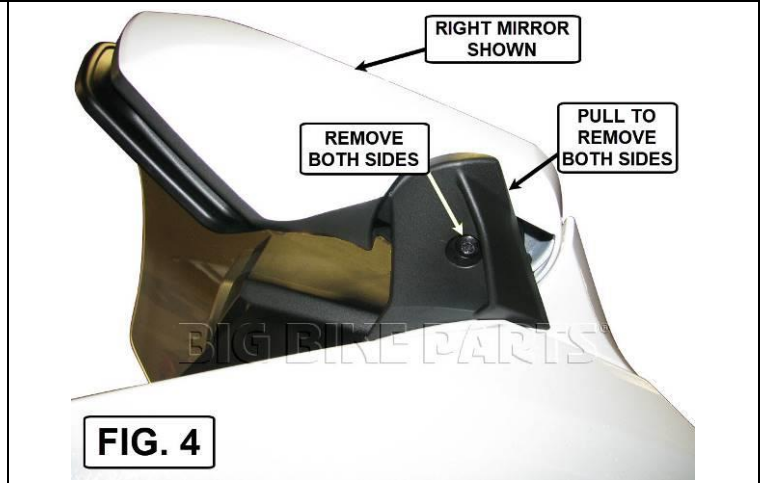
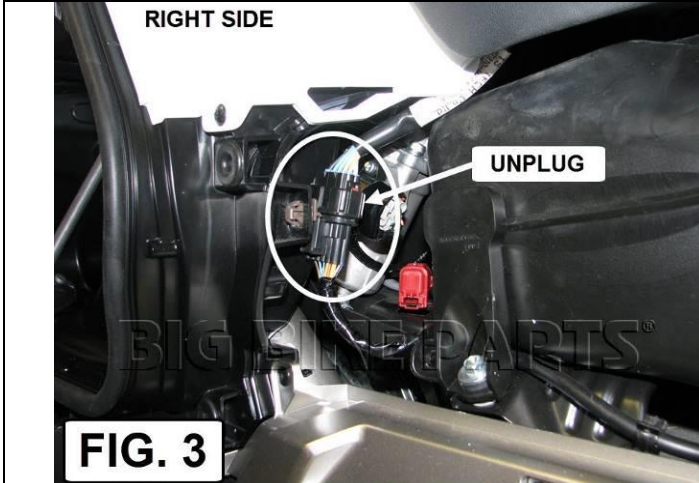
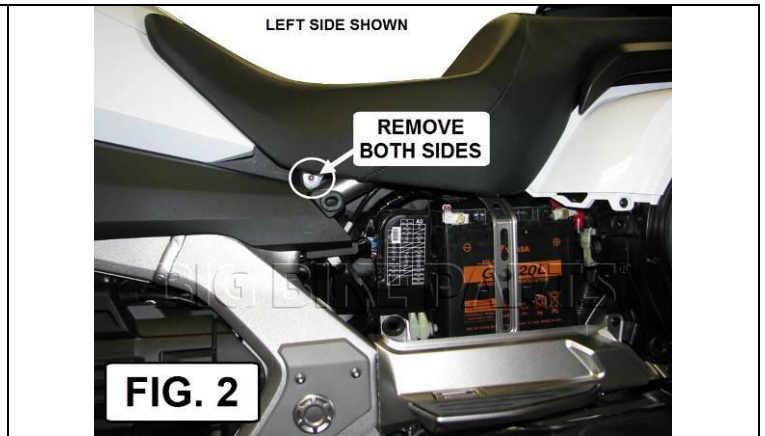
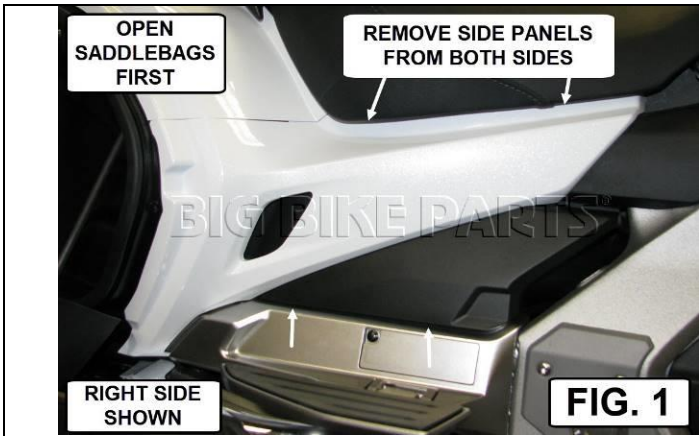

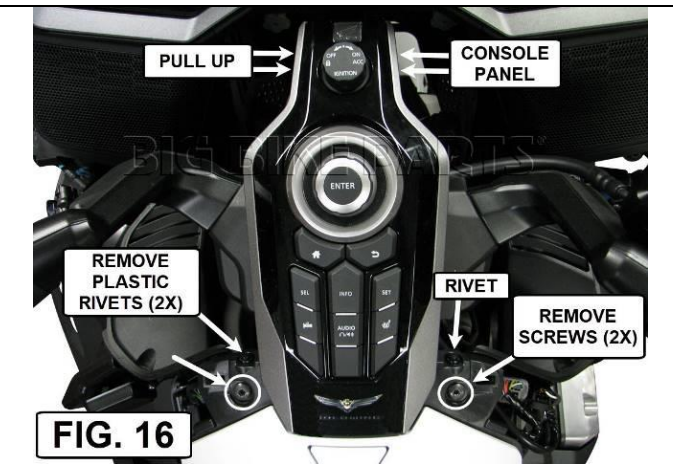
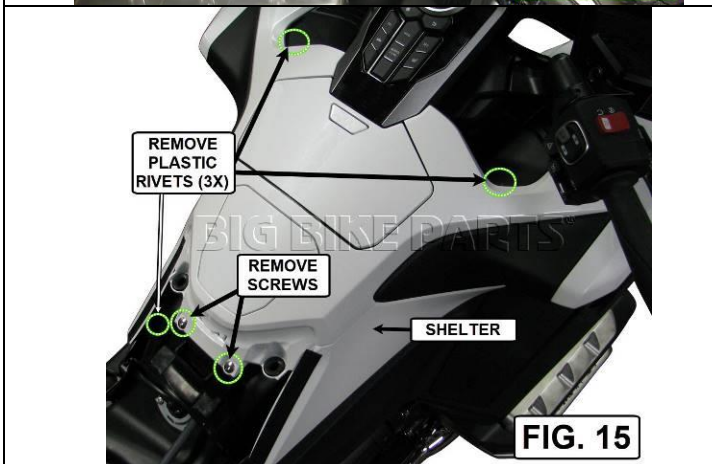
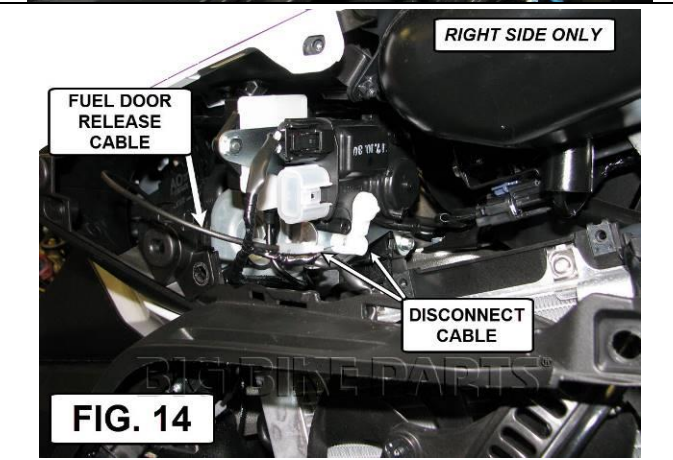
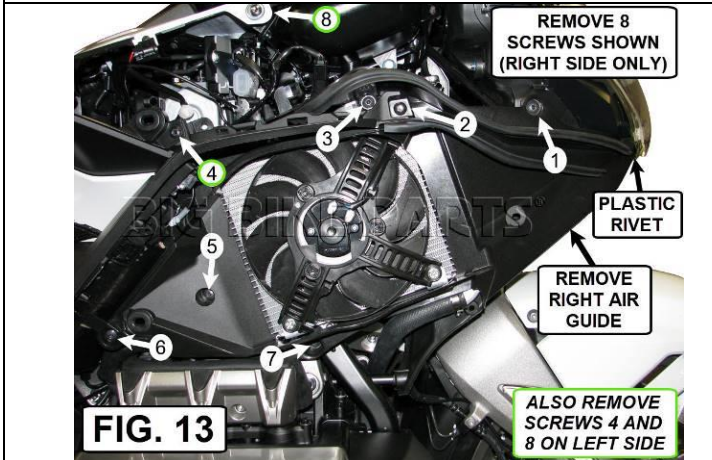
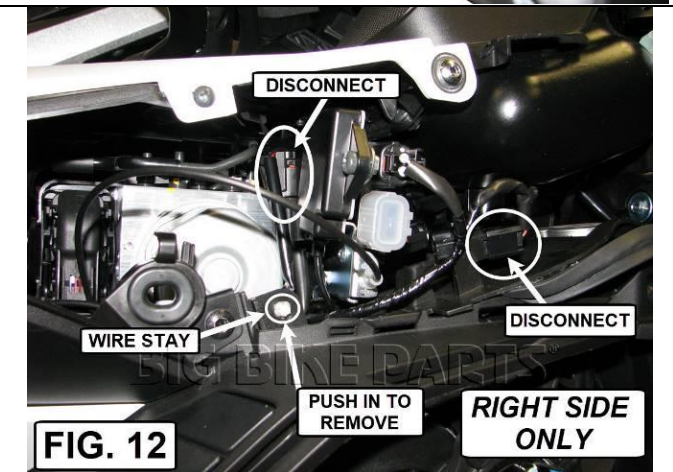
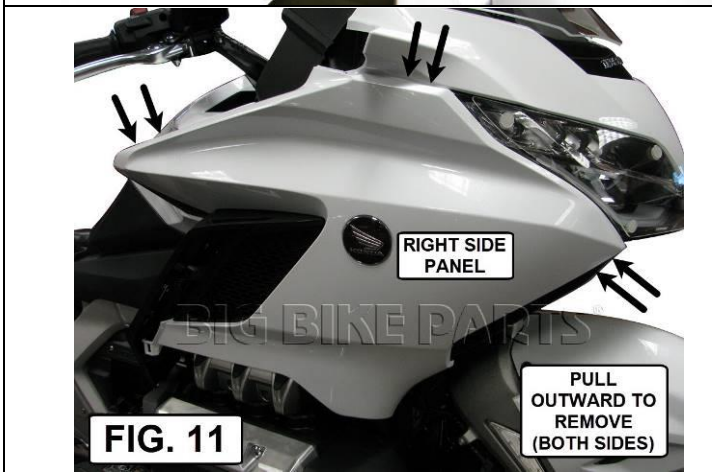
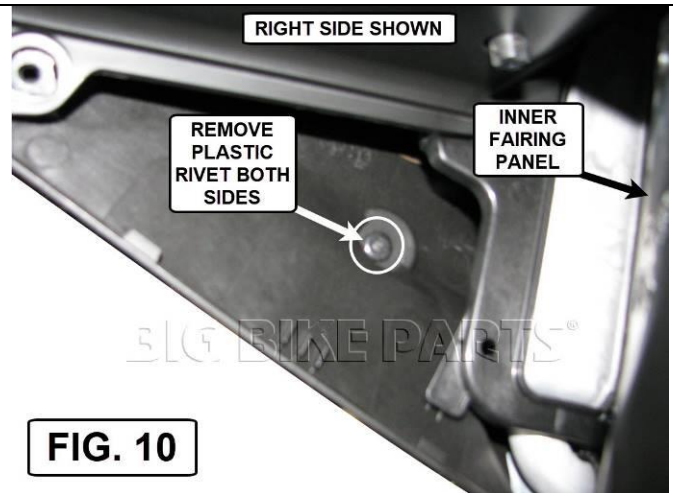
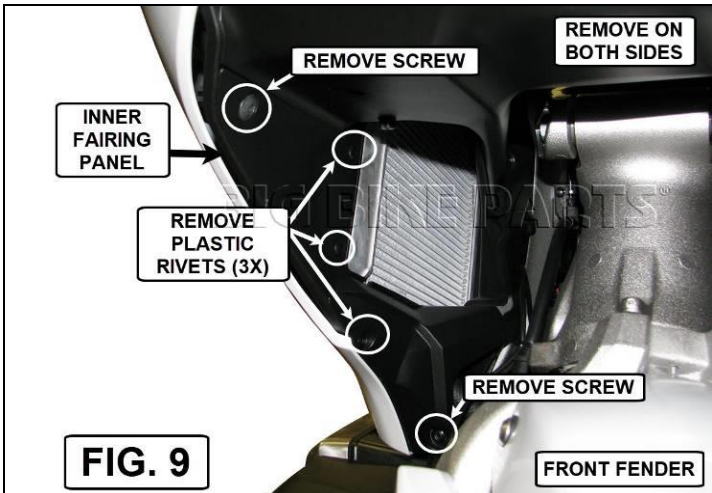

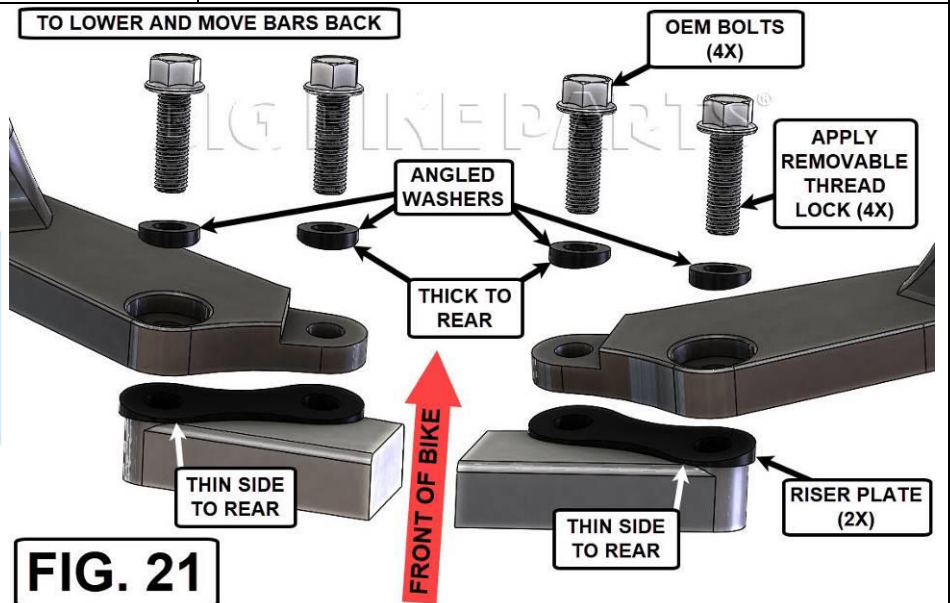
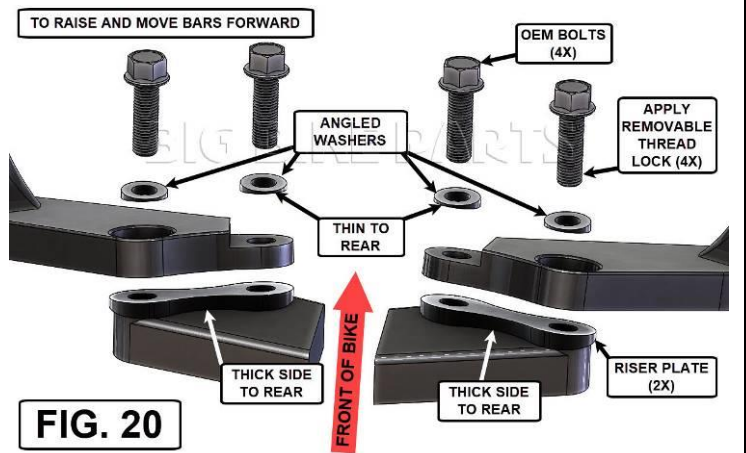
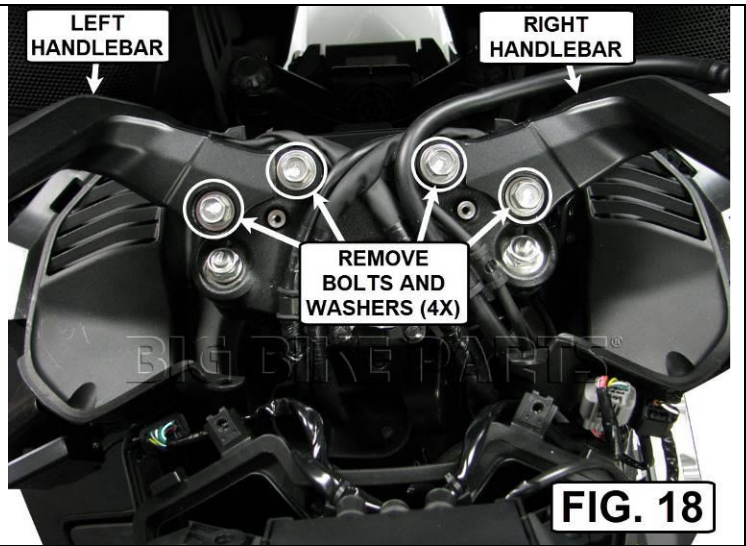
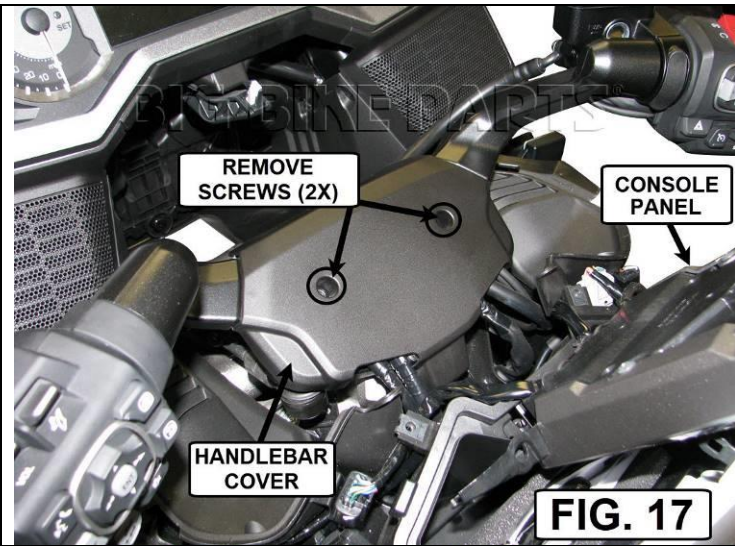

NOTICE

IGNORING THE CONTENTS OF THESE INSTRUCTIONS MAY AFFECT THE PRODUCT PERFORMANCE AND FUNCTIONALITY. NOT FOLLOWING THESE INSTRUCTION MAY CAUSE DAMAGE TO THE PRODUCT OR THE VEHICLE TO WHICH IT IS BEING ATTACHED.

