

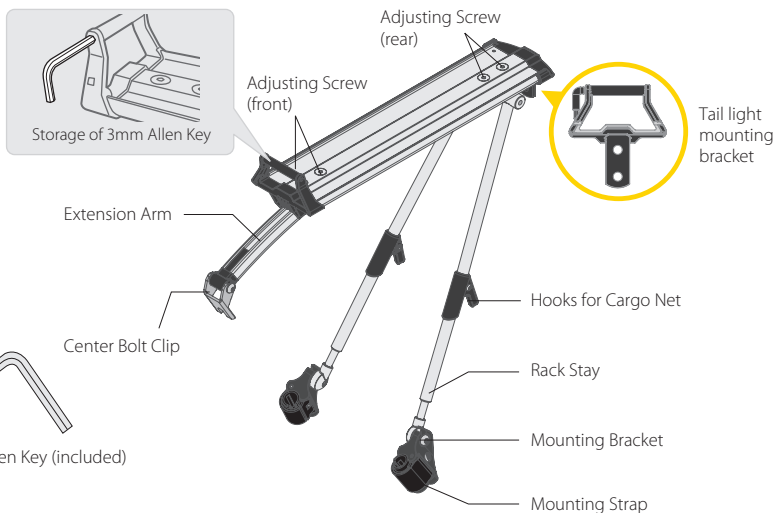

- Max. Weight Capacity: **7 kgs/ 15 lbs**
- Fits road tires up to **700 x 25C**
- Fits seatstay diameter **Ø 14.3 mm ~ Ø 22.2 mm**
- For safety reasons, please read all instruction before first use.

* Tool Needed: 3 mm Allen Key, 5 mm Allen Key

3 mm Allen Key
3 N.m/ 26.55 in-lbs
5 mm Allen Key
8-10 N.m/ 70.8-88.5 in-lbs



INSTALLATION

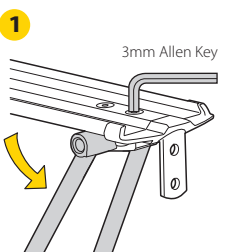

Loosen the 2 Adjusting Screws (rear) to adjust the rack stay. Keep the bracket horizontal when re-tightening the screws.

IMPORTANT NOTE

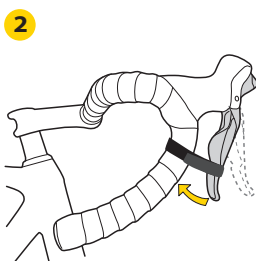
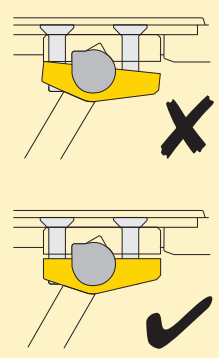

Hold rear brake lever with the Hook and loop Fastener (supplied) to fix rear brake in position.

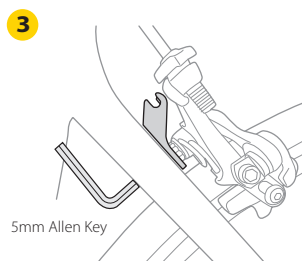

Loosen the rear brake (DO NOT loosen the bolt completely). Install the Center Bolt Clip on bike then re-tighten the bolt. Release the Hook and loop Fastener and test brake function after installation.

IMPORTANT NOTE

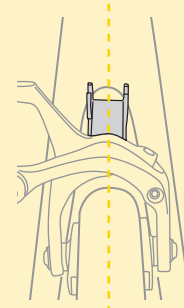

Make sure the Center Bolt Clip is aligned with the tire and does not interfere with normal brake function.

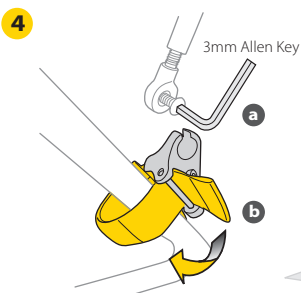

- a Release the Mounting Bracket.
- b Install the Mounting Bracket on seatstay as shown. DO NOT fasten the strap completely.

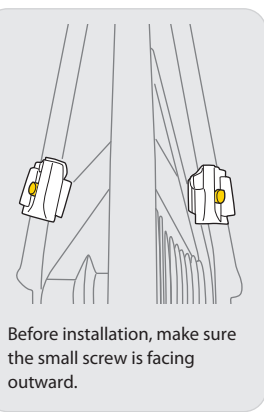

Before installation, make sure the small screw is facing outward.

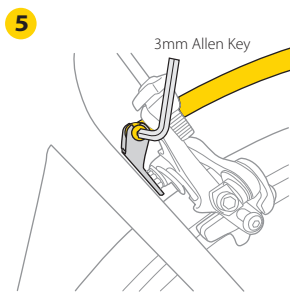

Install the Extension Arm on the Center Bolt Clip and tighten the screws.

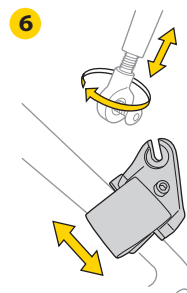

Adjust the Mounting Bracket and length of rack stay for proper position. Fasten the Mounting Strap after adjustment.

IMPORTANT NOTE

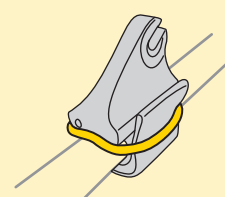

For safety reasons, secure excess Mounting Strap with Rubber Ring as shown. (Especially when mounted on thin seatstays)

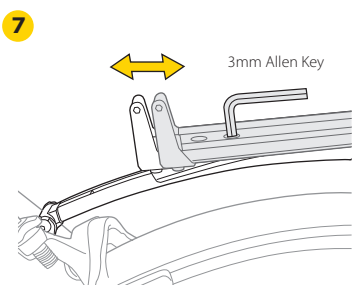

Loosen the 2 Adjusting Screws (front) to adjust angle of rack. Re-tighten screws when angle is fixed.

IMPORTANT NOTE

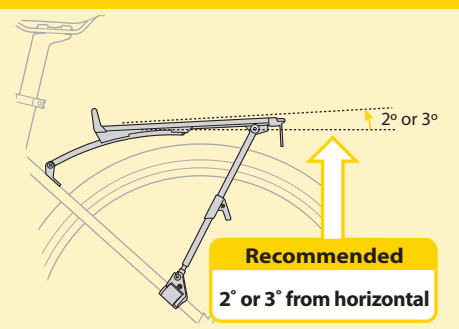

Recommended
2° or 3° from horizontal

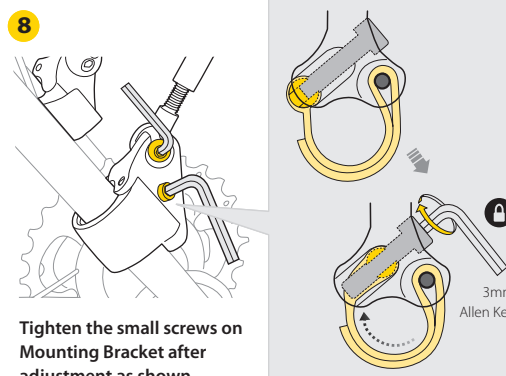

Tighten the small screws on Mounting Bracket after adjustment as shown.



WARNING

- 1. NEVER exceed maximum loading capacity of 7 kgs (15 lbs) when using Roadie Rack.**
2. Make no modifications to the rack.
3. Roadie Rack is not designed to tow any kind of trailer. Never attach a trailer to Roadie Rack.
4. DO NOT attempt to use Roadie Rack as a passenger seat.
5. Loading Roadie Rack may affect the stability and alter the riding characteristics of the bicycle, particularly regarding steering and braking.
6. If you mount trunk bag on the rack, make sure the rearward view of the rear reflector or tail light is not blocked.
- 7. Before each ride, insure Roadie Rack is properly installed on your bike as shown and all screws and straps are tighten securely.**
- 8. For safety reasons, check the rear brake and make sure the function works well after installation.**

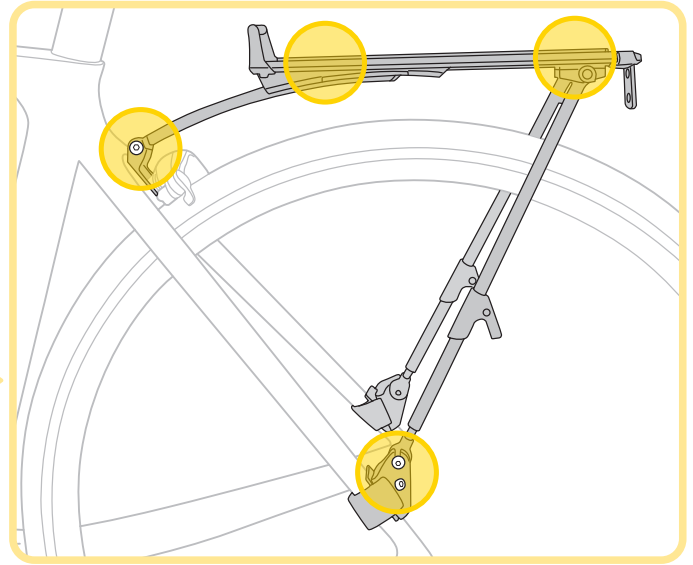

WARNING

- 1. MAKE SURE the mounting bracket is not interfere with the movement of chain and freewheel. Improper mounting position may cause damage to Roadie Rack or your bike and may cause bodily harm.**

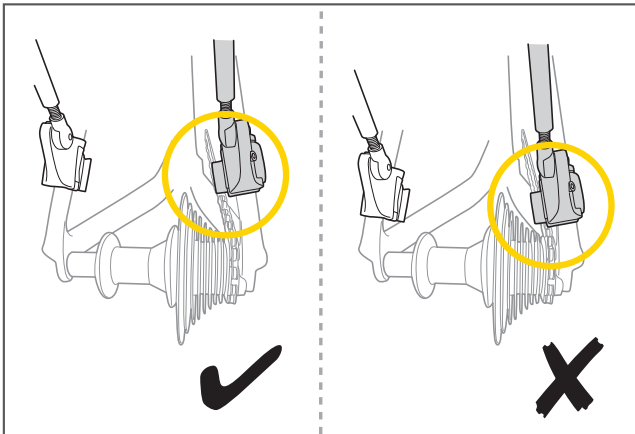

- 2. MAKE SURE the rack is aligned with tire.**

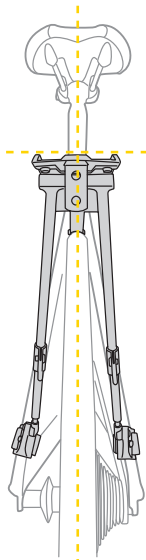

OPTIONAL ACCESSORIES

RedLite™ Aura

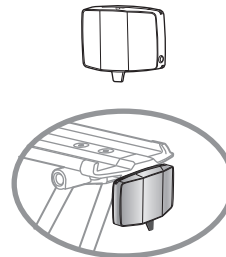

Art no. TMS063

Cargo Net

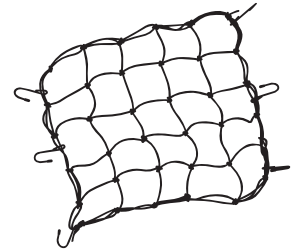

Art no. TCN02

Works with any Topeak RX QuickTrack™ system trunkbags, ex: RX TrunkBag EX

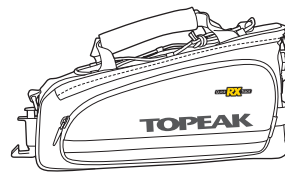

Art no. TT9636B

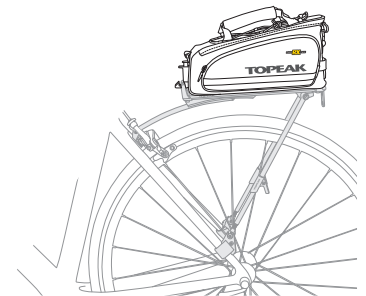

WARRANTY

2-year Warranty: All electronic and mechanical components against manufacturer defects only.

Warranty Claim Requirements

To obtain warranty service, you must have your original sales receipt. Items returned without a sales receipt will assume that the warranty begins on the date of manufacture. All warranties will be void if the product is damaged due to user crash, abuse, system alteration, modification, or used in any way not intended as described in this manual.

* The specifications and design are subject to change without notice.

Please contact your Topeak dealer with any questions.

For USA customer service, call: 1-800-250-3068

Website: www.topeak.com