

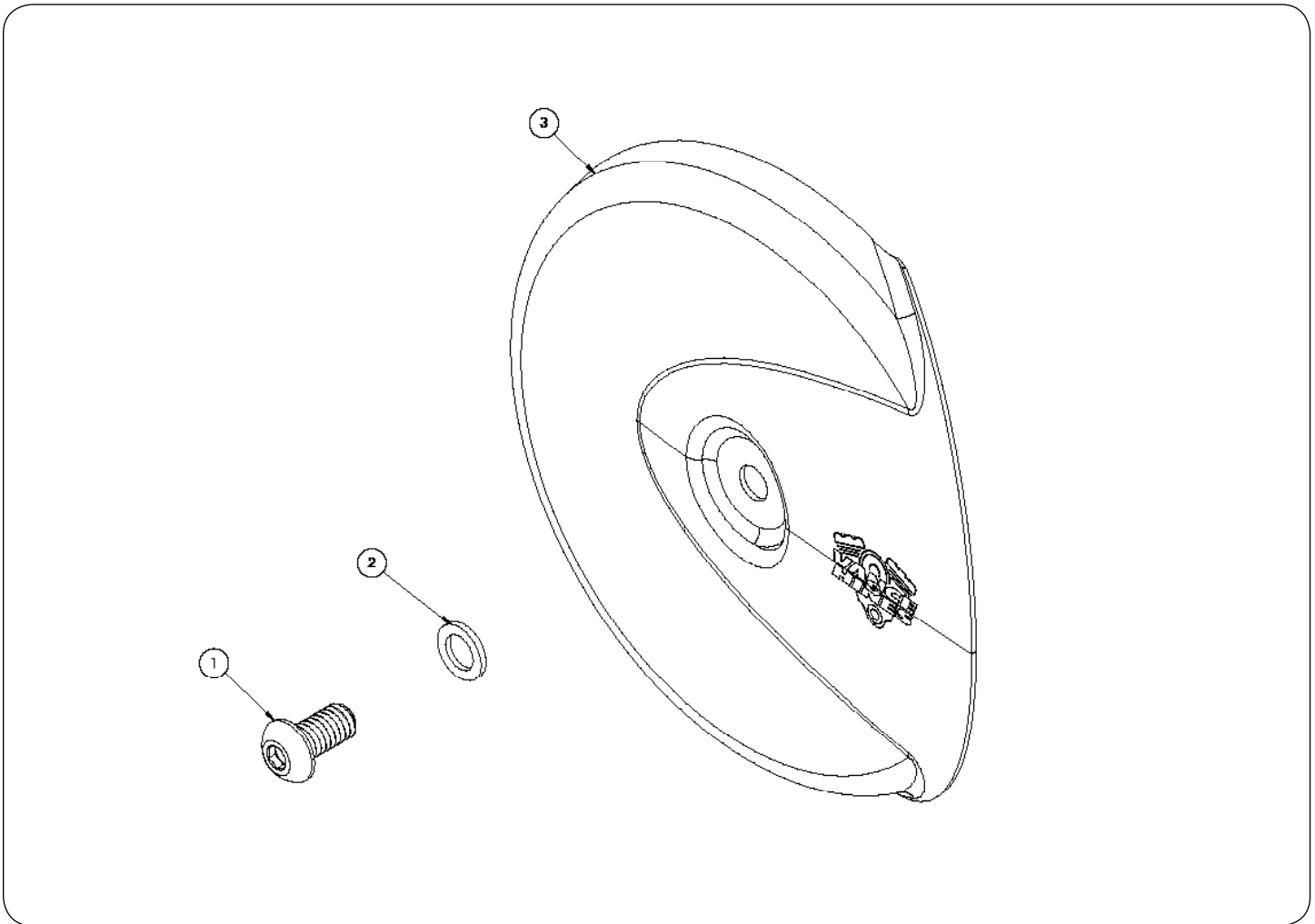

INSTALLATION INSTRUCTIONS: SKULLCAP STINGRAY AIR FILTER COVER VO2 **NAKED** AIR INTAKE PART# 71090 / 71091

Congratulations, you have purchased the finest air intake available for your motorcycle. Your Vance & Hines air intake is designed and crafted for performance, quality and style. Please follow the instructions below, check air intake kit for missing or damaged parts and if you need any assistance please contact our technical support line (562) 921-7461.



PARTS LIST

NO.	Description	Qty.
1	5/16-18 X 5/8 Button Head	1
2	Poly washer	1
3	Skullcap Stingray	1

TOOLS REQUIRED

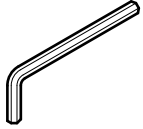

3/16" Allen,

Loctite 243 (blue)

OEM SYSTEM REMOVAL

1. Begin by removing the OE air filter cover. On some models the cap screw may be covered by a vanity cover. Carefully pull this cover off carefully as it is held on by Velcro.
2. None of the OEM parts will be reused for this installation

V&H AIR INTAKE INSTALLATION

1. For a clear understanding of this installation, it is best to refer to the exploded view diagram while reading these instructions.
2. When installing or servicing the air cleaner, apply Loctite 243 (blue) to threads of all fasteners.
3. Place the Skullcap **(3)** cover onto air filter. Make sure Vance and Hines logo is oriented to 3 O'clock.
4. Apply Loctite 243 (blue) to the threads on the 5/16"-18 x 5/8" button head cap screw **(1)**. Insert the 5/16"-18 x 5/8" button head cap **(1)** screw through the poly washer **(2)** and skullcap cover hole into the center of the air filter element: tighten to 50-65 in/lbs..
5. After 100 miles check to be sure that all bolts are still tight. Periodically ensure that these screws remain tight.

CARE AND MAINTENANCE

1. CHROME COVER. When installing the chrome air filter cover, make sure your hands are clean and free of oil. After installation, thoroughly clean cover with a soft cloth and cleaning solvent that will leave no residue (chrome wax / polish, glass cleaner, alcohol, ammonia, etc.) before starting the motorcycle
2. BLACK COVER. When installing the black air filter cover, make sure your hands are clean and free of oil. After installation, thoroughly clean cover with warm soapy water and a clean soft cloth, taking care to not wet the filter element. Dry with clean towel to remove any residue before starting the motorcycle. DO NOT use anything abrasive to clean cover

Emissions Notice:

In California, in order to meet Air Resources Board emissions requirements, certain aftermarket part applications have been identified as replacements, and others have received ARB Executive Orders. All other emissions related aftermarket parts are for competition use only. A list of replacement parts and EO parts, and corresponding fitment is provided at vanceandhines.com/california.

Warranty:

All Vance & Hines products are warranted against defects in material and workmanship for a period of 90 days. This warranty does not cover discoloration or rust. This warranty shall be limited to the repair or replacement of the product, which may be proven defective under normal use. Vance & Hines will not warranty any system that has been abused, misused, improperly installed or modified.

Dealers or distributors are not authorized to make dispositions binding upon Vance & Hines. Vance & Hines will not be responsible for any labor charges incurred in removing or replacing any system under warranty. A return authorization number and a copy of the original purchase invoice must accompany all returns. Parts returned without a return authorization may be refused.

13861 ROSECRANS AVENUE / SANTA FE SPRINGS, CA 90670

SALES: (562) 921-5388
TECHNICAL: (562) 926-5291
FAX: (562) 802-0110

vanceandhines
.com