

Please follow the instructions below, check the kit system for missing or damaged parts and if you need any assistance please contact our technical support line (562) 921-7461.

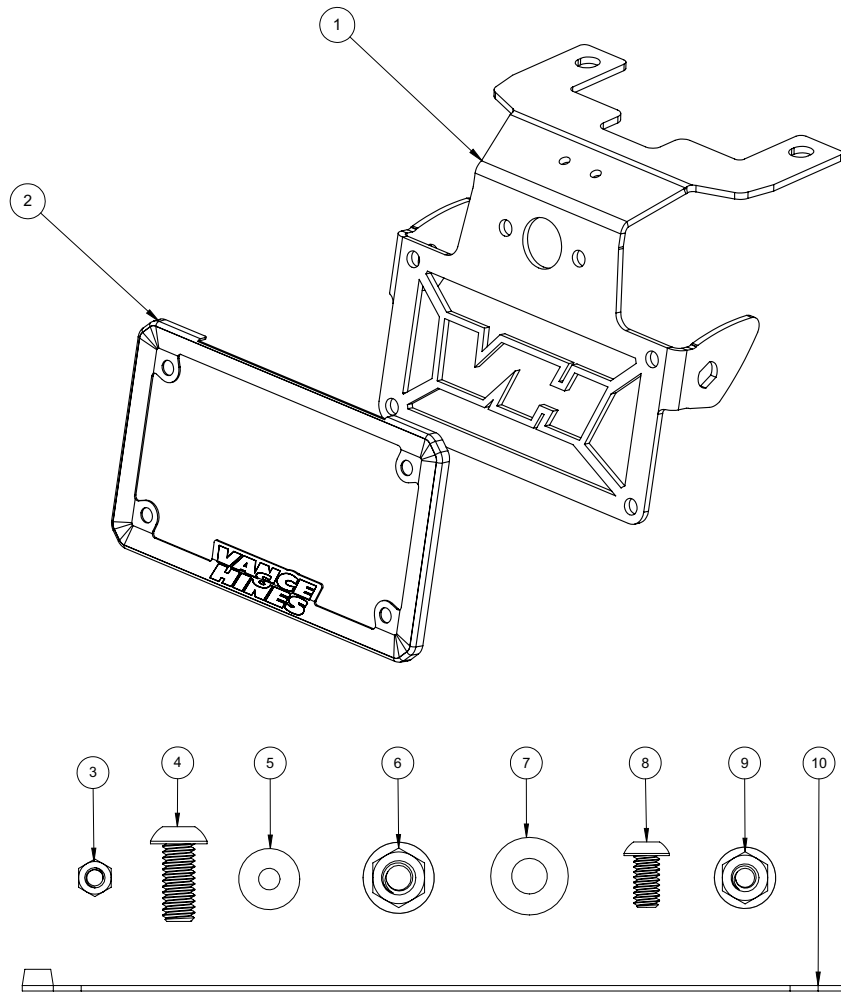

PARTS LIST

ITEM NO.	PART NO.	DESCRIPTION	QTY.
1	H465FE-P	HON GROM FENDER ELMIN BLK	1
2	H435FE-P	HON GROM LC PLATE FRAM	1
3	A928HW	M5 HEX NUT 18-8 SS BLACK	2
4	A755HW	SS BLK 5/16-18 X 3/4 BHSOC SCREW	2
5	A927HW	M5 FLAT WASHER 18-8 SS BLACK	2
6	A520HW	5/16-18 HEX LOCK NUT SS BLK	2
7	A107HW	WASHER 5/16IN FLAT ZINC	2
8	A304HW	SCREW 1/4-20X1/2 BHSCS-PATCH	4
9	A504HW	NUT SERR FLANGE 1/4IN-20 ZINC	4
10	A288HW	NYLON CABLE TIE 8" X 14"	1

TOOLS REQUIRED

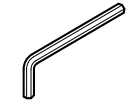

Allen Keys: 6mm, 5/32", 3/16"



Screwdriver (PH #1)

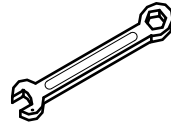

Combination Wrench: 10mm

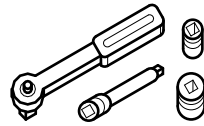

Ratchet: 1/4", 3/8" Drive
Socket: 1/2", 10mm, 8mm

STOCK LICENSE PLATE REMOVAL & VANCE & HINES INSTALLATION

1. Remove the seat with ignition key.
2. Disconnect the wiring shown in Figure 1.
3. Unfasten the 4 bolts shown in Figure 2.
4. Carefully remove the OEM fender assembly and wiring from the motorcycle.
5. On the OEM fender, unfasten all the screws shown in Figure 3 and 4.
6. Remove the (2) screws shown in Figure 5, and the (1) bolt shown in Figure 6.
7. Remove the screws shown in Figure 7, this will free the license plate light assembly.
8. Remove the nuts shown in Figure 8, and remove the license plate light from the assembly.
9. Disconnect the turn signal connectors shown in Figure 9.
10. Remove the OEM flange nuts shown in Figure 10, then remove the turn signal, keep the flange nuts as these will be reused for assembly of Vance & Hines' Fender Eliminator.
11. Run the wiring of the OEM turn signals through the V&H Fender Eliminator as shown in Figure 11, be sure to check that the screw on the turn signal is facing down and it clocks into the slot cutout, fasten with OEM flange nut do this for both sides.
12. Run wiring for OEM license plate light as shown in Figure 12.
13. Fasten license plate light with the two M5 hex nuts (Item 3) and washer (Item 5) as shown in Figure 13, leave loose at this time.
14. Reconnect the turn light wiring as shown in Figure 14, be sure to match the coloring of the wiring when connecting.
15. Run the wiring through the frame's square cutout as shown in Figure 15.
16. Install the bolts (Item 4) and fasten with nuts (Item 6) as shown in Figure 16.
17. Run the wiring as it was before, underneath the gaps between fender mounts. Then connect the ends as shown in Figure 1.
18. Install frame using 5/16-18 screw (Item 4), 5/16 washer (Item 7) and 5/16-18 nut (Item 6)
19. Secure wiring using cutouts on frame and supplied zip tie (Item 10)
20. Install V&H Cover (Item 2) using 1/4-20 screw (Item 8), and 1/4-20 nut (Item 9). Adjust license plate cover to leave clearance between the cover and the light. Tighten nuts.
21. Be sure to tighten all the hardware before starting your motorcycle.
22. Check to see that all the lights are working correctly.

FIGURE 1

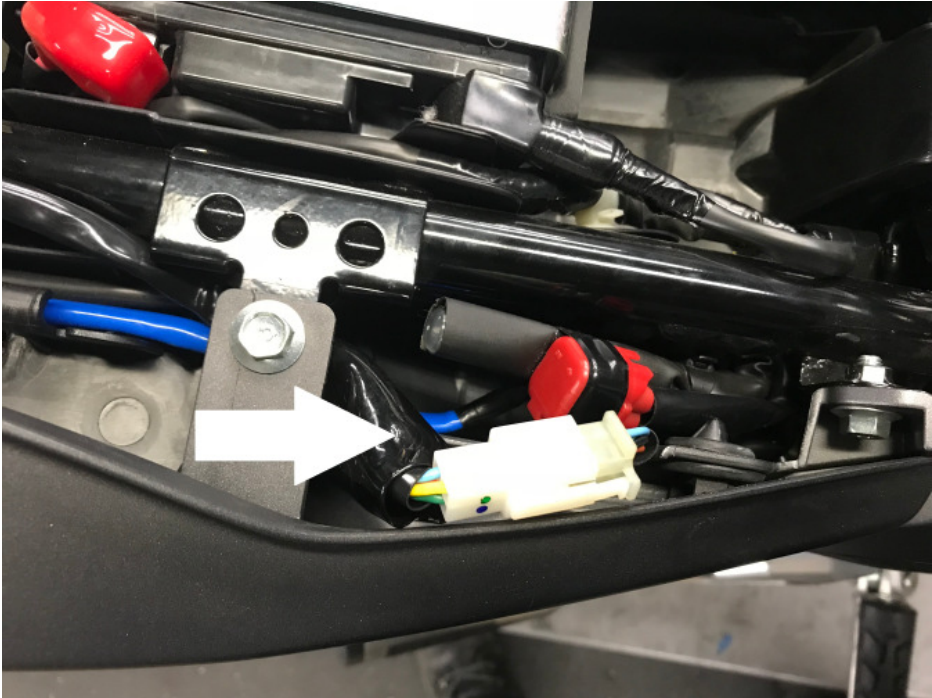

FIGURE 2



FIGURE 3



FIGURE 4



FIGURE 5



FIGURE 6



FIGURE 7

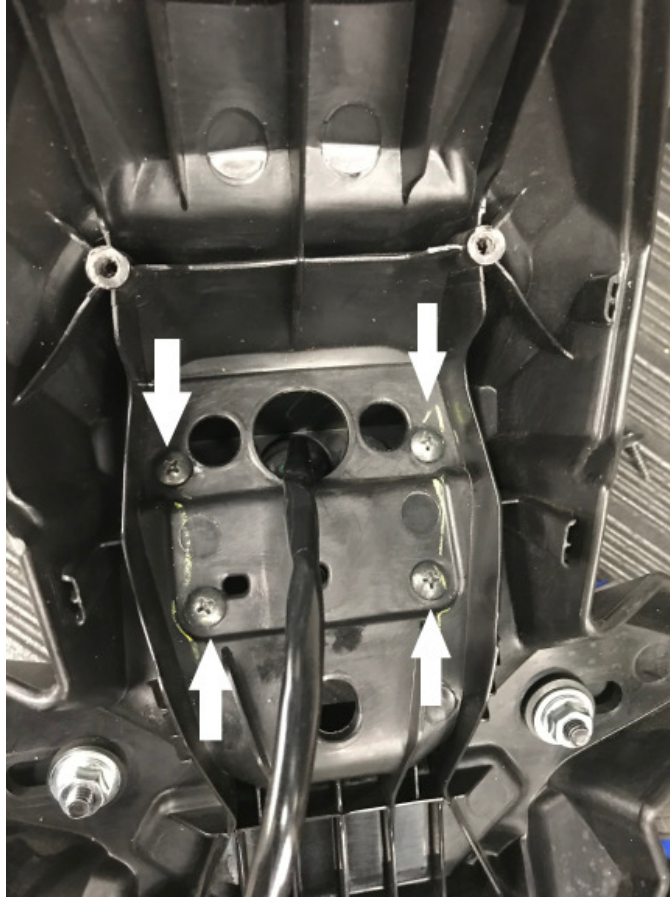

FIGURE 8



FIGURE 9



FIGURE 10



FIGURE 11



FIGURE 12



FIGURE 13

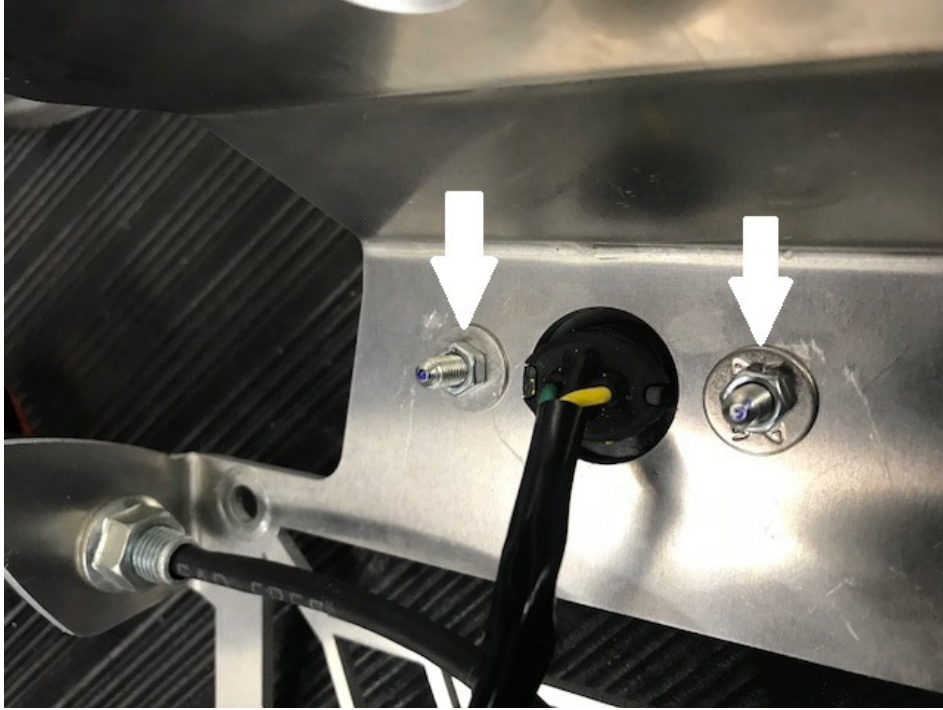

FIGURE 14

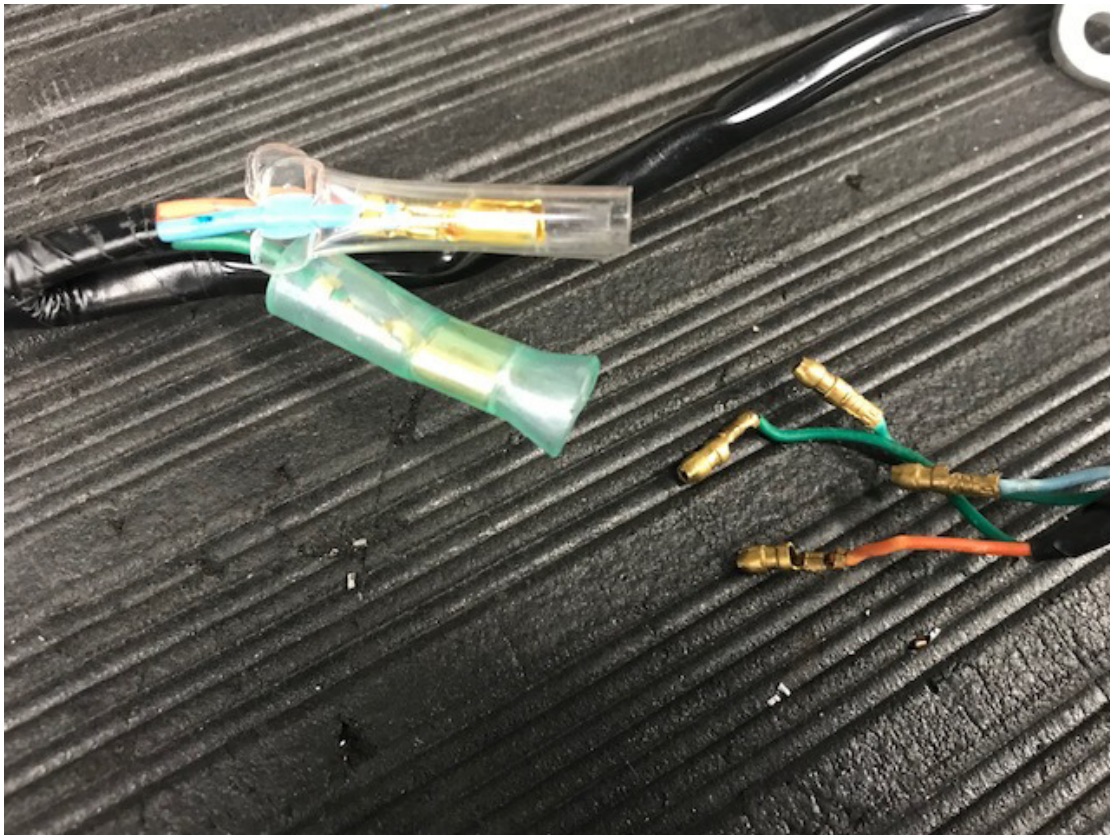

FIGURE 15

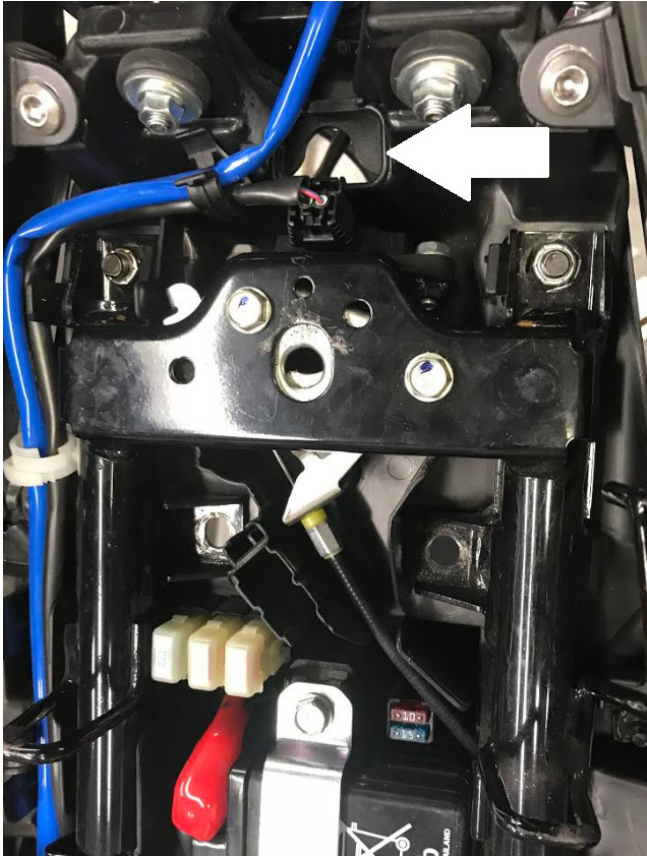

FIGURE 16



Emissions Notice:

In California, in order to meet Air Resources Board emissions requirements, certain aftermarket part applications have been identified as replacements, and others have received ARB Executive Orders. All other emissions related aftermarket parts are for competition use only. A list of replacement parts and EO parts, and corresponding fitment is provided at vanceandhines.com/California.

Warranty:

All Vance & Hines products are warranted against defects in material and workmanship for a period of 90 days. This warranty does not cover discoloration or rust. This warranty shall be limited to the repair or replacement of the product, which may be proven defective under normal use. Vance & Hines will not warranty any system that has been abused, misused, improperly installed or modified.

Dealers or distributors are not authorized to make dispositions binding upon Vance & Hines. Vance & Hines will not be responsible for any labor charges incurred in removing or replacing any system under warranty. A return authorization number and a copy of the original purchase invoice must accompany all returns. Parts returned without a return authorization may be refused.

13861 ROSECRANS AVENUE / SANTA FE SPRINGS, CA 90670
SALES: (562) 921-5388
TECHNICAL: (562) 926-5291
FAX: (562) 802-0110

vanceandhines
.com