

V3 FRAME SLIDERS KIT 2.0

KAWASAKI ER6 F

year of production: '09-'11

product code: SR139

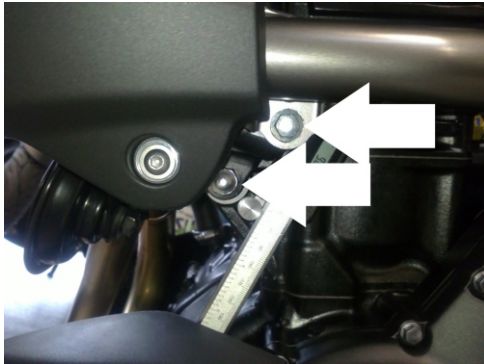

Assembly position (both sides)

Assembly instructions

1. Remove the original bolts indicated with the arrows on the assembly position scheme above.
  2. Replace the original bolt by the new mounting bolt (parts #7), the spacer 1 (parts #9) and adapter (part #6) according to the scheme on the right page. Put the adapter (part #6) in the right position according to the drawing on the right page.
  3. Assemble the slider, round cylindrical body, the bolt and the steel sleeve (parts #1, #2, #3, #4 and #5) according to the drawing on the right page. Put them into the threaded hole in adapter (part #6).
  4. Same operation is required in another side of the motorbike.
- We suggest to use the threadlocker (eg. Loctite®) to make sure that the vibrations of the engine do not loosen the bolts.

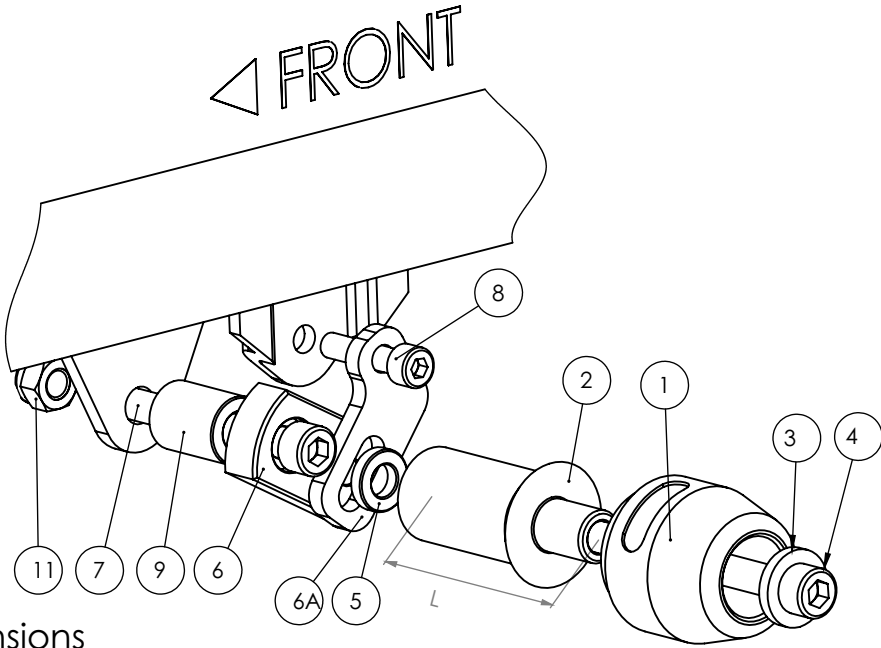

Dimensions of the spacers

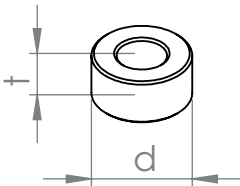

Assembly scheme (both sides).  
Parts #6A and #8 appear on the right side only.

Part #	Part name	Left side (as You sit on the motorbike)	Right side
1	Slider	1 pcs.	1 pcs.
2	Round cylindrical body	L = 80 mm	L = 50 mm
3	Steel sleeve	1 pcs.	1 pcs.
4	Allen bolt (8,8 class)	M10x110 mm	M10x70 mm
5	Spacer	t=20 mm, d=5 mm	t=20 mm, d=5 mm
6	Adapter	Aluminium (#6) + Steel (#6A)	Aluminium
7	Mounting bolt 1	M10x80 mm	M10x140 mm
8	Mounting bolt 2	M8x40 mm	-
9	Spacer 1	t=20 mm, d=30 mm	t=20 mm, d=25 mm
10	Spacer 2	-	-
11	Nut	1 pcs. M10 to be mounted on M10x80 bolt	1 pcs. M10 to be mounted on M10x140 bolt
12	Washer	-	-

Legal note. This product is a professional accessory to be used on the race track. Neither manufacturer, nor Seller take responsibility for any damages occurred despite of using protective accessories. For more information go to [vortexracing.com](http://vortexracing.com)